

RETAIL FOR LEASE

334 SOUTH BROADWAY
DENVER, COLORADO 80209

334 S BROADWAY



AVAILABLE NOW

LEASE RATE

Call Ray! He returns phone calls!

NNN

\$13.56

RAY ROSADO, CCIM

Principal

720.209.5546

rosado@lee-associates.com

PROPERTY DETAILS

- 334 S Broadway has a total of $\pm 3,144$ RSF.
- Exceptional visibility with Broadway facing signage.
- Centrally located with easy access to I-25, Santa Fe and Broadway/Alameda Light Rail Station.
- Close proximity to Baker, Wash Park and Platt Park neighborhoods.
- Common area restrooms.
- Private, secured tenant entrance located in back.
- Ample street parking and dedicated off-street parking available.
- Across the street from 75 Acre Broadway Park development project.



RETAIL FOR LEASE

334 SOUTH BROADWAY
DENVER, COLORADO 80209



334 SOUTH BROADWAY ±3,144 SF

Former Dance Studio

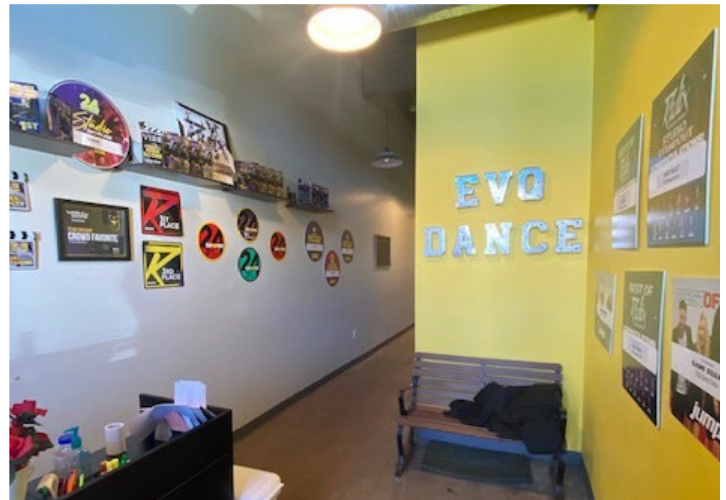
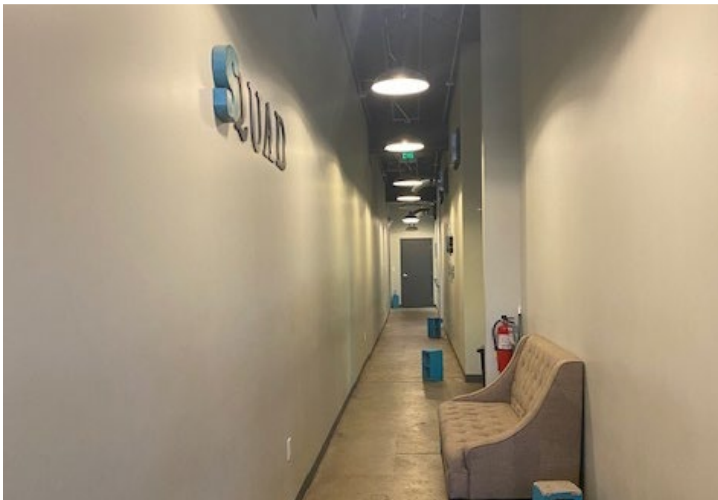
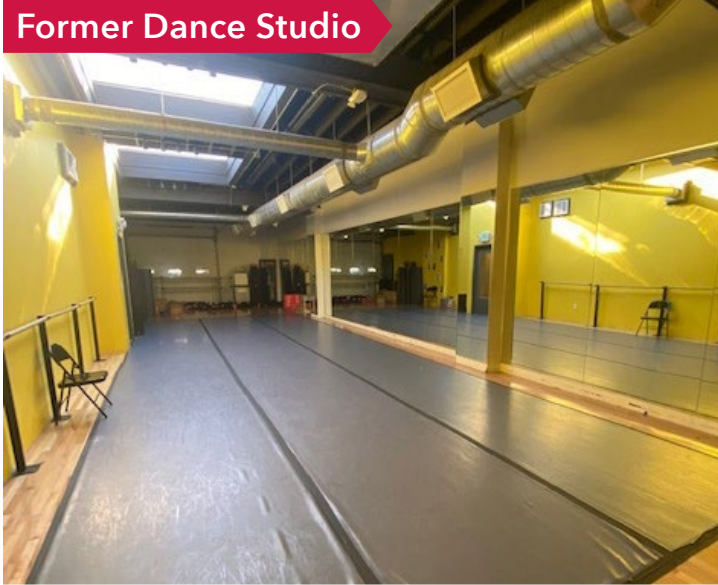

PROPERTY DETAILS

- Dance studio buildout with small reception area and two (2) separate studio rooms.
- Current tenant is still operating so please call broker to set up a showing.
- With overhead door, an outside front patio would be possible.
- Hardwood dance floor and mirrors can remain if preferred.
- Panoramic skylights throughout.
- Rear access to common area restrooms.
- Direct access to the alley with a rear overhead door.

RAY ROSADO, CCIM
Principal
720.209.5546
rrosado@lee-associates.com

RETAIL FOR LEASE

334 SOUTH BROADWAY
DENVER, COLORADO 80209

FLOOR PLAN

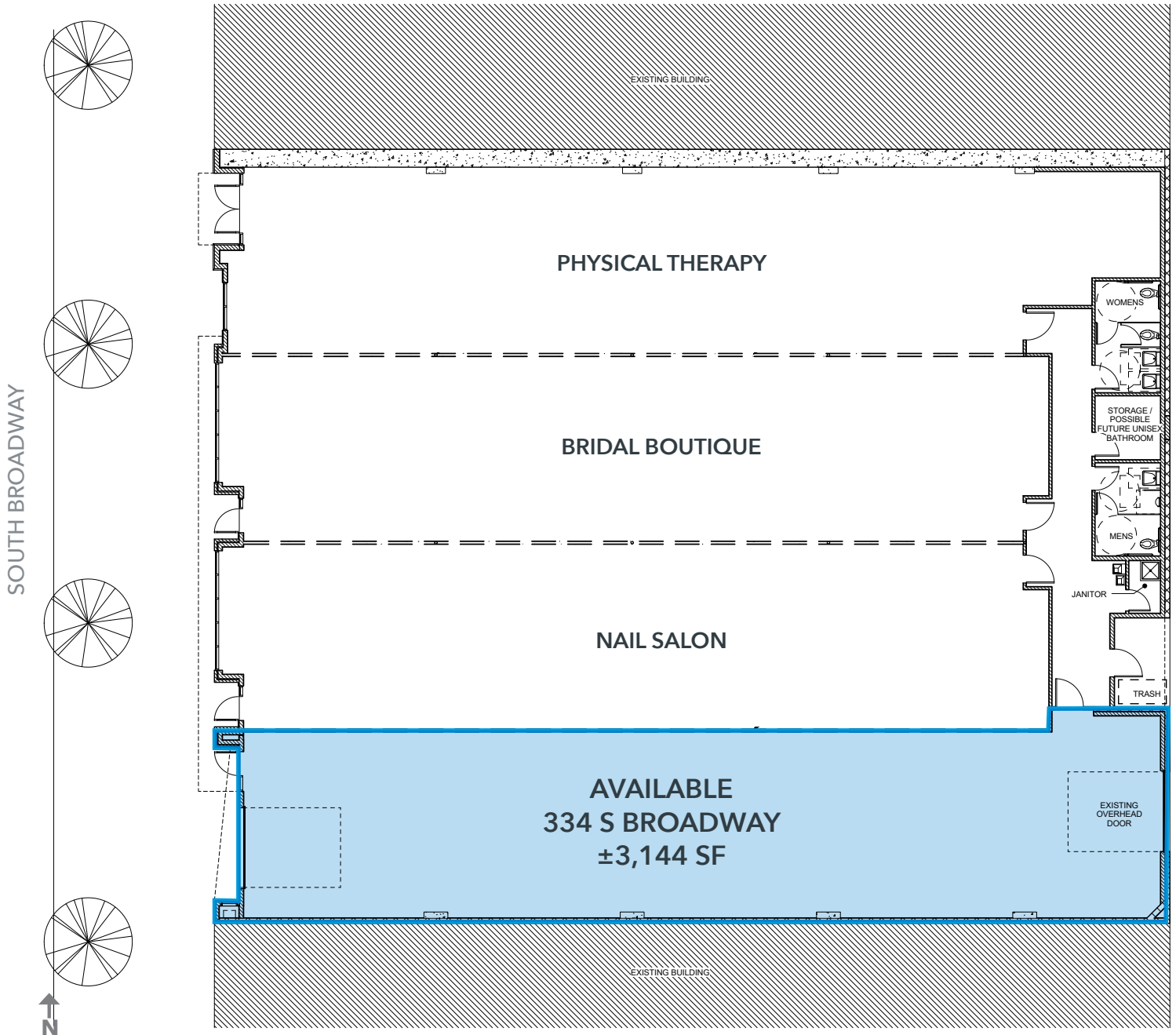

RAY ROSADO, CCIM

Principal

720.209.5546

rosado@lee-associates.com

RETAIL FOR LEASE

334 SOUTH BROADWAY DENVER, COLORADO 80209

AERIAL



Walk Score	94
Transit Score	77
Bike Score	96
TRAFFIC COUNTS	
Along Broadway	32,462 VPD
Along Lincoln	29,814 VPD

DEMOGRAPHICS	2 MILES	5 MILES	10 MILES
POPULATION	78,807	470,599	1,307,361
AVERAGE HH INCOME	\$106,113	\$105,630	\$101,747

RAY ROSADO, CCIM

Principal
720.209.5546
rosado@lee-associates.com

