



260

RICHMOND ST. E.

OFFICE/RETAIL FOR LEASE IN  
TORONTO'S DOWNTOWN EAST



# w e l c o m e t o

## 260 RICHMOND ST E

Located just north of the heart of the King East District and with proximity to the Financial Core, and St. Lawrence Market, and in the heart of the King East Design District, 260 Richmond Street East is surrounded by some of the city's most notable design studios and boutiques. With heavy foot traffic and a King Street streetcar stop within walking distance to the unit, providing excellent east-west connection throughout the city, this location is centrally located with rapid incoming residential density. The rapid population growth and recent influx of residential developments make this the ideal opportunity for a variety of retail purposes in one of the most historic neighbourhoods in Toronto. Targeting clean uses only.



# w e l c o m e t o

# 260 RICHMOND STREET E

## HIGHLIGHTS

- Opportunity to lease an office/retail unit in the heart of Downtown East
- Character, brick-and-beam flex space
- Unique signage/branding exposure along high-traffic Richmond Street East
- High transit score, only steps away from both King and Queen TTC Streetcars

## DETAILS

<b>AVAILABILITY:</b>	Ground Floor - 2,719 SF
<b>NET RENT:</b>	Negotiable
<b>ADDITIONAL RATE:</b>	\$16.68 PSF (2023 est.)
<b>OCCUPANCY:</b>	Immediately
<b>TERM:</b>	5 to 10 years

## INTERIOR PHOTOS



# FLOOR PLAN

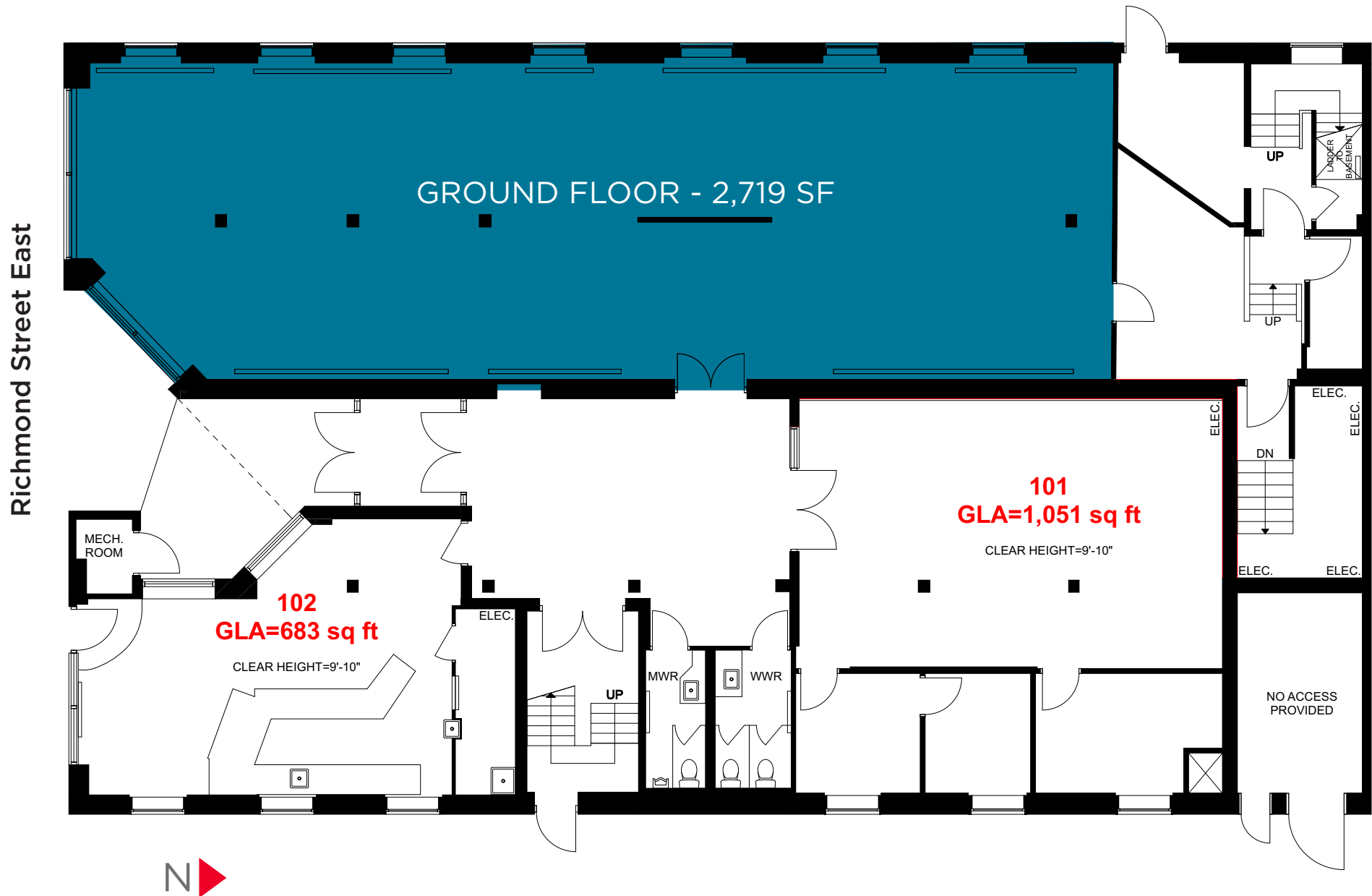

# AREA RETAILERS



HOUSEHOLD INCOME AVERAGE  
\$291,768



DAYTIME POPULATION  
55,800



MEDIAN AGE  
49



POPULATION  
24,170



MEDIAN HOUSEHOLD INCOME  
\$107,038



AVERAGE ANNUAL HOUSEHOLD SPENDING  
\$211,242



WITHIN 1KM RADIUS  
Source: PiinPoint



161 Bay Street, Suite 1500  
Toronto, ON M5J 2S1 | Canada

## LEASING ENQUIRIES

### **Carmen Siegel\***

Associate Vice President  
Retail Services  
+1 416 359 2365  
carmen.siegel@cushwake.com

### **HANNAH KINNEY\***

Associate  
Retail Services  
+1 416 359 2390  
hannah.kinney@cushwake.com

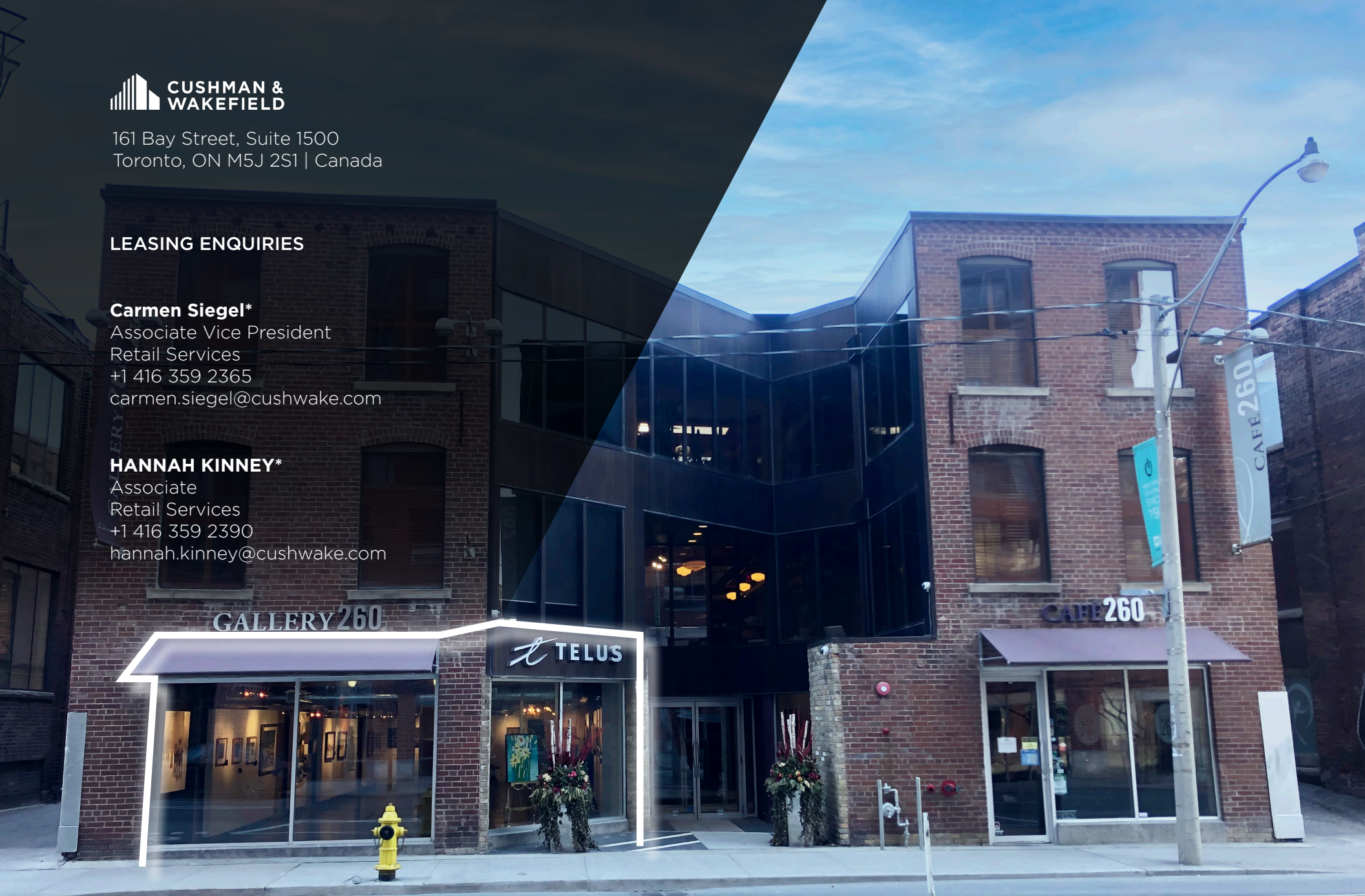

©2023 Cushman & Wakefield ULC. All rights reserved. The information contained in this communication is strictly confidential. This information has been obtained from sources believed to be reliable but has not been verified. NO WARRANTY OR REPRESENTATION, EXPRESS OR IMPLIED, IS MADE AS TO THE CONDITION OF THE PROPERTY (OR PROPERTIES) REFERENCED HEREIN OR AS TO THE ACCURACY OR COMPLETENESS OF THE INFORMATION CONTAINED HEREIN, AND SAME IS SUBMITTED SUBJECT TO ERRORS, OMISSIONS, CHANGE OF PRICE, RENTAL OR OTHER CONDITIONS, WITHDRAWAL WITHOUT NOTICE, AND TO ANY SPECIAL LISTING CONDITIONS IMPOSED BY THE PROPERTY OWNER(S). ANY PROJECTIONS, OPINIONS OR ESTIMATES ARE SUBJECT TO UNCERTAINTY AND DO NOT SIGNIFY CURRENT OR FUTURE PROPERTY PERFORMANCE. \*Sales Representative