

Renovations coming soon!

2301 RESEARCH

Medical and Office Tenants Welcome

Your Sign Here

Move In Ready Medical Suites

- 94,000 SF, 3 story, Class B Medical Office Building
- Located 1.5 Miles from Shady Grove Adventist Hospital (15 minutes from Holy Cross Silver Spring and Germantown Hospitals)
- Ample Free Surface parking
- Name brand mix of healthcare providers, "built-in" referral sources
- Easily accessible from I-270, I-370 & Inter County Connector, Shady Grove Rd & Key West Ave
- Move-In Ready Medical Suites + Build-to-Suit Opportunities
- Public transit stops walking distance
- Building Face and Monument Signage available
- New Tenants eligible for up to \$8psf with Rockville and Montgomery County MOVE programs.

[Rockville Link here](#)

[Montgomery County Link here](#)

Amenities and Highlights

- Newly renovated, state of the art conference room
- Avenue C—convenient grab and go food and beverage area with sit down area
- Convenient Patient Drop-Off area and awning
- Common Area and Exterior Renovations Coming Soon
- Updated electronic Tenant Directory



1.5 Miles from
Shady Grove
Adventist Hospital



Located in the heart
of the I-270 Research
Community and
DNA Alley



Ample Free
Surface Parking



Physician
Community Built-In
Referral Sources

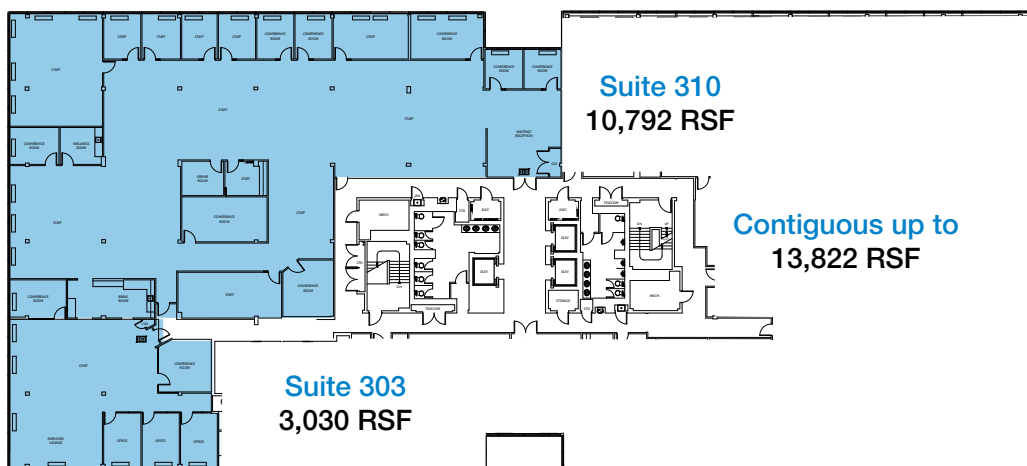
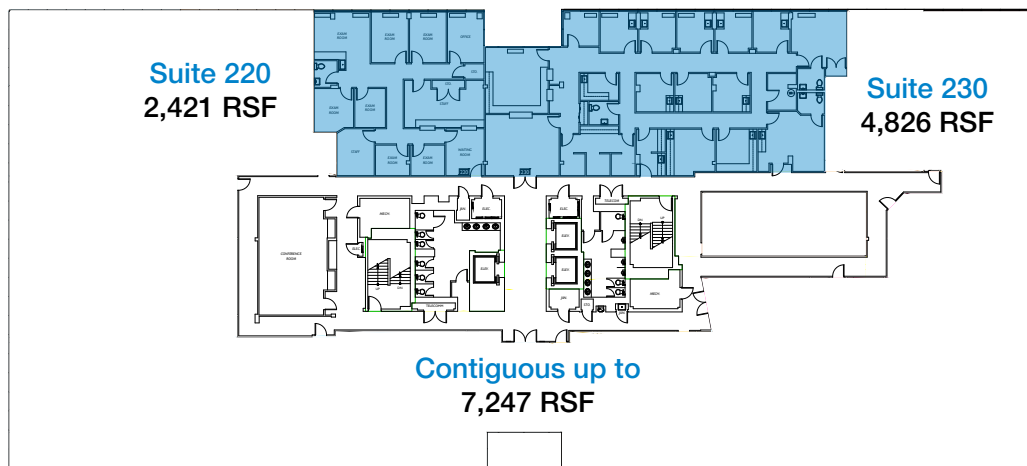
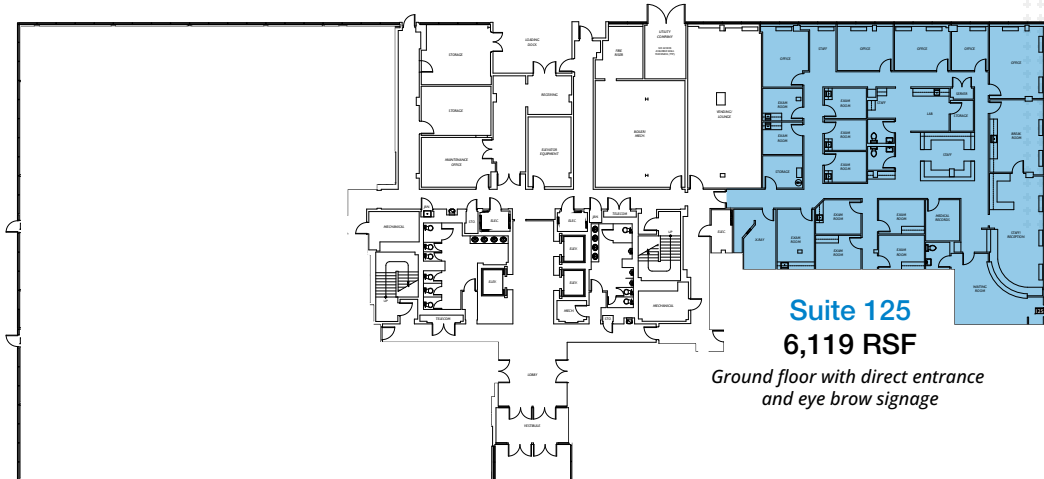

For more information or to schedule a property tour, please contact:

CHAZ FEITEL: 240.694.6109 | chazfeitel@hprgrealty.com

LUKE POULOS: 301.395.7108 | lpoulos@hprgrealty.com

HPRGrealty.com

COMMUNITY
HEALTHCARE
— TRUST —

HPRG HEALTH-PRO+
REALTY GROUP

This document/email has been prepared by HPRG for advertising and general information only. HPRG makes no guarantees, representations or warranties of any kind, expressed or implied, regarding the information including, but not limited to, warranties of content, accuracy and reliability. Any interested party should undertake their own inquiries as to the accuracy of the information. HPRG excludes unequivocally all inferred or implied terms, conditions and warranties arising out of this document and excludes all liability for loss and damages arising there from. This communication is not intended to cause or induce breach of an existing listing agreement.

