

MEDICAL/ PROFESSIONAL

OFFICE FOR LEASE

| | |
|-------------|--------------|
| PRICE | INQUIRE |
| APPROX SIZE | 2,917+/- RSF |
| TERM | NEGOTIABLE |
| POSSESSION | IMMEDIATE |

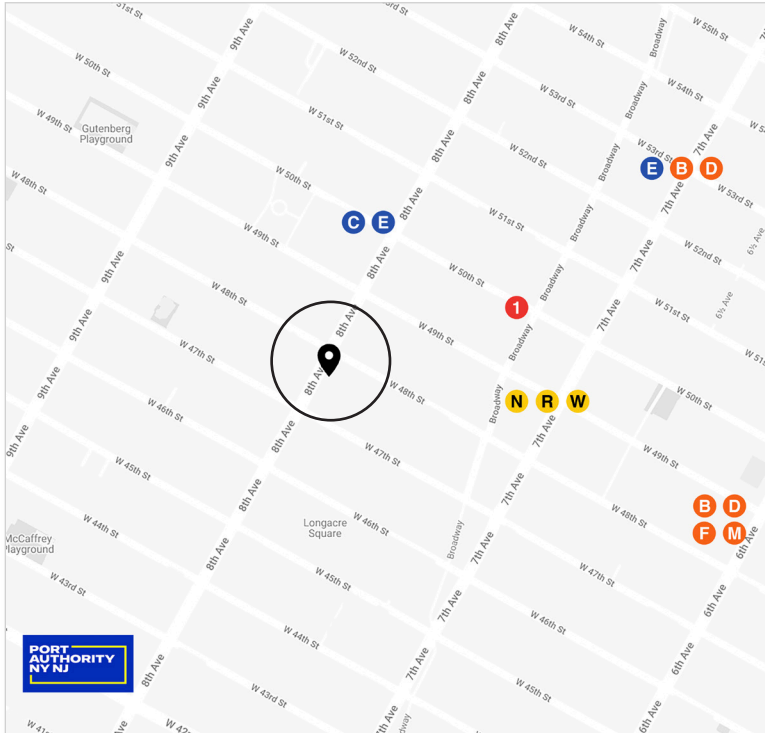

780 8TH AVENUE, SUITE 201

BETWEEN WEST 47TH STREET AND WEST 48TH STREET

VIRTUAL RENDERING

LAYOUT

- FIVE (5) EXAM ROOMS
- TWO (2) CONSULTS/OFFICES
- PROCEDURE ROOM
- RECOVERY ROOM
- WAITING/RECEPTION
- TWO (2) RESTROOMS
- NURSES STATION
- STORAGE ROOM
- STAFF LOUNGE

ADDITIONAL FEATURES

- CENTRAL AIR CONDITIONING
- ADAPTABLE TO ANY MEDICAL SPECIALTY

FLOOR PLAN FOR ILLUSTRATIVE PURPOSES ONLY. ACTUAL SIZES AND DIMENSIONS MAY VARY.

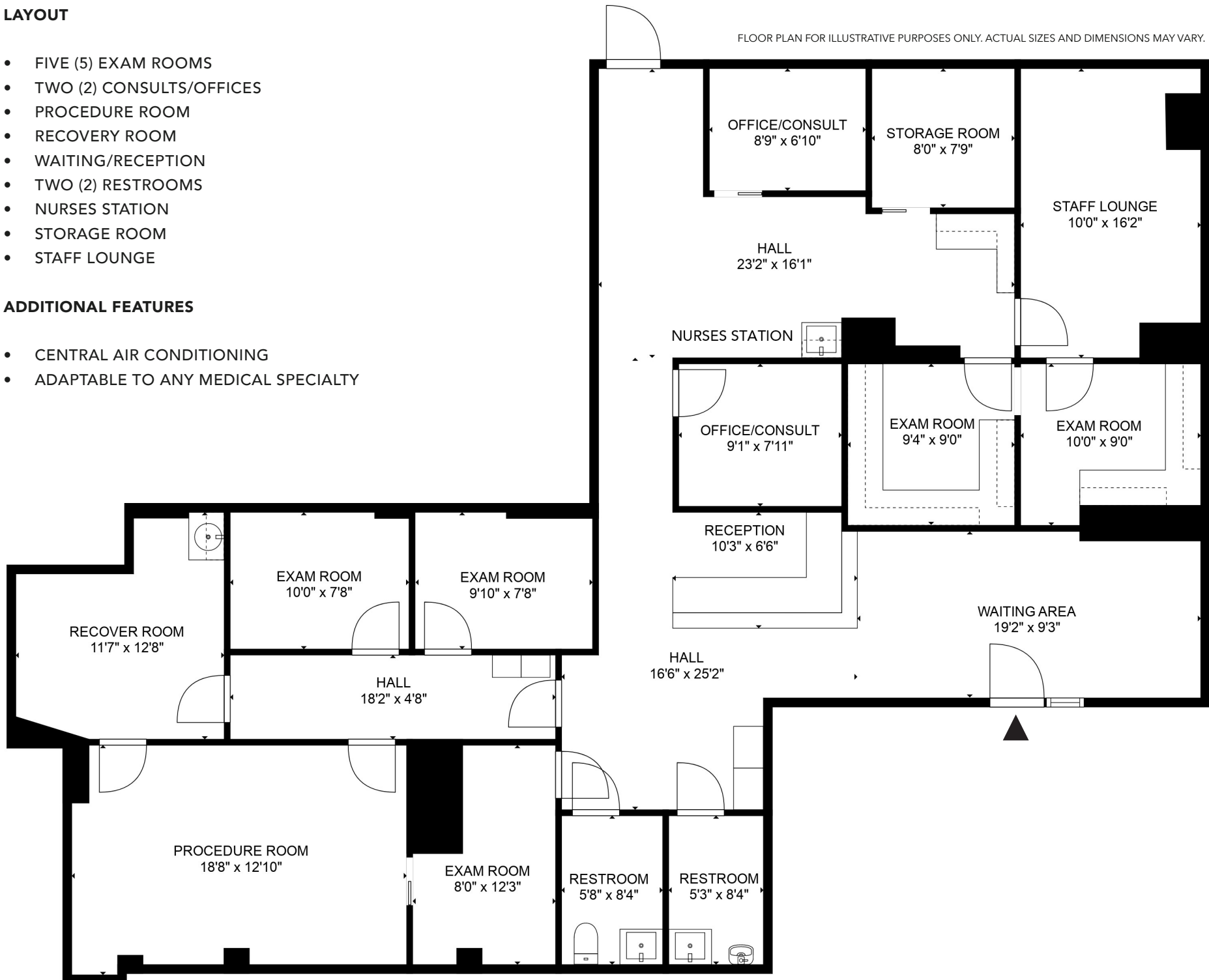



WEXLER HEALTHCARE & COMMERCIAL
PROPERTIES
TEAM AT THE CORCORAN GROUP
HEALTHCARE-PROPERTIES.COM



Paul L Wexler

LICENSED ASSOCIATE
REAL ESTATE BROKER

P: 212.836.1075
E: PWexler@corcoran.com

Josef Yadgarov

LICENSED ASSOCIATE
REAL ESTATE BROKER

P: 212.836.1097
E: josef.yadgarov@corcoran.com

Elliot Dennis

LICENSED REAL ESTATE
SALESPERSON

P: 212.893.1746
E: elliot.dennis@corcoran.com

Alisia Ramlochan

LICENSED ASSOCIATE
REAL ESTATE BROKER

P: 212.893.1450
E: alisia.ramlochan@corcoran.com

Kurt Herold

LICENSED ASSOCIATE
REAL ESTATE BROKER

P: 212.323.3817
E: kherold@corcoran.com

Cosmin Bită

LICENSED REAL ESTATE
SALESPERSON

P: 917.602.5754
E: cosmin.bită@corcoran.com