

**GREELEY WEST - MIXED USE**  
**GREELEY, CO**

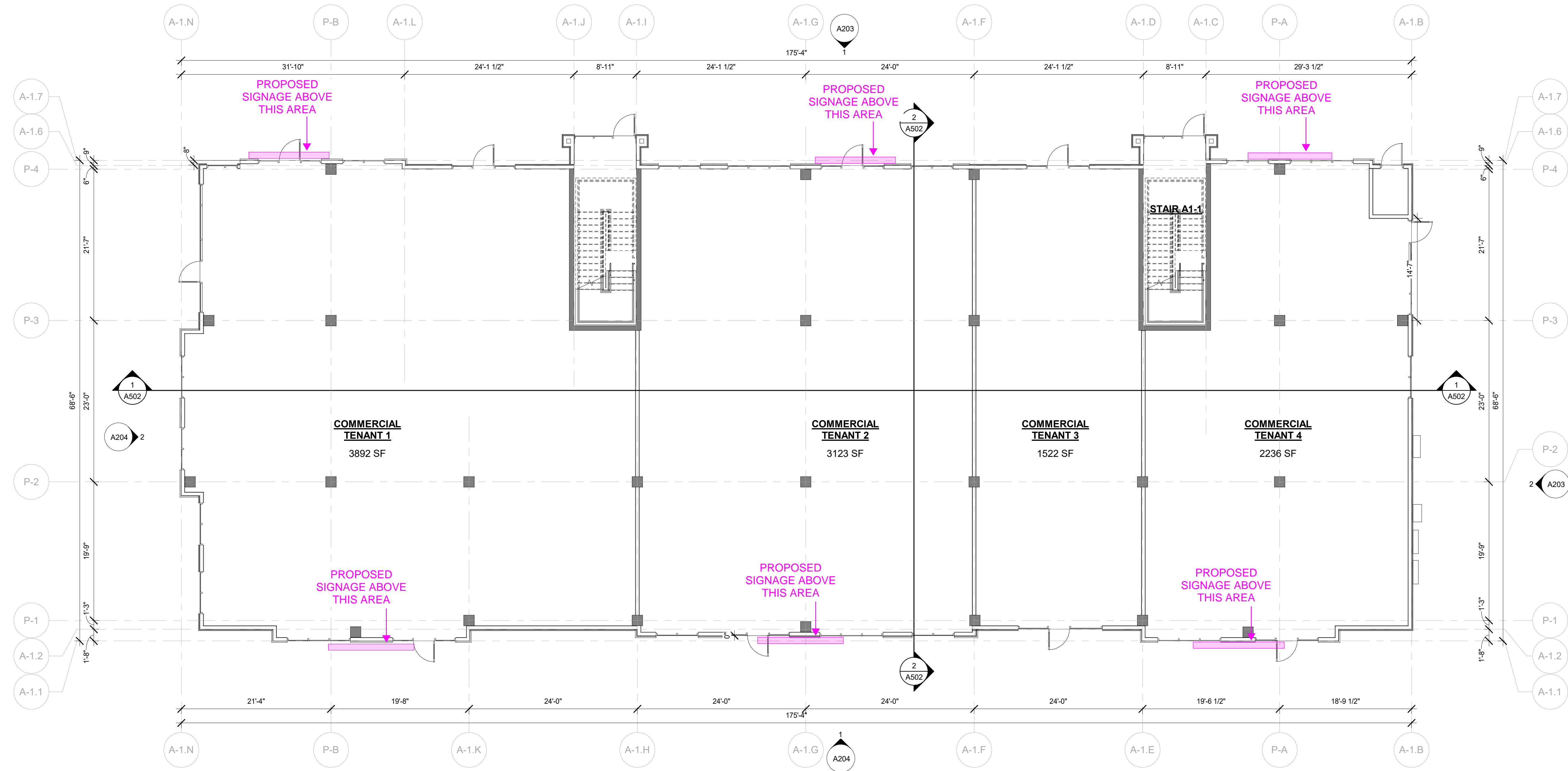

**1 BUILDING A-1 - LEVEL 1**  
A102.11 1/8" = 1'-0"

- OVERALL PLAN GENERAL NOTES**
- REFER TO SLAB PLANS FOR BUILDING STEPS, SLAB SLOPES AND SLAB ELEVATIONS.
  - DIMENSIONS ARE TO OUTSIDE OF STUD WALLS, CONCRETE WALLS, CMU, OR CENTERLINE OF TENANT SEPARATION WALLS UNLESS NOTED OTHERWISE.
  - REFER TO ENLARGED UNIT PLANS FOR DETAILED DIMENSIONS, WALL TYPES, AND ADDITIONAL DOOR INFORMATION.
  - REFER TO WALL ASSEMBLY PAGES FOR WALL ASSEMBLY INFORMATION.
  - REFER TO CODE ANALYSIS SHEETS FOR EXITING INFORMATION.
  - WINDOW AND DOOR DIMENSIONS ARE TO CENTERLINE OF WINDOWS AND DOORS.
  - ALL MATERIAL TRANSITIONS OCCUR AT INSIDE CORNERS, TYPICAL UNLESS NOTED OTHERWISE.
  - REFER TO EXTERIOR ELEVATIONS FOR EXTERIOR MATERIAL LOCATIONS.
  - REFER TO ACCESSIBILITY DETAIL SHEETS FOR DETAIL OF REQUIRED CANE DETECTION RAIL UNDER ALL EXTERIOR STAIRS, TYPICALLY.
  - ACCESSIBLE TYPE 'A' UNIT PLAN INDICATED BY ACCESSIBLE SYMBOL DENOTES BUILDING WHERE OCCURS - REFER TO ENLARGED DETAIL PLAN FOR UNIT VARIATIONS AT TYPE 'A' ACCESSIBLE UNIT.

**ROOF PLAN LEGEND**

	DRAFTSTOP DOOR IN ATTIC, SELF CLOSING WITH AUTOMATIC LATCH, IBC 718.4.1.1, RE: 1/FA742		DRAFTSTOPPING IN ATTIC (ROOF AREA BOUNDARIES)
	SOFFIT VENT (DIAGRAMMATICALLY SHOWN, INSTALL VENT WITHIN EAVE. DOUBLE UP VENTS AS SHOWN ON PLANS)		ICE AND WATER SHIELD AT ROOF EDGES - EXTEND FROM LOWEST POINT OF ROOF TO 24" BEYOND INSIDE FACE OR EXTERIOR WALL AND 24" EITHER SIDE OF VALLEYS OR BREAKS IN ROOF PITCH. INSTALL FULL LAYER OF ICE AND WATER SHIELD AT ALL AREAS WHERE ROOF SLOPE IS LESS THAN 4:12 PITCH
	METAL DOME POP UP ROOF VENT		ASPHALT SHINGLE ROOF
	INDICATES DIRECTION OF ROOF SLOPE		ATTIC ACCESS HATCH MIN. 20"x30" CLEAR
	INDICATES STEP IN ROOF		ATTIC ACCESS PLATFORM TO CONNECT ALL ATTIC ACCESS HATCHES.
	DOWNSPOUT RE: ELEVATIONS, BUILDING LAYOUTS, SITE PLAN & CIVIL		3/4" PLYWOOD OVER WOOD FRAMING. SIZE AS NECESSARY.
			FACE OF FRAMING OF WALL BELOW

**KEYNOTES**

#	KEYNOTE DESCRIPTION

**LAYOUT LEGEND:**

	TYPE A UNIT
	FLOOR DRAIN SLOPE TO DRAIN, RE: PLBG
	ATTIC ACCESS HATCH, RE: ROOF PLANS
	TEMPERED GLASS

No.	Description	Date

CURRENT PHASE  
**COORDINATION**

ISSUE DATE  
09/07/2023

KEY PLAN

SHEET TITLE  
**BUILDING A-1 OVERALL PLAN - LEVEL 1**

SHEET NUMBER  
**A102.11**







**ELEVATION GENERAL NOTES**

- ALL EXTERIOR COLORS AND LOCATIONS TO BE DETERMINED BY ARCHITECT.
- REFER TO ARCHITECTURAL BUILDING LAYOUTS, SITE PLAN & CIVIL FOR SPECIFIC DOWNSPOUT LOCATIONS. REFER TO SHEET 14/A701 FOR CONNECTION DETAILS TO THE LANDSCAPE DRAINS IDENTIFIED ON THE CIVIL AND LANDSCAPE PLANS.
- FINISHED GRADE AT ALL ELEVATIONS SHALL BE SLOPED TO PROVIDE A MIN. OF 6" OF FALL WITHIN 10' OF THE FINISHED FACE OF THE BUILDING, RE: CIVIL GRADING PLANS.
- ALL CLADDINGS MUST BE HELD ABOVE GRADE ACCORDING TO MANUFACTURER AND CODE REQUIREMENTS:
  - CEMENTITIOUS CLADDING: 2" ABOVE PAVING
  - UNTREATED WOOD (INCLUDING WOOD SHEATHING): 8" ABOVE EXPOSED EARTH
- MATERIALS, FINISH AND CLADDING INDICATED IN THE FOREGROUND SHALL RETURN BACK TO THE NEXT PLANE AT THE INSIDE CORNER.
- ALL FLASHING AND COPING SHALL BE 24 GA. U.N.O. IN DETAILS
- FOR ALL EXTERIOR WALL PENETRATION DETAILS, RE: SHEET A714

**KEYNOTES**

#	KEYNOTE DESCRIPTION
---	---------------------



**2 BUILDING A-1 LEFT ELEVATION**  
A204 1/8" = 1'-0"



**1 BUILDING A-1 - REAR ELEVATION**  
A204 1/8" = 1'-0"

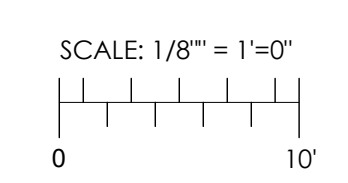

**GREELEY WEST - MIXED USE**

GREELEY, CO

No.	Description	Date
-----	-------------	------

CURRENT PHASE  
**COORDINATION**

ISSUE DATE 09/07/2023

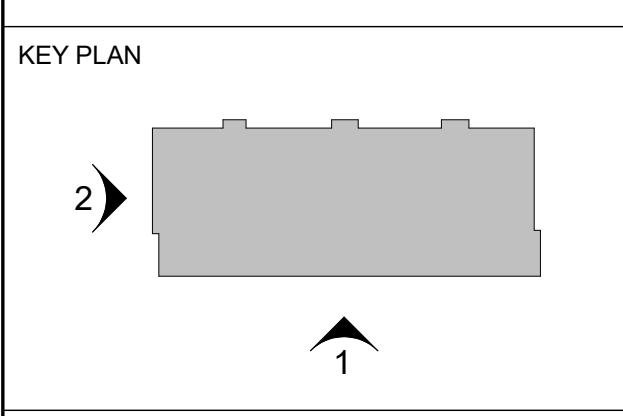

SHEET TITLE  
**BUILDING A-1 ELEVATIONS**

SHEET NUMBER  
**A204**





1 3D VIEW - NORTHEAST  
A205



3 3D VIEW - SOUTHEAST  
A205



4 3D VIEW - SOUTHWEST  
A205



2 3D VIEW - NORTHWEST  
A205



5 3D VIEW - FRONT OVERALL  
A205

GRADING SHOWN FOR ILLUSTRATIVE PURPOSES ONLY. PLEASE REFER TO CIVIL GRADING FOR ACTUAL TOPOGRAPHY. GAS METERS, ELECTRIC METERS, AND WATER ENTRY ROOMS SHOWN FOR ILLUSTRATIVE PURPOSES AND VARY PER INSTANCE ON SITE. REFER TO FLOOR PLANS AND ELEVATIONS FOR SPECIFIC LOCATIONS PER INSTANCE.

**GREELEY WEST - MIXED USE**  
**GREELEY, CO**

No.	Description	Date
-----	-------------	------

CURRENT PHASE  
**COORDINATION**

ISSUE DATE  
09/07/2023

KEY PLAN

SHEET TITLE  
**BUILDING A  
AXONOMETRICS**

SHEET NUMBER  
**A205**