



SALE PRICE: UNDISCLOSED

Rowan Middle School (Jackson Public Schools)

136 East Ash Street, Jackson, MS 39202

Brian Estes, CCIM, CPM
601.906.8999
brian@estesgroup.net

Jimmy Kitchens
601.955.6434
jimmy@estesgroup.net

Brian Chadwick
601.573.2782
bchadwick@estesgroup.net

PO Box 1220
Madison, MS 39130
601.362.9633
estesgroup.net

Rowan Middle School (Jackson Public Schools)

136 East Ash Street, Jackson, MS 39202

Estes
GROUP
INVESTMENT REAL ESTATE

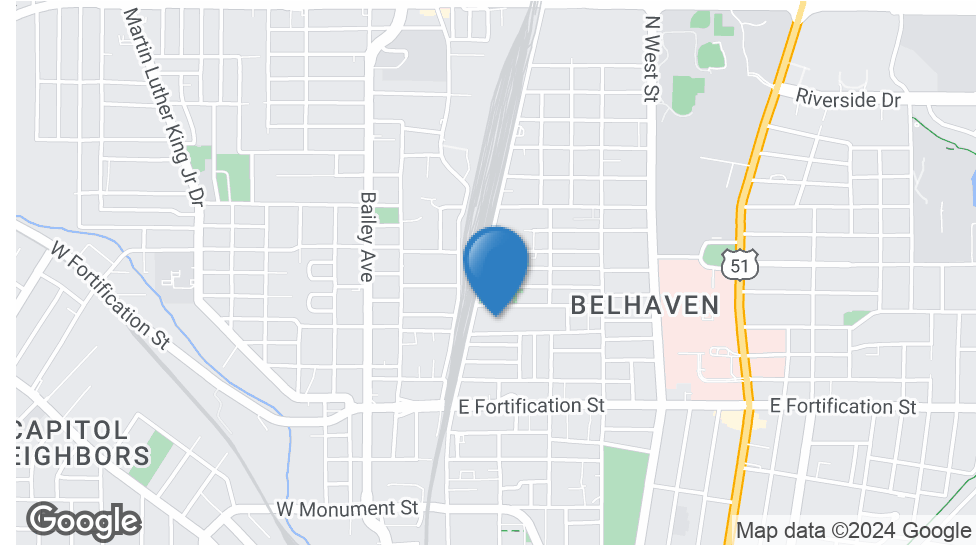

OFFERING SUMMARY

Sale Price:	Undisclosed
Building Size:	82,315 SF
Year Built:	1962
Lot Size:	3.4 Acres
Zoning:	SUD (Special Use District)
Year Built:	1962

PROPERTY OVERVIEW

Two-story building formerly Rowan Middle School (Jackson Public Schools).

This property is part of the JPS Repurposing Initiative. The initiative was created to help promote the reuse and redevelopment of the JPS surplus school sites. The primary goal is to spur redevelopment of surplus and undeveloped properties, ensuring that they are transformed into valuable assets that contribute to the growth and prosperity of Jackson's neighborhoods.

Brian Estes, CCIM, CPM
601.906.8999
brian@estesgroup.net

Jimmy Kitchens
601.955.6434
jimmy@estesgroup.net

Brian Chadwick
601.573.2782
bchadwick@estesgroup.net

PO Box 1220
Madison, MS 39130
601.362.9633
estesgroup.net

Rowan Middle School (Jackson Public Schools)

136 East Ash Street, Jackson, MS 39202



Brian Estes, CCIM, CPM
601.906.8999
brian@estesgroup.net

Jimmy Kitchens
601.955.6434
jimmy@estesgroup.net

Brian Chadwick
601.573.2782
bchadwick@estesgroup.net

PO Box 1220
Madison, MS 39130
601.362.9633
estesgroup.net

Rowan Middle School (Jackson Public Schools)

136 East Ash Street, Jackson, MS 39202

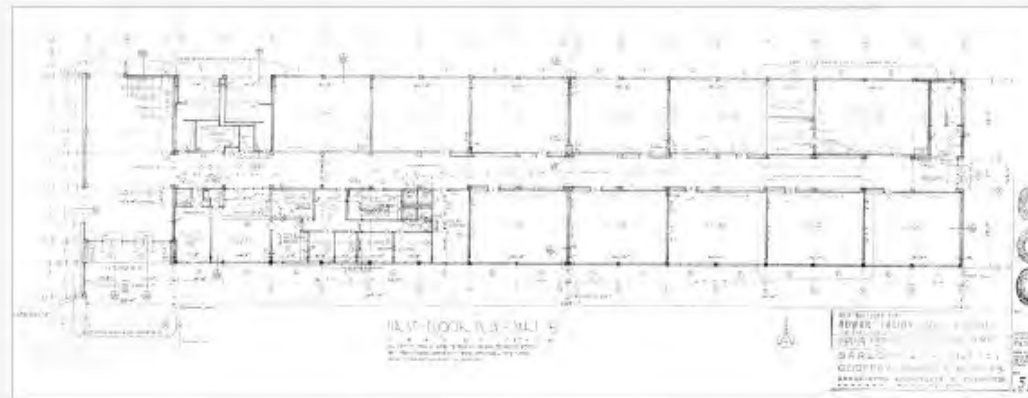
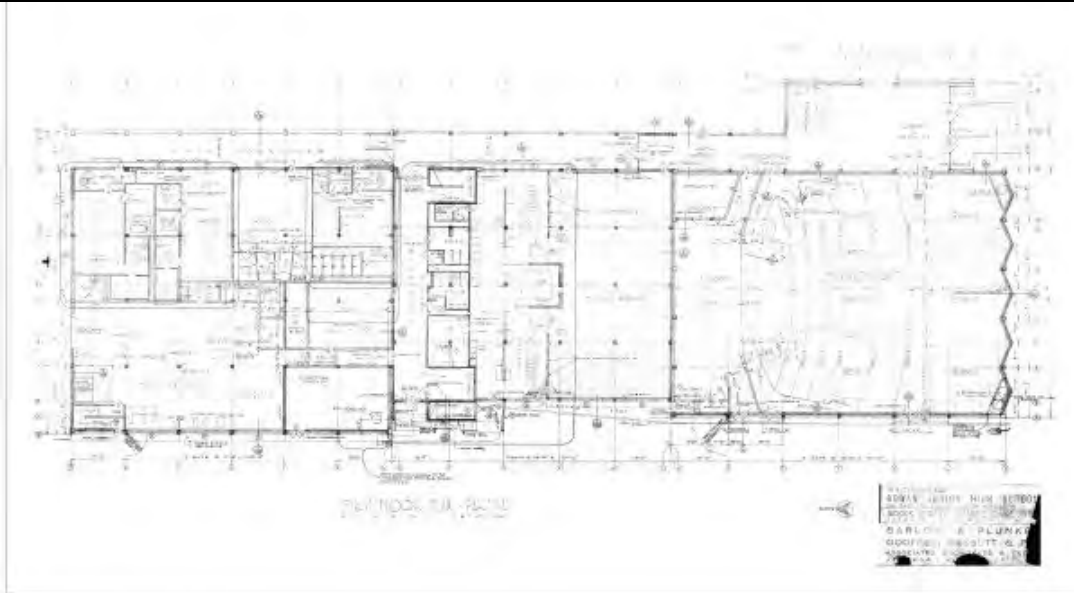

Rowan Middle School (Jackson Public Schools)

136 East Ash Street, Jackson, MS 39202

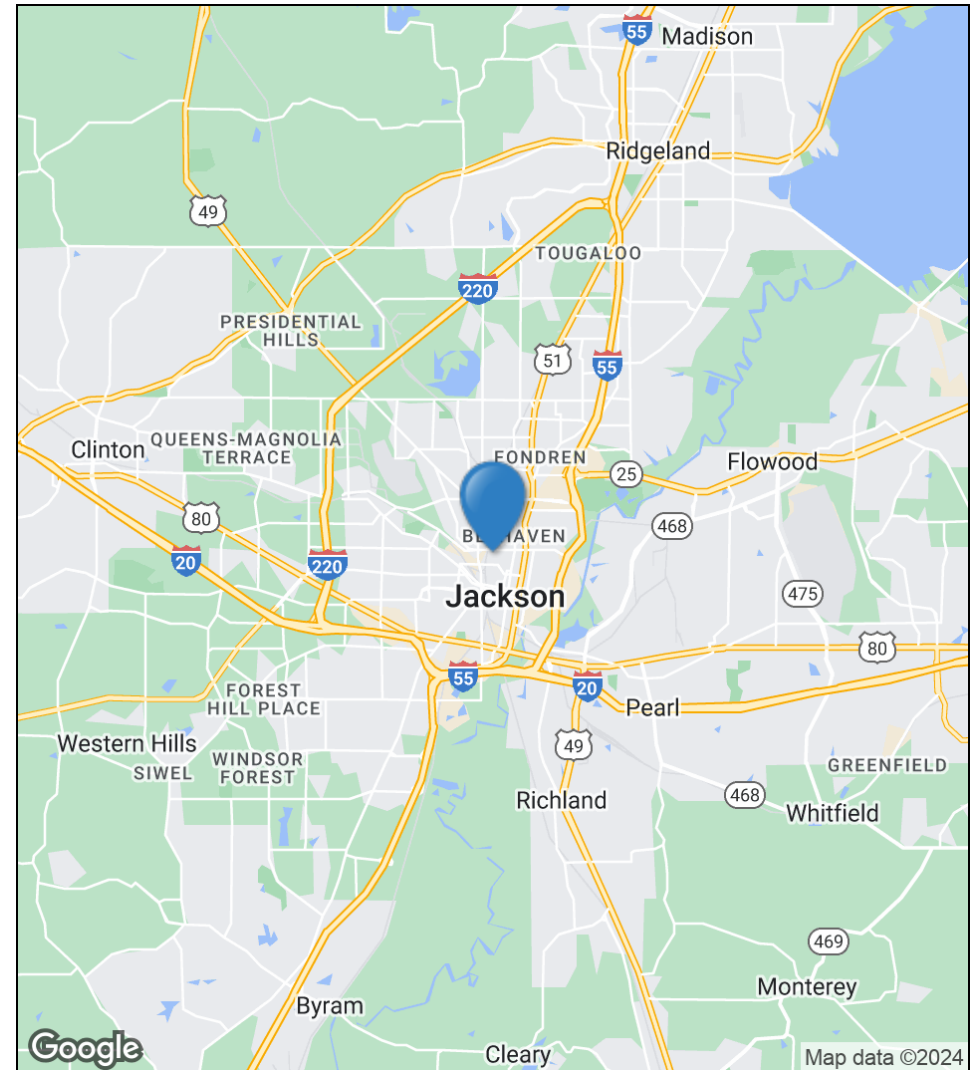
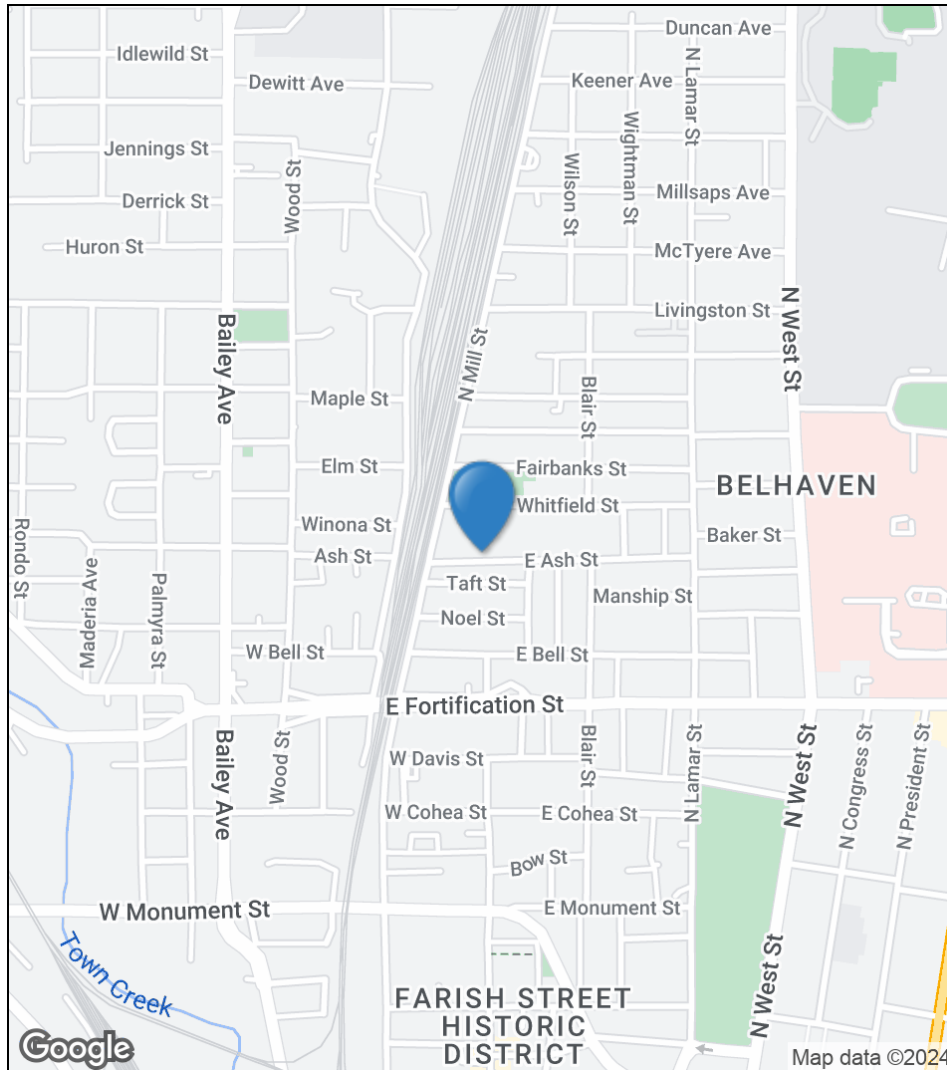

Rowan Middle School (Jackson Public Schools)

136 East Ash Street, Jackson, MS 39202

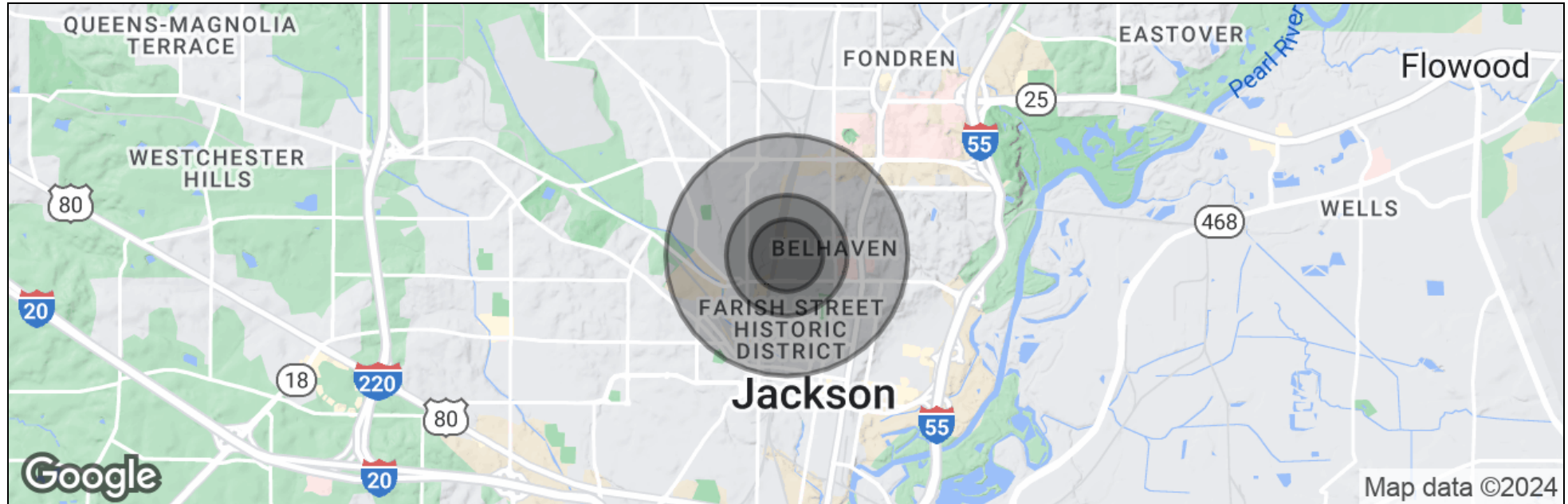

	0.3 Miles	0.5 Miles	1 Mile
Total Population	465	2,003	7,346
Population Density	1,645	2,550	2,338
Median Age	41	38	39
Median Age (Male)	39	37	38
Median Age (Female)	42	40	40
Total Households	211	817	3,399
# of Persons Per HH	2.2	2.5	2.2
Average HH Income	\$35,980	\$32,244	\$38,367
Average House Value	\$102,260	\$164,647	\$190,917

* Demographic data derived from 2020 ACS - US Census

Brian Estes, CCIM, CPM
601.906.8999
brian@estesgroup.net

Jimmy Kitchens
601.955.6434
jimmy@estesgroup.net

Brian Chadwick
601.573.2782
bchadwick@estesgroup.net

PO Box 1220
Madison, MS 39130
601.362.9633
estesgroup.net