



**GIUSEPPE NOTARO**  
— COMMERCIAL REAL ESTATE FIRM —



**FOR LEASE**  
**321-388-6047**



**HOWELL BRANCH SQUARE**

2075 Howell Branch Road  
Maitland Florida



## Property Highlights

Flexible spaces ideal for medical, retail, restaurant, and professional use.

- ✓ Brand-New Multi-Tenant Plaza with High Visibility
- ✓ Suites available from 1,484 SF up to 10,468 SF
- ✓ Premium End-Cap Restaurant Space
  - Delivered with underground grease trap
  - Glass roll-up doors + outdoor seating area

- ✓ Strategic Frontage on Howell Branch Rd
  - 2024 Traffic Count: 28,000 AADT (FDOT)
  - Strong exposure in high-demand corridor
- ✓ Centrally located to serve
  - Maitland | Casselberry | Altamonte Springs | Winter Park

# FOR LEASE



## HOWELL BRANCH SQUARE



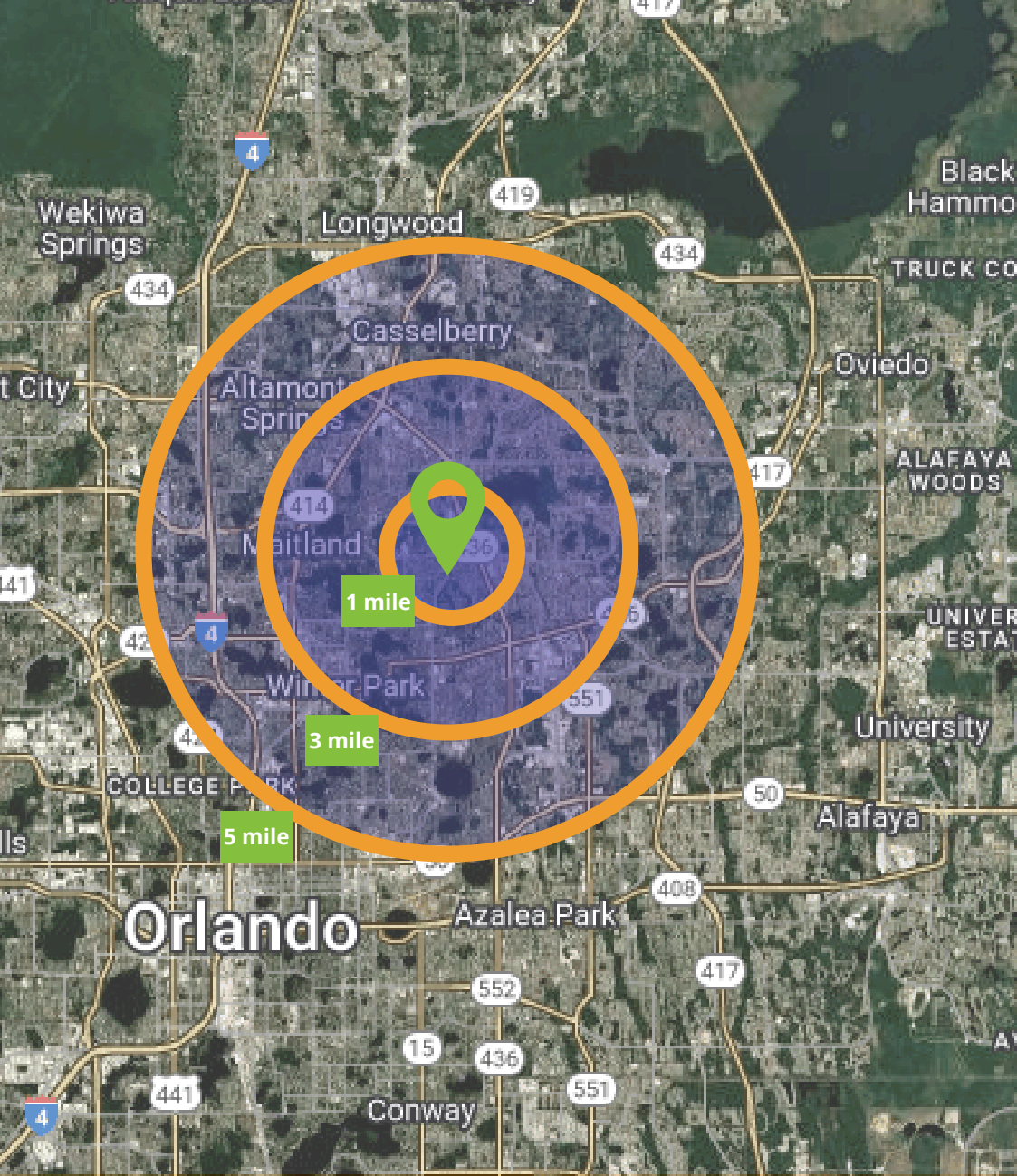

## Drivetime

**Downtown Orlando:** 23 minutes (11 miles)

**Orlando International Airport:** 27 minutes (22 miles)

**Universal Studios:** 33 minutes (20 miles)

**Disney World:** 47 minutes (35 miles)

**Downtown Kissimmee:** 49 minutes (35 miles)

## Demographics

### 1 MILE

Average HH income: \$101,617

### 2 MILE

Average HH income: \$99,845

### 3 MILE

Average HH income: \$99,912

# FOR LEASE



## HOWELL BRANCH SQUARE



# FOR LEASE



## HOWELL BRANCH SQUARE

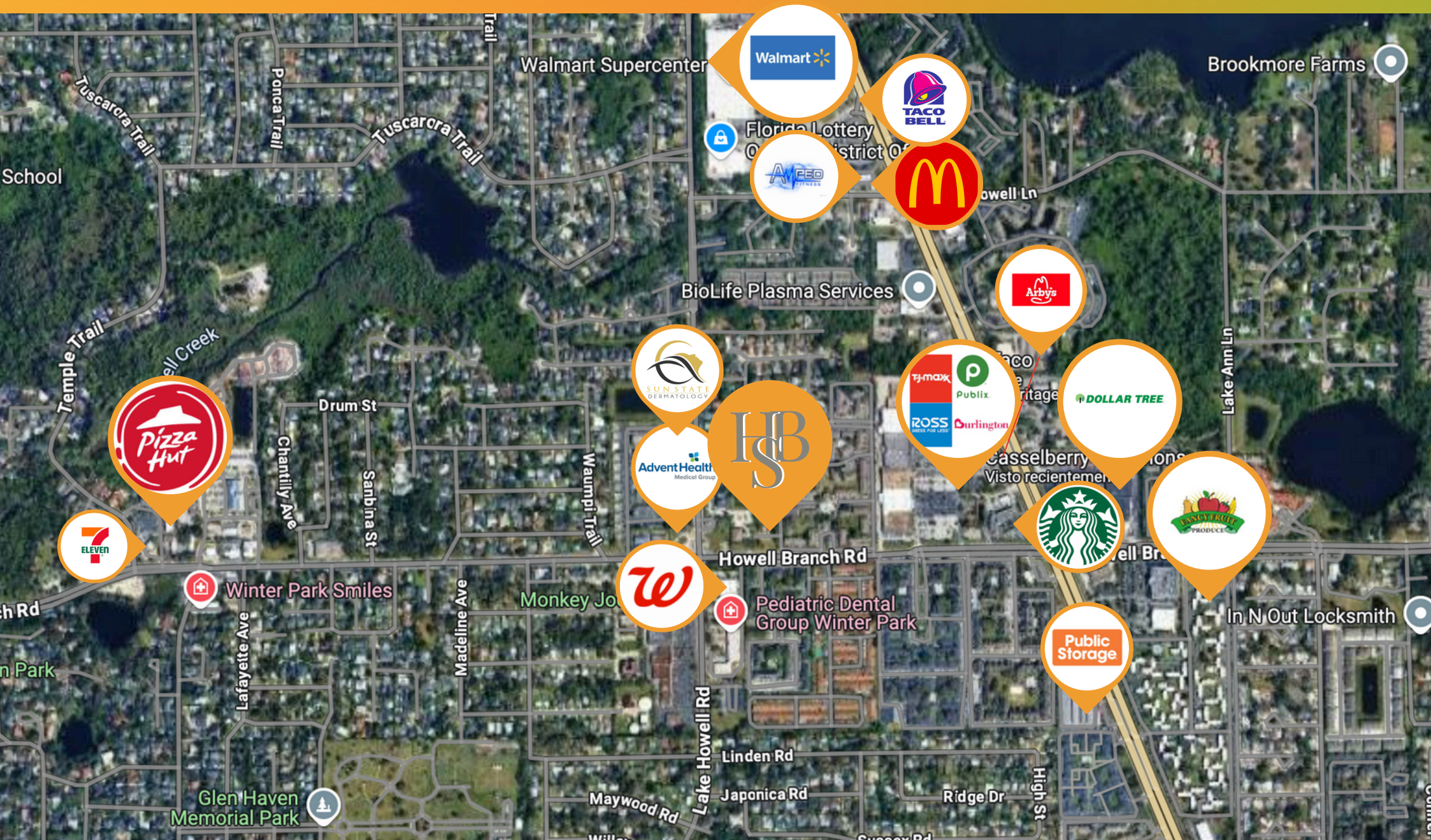



# Building Plan

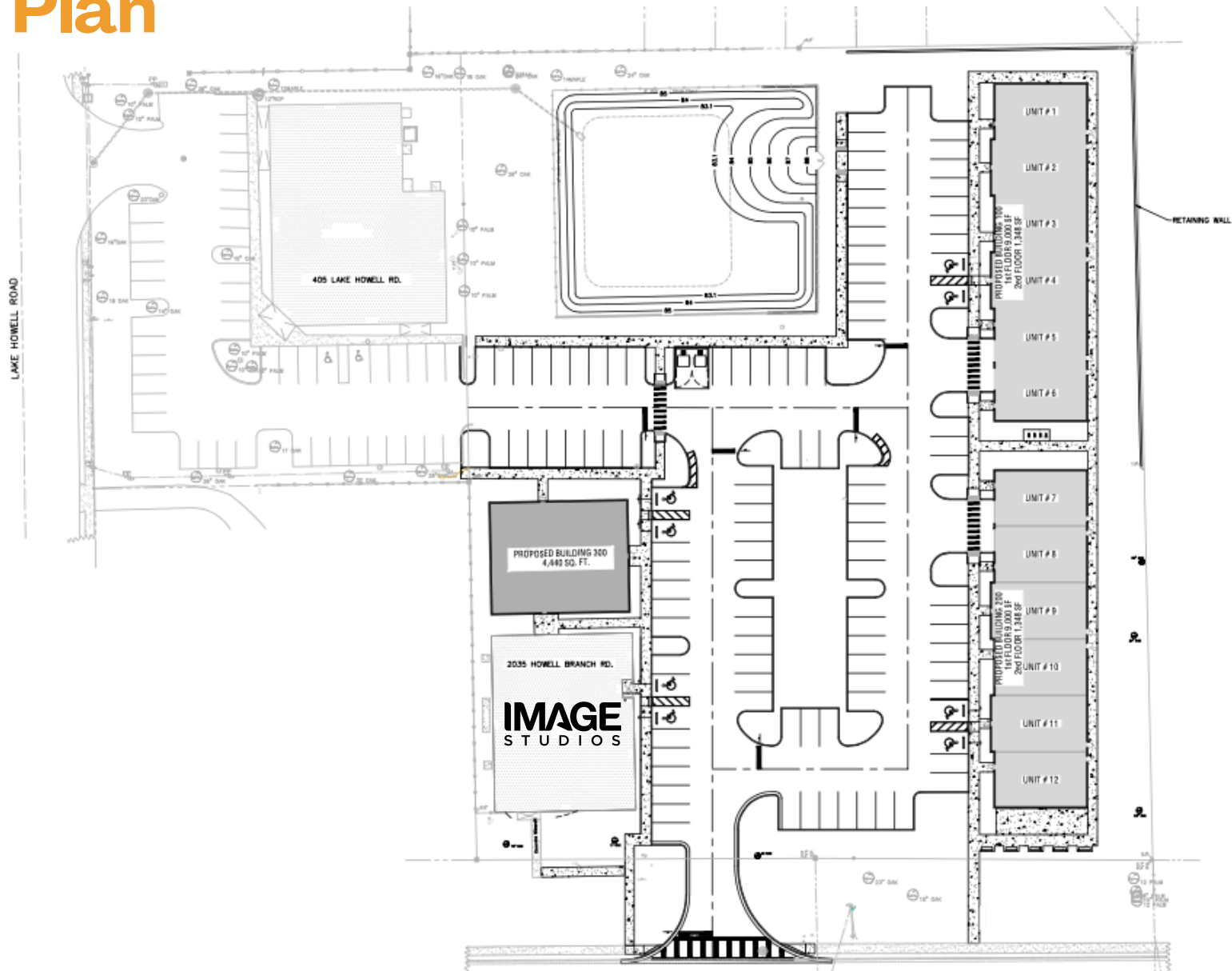

# FOR LEASE



# HOWELL BRANCH SQUARE

