



FOR LEASE

36111-36119 SCHOOLCRAFT ROAD LIVONIA, MICHIGAN 48150

Presented by Friedman Real Estate | 248.324.2000 | friedmanrealestate.com



Robert Gagniuk
robert.gagniuk@freg.com



Jordan Friedman
jordan.friedman@freg.com



Rylee Bates
rylee.bates@freg.com



WESTWOOD MEDICAL PARK PROPERTY HIGHLIGHTS

- Westwood Medical Park is a medical office building in a park-like setting
- Located immediately off I-96 with direct access
- Office campus setting with interior courtyard between buildings
- Individual suites available ranging from $\pm 2,000$ SF to $\pm 22,000$ SF
- Full building available for up to $\pm 32,000$ SF
- M-1 zoning offers maximum flexibility for office, medical, or tech users
- Building façade signage visible from I-96 with traffic counts in excess of 125k vehicles per day
- Proximity to many restaurants, hotels, and area amenities

PROPERTY OVERVIEW

eCode	347
Property Type	Office Medical
Total SF	$\pm 32,400$ SF
Year Built	1986
Parking Ratio (per 1,000 SF)	4:33

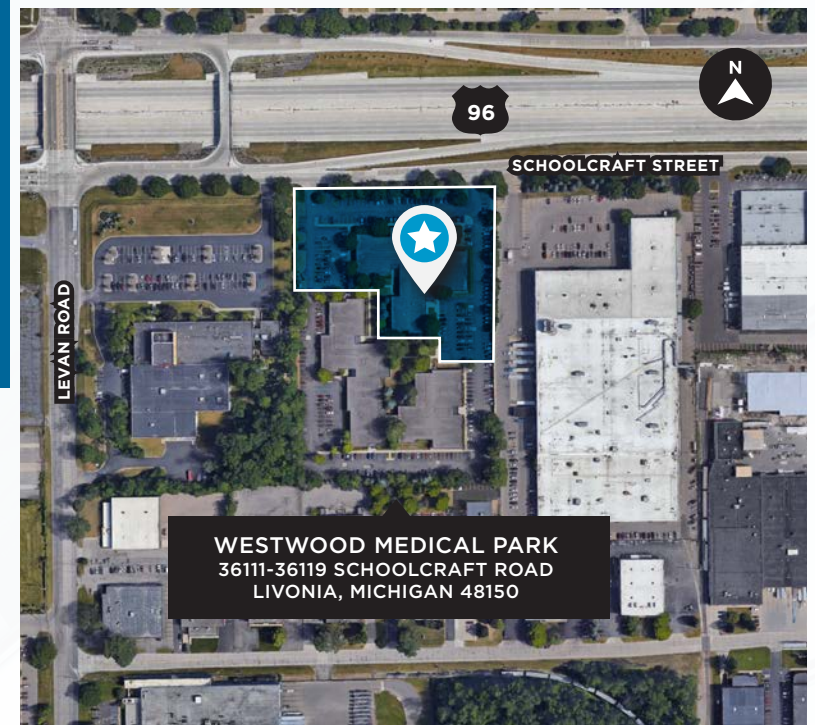

INTERIOR PHOTOS



INTERIOR PHOTOS



EXTERIOR PHOTOS



WESTWOOD MEDICAL PARK SITE PLAN

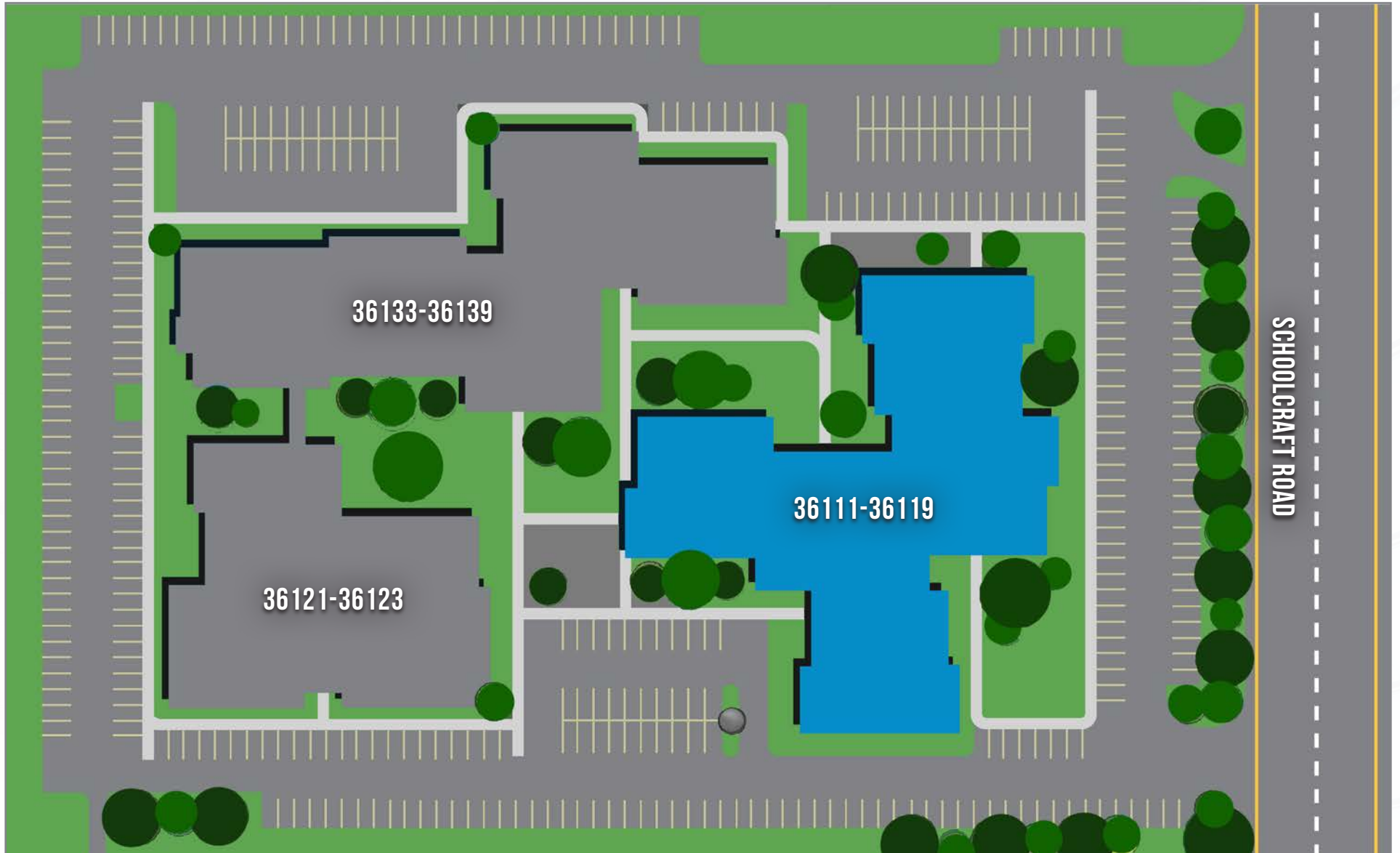

WESTWOOD MEDICAL PARK FLOOR PLAN

30,532 SF
FULL BUILDING AVAILABLE



36111-36119 SCHOOLCRAFT ROAD

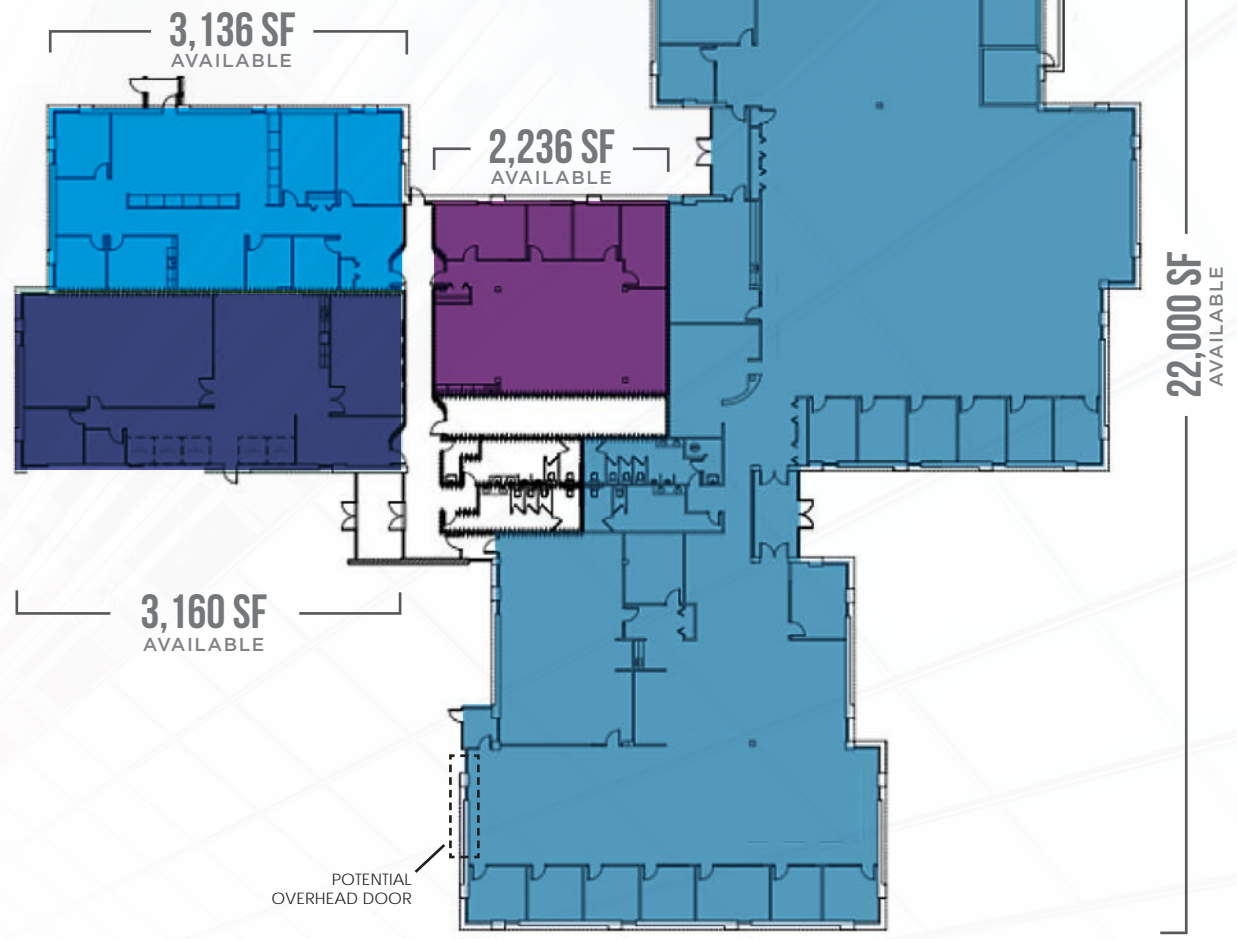

36111-36119 SCHOOLCRAFT ROAD

WESTWOOD MEDICAL PARK AERIAL OVERVIEW



SCHOOLCRAFT ROAD

36133-36139

36111-36119

36121-36123

INDUSTRIAL ROAD

LEVAN ROAD

WESTWOOD MEDICAL PARK LOCAL DRIVE TIMES



DISTANCE TO WESTWOOD MEDICAL PARK	
Ann Arbor	22 Miles
Auburn Hills	33 Miles
Dearborn	17 Miles
Detroit	21 Miles
Detroit Metro Airport	20 Miles
Lansing	73 Miles
Plymouth	4 Miles
Troy	35 Miles
Warren	30 Miles
Windsor	26 Miles

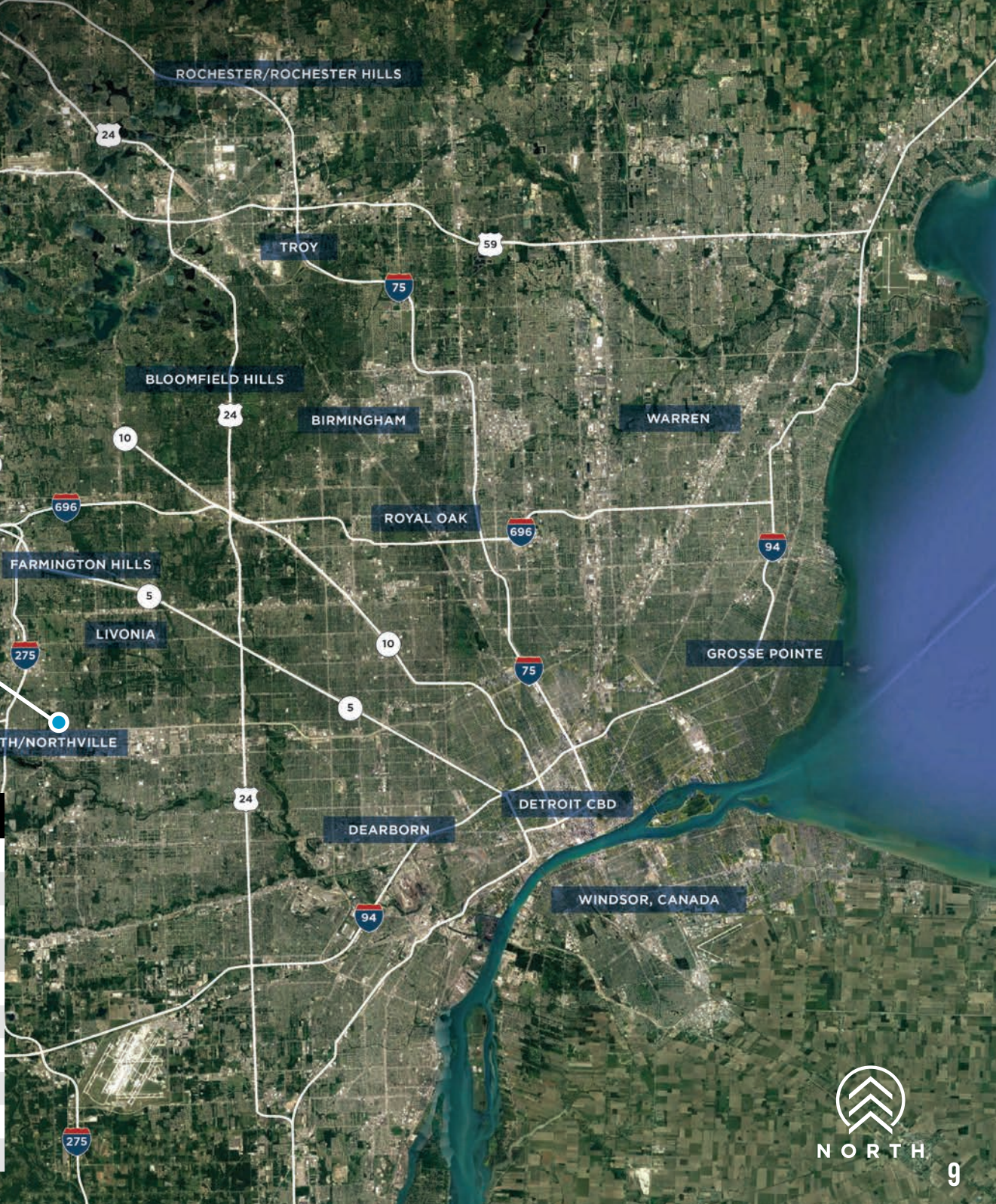



Westwood
Medical Park

FOR LEASE

36111-36119 SCHOOLCRAFT ROAD LIVONIA, MICHIGAN 48150

Presented by Friedman Real Estate | 248.324.2000 | friedmanrealestate.com



Robert Gagniuk
robert.gagniuk@freg.com



Jordan Friedman
jordan.friedman@freg.com



Rylee Bates
rylee.bates@freg.com



LEARN MORE

