

Warehouse with Fenced Yard For Lease

**CBRE**

# 5419 SW 27th Street

Oklahoma City, OK 73179



**Jason Hammock, SIOR, CCIM**

First Vice President

+1 405 315 0725

[jason.hammock@cbre.com](mailto:jason.hammock@cbre.com)

**Caitlin Mazaheri, SIOR, CCIM**

Vice President

+1 405 413 2315

[caitlin.mazaheri@cbre.com](mailto:caitlin.mazaheri@cbre.com)

**Joe Summers**

Senior Associate

+1 405 831 6851

[joe.summers@cbre.com](mailto:joe.summers@cbre.com)

# Warehouse with Fenced Yard For Lease



## Property Details

- + Total Available SF: 22,765± SF
- + Total Land Size: 1.5± AC
- + Built in 2011
- + I-2 Zoning
- + Clear Height: 20' - 28'
- + Fully Fenced Concrete Yard
- + 3-Phase Power
- + Multiple Cranes
- + Less than 5 miles to Will Rogers World Airport
- + Easy access to I-40, I-44, & Kilpatrick Turnpike

**Lease Rate:**  
**\$6.95 PSF NNN**

© 2024 CBRE, Inc. All rights reserved. This information has been obtained from sources believed reliable, but has not been verified for accuracy or completeness. You should conduct a careful, independent investigation of the property and verify all information. Any reliance on this information is solely at your own risk. CBRE and the CBRE logo are service marks of CBRE, Inc. All other marks displayed on this document are the property of their respective owners, and the use of such logos does not imply any affiliation with or endorsement of CBRE. Photos herein are the property of their respective owners. Use of these images without the express written consent of the owner is prohibited.

# 5419 SW 27th Street

Oklahoma City, OK 73179



## Building Details

- + Building Size: 17,915± SF
- 1,750± SF Office Space
- + Clear Height: 28'

- + (2) 10-Ton Bridge Cranes
- + (2) 16' Overhead Doors
- + (1) 12' x 16' Drive-In Doors
- + 100% Climate Controlled

- + Large Breakroom
- + Floor Drains

# 5419 SW 27th Street

Oklahoma City, OK 73179

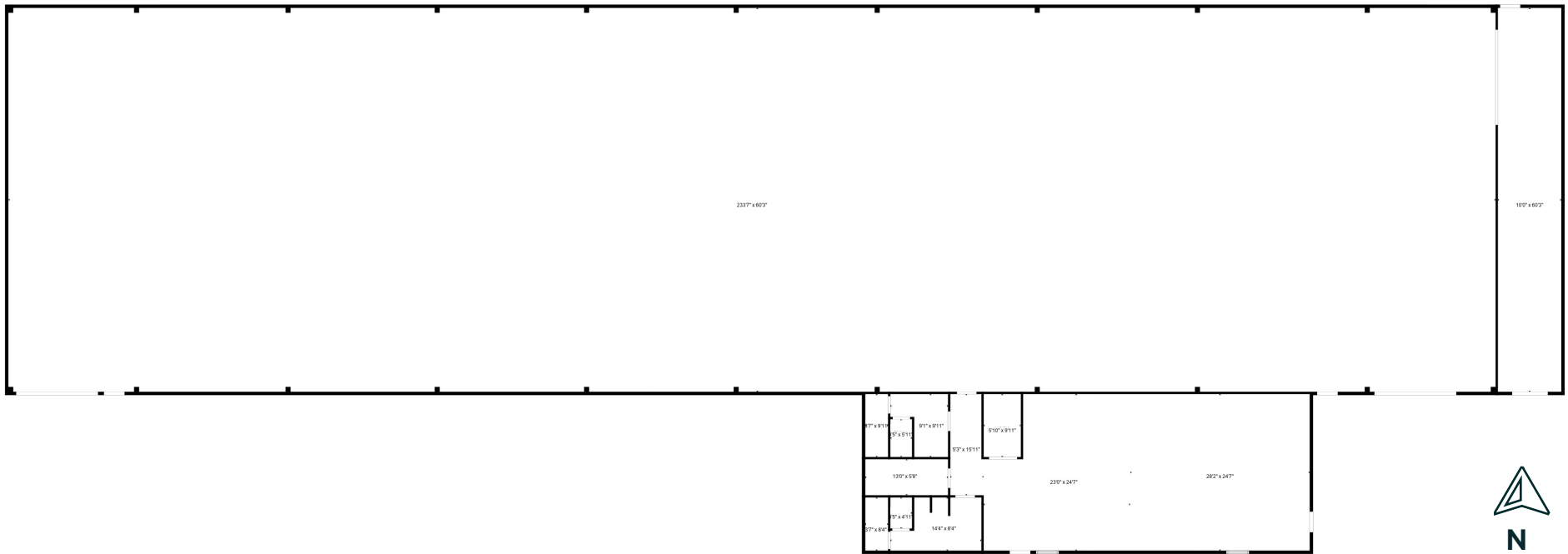

**Jason Hammock, SIOR, CCIM**  
First Vice President  
+1 405 315 0725  
jason.hammock@cbre.com

**Caitlin Mazaheri, SIOR, CCIM**  
Vice President  
+1 405 413 2315  
caitlin.mazaheri@cbre.com

**Joe Summers**  
Senior Associate  
+1 405 831 6851  
joe.summers@cbre.com

# 5419 SW 27th Street

Oklahoma City, OK 73179



## Ancillary Building Details

*\*3,300± SF lean-to attached for outside covered storage*

- + Building Size: 4,850± SF
- + Clear Height: 20'
- + (1) 5-Ton Bridge Cranes

- + (2) 16' Overhead Doors
- + Wash Bay
- + Small Office

# Warehouse with Fenced Yard For Lease

CBRE



# 5419 SW 27th Street

Oklahoma City, OK 73179

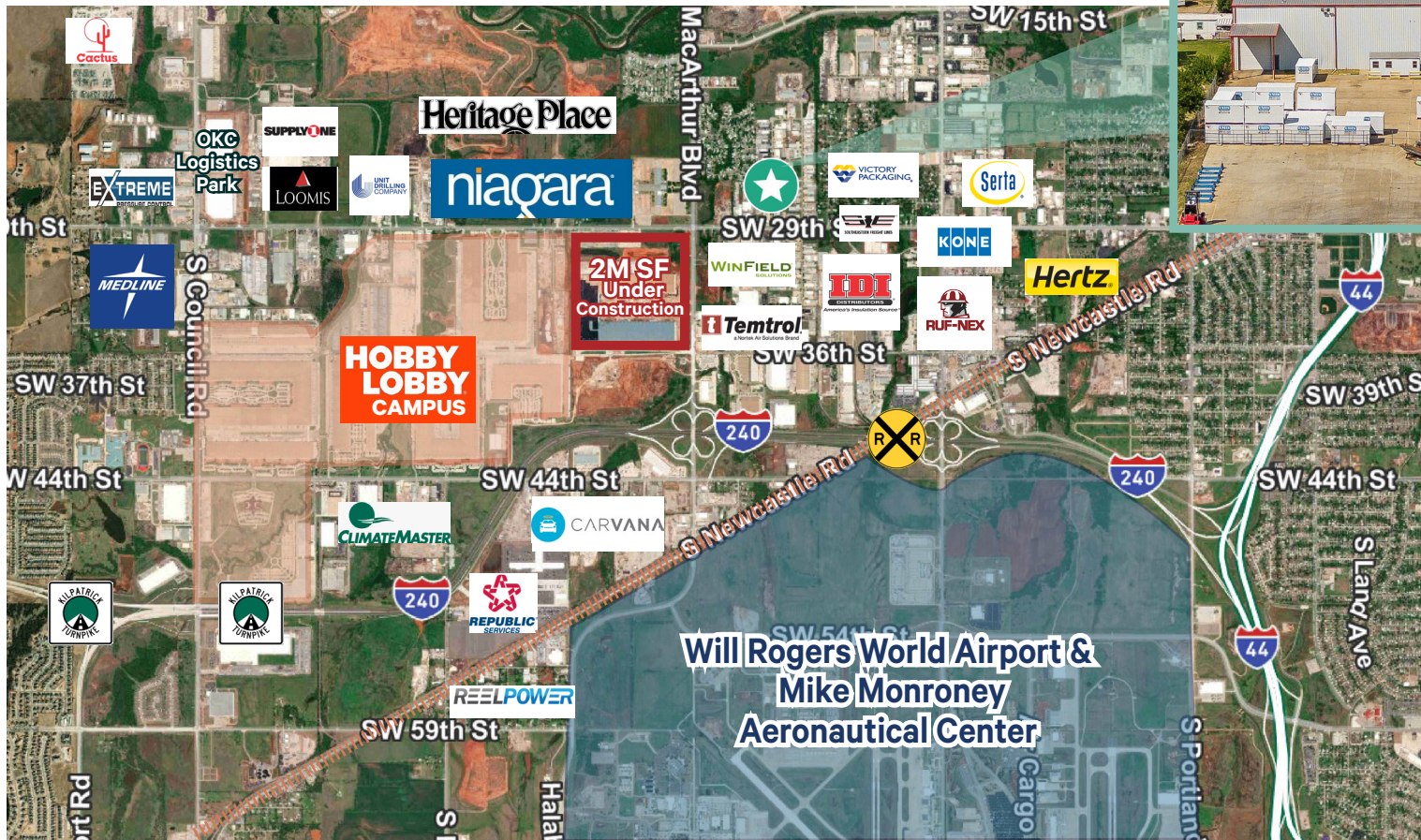

Scan QR Code for  
Additional Property  
Photos

Jason Hammock, SIOR, CCIM  
First Vice President  
+1 405 315 0725  
jason.hammock@cbre.com

Caitlin Mazaheri, SIOR, CCIM  
Vice President  
+1 405 413 2315  
caitlin.mazaheri@cbre.com

Joe Summers  
Senior Associate  
+1 405 831 6851  
joe.summers@cbre.com