

Deed References:

- Warranty deed of H & H Investments, LLC, dated April 13, 2006, recorded Carroll County Registry of Deeds Book 2522, Page 344.

Plan References:

- October 22, 1987 "Plan of Land in Ossipee, N.H. prepared for Van E. Hertel" by Robert G. Colbooth, recorded P.B.106, P.11.
- January 5, 1961 "Plan of land in Ossipee, N.H. property of Parker M. Morrow" by Roger S. Burnell, unrecorded.
- September 1967 plan "Property of George Albarghini Ossipee, N.H." by Stephen H. Boomer, recorded P.B.31, P.38.
- June 9, 1981 "Plan of Land for Milton E. & Janet T. Dow" by White Mountain Survey & Engineering, unrecorded.
- October 2022 "Conservation Easement Plan Prepared For Moose Mountain Regional Greenways Land Owned By Ellen Oglesby Carr, Trustee Ellen Oglesby Carr Trust" by Hambrick Land Surveying, unrecorded.
- June 1895 plan "A plan of Roland Park Ext'n" by Nash and Hunter Civil Engineers, recorded P.B.38, P.38.
- December 1975 plan "Property of Katherine E. Lovett" by Thaddeus Thorne-Surveys, Inc., recorded P.B.173, P.36.
- October 1977 "Plan showing boundary line adjustment between property of E. Milton Dow and property of Lloyd A. Wilkins and Catharine Pike Wilkins, Ossipee, N.H." by Stephen H. Boomer, recorded P.B.50, P.84.
- August 2, 1969 revision of plan "Subdivision of Land of Milton Dow" by White Mountain Survey Co., Inc. recorded P.B.124, P.74.
- Sept. 20, 2019 "Boundary Line Adjustment Plan of Lands of Allen R. & Donna M. Drelick" by David M. Dolan Associates, P.C., recorded P.B.242, P.23.
- February 6, 2008 revision of plan "Proposed Two Lot Subdivision Property of Janice L. & James M. Tully Jr." by Thaddeus Thorne Surveys, Inc., recorded P.B.220, P.63.
- June 8, 1820 plan "A Correct Plan representing Lot numbered ten and two Gores in the second Division of Lots in the Town of Ossipee" by B. Cook, recorded in the N.H. State Papers V. 28, P. 168.
- Various copies of 1806 "Plan of Ossipee N.H." by James Hersey, on file at the offices of HEB Engineers and on record at Carroll County Registry of Deeds.

Notes:

- Subject premises are Ossipee Tax Map 230, Lot 3, Map 239, Lots 2, 3, 7, & 8, Map 240, Lots 2 & 3, Map 241, Lot 23, and Map 242, Lot 31; lie within the Rural District and the Ossipee Corner Light and Power Precinct & the Center Ossipee Fire Precinct, and contain a total of 867.8± acres.
- Boundary evidence shown is per field surveying performed April-December 2022, using a Leica TS16 robotic total station and Leica GS15 GNSS receivers, under the direct supervision of Seth E. Burnell, L.S. #985, and conforming with the technical standards for urban property surveys per the NH Code of Administrative Rules of the Board of Licensure for Land Surveyors.
- Bearings reference grid north per the New Hampshire State Plane Coordinate System, North American Datum of 1983(2011), established per GPS observations tied to the NGS CORS network.
- Topography shown is per USGS LIDAR "Umbagog 2017" dataset. Wetlands shown are approximate per the National Wetlands Inventory and were downloaded from the NH Geodata Portal. Water courses, interior roads, and other topographic features were digitized per LIDAR and aerial imagery.

Legend

- Overhead utility wires/pole
- Major contour
- Minor contour
- Stone wall
- Edge of pavement
- Edge of gravel
- NW wetland
- Aluminum disk found
- Intersection point
- Iron pipe found
- Granite post found
- Drill hole found

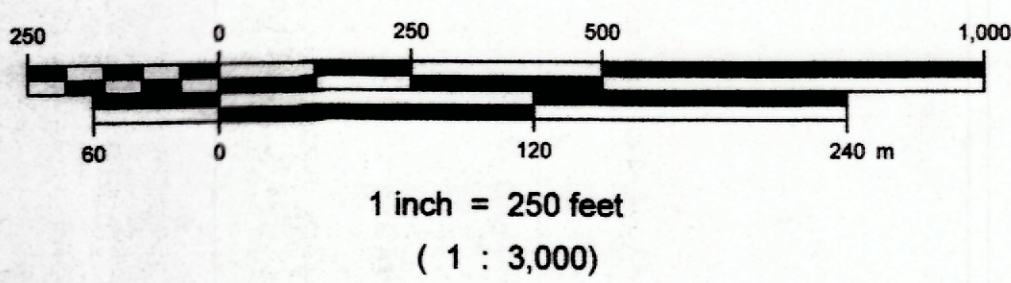

Copyright	2023	HEB Engineers, Inc.
No.	Revision	DATE BY

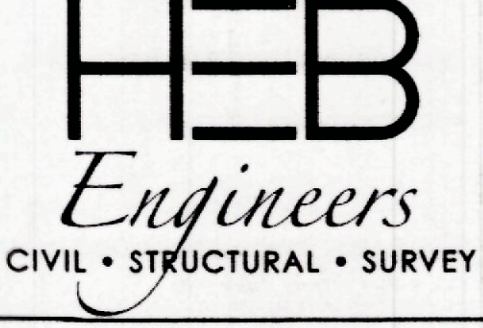
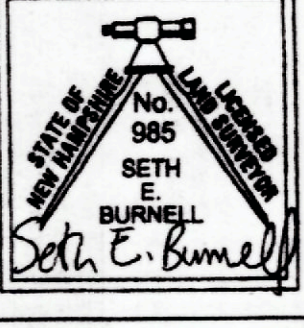

HEB Engineers, Inc.
www.hebengineers.com
NH Office (603) 356-6936
Post Office Box 440
North Conway, NH 03860
ME Office (207) 803-8265
Post Office Box 343
Bridgton, ME 04009

SURVEYED BY JAD, DWI
DESIGNED BY
DRAWN BY DAB
CHECKED BY SEB
FIELD BOOK 372,374
SCALE 1"=250'
DATE June 30, 2023

Vicinity Map
SCALE: 1" = 1 mile
Source: NH GRANIT Database

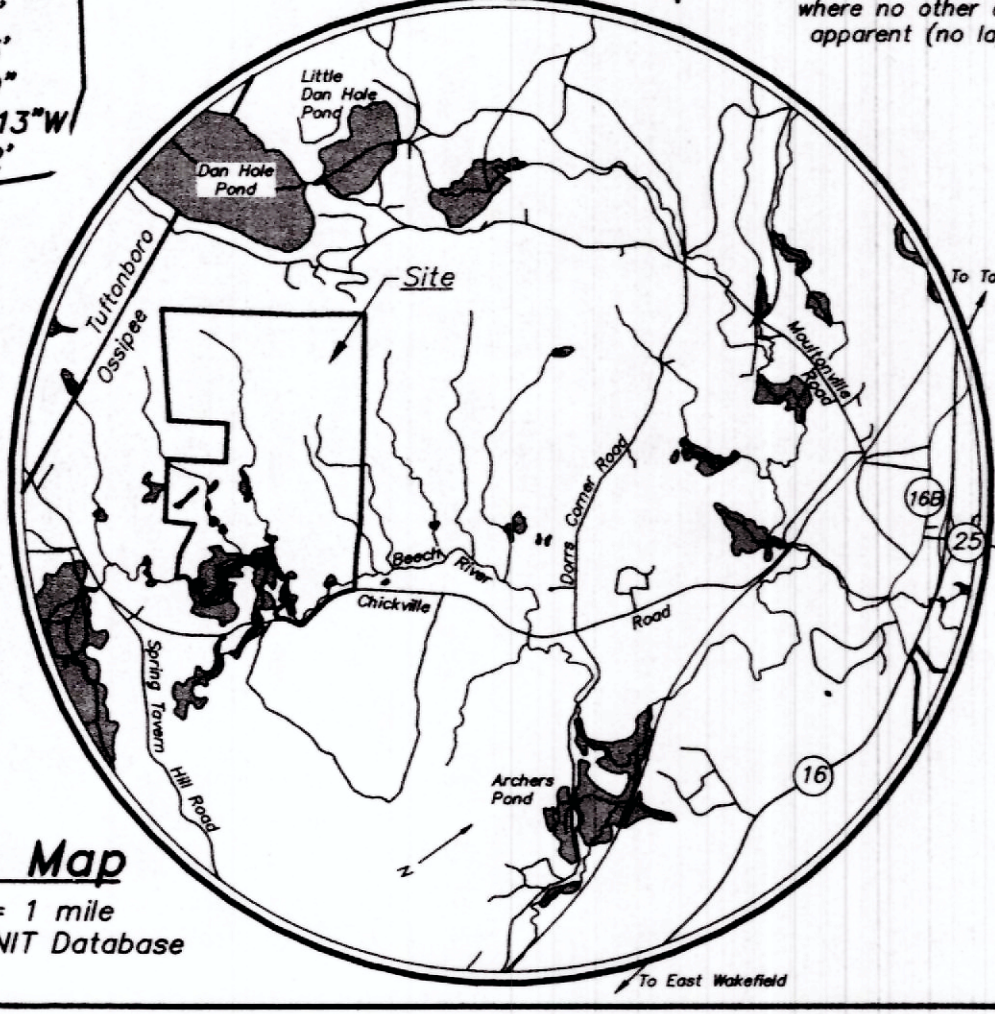

Boundary Plan
of land of
Eldridge Hill Group, LLC
in
Ossipee, New Hampshire
prepared for
Nick Castel