



11189 Sorrento Valley Rd

San Diego, CA 92121

Asking Rate:

\$4.25 NNN

4,543 SF Available

Lab Space Available Now



End unit in a private setting. Building & Monument signage.



Across the street from the Sorrento Valley Coaster station.



Move-in ready. Above-market percentage of lab to office ratio.



Connectivity to nature. Lush landscaping & seating on the banks of Los Penasquitos Creek.

Accelerating success.

Property Profile



Lab

- Furnished with benches and hoods
- Four 6' and two 8' fume hoods
- All hoods with racks and 22 A&F storage
- House DI water and gas
- Lab support rooms
- Separate 100 SF vented chemical storage
- Single-pass air in labs

Office

- Mix of private offices and lab support rooms. Upgraded finishes to accommodate maximum flexibility for office or lab users.
- Conference room, two restrooms, multiple private offices, and kitchen/break room
- New interior paint, ceiling tiles, and flooring
- Complete HVAC refurbishing with 1 year warranty

Premium Site

Conveniently situated within the **Venture Sorrento Office Park**, just west of I-5, in the Sorrento Valley Lab submarket, it stands directly opposite from the Sorrento Valley Coaster Station.

Floorplan

4,543 SF Available

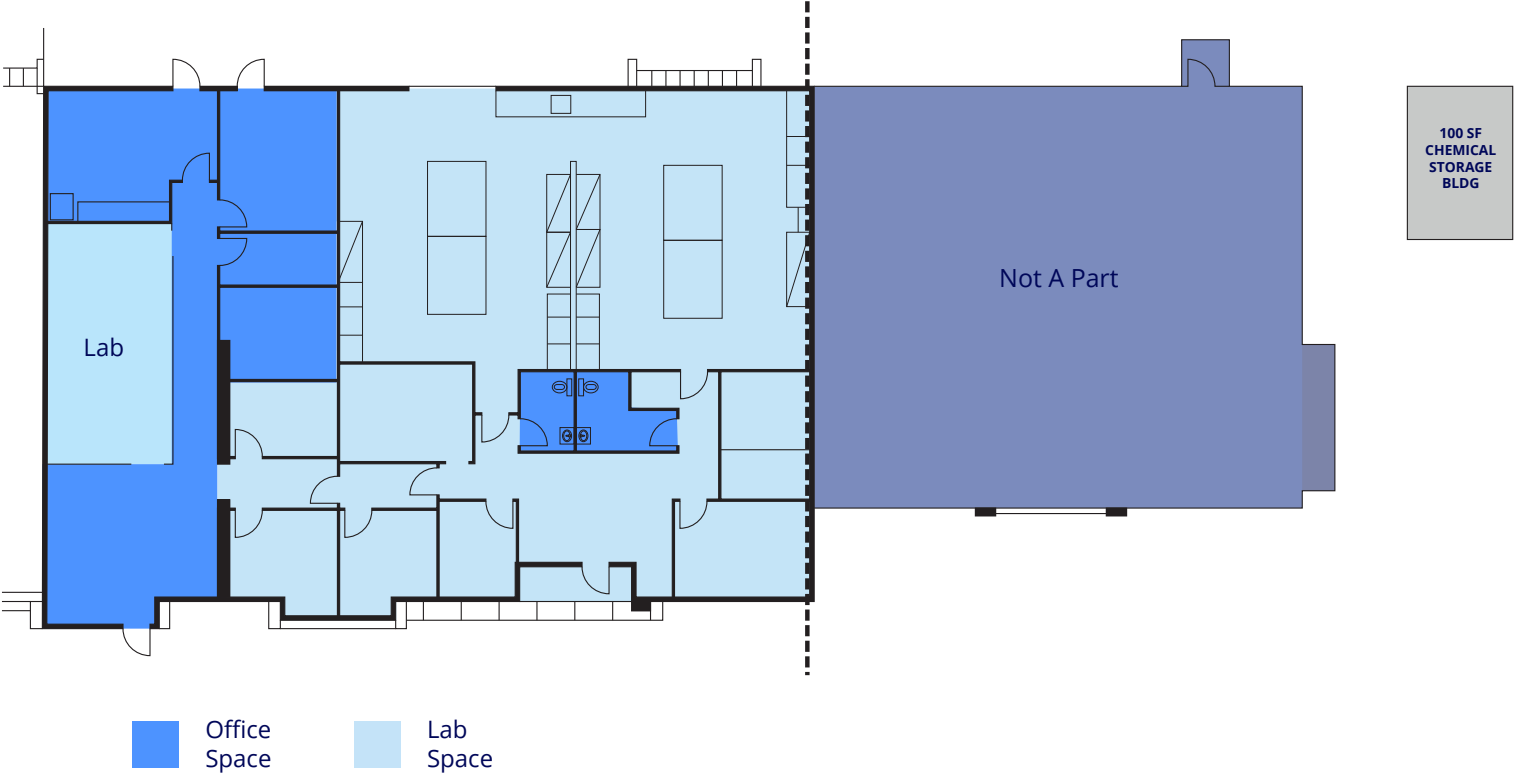

Property Gallery

Hallway



Lab



Lab with existing fume hoods



Entry



Kitchen/Break Room



PACIFIC OCEAN



CARMEL VALLEY



11189 Sorrento Valley Rd

SORRENTO VALLEY



UTC



Copyright © 2024 Colliers International.
Information herein has been obtained from sources deemed reliable, however its accuracy cannot be guaranteed. The user is required to conduct their own due diligence and verification.

Contact

Conor Evans

Vice President

t 858-291-1415

conor.evans@colliers.com

CA RE Lic. #01963596

