

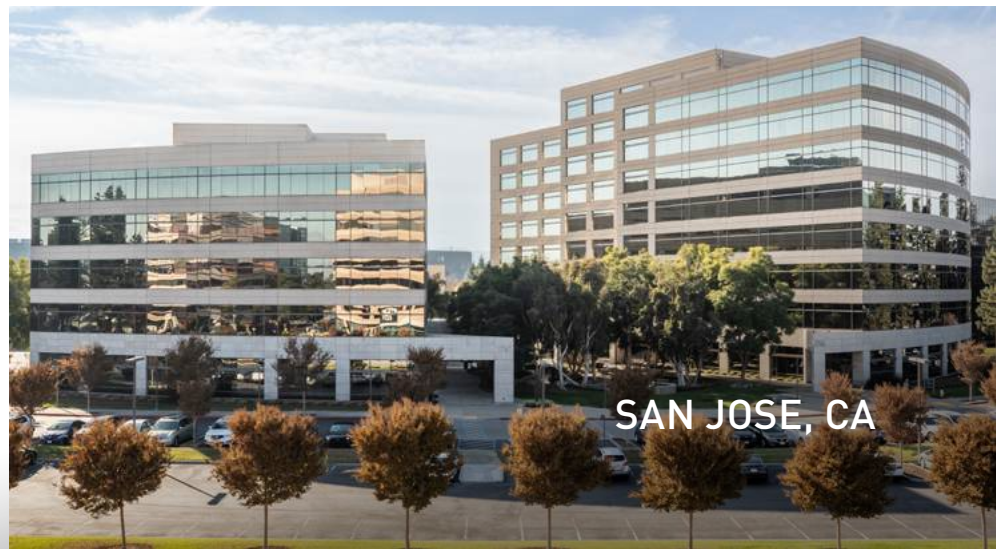

AIRPORT PLACE





GATEWAY

2001, 2033, 2055, 2077, 2099
GATEWAY PLACE

CONCOURSE

1731, 1735, 1741, 1745
TECHNOLOGY DRIVE
224 & 226
AIRPORT PARKWAY



METRO PLAZA

25, 101, 181
METRO DRIVE



SKYPORT PLAZA

1650 & 1700
TECHNOLOGY DRIVE



1740 TECHNOLOGY

1740
TECHNOLOGY DRIVE



SAN JOSE

WELCOME TO AIRPORT PLACE

CONVENIENTLY LOCATED ADJACENT TO SAN JOSE INTERNATIONAL AIRPORT **IN THE HEART OF SILICON VALLEY**, AIRPORT PLACE IS A COLLECTION OF CLASS A OFFICE CAMPUSES OFFERING INDUSTRY-LEADING COMPANIES THE **ONSITE AMENITIES AND EVENTS** REQUIRED TO ATTRACT AND RETAIN TALENT.

17

BUILDINGS

2.6M

TOTAL SQUARE FEET

FACTS & FEATURES

WHERE THE OFFICE IS A DESTINATION



CLASS A CAMPUSES
MODERN INDOOR/OUTDOOR
AMENITIES



LEED GOLD
CERTIFICATIONS



ONSITE
PROPERTY
MANAGEMENT

- + Class A office campus collection
- + Exceptional scalability for growth opportunities
- + Wide variety of modern, move-in ready suites of all sizes and configurations
- + Best-in-class upgrades and enhancements throughout
- + State-of-the-art conference facilities and fitness centers
- + Abundant outdoor collaboration spaces with complementary Wi-Fi
- + Abundant parking with EV charging stations
- + 24-hour security
- + Bike parking & storage
- + Walking distance to restaurants, retail, lodging & public transportation
- + Jogging & biking trails nearby
- + Free airport use parking
- + 5 minutes to San Jose International Airport
- + 3 minutes to VTA light rail
- + Convenient freeway access – 101, 880, 87 & 280



LOCATION

AIRPORT PLACE COLLECTION



LOCATION

WELCOME TO THE NEIGHBORHOOD

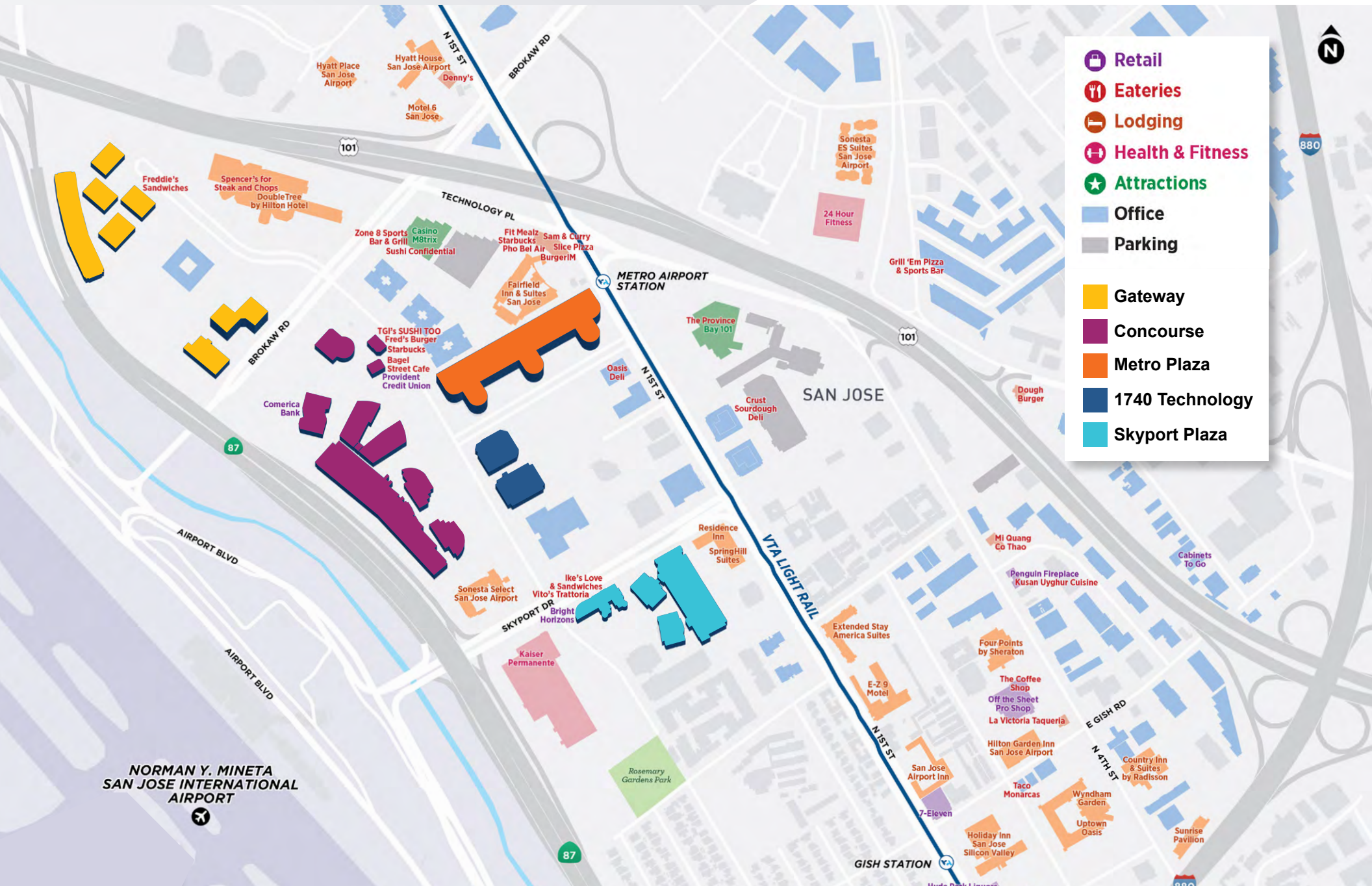

- Retail
- Eateries
- Lodging
- Health & Fitness
- Attractions
- Office
- Parking
- Gateway
- Concourse
- Metro Plaza
- 1740 Technology
- Skyport Plaza

**NORMAN Y. MINETA
SAN JOSE INTERNATIONAL
AIRPORT**

LOCATION

IN GOOD COMPANY

- GATEWAY
- CONCOURSE
- METRO PLAZA
- 1740 TECHNOLOGY
- SKYPORT PLAZA

Roku

Santa Clara University

TikTok

SJC SAN JOSE MINETA INTERNATIONAL AIRPORT

KAISER PERMANENTE

QuantumScape

SONY

muRata
INNOVATOR IN ELECTRONICS

QuantumScape

NUTANIX

TDK

HERITAGE
BANK OF COMMERCE

FICO

Aerotek

Regus

NEW YORK
LIFE

Amkor
technology

KPMG

APPLIED
MATERIALS

nvidia

ANALOG
DEVICES

amazon

servicenow

PURESTORAGE

ERICSSON

paloalto
NETWORKS

AMD

HUDSON PACIFIC PROPERTIES

YOUR WORKSPACE

MOVE-IN READY

SUITES THAT GO THE DISTANCE



MARKET-LEADING SPACES

PREMIUM WORKSPACES
INCLUDE KITCHENS,
CONFERENCE ROOMS AND MORE



READY FOR YOU

WE'VE THOUGHT OF EVERYTHING
SO ALL YOU HAVE TO DO IS
UNPACK AND GET TO WORK



SCALABLE OPTIONS

MULTIPLE MOVE-IN OPTIONS
AVAILABLE TO GROW WITH YOU



FLEXIBLE FLOOR PLANS

A VARIETY OF SIZES AND
CONFIGURATIONS TO
ACCOMMODATE THE WAY YOU WORK

HPP's move-in ready suites provide the perfect companion to our highly amenitized buildings. Designed for immediate productivity, these move-in ready workspaces ensure your team is ready to hit the ground running from day one.

TRUSTED BY:



AMENITIES & EVENTS

ELEVATED TENANT EXPERIENCES

Premium tenant amenities and events are designed to enhance the employee workday and create community. Bright and modern collaborative public workspaces, premium tenant-only amenities and a robust tenant appreciation events calendar offer the essential elements you and your team need to thrive in a connected, inspiring environment.



**COLLABORATION
SPACES**
ACROSS CAMPUS



**CONFERENCE
CENTERS**
WITH KITCHEN



**FITNESS
CENTERS**
MODERN FACILITIES



**EVENTS &
PROGRAMMING**
ROBUST CALENDAR



**OUTDOOR
SPACES**
RECENTLY RENOVATED



**ONSITE
RETAIL**
FOOD & CHILDCARE



**MY HPP
OFFICE**
TENANT APP



**PROPERTY
MANAGEMENT**
ONSITE



— SUSTAINABILITY

BUILDING A BETTER BLUEPRINT

OUR PROPERTIES ARE RECOGNIZED WITH THE INDUSTRY'S
LEADING AWARDS AND CERTIFICATIONS, INCLUDING:



We are committed to building and operating with a long-term vision to protect the environment, as well as support the safety and well-being of those in and around our buildings. Our Better Blueprint fosters the growth of sustainable, healthy and equitable buildings and cities – today and in the future.

- + 100% Carbon neutral operations
- + Recycling
- + Eco-initiatives
- + Water & waste management
- + Sustainable transportation
- + Health & wellness
- + Community impact



GATEWAY

— SAN JOSE / CA

2099 ↑

2033 →

2055 ↑

— FACTS & FEATURES

RUNWAY READY FOR YOUR TEAM



**5-BUILDING
CAMPUS**



**LEED GOLD
CERTIFICATION**



**COURTYARDS
WITH MEETING SPACES**

- + 609,566 SF class A creative office campus
- + Flexible growth opportunities within 2.6M SF portfolio
- + Expansive courtyard with outdoor meeting space
- + Surface & secured garage parking with EV charging
- + Onsite security & property management
- + Indoor/outdoor conference center with Zoom capability
- + Indoor/outdoor fitness center with showers & lockers
- + Bike parking & storage
- + Café with outdoor seating
- + Walking distance to 24 restaurants, 5 hotels, retail services & public transportation
- + Free airport parking



**SCAN TO
LEARN MORE**



PHOTO GALLERY



5-BUILDING CAMPUS WITH EXPANSIVE GREEN SPACE

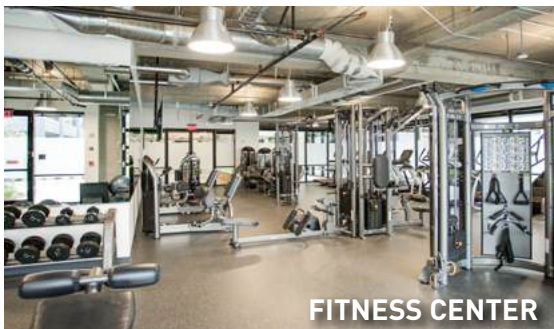

FITNESS CENTER



CONFERENCE CENTER

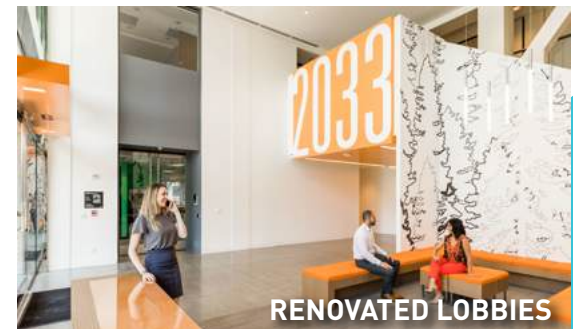

RENOVATED LOBBIES

CONCOURSE

— SAN JOSE / CA



— FACTS & FEATURES

TAKE A MEETING, CATCH A FLIGHT



**6-BUILDING
CAMPUS**



**LEED GOLD
CERTIFICATION**



**± 941,000
SF CAMPUS**

- + 941,566 SF class A creative office campus
- + Surface & secured garage parking with EV charging
- + Onsite security & property management
- + Modern conference center
- + Wi-Fi throughout ground-floor common area
- + Fitness center with showers & lockers
- + Bike parking & storage
- + Onsite retail restaurants and café
- + Prominent Silicon Valley location
- + Jogging/biking trails nearby
- + Convenient freeway access – 101, 880, 87 & 280



**SCAN TO
LEARN MORE**



PHOTO GALLERY



6-BUILDING CAMPUS WITH AMPLE PARKING

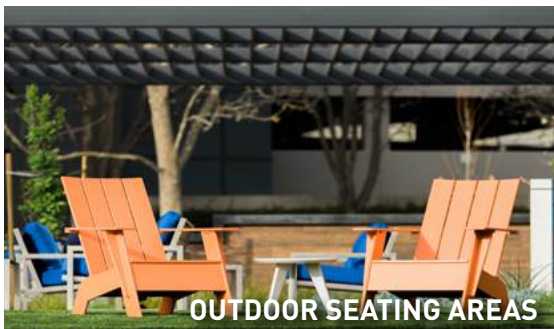

OUTDOOR SEATING AREAS



ONSITE RETAIL FOOD & DRINK



MOVE-IN READY SUITES

PHOTO GALLERY



FULLY EQUIPPED CONFERENCE CENTER



FITNESS CENTER



EV CHARGING

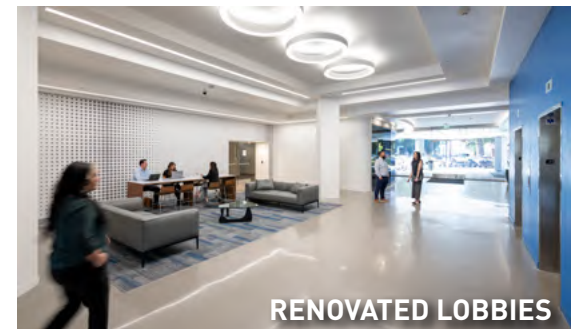

RENOVATED LOBBIES

METRO PLAZA

SAN JOSE / CA



25, 101, & 181 METRO DRIVE
SAN JOSE, CA 95110

— FACTS & FEATURES

BUSINESS VENTURES BOARDING HERE



**3-BUILDING
CAMPUS**



**LEED GOLD
CERTIFICATION**



**CONFERENCE CENTER
WITH KITCHEN**

- + ±468,793 SF class A creative office campus
- + New outdoor areas with drought-tolerant plants, seating & water bottle filling stations
- + Surface & secured garage parking with EV charging
- + Onsite security & property management
- + Renovated lobby with new tenant lounge
- + Upgraded conference center with Zoom capability
- + State-of-the-art fitness center with showers & lockers
- + New glass facades with energy efficient glazing to mitigate interior heat
- + Bike parking & storage
- + Jogging & biking trails nearby



**SCAN TO
LEARN MORE**



PHOTO GALLERY



3-BUILDING INTERCONNECTED CAMPUS



OUTDOOR COLLABORATION

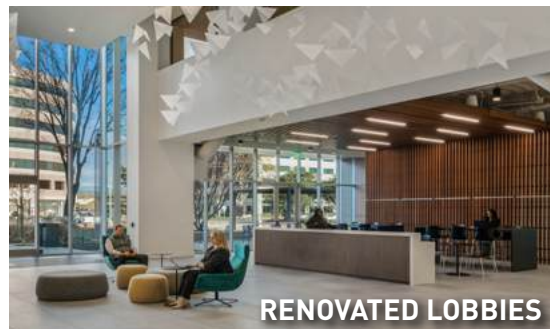

RENOVATED LOBBIES



AMPLE PARKING

PHOTO GALLERY



INDOOR/OUTDOOR CONFERENCE CENTER

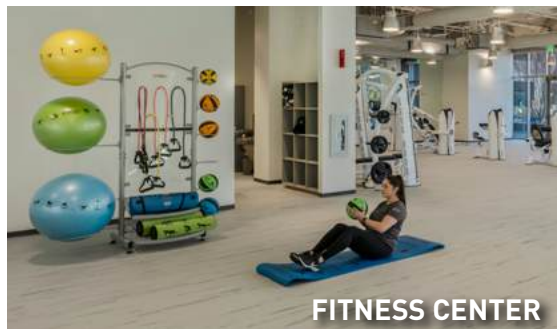

FITNESS CENTER



BIKE STORAGE



EVENT KITCHEN

SKYPORT PLAZA

SAN JOSE / CA



1650 & 1700 TECHNOLOGY DRIVE
SAN JOSE, CA 95110

— FACTS & FEATURES

LAND YOUR HQ HERE



2-BUILDING
CLASS A CAMPUS



LEED GOLD
CERTIFICATION



ONSITE RETAIL
FOOD & CHILDCARE

- + ±418,465 SF class A creative office campus
- + Twin 8-story buildings
- + Valley & mountain views
- + Exclusive outdoor courtyard amenity area with basketball court & soft seating (+Wi-Fi)
- + Generous electrical power: 1650 Technology: 3,500 amps
1700 Technology: 6,000 amps
- + Abundant surface & secured garage parking with EV chargers
- + Onsite security & property management
- + 100% carbon neutral operations
- + Premier highway 87 identity & signage opportunities
- + Walking distance to VTA light rail station
- + Onsite retail & restaurants



SCAN TO
LEARN MORE



PHOTO GALLERY



2-BUILDING CAMPUS



ONSITE RETAIL



BASKETBALL COURT



OUTDOOR SEATING

1740 TECHNOLOGY

SAN JOSE / CA



— FACTS & FEATURES

WHERE CONVENIENCE MEETS TECHNOLOGY



6-STORIES
CLASS A BUILDING



LEED GOLD
CERTIFICATION



FITNESS CENTER
WITH LOCKER ROOMS

- + ±215,857 SF class A creative office campus
- + Ideal for single-tenant headquarters
- + Outdoor collaboration spaces
- + Outdoor sports & recreation areas
- + Surface & secured garage parking with EV charging
- + Fitness center with showers & lockers
- + Water-efficient fixtures
- + 100% carbon neutral operations
- + Bike parking & storage
- + Jogging & biking trails nearby



SCAN TO
LEARN MORE



PHOTO GALLERY



BASKETBALL HALF COURT

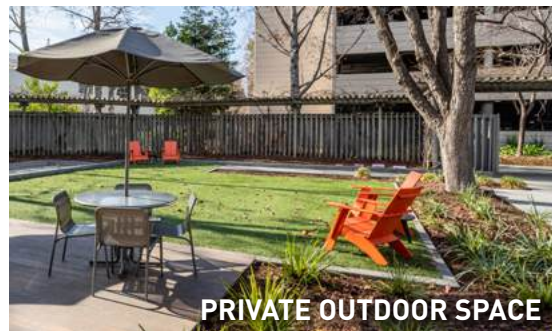

PRIVATE OUTDOOR SPACE

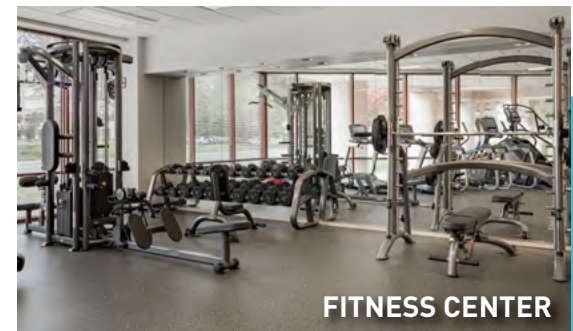

FITNESS CENTER

HUDSON PACIFIC PROPERTIES

REIMAGINING NOW. TO CREATE WHAT'S NEXT.

Where we work is not just where we work. It's part of who we are and how we thrive. At Hudson Pacific Properties, that's what drives us to stay one step ahead, looking for opportunities in just the right places to bring innovation to life. When you partner with us, you get a lasting relationship focused on addressing your every need. From an entrance that signals you've arrived to an environment that fosters collaboration, creativity and success, we provide the state-of-the-art infrastructure and excellent service necessary to fulfill your business strategy. And when you're ready, we're here to help you expand for the future, because the sky's the limit.

We're driven to find the next amazing space for today and tomorrow's leading companies – building it from the ground up or reimagining it from the inside out. With Hudson Pacific Properties everything is possible.

FOR MORE INFORMATION CONTACT

2055 GATEWAY PLACE, SUITE 200, SAN JOSE, CA 95110

408 451 4500

HUDSONPACIFICPROPERTIES.COM

