

**FOR LEASE**

± 6,000 SF

OFFICE/  
MEDICAL/  
RETAIL

ZONED "E"  
NEIGHBORHOOD  
COMMERCIAL



**TRANSWESTERN**

REAL ESTATE  
SERVICES

# 1032 Sandy Lane

FORT WORTH, TEXAS 76120



## PROPERTY INFORMATION:

- Currently 6,000 SF 2nd Generation Medical Clinic
- Behind New Elementary School
- Ample Parking
- 0.2 Miles From Bus Stop
- Flexible Floorplans
- Zoned "E" Neighborhood Commercial:  
Permitted Uses May Include:
  - Daycare and Schools
  - Healthcare Facilities, Doctors Office, Medical Clinic
  - Assisted Living, Nursing Home
  - Event Center
  - Restaurants, Retail, and Service
  - Office
- Build to Suit Available
- As-Is Rate: \$12.00 SF + NNN

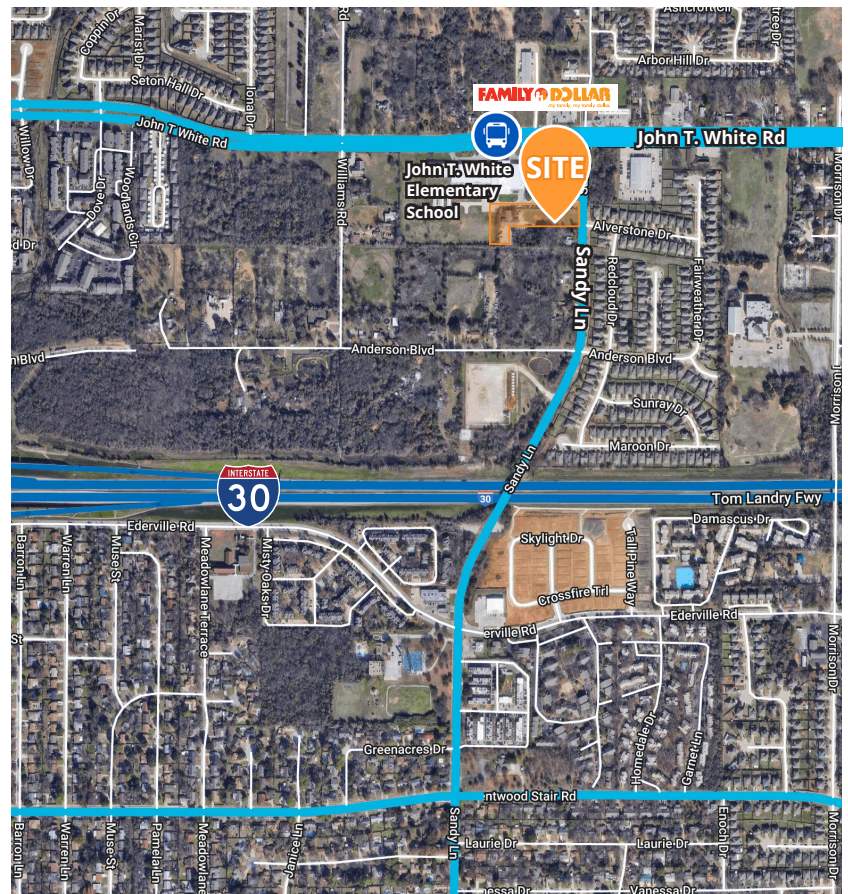

## FOR MORE INFORMATION:

**JASON HARRELL, MBA, CCIM®**

817.259.3545

jason.harrell@transwestern.com

The information provided herein was obtained from sources believed reliable; however, Transwestern makes no guarantees, warranties or representations as to the completeness of accuracy thereof. The presentation of this property is submitted subject to errors, omissions, change of price or conditions, prior to sale or lease, or withdrawal without notice. Copyright © 2023 Transwestern.



# 1032 Sandy Lane

FORT WORTH, TEXAS 76120



TRANSWESTERN

REAL ESTATE  
SERVICES

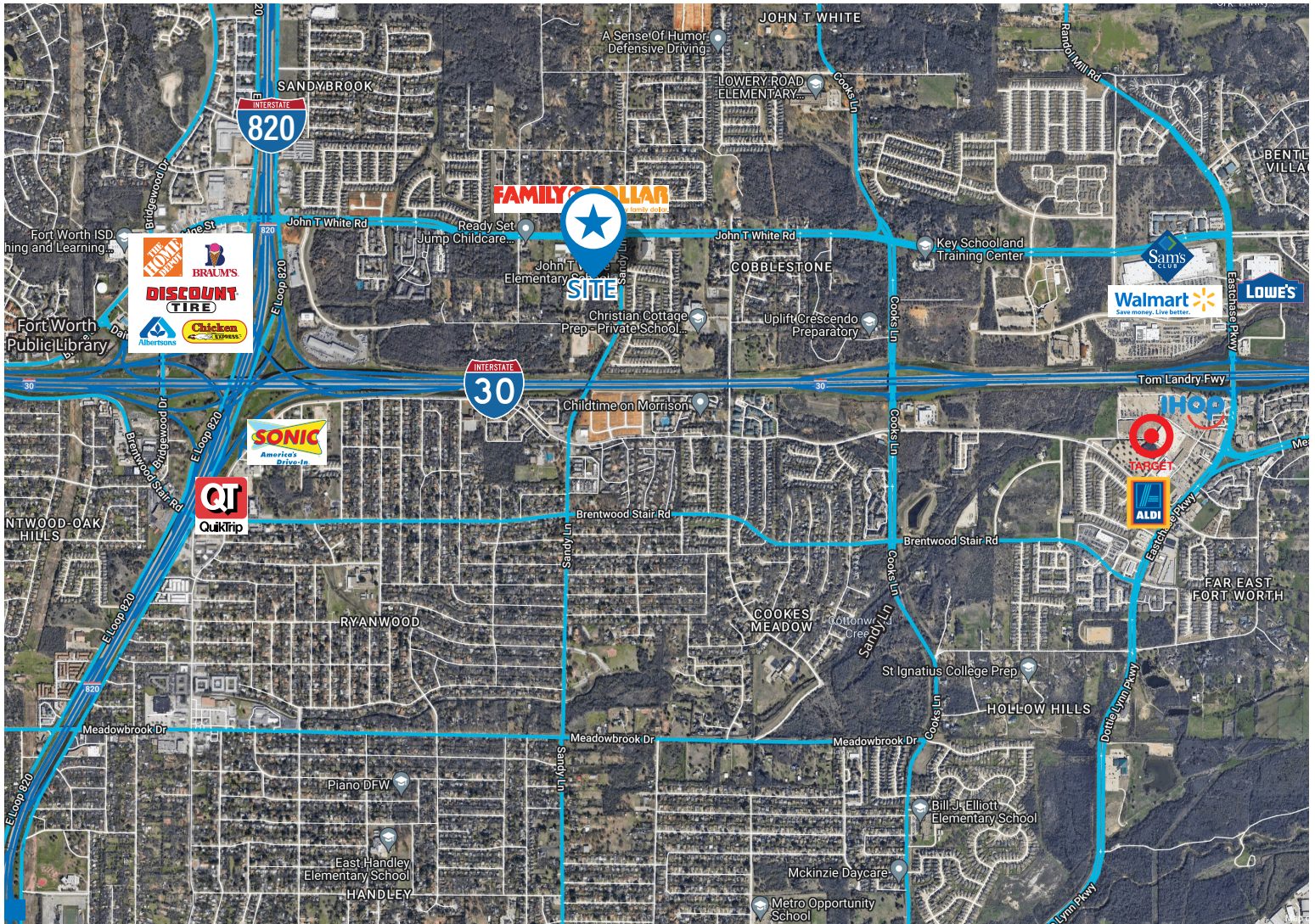

## FOR MORE INFORMATION:

JASON HARRELL, MBA, CCIM®

817.259.3545

jason.harrell@transwestern.com

The information provided herein was obtained from sources believed reliable; however, Transwestern makes no guarantees, warranties or representations as to the completeness of accuracy thereof. The presentation of this property is submitted subject to errors, omissions, change of price or conditions, prior to sale or lease, or withdrawal without notice. Copyright © 2023 Transwestern.

# 1032 Sandy Lane

FORT WORTH, TEXAS 76120



TRANSWESTERN

REAL ESTATE  
SERVICES

## AS-IS FLOOR PLAN

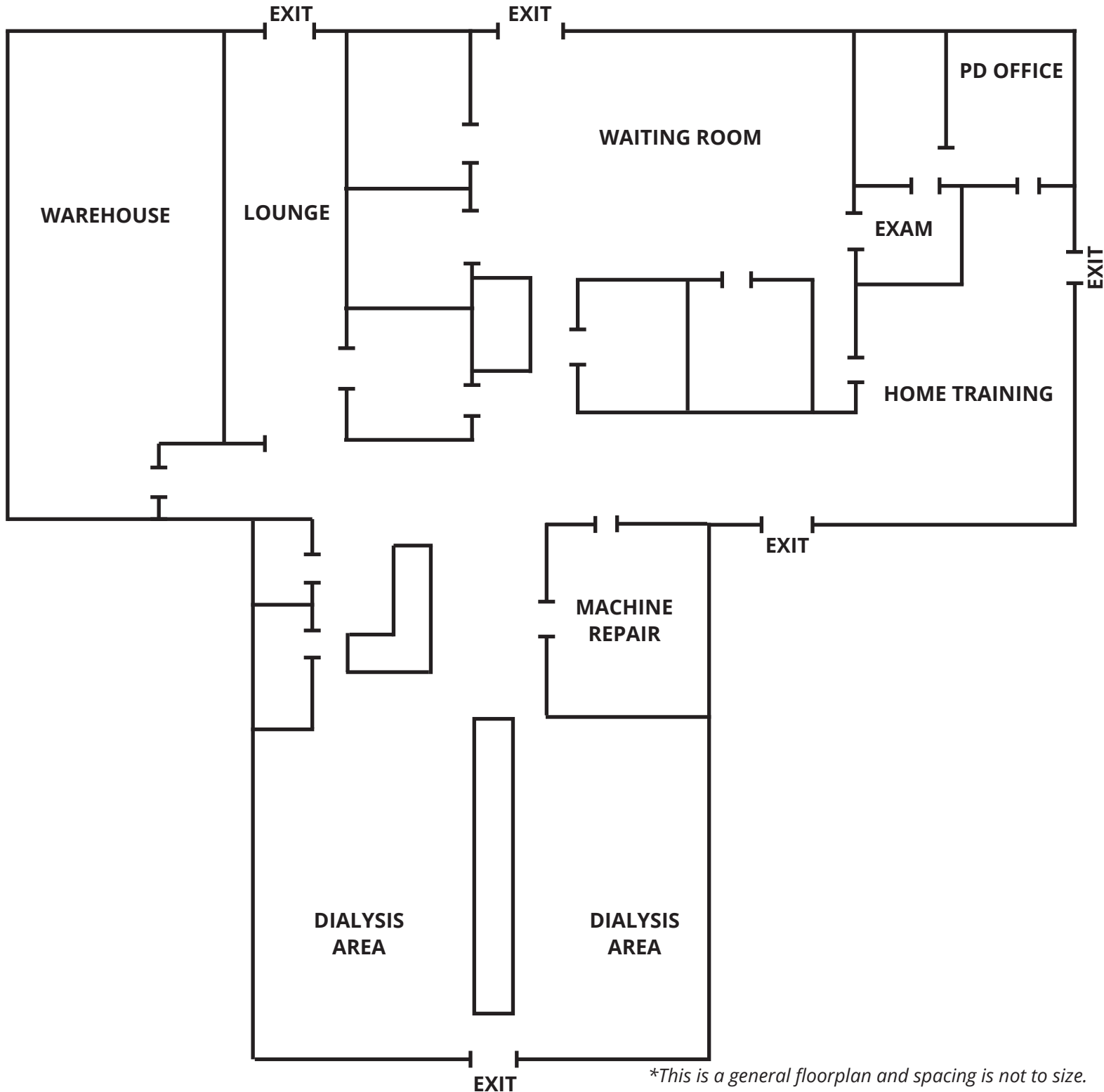

*\*This is a general floorplan and spacing is not to size.*

### FOR MORE INFORMATION:

JASON HARRELL, MBA, CCIM®

817.259.3545

jason.harrell@transwestern.com

The information provided herein was obtained from sources believed reliable; however, Transwestern makes no guarantees, warranties or representations as to the completeness of accuracy thereof. The presentation of this property is submitted subject to errors, omissions, change of price or conditions, prior to sale or lease, or withdrawal without notice. Copyright © 2023 Transwestern.



# 1032 Sandy Lane

FORT WORTH, TEXAS 76120







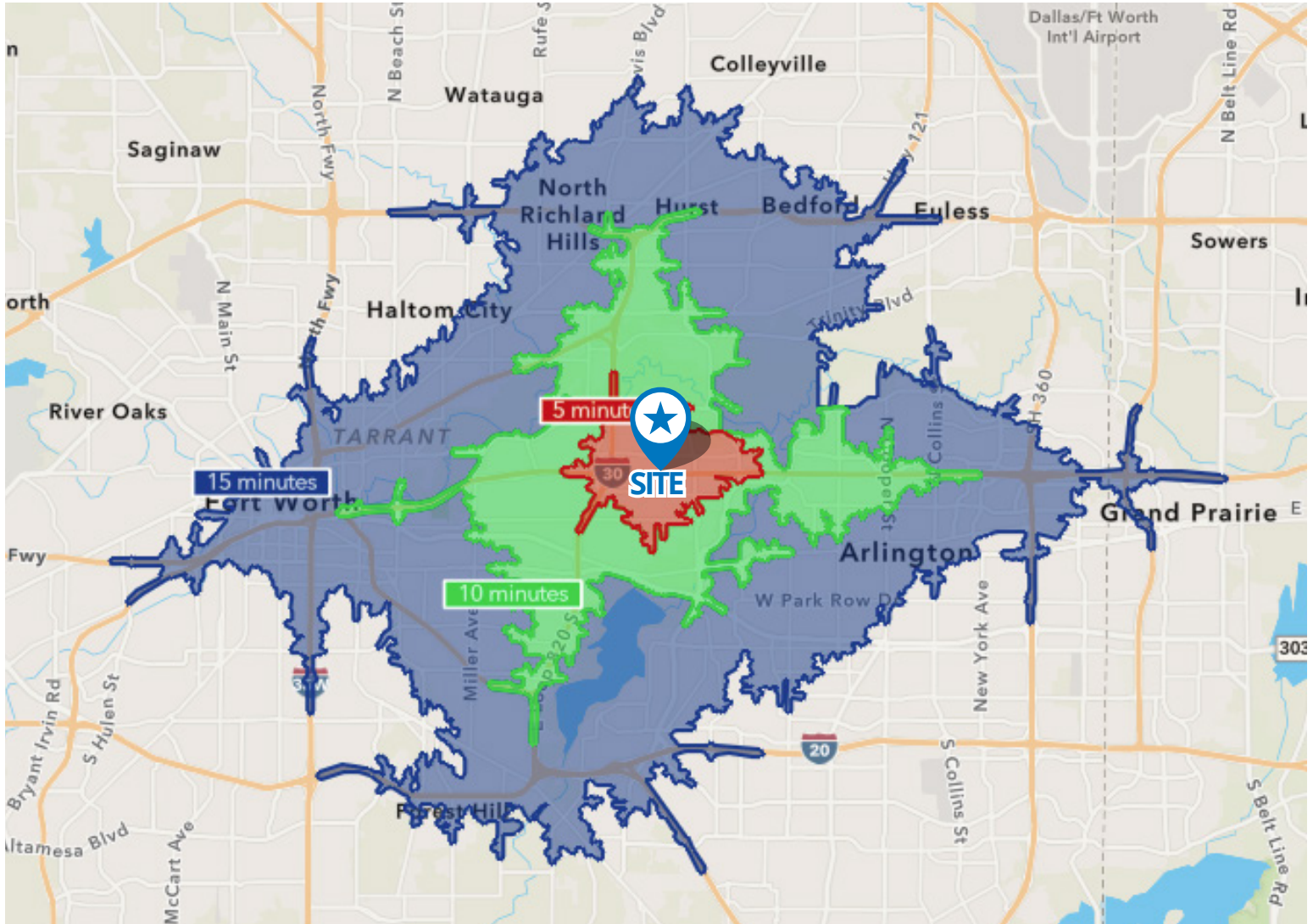



TRANSWESTERN



REAL ESTATE  
SERVICES



## DEMOGRAPHICS

1 mile	3 miles	5 miles
 Population <b>12,708</b>	 Population <b>71,604</b>	 Population <b>223,499</b>
 Average Income <b>\$76,963</b>	 Average Income <b>\$85,710</b>	 Average Income <b>\$84,976</b>
 Households <b>5,028</b>	 Households <b>28,002</b>	 Households <b>85,211</b>

## TRAFFIC COUNTS

	I-30 "West Fwy" @ Sandy Lane <b>7,408 vpd</b>
	I-30 "West Fwy" @ Morrison Dr <b>130,874 vpd</b>
	John T White Rd @ Egret Dr <b>11,967 vpd</b>

The information provided herein was obtained from sources believed reliable; however, Transwestern makes no guarantees, warranties or representations as to the completeness of accuracy thereof. The presentation of this property is submitted subject to errors, omissions, change of price or conditions, prior to sale or lease, or withdrawal without notice. Copyright © 2023 Transwestern.

## FOR MORE INFORMATION:

JASON HARRELL, MBA, CCIM®

817.259.3545

jason.harrell@transwestern.com



# Information About Brokerage Services - Fort Worth

Texas law requires all real estate license holders to give the following information about brokerage services to prospective buyers, tenants, sellers and landlords.

11-2-2015



## TYPES OF REAL ESTATE LICENSE HOLDERS:

- **A BROKER** is responsible for all brokerage activities, including acts performed by sales agents sponsored by the broker.
- **A SALES AGENT** must be sponsored by a broker and works with clients on behalf of the broker.

## A BROKER'S MINIMUM DUTIES REQUIRED BY LAW (A client is the person or party that the broker represents):

- Put the interests of the client above all others, including the broker's own interests;
- Inform the client of any material information about the property or transaction received by the broker;
- Answer the client's questions and present any offer to or counter-offer from the client; and
- Treat all parties to a real estate transaction honestly and fairly.

## A LICENSE HOLDER CAN REPRESENT A PARTY IN A REAL ESTATE TRANSACTION:

**AS AGENT FOR OWNER (SELLER/LANDLORD):** The broker becomes the property owner's agent through an agreement with the owner, usually in a written listing to sell or property management agreement. An owner's agent must perform the broker's minimum duties above and must inform the owner of any material information about the property or transaction known by the agent, including information disclosed to the agent or subagent by the buyer or buyer's agent.

**AS AGENT FOR BUYER/TENANT:** The broker becomes the buyer/tenant's agent by agreeing to represent the buyer, usually through a written representation agreement. A buyer's agent must perform the broker's minimum duties above and must inform the buyer of any material information about the property or transaction known by the agent, including information disclosed to the agent by the seller or seller's agent.

**AS AGENT FOR BOTH - INTERMEDIARY:** To act as an intermediary between the parties the broker must first obtain the written agreement of *each party* to the transaction. The written agreement must state who will pay the broker and, in conspicuous bold or underlined print, set forth the broker's obligations as an intermediary. A broker who acts as an intermediary:

- Must treat all parties to the transaction impartially and fairly;
- May, with the parties' written consent, appoint a different license holder associated with the broker to each party (owner and buyer) to communicate with, provide opinions and advice to, and carry out the instructions of each party to the transaction.
- Must not, unless specifically authorized in writing to do so by the party, disclose:
  - that the owner will accept a price less than the written asking price;
  - that the buyer/tenant will pay a price greater than the price submitted in a written offer; and
  - any confidential information or any other information that a party specifically instructs the broker in writing not to disclose, unless required to do so by law.

**AS SUBAGENT:** A license holder acts as a subagent when aiding a buyer in a transaction without an agreement to represent the buyer. A subagent can assist the buyer but does not represent the buyer and must place the interests of the owner first.

## TO AVOID DISPUTES, ALL AGREEMENTS BETWEEN YOU AND A BROKER SHOULD BE IN WRITING AND CLEARLY ESTABLISH:

- The broker's duties and responsibilities to you, and your obligations under the representation agreement.
- Who will pay the broker for services provided to you, when payment will be made and how the payment will be calculated.

**LICENSE HOLDER CONTACT INFORMATION:** This notice is being provided for information purposes. It does not create an obligation for you to use the broker's services. Please acknowledge receipt of this notice below and retain a copy for your records.

Transwestern Commercial Services Fort Worth, L.L.C.

9000246

817.877.4433

Licensed Broker /Broker Firm Name or  
Primary Assumed Business Name

License No.

Email

Phone

Paul Wittorf

479373

paul.wittorf@transwestern.com

214.446.4512

Designated Broker of Firm

License No.

Email

Phone

Leland Alvinus Prowse IV

450719

leland.prowse@transwestern.com

817.877.4433

Licensed Supervisor of Sales Agent/  
Associate

License No.

Email

Phone

Jason L. Harrell

677815

jason.harrell@transwestern.com

817.877.4433

Sales Agent/Associate's Name

License No.

Email

Phone

Buyer/Tenant/Seller/Landlord Initials

Date