

**53,754± SF & 1.3± Acre Parking**  
Industrial | For Lease

**343 MURRAY HILL PARKWAY**  
East Rutherford, NJ

**Heavy Power**  
**1200 Amps**



**Trailer Parking**

**NAI James E. Hanson**  
COMMERCIAL REAL ESTATE SERVICES, WORLDWIDE

**Kenneth D. Lundberg, SIOR**  
Senior Vice President  
201 488 5800 x138  
klundberg@naihanson.com

**Patrick Lennon**  
Senior Vice President  
201 488 5800 x109  
plennon@naihanson.com

**Lorenzo Lambiase, MBA, CCIM**  
Vice President  
201 488 5800 x176  
llambiase@naihanson.com

FOLLOW US! Offices: Teterboro | Parsippany | Allentown • [naihanson.com](http://naihanson.com) | [naisummit.com](http://naisummit.com) • Member of NAI Global with 325+ Offices Worldwide

THE INFORMATION CONTAINED HEREIN HAS BEEN OBTAINED FROM SOURCES CONSIDERED TO BE RELIABLE, BUT NO GUARANTEE OF ITS ACCURACY IS MADE BY NAI JAMES E. HANSON

# PROPERTY OVERVIEW

**343** MURRAY HILL PARKWAY  
East Rutherford, NJ

## BUILDING SPECIFICATIONS

<b>Building Size:</b>	53,754± SF
<b>Units Available:</b>	Three (3)
<b>Space Available:</b>	53,754± SF
<b>Ceiling Height:</b>	17'-21'
<b>Sprinklers:</b>	Wet
<b>Car Parking:</b>	40 Spaces

<b>Unit A:</b>	30,218± SF
<b>Office:</b>	3,000± SF
<b>Ceiling:</b>	17' Clear
<b>Tailgates:</b>	2 External & 2 Internal
<b>Drive-ins:</b>	2 Grade Level 10'x10' & 8'x8'
<b>Power:</b>	800 Amp

## UNIT SPECIFICATIONS

<b>Unit B:</b>	23,536± SF
<b>Office:</b>	5,000± SF
<b>Ceiling:</b>	21' Clear
<b>Tailgates:</b>	4 External
<b>Drive-ins:</b>	1 Oversized 15' H x 12' W
<b>Power:</b>	400 Amp

<b>Unit C:</b>	1.3± Acre Yard Trailer Parking
----------------	-----------------------------------



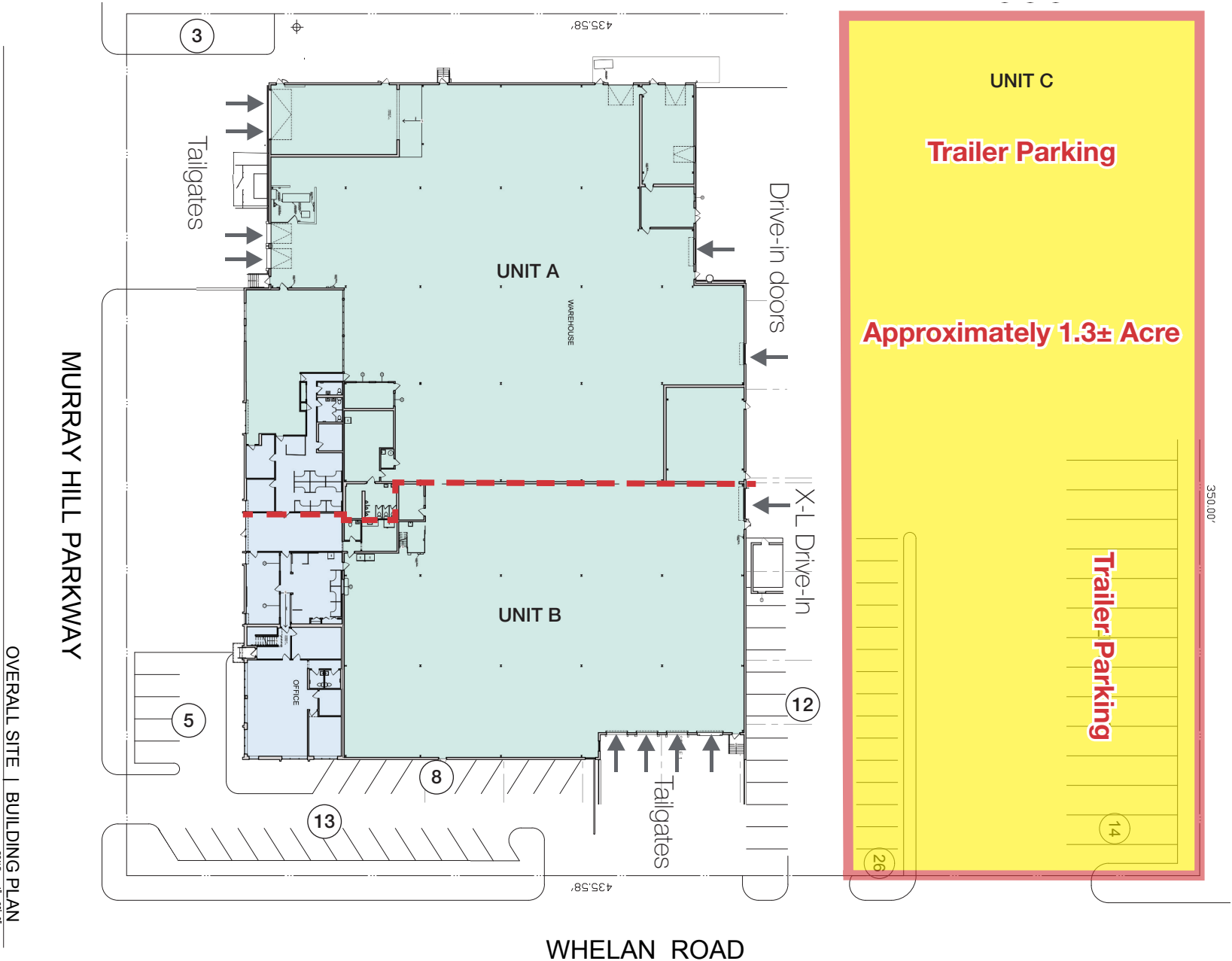

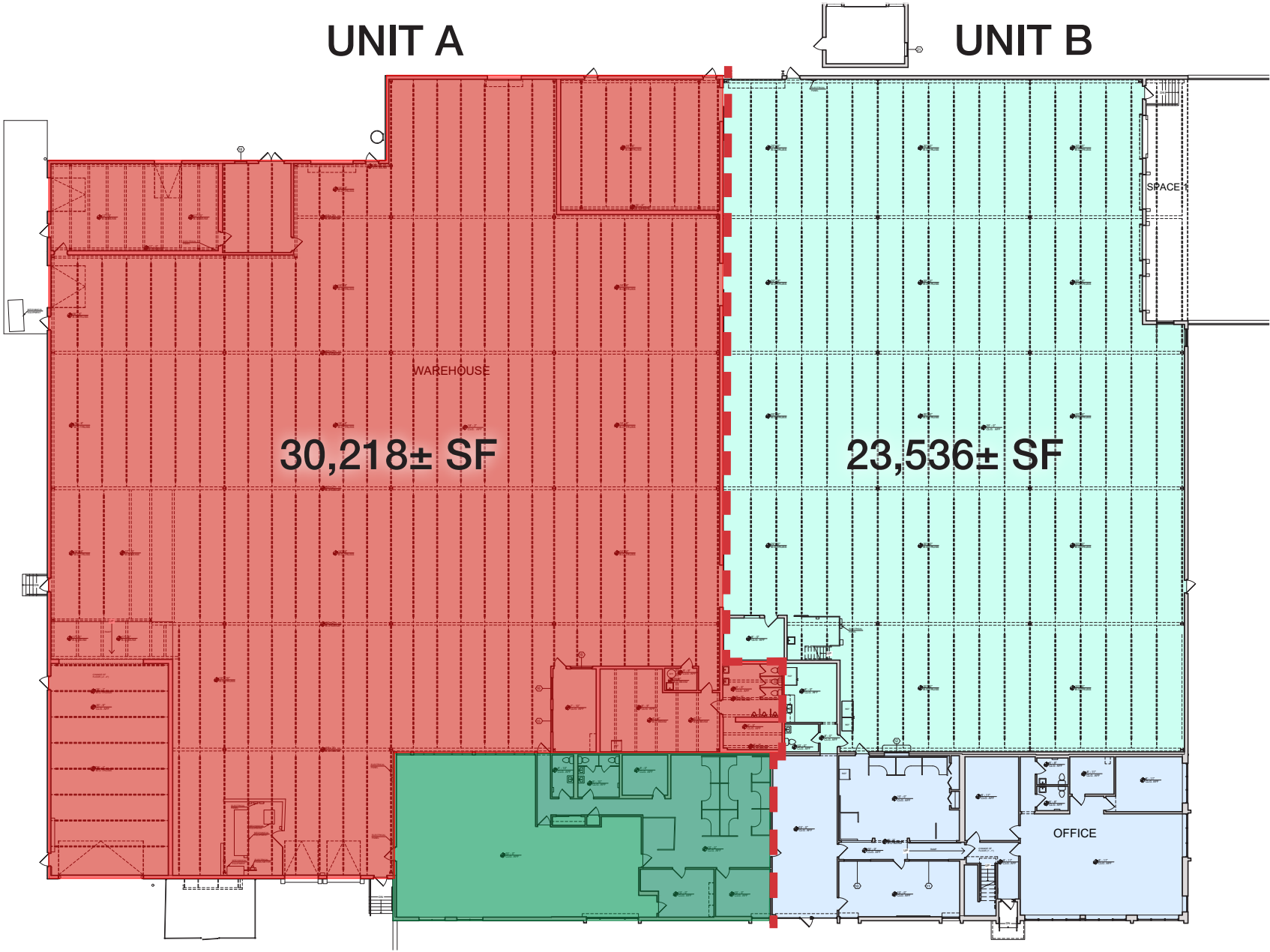

# LOCATION

# 343 MURRAY HILL PARKWAY

East Rutherford, NJ

