

AVAILABLE FOR LEASE

2201 POPLAR STREET | WEST OAKLAND, CA



## WEST OAKLAND INDUSTRIAL CENTER

3 AVAILABLE UNITS  
5,421 RSF | 13,257 RSF | 9,996-32,354 RSF

LBA Logistics  CBRE





## FEATURES

TOTAL BUILDING SIZE: ±201,947 SF

## ADDITIONAL EXTERIOR PHOTOS



Fully  
Sprinklered



53' Truck Access Permitted  
Throughout Property



Heavy Power Available



Onsite Property  
Management



Secured Loading &  
Off Street Parking



Located right off the Dock  
Platform - Dock & Grade  
Loading



Ground Zero West Oakland  
Location with immediate  
access to Bay Bridge and  
San Francisco



1st Floor - 16'-17' Clear Height  
2nd Floor - 22'-24' Clear Height



Second Floor - Dedicated  
Truck Access & Dock  
Loading



# FLOOR PLAN

## FLOOR 1 / ±104,395 TOTAL SF

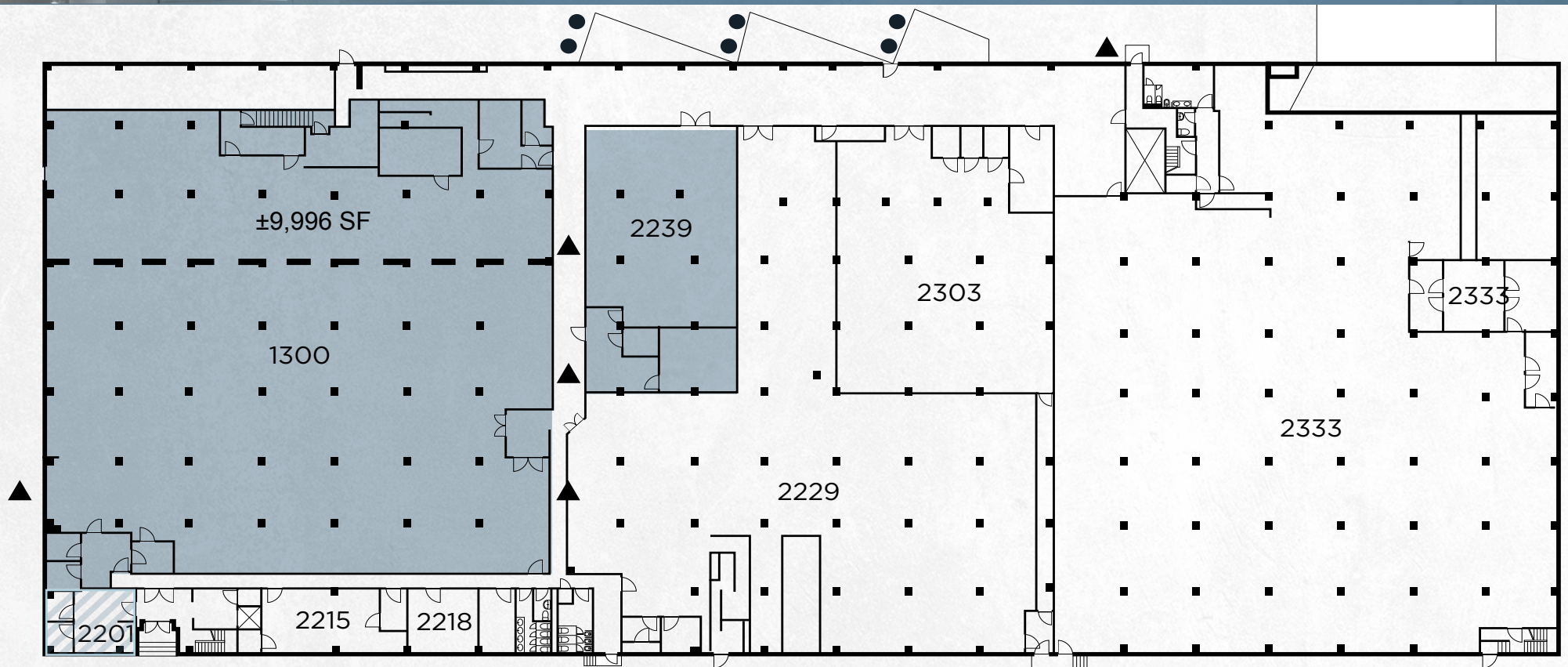

\*Unit 2201 can be made available for additional office space

UNIT	TOTAL SQUARE FOOTAGE	OFFICE	ASKING RATE	AVAILABLE	AVAILABLE SPACE
Unit 1300*	9,996 - 32,354	700-1,482	\$0.60/SF NNN + \$0.66 Opex	Now	DOCK LOADING
Unit 2239	5,421	±500	\$1.15/SF NNN + \$0.66 Opex	Now	ROLL UP DOOR

\*Can be divided into 2-3 units.

# FLOOR PLAN

## FLOOR 2 / ±97,552 TOTAL SF

\*53' trucks can access second floor building

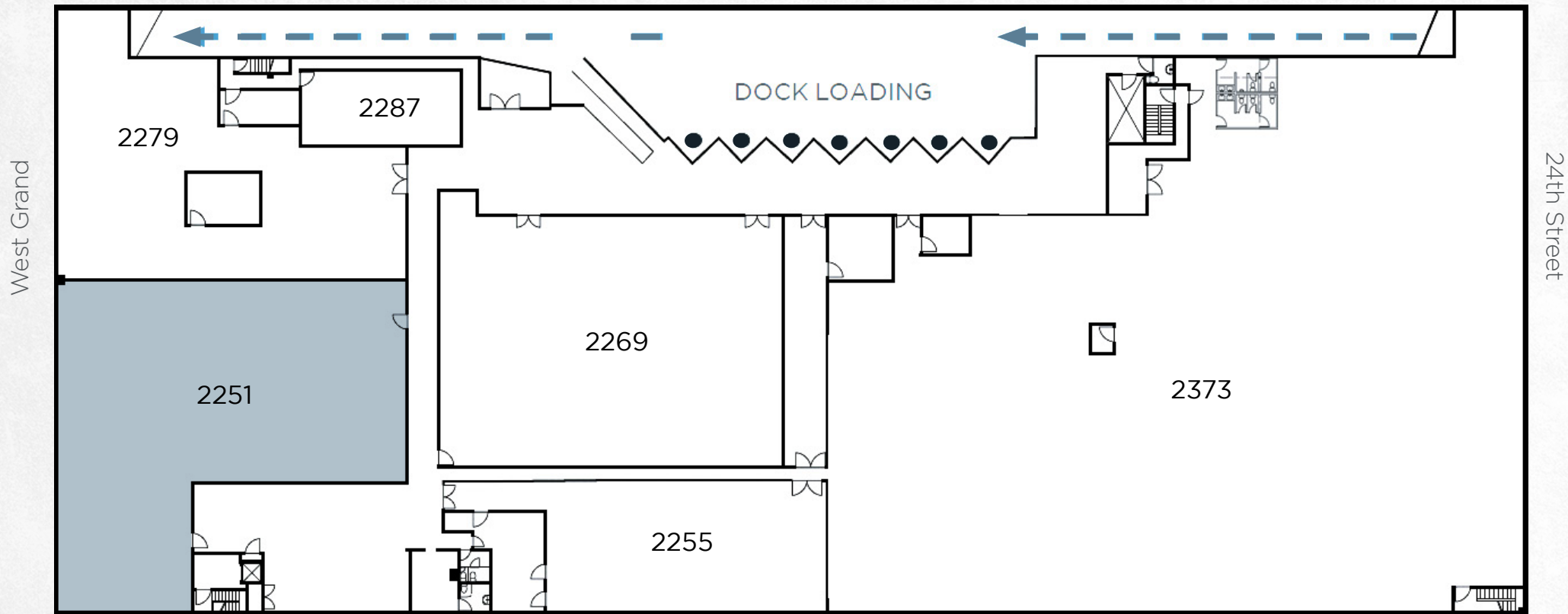

UNIT	TOTAL SQUARE FOOTAGE	OFFICE	ASKING RATE	AVAILABLE
Unit 2251	13,257 SF	1,301 SF	\$1.10/SF NNN + \$0.66 Opex	Now

- AVAILABLE SPACE
- DOCK LOADING
- ROLL UP DOOR



# CREATIVE TECH SPACE

UNIT 2251 | 13,257 SF WITH 800 AMPS AVAILABLE!

\*Upon Verification

AVAILABLE FOR LEASE

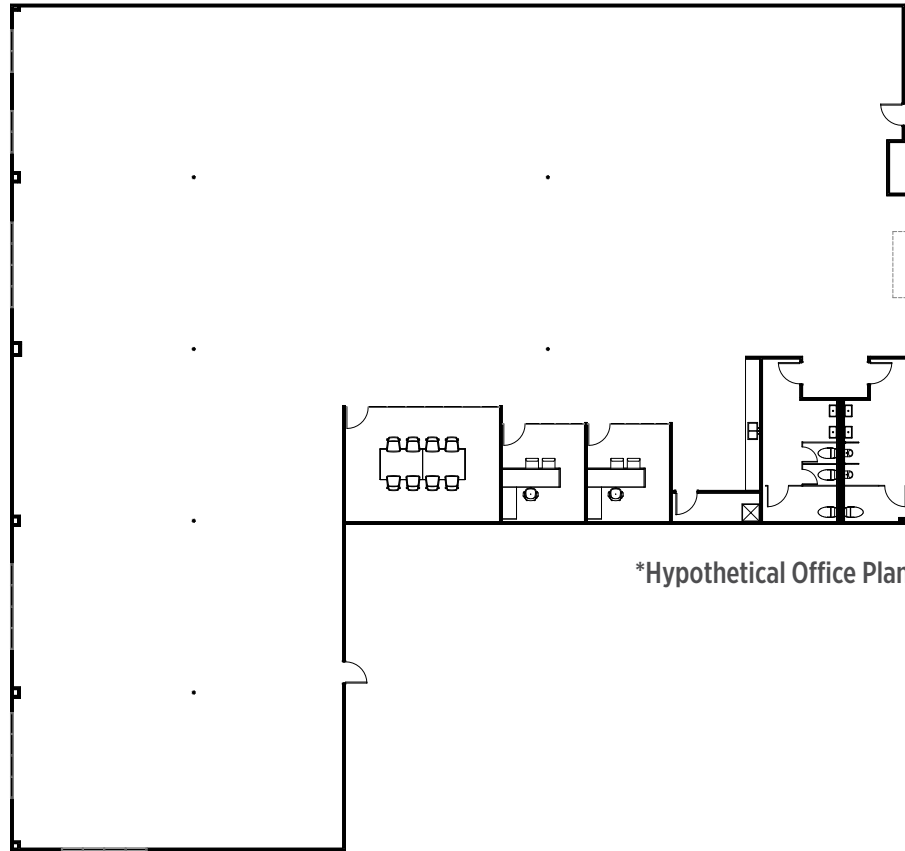

*\*Hypothetical Office Plan*



- Abundant Natural Light (Skylights+Large Perimeter Windows)
- Roll Up Door with access to Dock Loading Platform
- Landlord can bring 800 Amps of power into suite from current building supply

LBA Logistics 

**CBRE**



# 9,996-32,354 SF WITH DOCK LOADING

## UNIT 1300

AVAILABLE FOR LEASE



- Divisible
- Multiple Roll Up Door Access Points
- Immediate Access to Dock Loading
- Office Space can be Expanded as well as Built to Tenant Space



FOR MORE INFO,  
PLEASE CONTACT:

**CHRIS VAN KEULEN**

Senior Vice President

Lic. 01845520

+1 510 874 1934

[chris.vankeulen@cbre.com](mailto:chris.vankeulen@cbre.com)

**KENNY MORRIS**

First Vice President

Lic. 01312918

+1 510 874 1983

[ken.morris@cbre.com](mailto:ken.morris@cbre.com)



**LBA**Logistics 

**CBRE**

© 2025 CBRE, Inc. All rights reserved. This information has been obtained from sources believed reliable, but has not been verified for accuracy or completeness. You should conduct a careful, independent investigation of the property and verify all information. Any reliance on this information is solely at your own risk. CBRE and the CBRE logo are service marks of CBRE, Inc. All other marks displayed on this document are the property of their respective owners, and the use of such logos does not imply any affiliation with or endorsement of CBRE. Photos herein are the property of their respective owners. Use of these images without the express written consent of the owner is prohibited.