

# FLEX SPACE FOR LEASE

## 14 Corporate Cr., E. Syracuse



### BUILDING SIZE:

27,000 SF

### SPACES AVAILABLE:

2,520 & 4,100 SF

### SPACE TYPE:

Office/Warehouse with Drive-in  
& Door Doors

### AVAILABLE:

Immediately

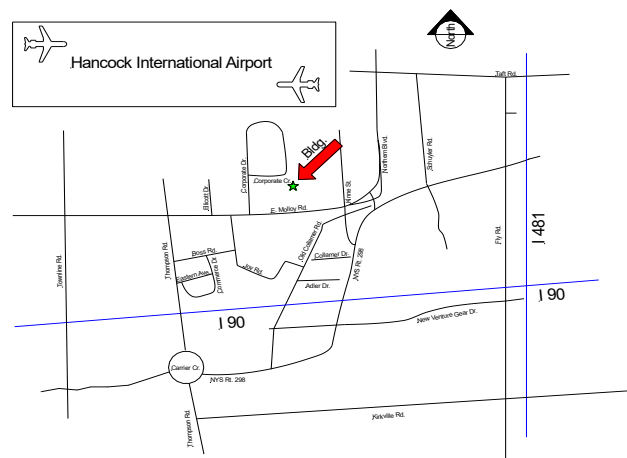

6724 Thompson Road • Syracuse, NY 13211

For more info contact:

Ed Rogers

Phone: 315-463-8684

Cell: 315-427-8510

E-mail: [Ed@olivaco.com](mailto:Ed@olivaco.com)

[www.olivaco.com](http://www.olivaco.com)

*All information is believed to be accurate. We are not responsible for misstatements of facts, errors or omissions, prior sales, and changes of price or withdrawal from the market without notice.*

# 14 Corporate Cr., East Syracuse, NY

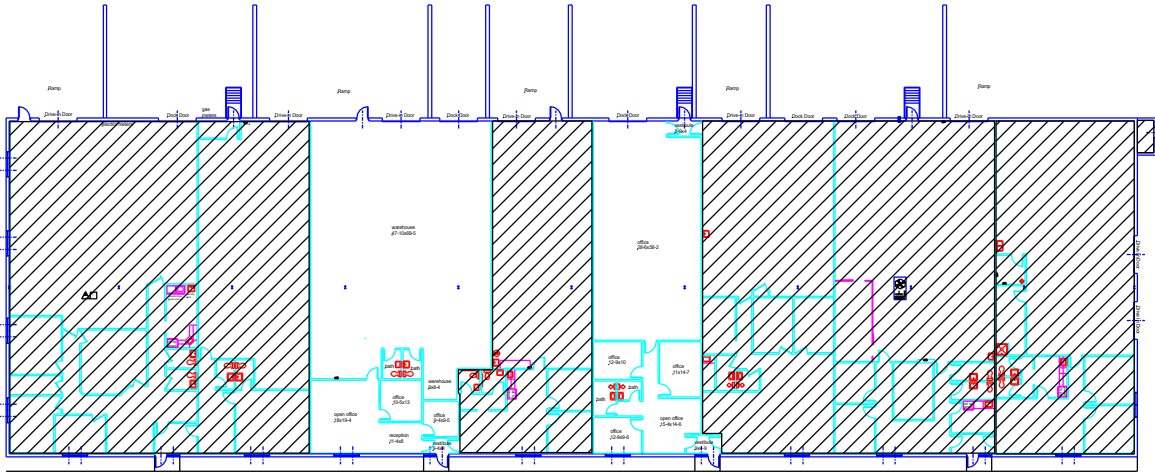

- **SPACES AVAILABLE:** 2,520 & 4,100 SF
- **SPACE TYPE:** Office/Warehouse
- **DOORS:**  
Smaller space: One Dock Door  
Larger space: One Drive-in Door & One Dock Door
- **HEAT TYPE:** Gas, forced air
- **AIR-CONDITIONED:** Yes (office areas only)
- **LEASE PRICE:** Depends on build out
- **TENANT RESPONSIBILITIES:**  
Utilities (gas, electric, & proportionate share of water)  
Janitorial and Trash
- **LANDLORD RESPONSIBILITIES:**  
Taxes & Insurance  
Lawn Care & Snow Plowing



6724 Thompson Road • Syracuse, NY 13211

For more info contact:  
Ed Rogers  
Phone: 315-463-8684  
Cell: 315-427-8510  
E-mail: [Ed@olivaco.com](mailto:Ed@olivaco.com)  
[www.olivaco.com](http://www.olivaco.com)

*All information is believed to be accurate. We are not responsible for misstatements of facts, errors or omissions, prior sales, and changes of price or withdrawal from the market without notice.*