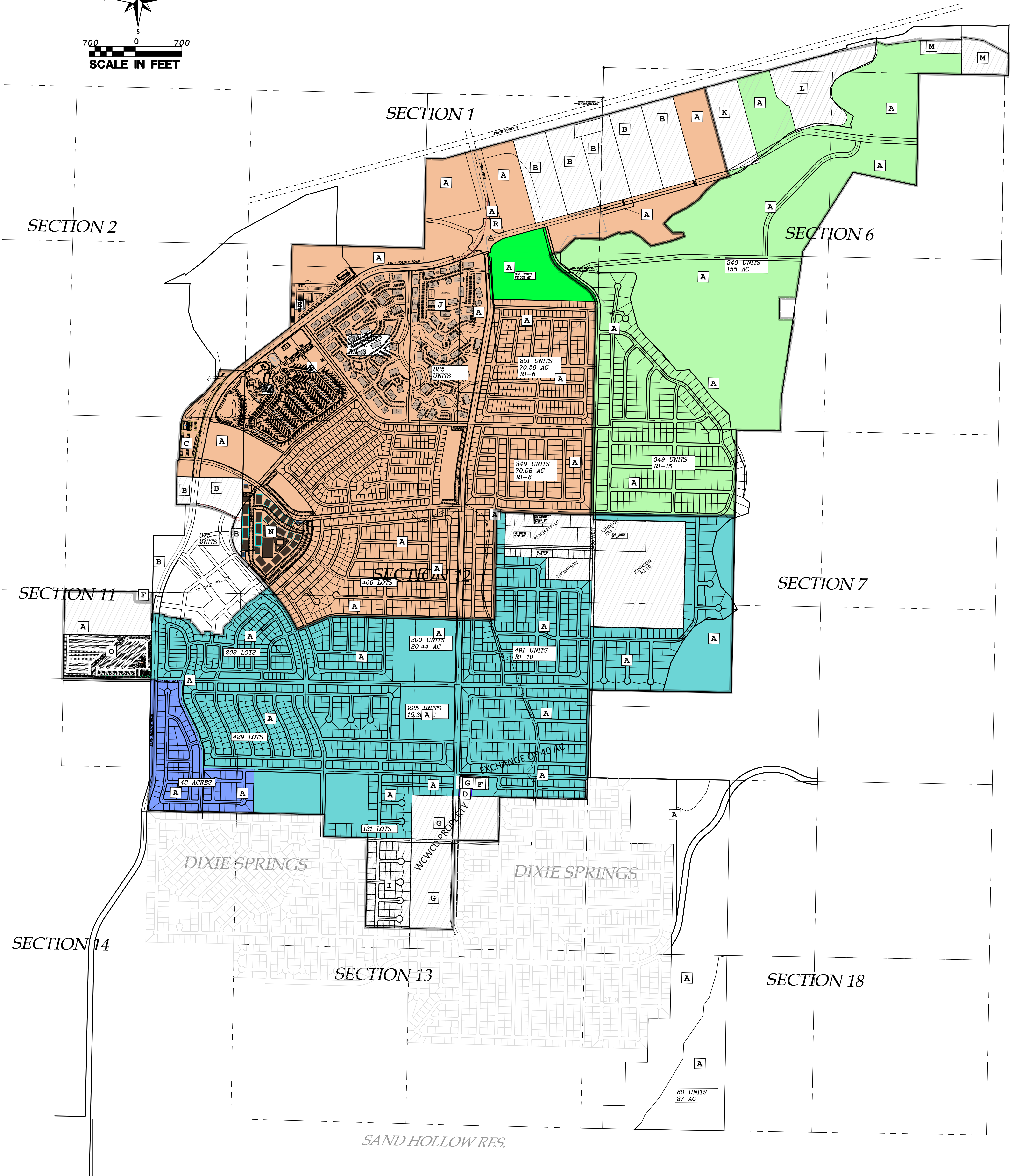
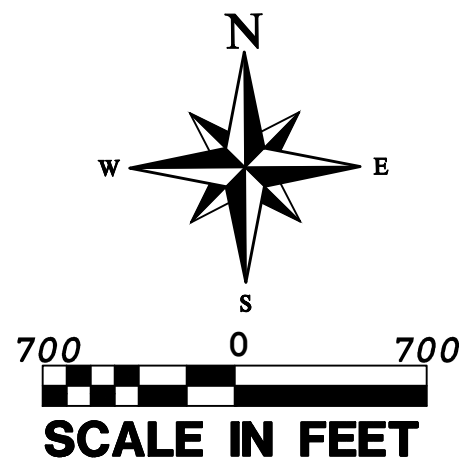

EXHIBIT A: GATEWAY AT SAND HOLLOW DISTRICT BOUNDARY MAP

LOCATED ON SAND HOLLOW RD, HURRICANE
WASHINGTON COUNTY, UTAH



LEGEND:		ANNEXATION PARCELS	
	PROPOSED PETITION AREA DISTRICT 1	A - WESTERN MORT. & REALTY CO. PARCELS:	B CYPRESS CAPITAL XI LLC, ET AL - PARCELS H-4-2-1-1105&1106, H-3-2-6-1403,1404,&1405 & H-4-2-11-126,127&128.
	POSSIBLE ANNEXATION AREAS DISTRICTS 1, 2 AND 3	H-3-2-6-431	F DIXIE ESCALANTE RURAL ELECTRIC - PARCELS H-4-2-13-1407-SA & H-4-2-11-240.
	PROPOSED PETITION AREA DISTRICT 2	H-3-2-6-1402	G WASHINGTON CO. WATER CONSERVANCY DISTRICT - PARCELS H-4-2-13-1405 & H-4-2-13-1491.
	PROPOSED PETITION AREA DISTRICT 3	H-3-2-6-1406	I WASHINGTON CO. BOARD OF EDUCATION - PARCEL H-4-2-13-1492.
	PROPOSED PETITION AREA BOUNDARY LINE	H-3-2-6-33	K REV INVEST I LP, PERRY J FALK, ET AL - PARCEL H-3-2-6-1407.
		H-4-2-1-1103	L DOS RIOS LC - PARCEL H-3-2-6-1409.
		H-4-2-1-1104	M VIRTUS INVESTMENTS 1 - PARCELS H-3-1-31-220 & H-3-1-31-221.
		H-4-2-1-1107	R QUESTAR GAS - PARCEL H-4-2-1-131
		H-4-2-1-1108	
		H-4-2-1-1109	
		H-4-2-1-1113	
		H-4-2-1-1123	
		H-4-2-1-125	
		H-4-2-11-127	
		H-4-2-13-1410	
		H-4-2-11-2103	
		H-4-2-11-2112	
		H-4-2-1-131	
		H-4-2-11-31031	
		H-4-2-12-130	
		H-4-2-12-131	
		H-4-2-12-2113	
		H-4-2-13-1409	
		H-4-2-13-2114	
		H-4-2-14-1101	
		H-4-2-1-4203	
		C - SH HOLDINGS LLC PARCELS:	
		H-4-2-11-21121	
		D - GLAMPERS INN LLC PARCELS:	
		H-3-2-6-330	
		E - JASON AND HOLLY CURTIS PARCEL:	
		H-4-2-1-340	
		J - SECURE PRIVATE FUND LLC - PARCEL	
		H-4-2-1-234.	
		N - BASH RESORTS LLC:	
		H-4-2-12-2113	
		O - CROWTHER ELM LLC:	
		H-4-2-11-243	

EXHIBIT A: SHEET NO. 1 OF 1	JOB NO. 336-005	DATE: 5/1/2011 SCALE: 1"=100'	EXHIBIT A:: GATEWAY AT S.H. DISTRICT BOUNDARY MAP SAND HOLLOW RD HURRICANE, WASHINGTON COUNTY, UTAH		PROVALUE ENGINEERING, INC. Engineers - Land Surveyors - Land Planners 20 South 850 West, Suite 1 Hurricane City, Utah 84757 Phone: (435) 668-8307	<table border="1" style="width: 100%; border-collapse: collapse;"> <thead> <tr> <th colspan="4" style="text-align: center;">REVISIONS</th> </tr> <tr> <th style="width: 10%;">NO</th> <th style="width: 50%;">DESCRIPTION</th> <th style="width: 20%;">DATE</th> <th style="width: 20%;">BY</th> </tr> </thead> <tbody> <tr> <td> </td> <td> </td> <td> </td> <td> </td> </tr> <tr> <td> </td> <td> </td> <td> </td> <td> </td> </tr> </tbody> </table>	REVISIONS				NO	DESCRIPTION	DATE	BY								
REVISIONS																						
NO	DESCRIPTION	DATE	BY																			

COPYRIGHT © 2013 provalue engineering inc.