

# CONTRACTOR'S YARD FOR SALE/LEASE

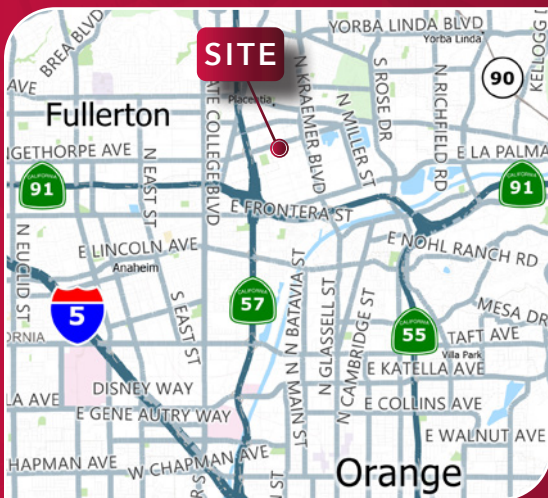

## 1442 N Red Gum St Anaheim | CA

- ±19,321 SF Contractor's Yard
- Fully Fenced with Partial Concrete Pavement
- Drive-Thru Property with Three (3) Points of Entry
- Curb and Gutter in Place
- Excellent East Anaheim Location
- Vacant and Available for Immediate Occupancy
- Easy Access to the 5, 57, 91, and 55 Freeways
- SP 2015-1 Zoning

FOR MORE INFORMATION PLEASE CONTACT:

### Luke Hudson

Principal | Lee & Associates

D: 714.564.7154

C: 714.614.2522

lhudson@lee-associates.com

DRE# 01870037

### Dennis Holt

Vice President | Daum

D: 949.242.1714

C: 714.423.0169

dennis.holt@daumcommercial.com

DRE# 01948978



All information contained herein has been provided by Seller/Lessor and/or third parties, but has not been independently verified by Lee & Associates or its agent(s). Buyer/Lessee and interested parties should independently verify all information communicated by these sources.

# FOR SALE/LEASE

±19,321 SF

CONTRACTOR'S YARD

1442

N Red Gum St  
Anaheim | CA

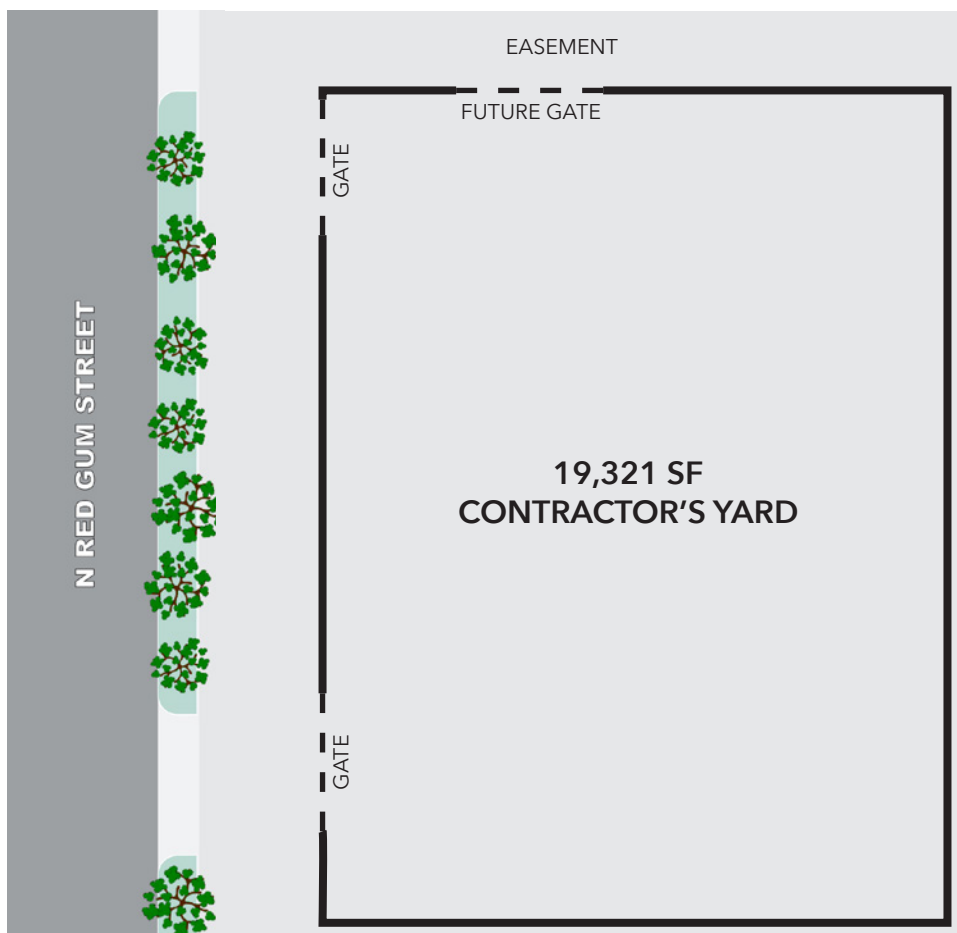

Not to Scale



FOR MORE INFORMATION PLEASE CONTACT:

## Luke Hudson

Principal | Lee & Associates

D: 714.564.7154

C: 714.614.2522

lhudson@lee-associates.com

DRE# 01870037

## Dennis Holt

Vice President | Daum

D: 949.242.1714

C: 714.423.0169

dennis.holt@daumcommercial.com

DRE# 01948978



All information contained herein has been provided by Seller/Lessor and/or third parties, but has not been independently verified by Lee & Associates or its agent(s). Buyer/Lessee and interested parties should independently verify all information communicated by these sources.