



W I N L O W
W E S T H E I M E R
D I S T R I C T

SECOND GEN RESTAURANT AVAILABLE

1915 Westheimer Road Houston, TX 77098

THE PHOENIX PUB

City Houston

Neighborhood Montrose

Year Built 1948

Type Restaurant

Available September 1, 2026

Size 3,637 SF with patio

Rent Call for pricing



DO NOT DISTURB TENANT

Winlow Westheimer District is an architecturally significant retail center in the heart of Montrose. The project combines several pre-World War II masonry buildings into a pedestrian destination, indicative of European gathering places, which are conspicuously absent in Houston. The Montrose neighborhood includes some of the nation's greatest museums, restaurants and historic homes, and is conveniently located between River Oaks, Rice University and Downtown. Importantly, Montrose is one of Houston's few truly urban and walkable areas.

SITE PLAN

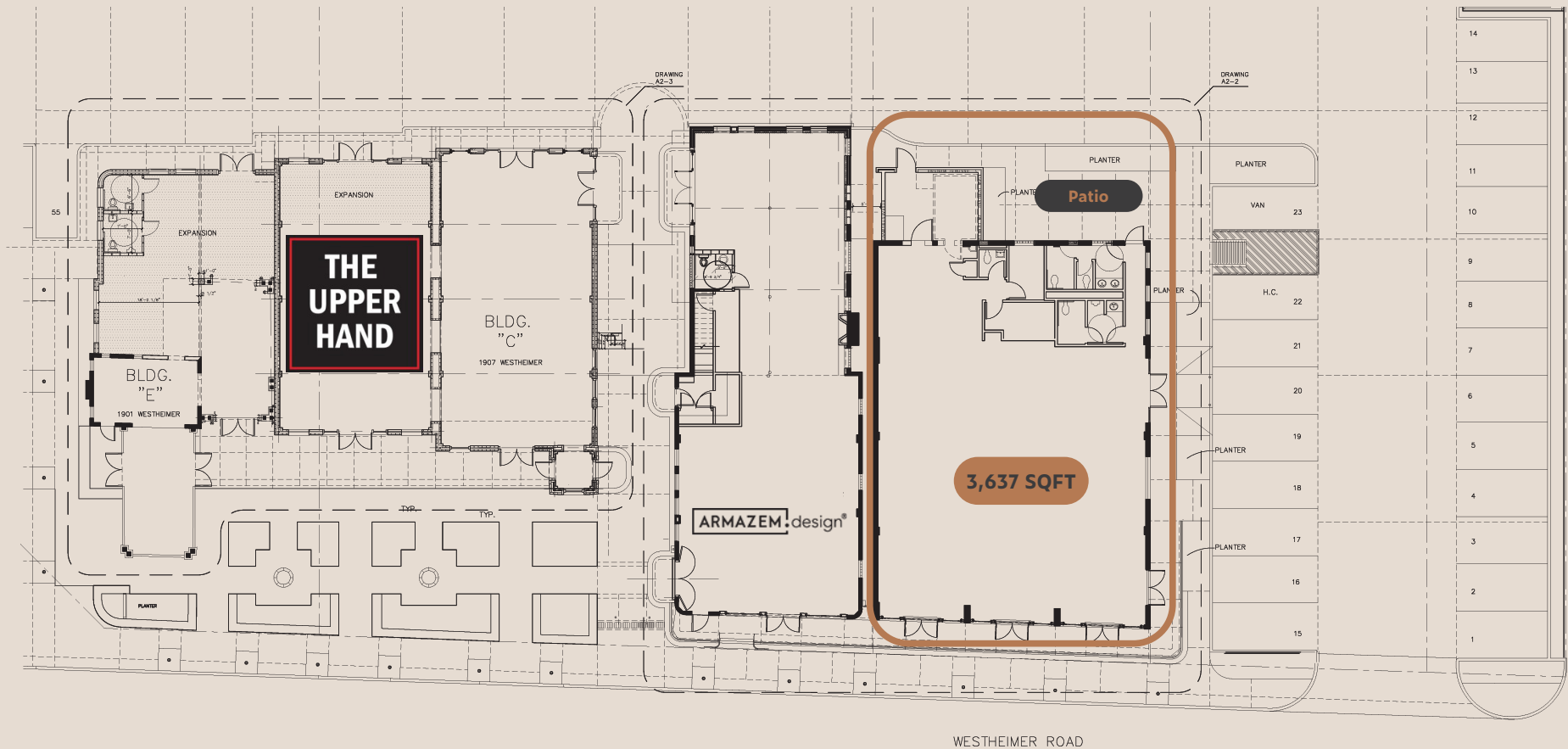

Available
September 2026

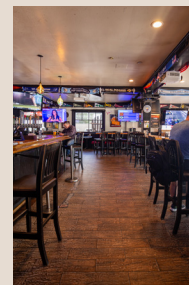

PHOTOGRAPHY



KITCHEN PHOTOGRAPHY



PREMIER PLACEMENT

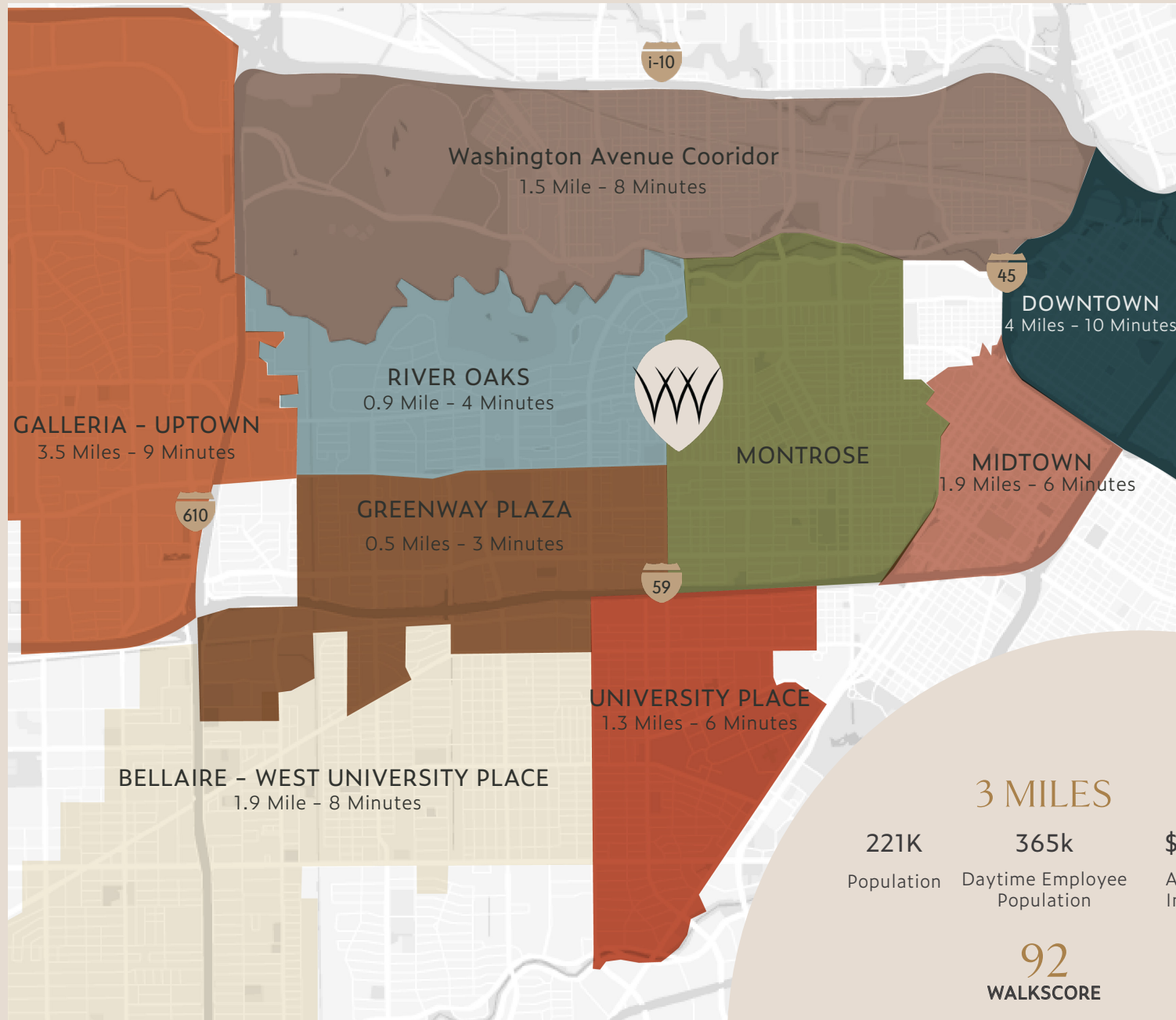

WINLOW WESTHEIMER

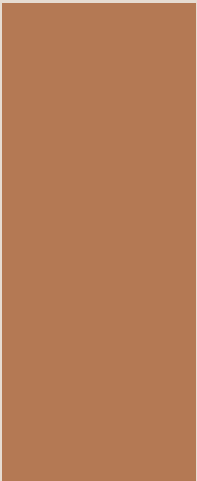

CONTACT

713-783-4444

611 W, 22nd Street, Suite 203
Houston, TX 77008

Barton Kelly

Barton@Radomcapital.com

Byron Sullivan

Byron@Radomcapital.com

