



MAIN STREET CROSSING | 6402 WILKINSON BLVD | BELMONT

Variable retail space available in popular shopping center fronting Wilkinson Blvd, Highway 74.

SAM KLINE, CCIM
c 704 777 6003
skline@mecacommercial.com





PROPERTY INFORMATION

SHOPPING CENTER GLA

65,572 SF*

SUITE AVAILABLE

Suite - 1,200 SF*

FEATURES

- Cohesive mix of retail tenants, including Aldi, Burn Boot Camp and Dollar Tree
- Second generation space in Belmont
- Highly visible location on well-travelled Wilkinson Blvd.
- Close proximity to I-85 and Downtown Belmont
- Three access points off Wilkinson Blvd. (AADT 23K) and one off of Main St. (AADT 16K)
- Strong grocery-driven traffic
- TICAM is approximately \$3.50 per SF annually

LEASE RATE

\$22 per SF NNN



SAM KLINE, CCIM

c 704 777 6003

skline@mecacommercial.com

MECA Commercial Real Estate

102 Main Street, Suite 110

McAdenville, NC 28101

704 971 2000



MECA
COMMERCIAL REAL ESTATE

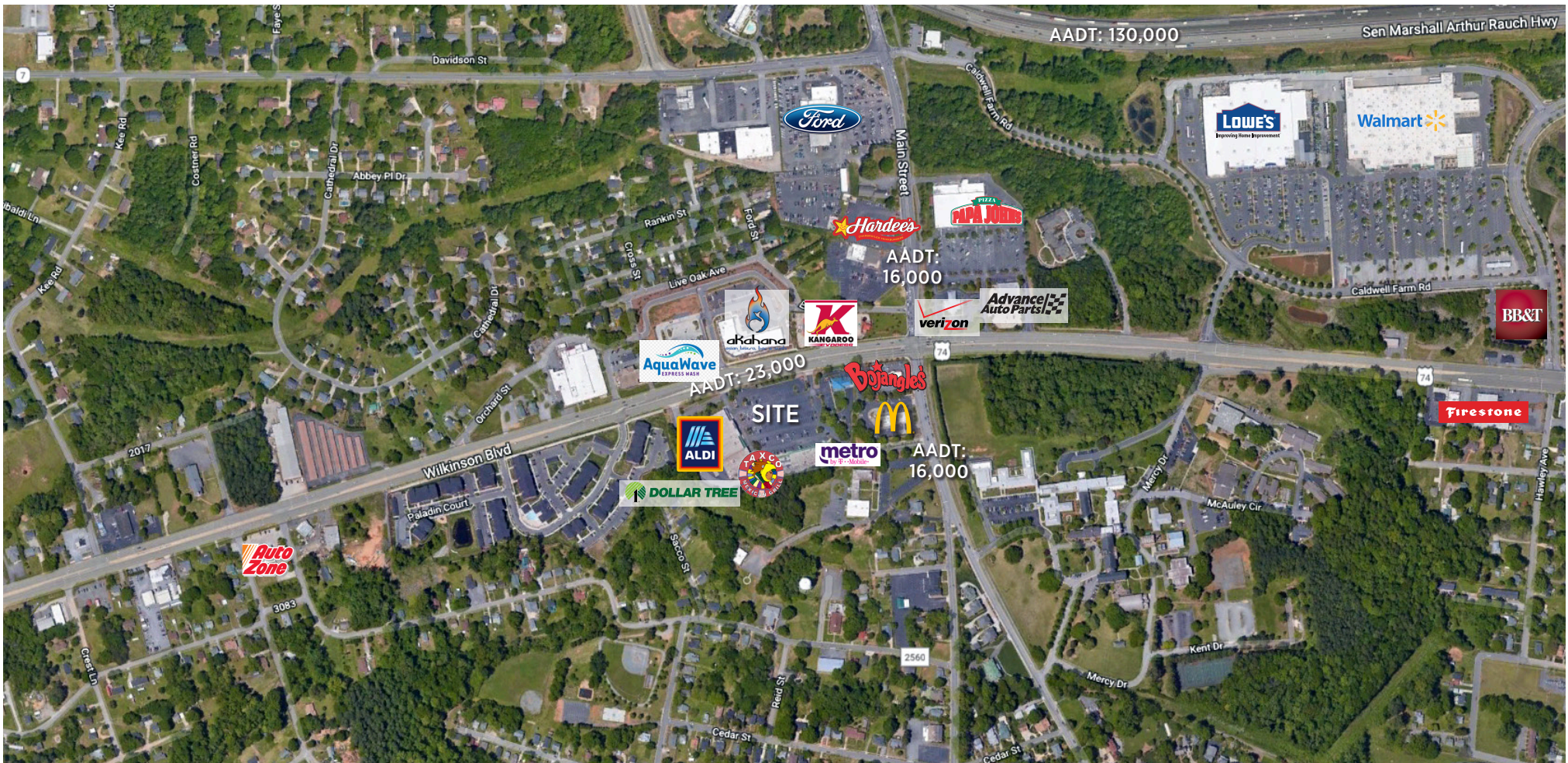

Traffic counts are provided by Kalibrate Technologies plc using TrafficMetrix Data. Traffic Counts displayed is a 2 miles radius from centroid of the location.

SAM KLINE, CCIM
c 704 777 6003

skline@mecacommercial.com

MECA Commercial Real Estate
102 Main Street, Suite 110
McAdenville, NC 28101
704 971 2000



MECA
COMMERCIAL REAL ESTATE

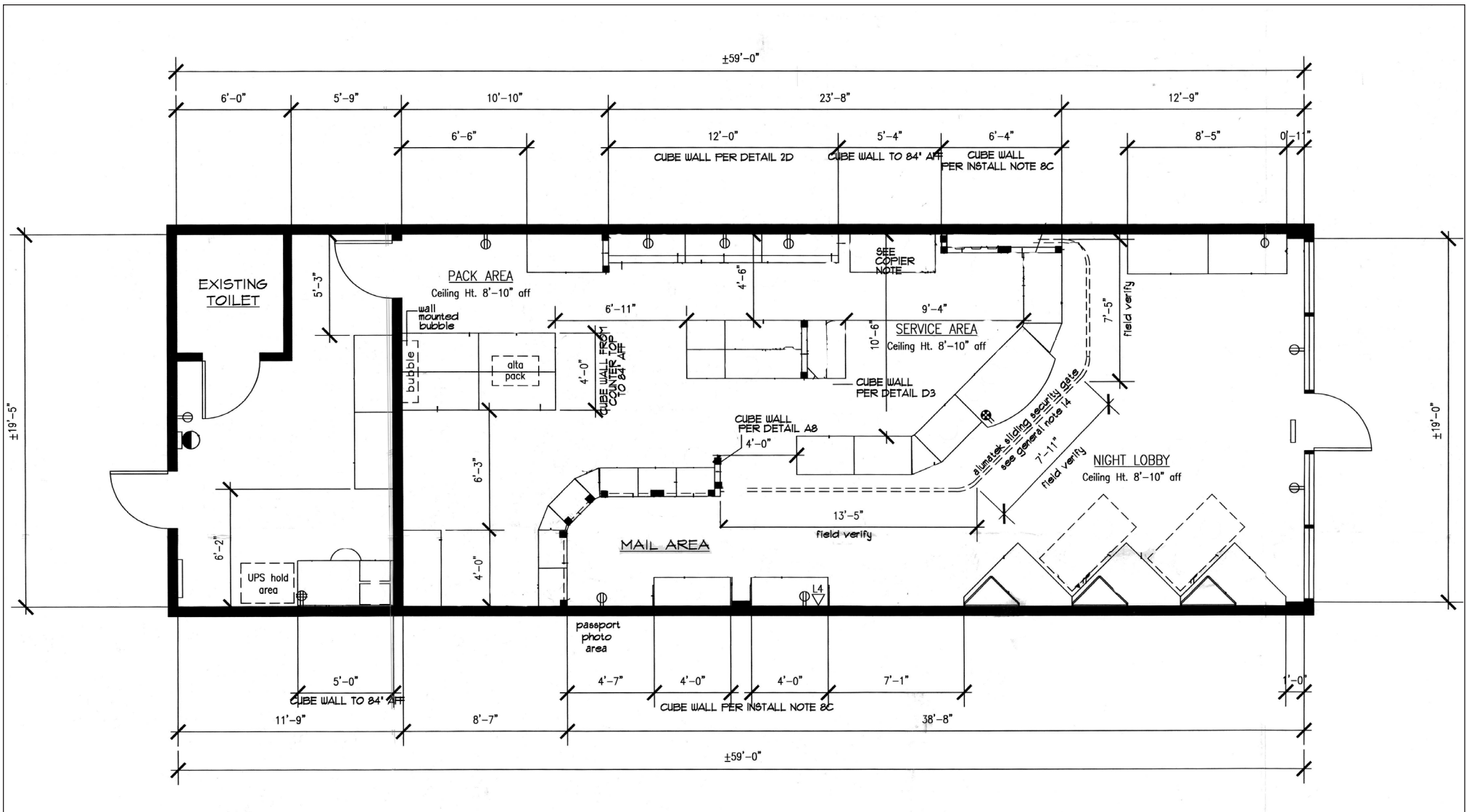

SAM KLINE, CCIM

c 704 777 6003

skline@mecacommercial.com

MECA Commercial Real Estate

102 Main Street, Suite 110

McAdenville, NC 28101

704 971 2000

mecacommercial.com

© 2023 Metro Realty, LLC. All rights reserved. Metro Realty, LLC fully supports the principles of the Fair Housing Act and the Equal Opportunity Act. Each franchise is independently owned and operated.

*The land acreage and/or building square footage was obtained from the County's Geographical Information System or other electronic resources. For exact square footage and/or acreage, we recommend that prior to purchase, a prospective Buyer/Tenant obtain a boundary survey or have the building measured professionally.



MECA
COMMERCIAL REAL ESTATE