

FOR SALE

800 WESTINGHOUSE BLVD CHARLOTTE, NC ±124,560 SF



PROPERTY HIGHLIGHTS

- EXCEPTIONAL LOCATION
- HEAVY INDUSTRIAL ZONING (ML-2)
- FORMER FOOD GRADE FACILITY
- HEAVY POWER
- RAIL SPUR

800 WESTINGHOUSE BLVD



BUILDING SIZE
± 124,560 SF

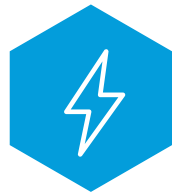

HEAVY POWER
3000 AMPS/ 3 Phase / 480V
TRANSFORMER 1: 1000 KVA
TRANSFORMER 2: 750 KVA

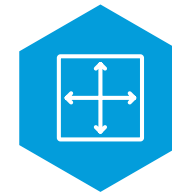

ZONING
ML-2 (Formerly I-2)



RAIL SERVED
INACTIVE



AUTO PARKING
122 Spaces

BUILDING SPECIFICATIONS



For Sale:	Subject to Offer
Parcel ID:	203-062-03
Land:	9.00 Acres
Zoning:	ML-2 (Formerly I-2)
Year Built:	1965 / 1970
Total SF:	± 124,560 SF
Main Office:	12,160 SF
Warehouse SF:	112,400 SF
Warehouse Office:	6,300 SF
Warehouse Mezz:	3,500 SF
Food Grade / Conditioned Warehouse:	55,900 SF
Unconditioned Warehouse:	56,500 SF
Clear Height:	16' - 18'3"
Roof:	Sawtooth (Est. 1999)
HVAC Units:	15 Units, 3 Office, 12 Warehouse
Lighting:	LED (Converted)
Sprinkler System:	Wet
Column Spacing:	28' x 50' Warehouse and 24' x 64' Conditioned Warehouse
Power:	3000 AMPS/ 3 Phase / 480V
Transformers:	1000 KVA + 750 KVA
Dock Highs:	7 Dock High w/ Pit Levelers, 6 w/ Swing Arm Lights, Locks, Seals, & Bumpers
Grade Level:	1 Grade Level (10' x 10')
Rail Doors:	4 Rail Doors (10' x 10')
Rail:	Norfolk Southern (Inactive)
Auto Parking:	122 Spaces
Truck Court:	135' (Fenced)

FLOOR PLAN

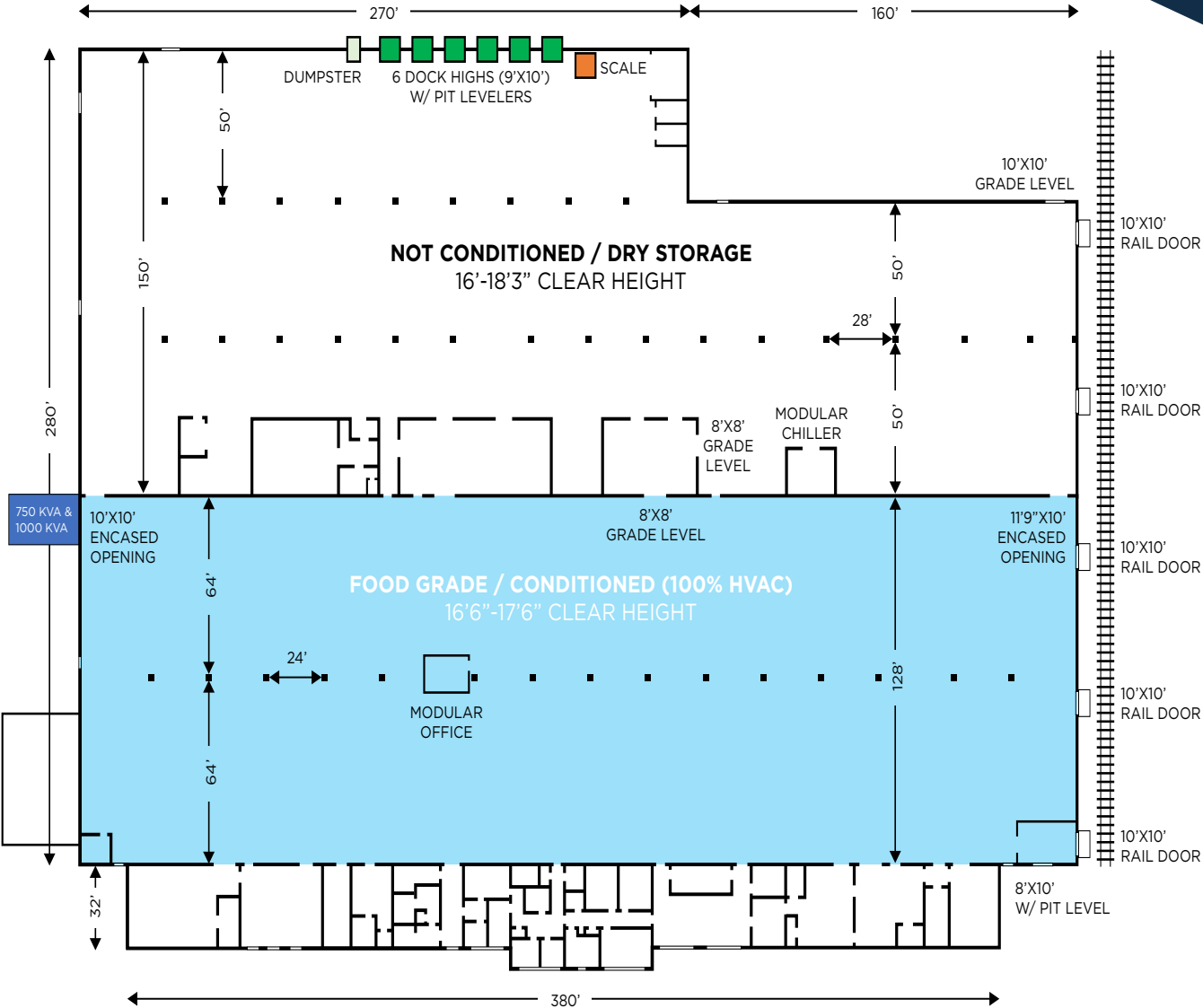

CORPORATE NEIGHBORS



INCREDIBLE ACCESS

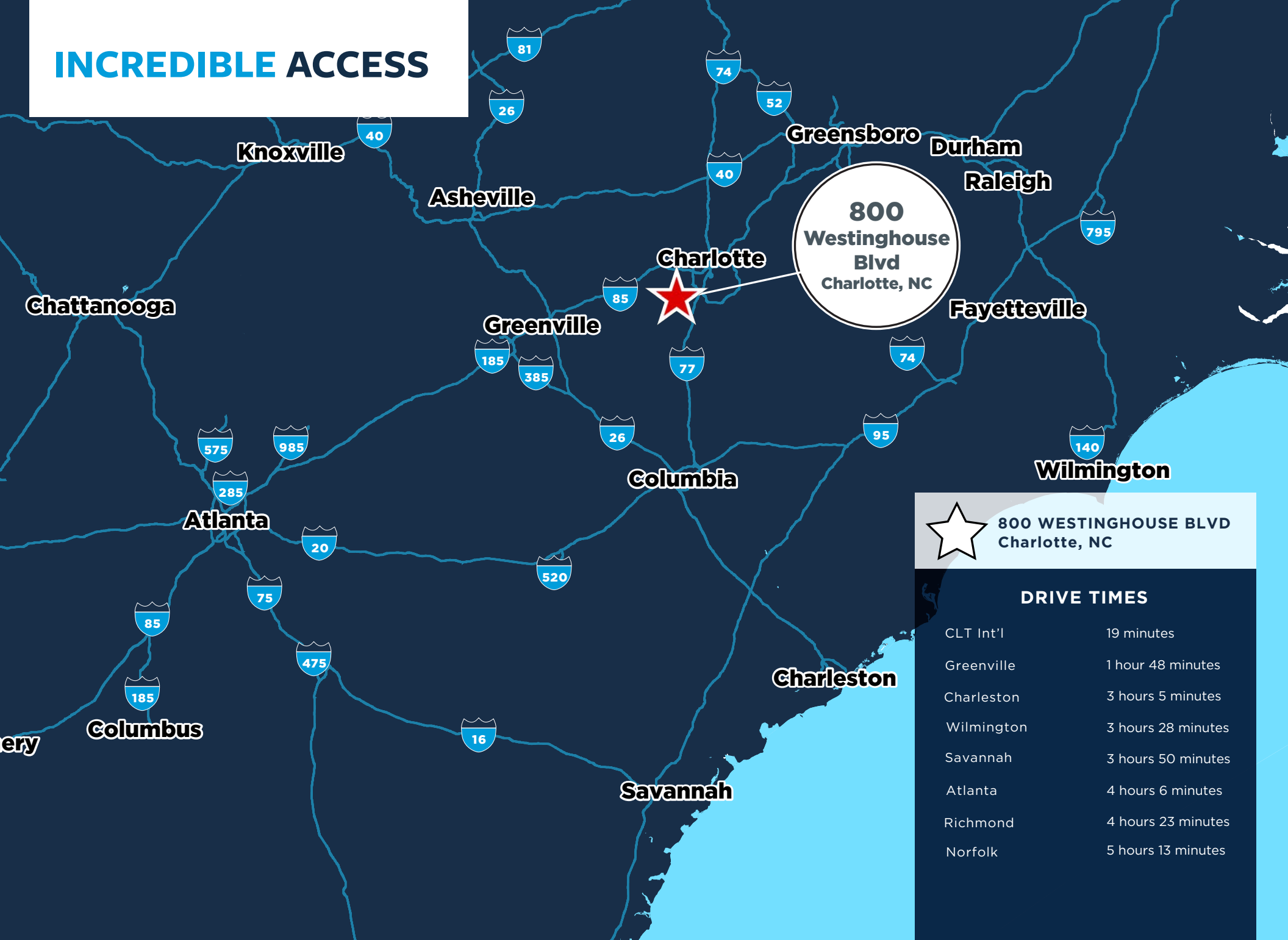

 800 WESTINGHOUSE BLVD
Charlotte, NC

DRIVE TIMES

CLT Int'l	19 minutes
Greenville	1 hour 48 minutes
Charleston	3 hours 5 minutes
Wilmington	3 hours 28 minutes
Savannah	3 hours 50 minutes
Atlanta	4 hours 6 minutes
Richmond	4 hours 23 minutes
Norfolk	5 hours 13 minutes



For More Information, Please Contact:

Andrew DeLamielleure
+1 704 887 3020
andrew.delamielleure@cushwake.com

Frances Crisler
+1 704 620 6014
frances.crisler@cushwake.com

©2024 Cushman & Wakefield. All rights reserved. The information contained in this communication is strictly confidential. This information has been obtained from sources believed to be reliable but has not been verified. NO WARRANTY OR REPRESENTATION, EXPRESS OR IMPLIED, IS MADE AS TO THE CONDITION OF THE PROPERTY (OR PROPERTIES) REFERENCED HEREIN OR AS TO THE ACCURACY OR COMPLETENESS OF THE INFORMATION CONTAINED HEREIN, AND SAME IS SUBMITTED SUBJECT TO ERRORS, OMISSIONS, CHANGE OF PRICE, RENTAL OR OTHER CONDITIONS, WITHDRAWAL WITHOUT NOTICE, AND TO ANY SPECIAL LISTING CONDITIONS IMPOSED BY THE PROPERTY OWNER(S). ANY PROJECTIONS, OPINIONS OR ESTIMATES ARE SUBJECT TO UNCERTAINTY AND DO NOT SIGNIFY CURRENT OR FUTURE PROPERTY PERFORMANCE.

