



1920 Georgetown Rd.

Hudson, OH 44236

Property Features

- Available space: 10,000 SF
- 1st floor & 2nd floor availability
- Divisible by 2,500 SF (approximate)
- Situated on 5 acres providing an abundance of land for expansion
- Parking: 70 surface spaces
- Easily accessible from I-80 OH Turnpike & Darrow Rd.
- Major renovations over the last 6 months: new carpet, lighting, and exterior
- Hudson Gig
- Main electrical: 200 Amp
- Central fire alarm



Ronald Midcap II

+1 216 455 0900 | RMidcap@naipvc.com









Floor Plans

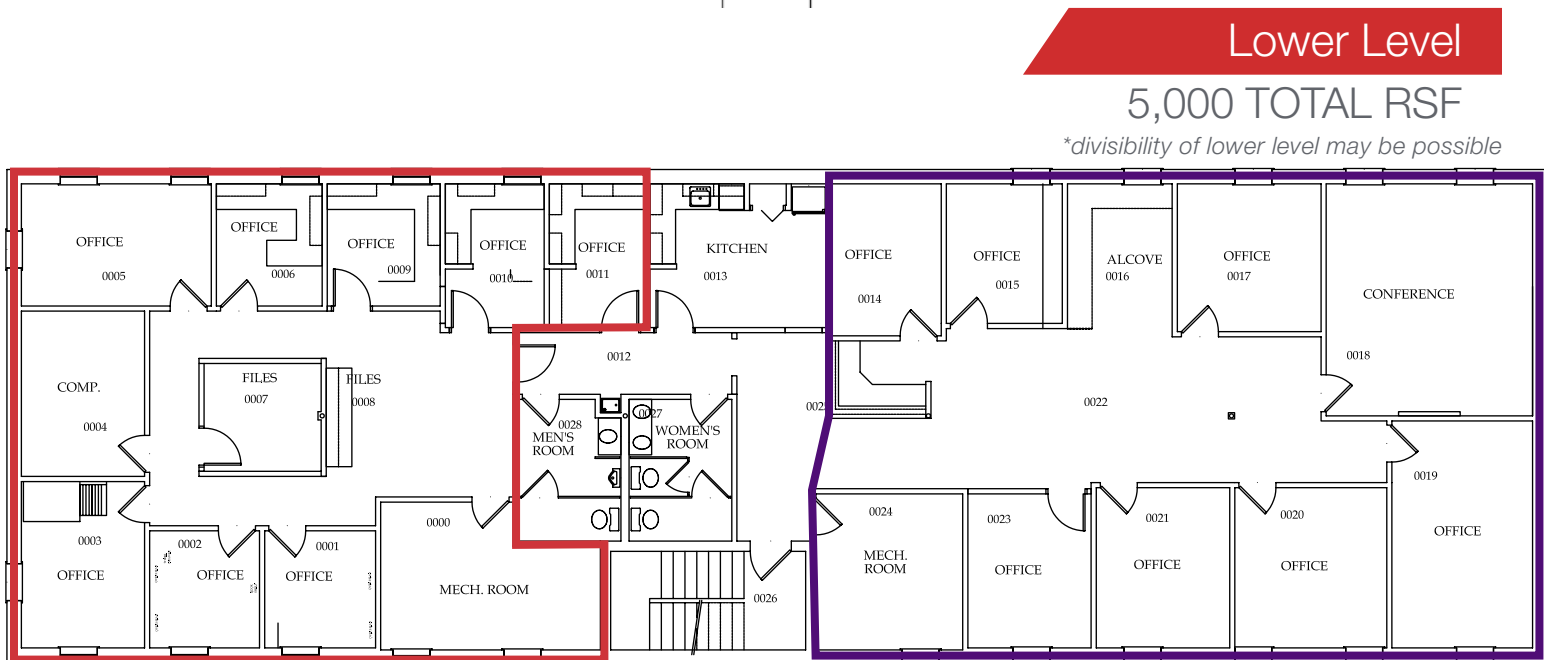

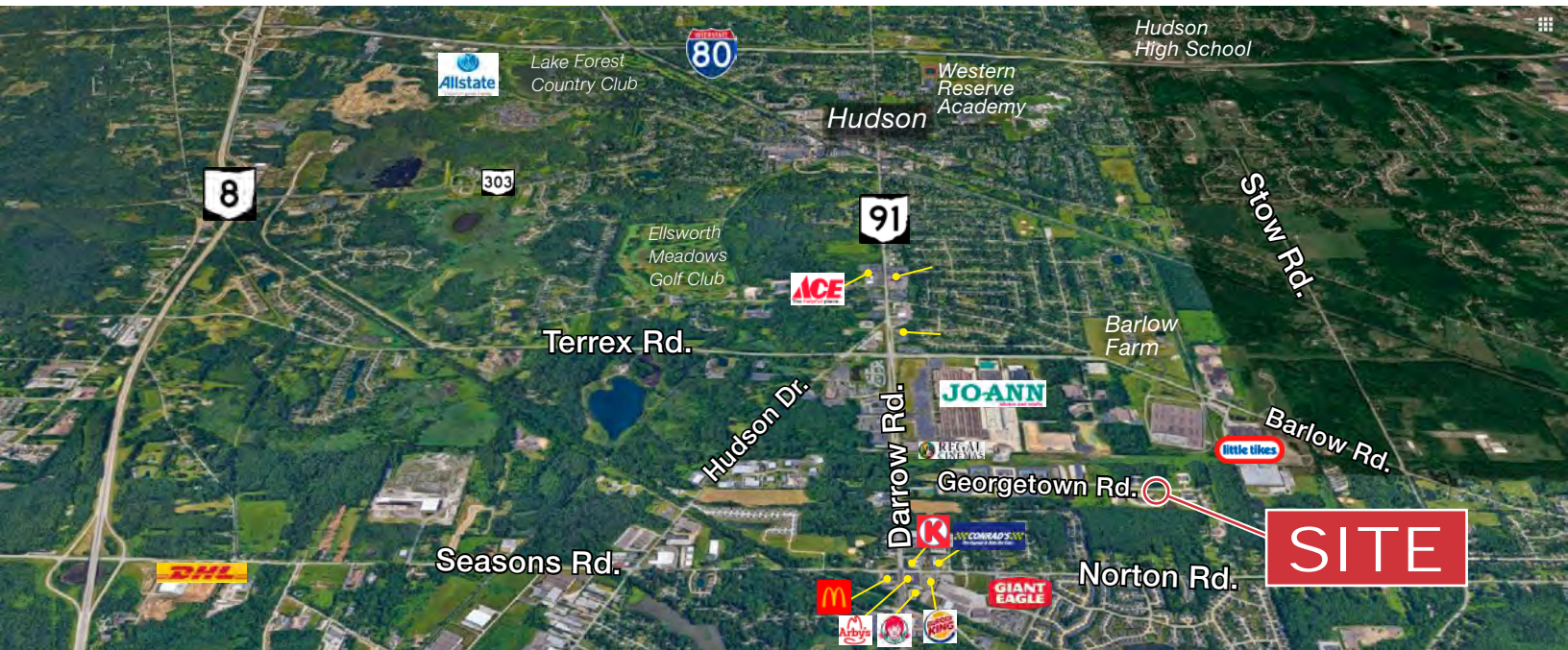
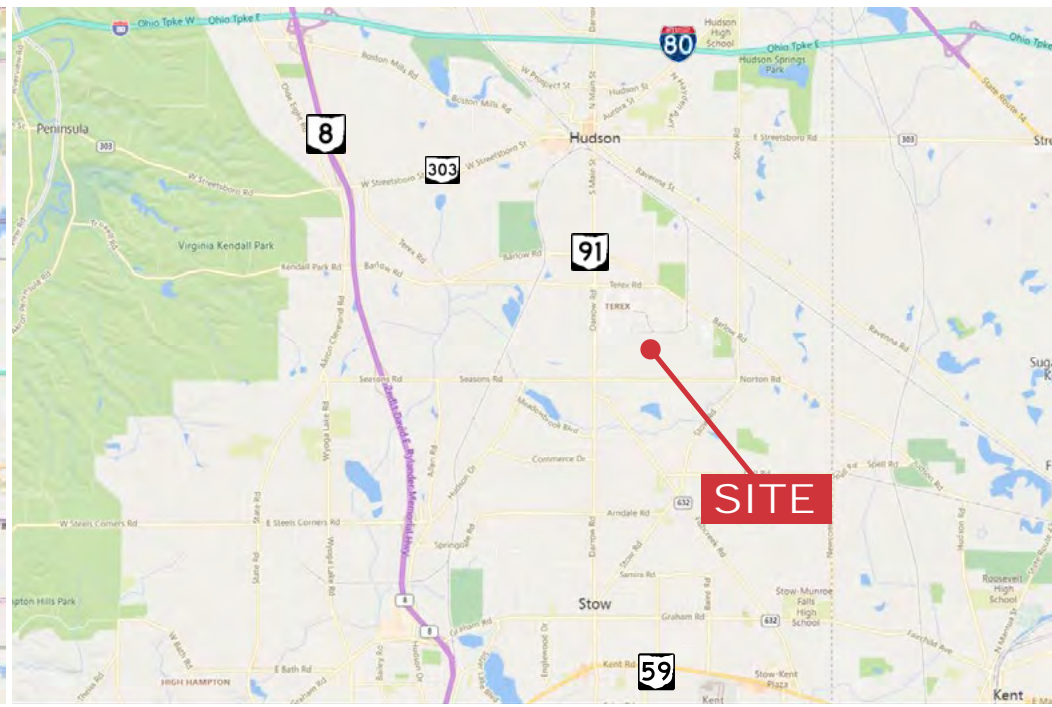
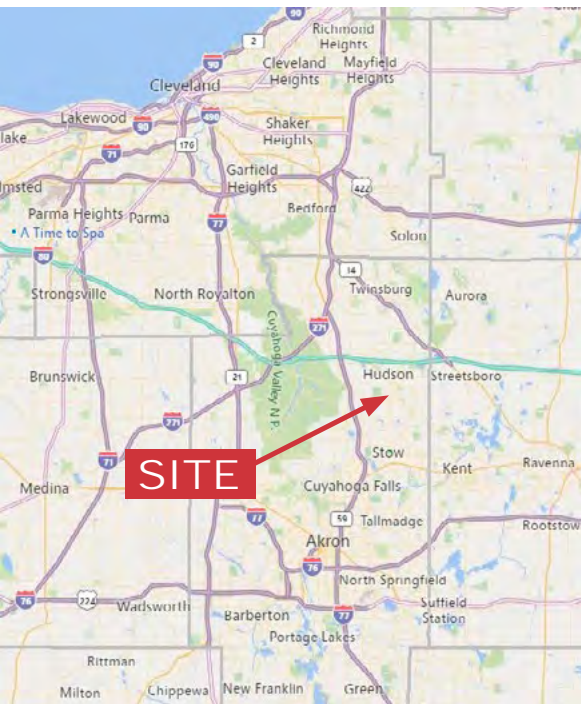

Demographics	1 Mile	3 Miles	5 Miles
Population:	3,914	36,909	90,621
Median Age:	38.7	42.5	43
Average HH Income:	\$127,283	\$117,304	\$119,808
Traffic Count:	19,980 CPD Darrow Rd. @ Norton Rd.		

