



PARAMARK
Real Estate Services

FOR LEASE

**MULTIPLE
SPACES
AVAILABLE**

1620 SOUTH BROADWAY, ROCHESTER, MN



PROPERTY HIGHLIGHTS:

- National co-tenancy including Caribou
- High Traffic, High Visibility location
- Endcap with drive-through is available
- High ceilings
- Full glass frontage



Contact information:

Darci Fenske

(507) 421-6556

dfenske@paramark.us



PARAMARK
Real Estate Services

© 2021 Paramark Real Estate Services. No warranty or representation, express or implied, is made to the accuracy or completeness of the information contained herein, and same is submitted subject to errors, omissions, change in price, rental or other conditions, withdrawal without notice, and to any special listing conditions imposed by the property owner(s). As applicable, we make no representation as to the condition of the property (or properties) in question.



PARAMARK

Real Estate Services

FOR LEASE

**MULTIPLE
SPACES
AVAILABLE**

1620 SOUTH BROADWAY, ROCHESTER, MN

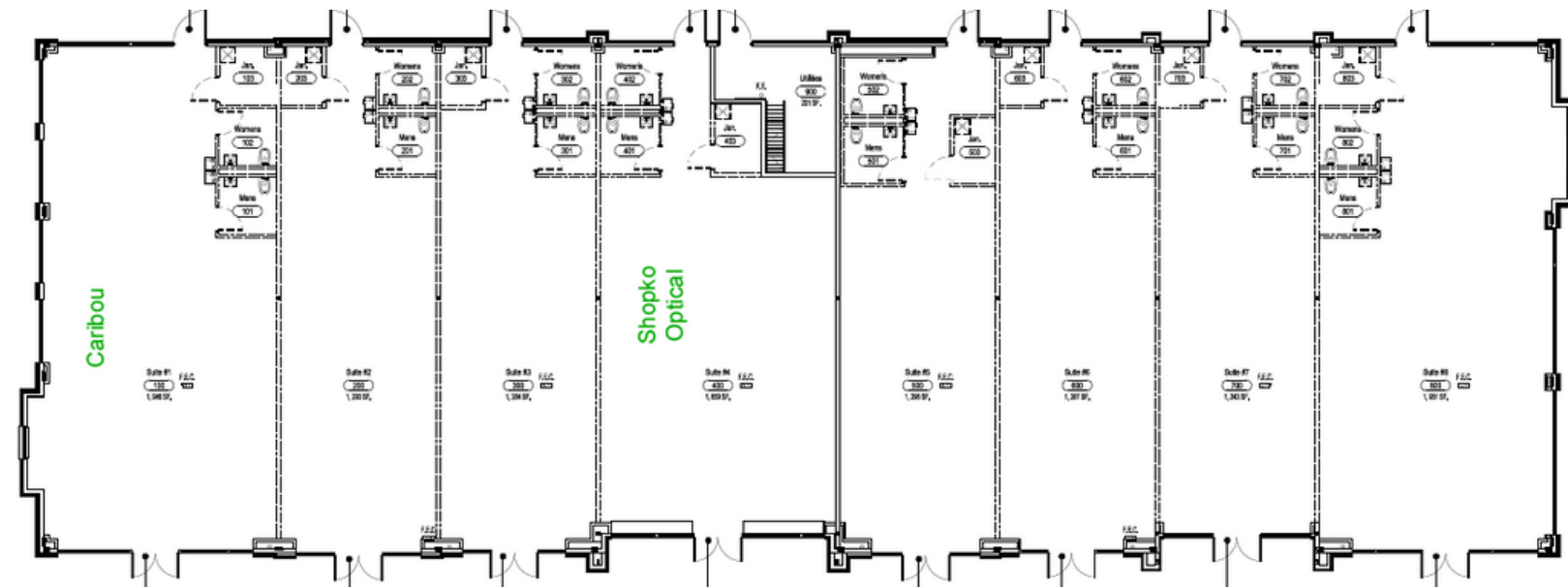

PARAMARK
Real Estate Services

© 2021 Paramark Real Estate Services. No warranty or representation, express or implied, is made to the accuracy or completeness of the information contained herein, and same is submitted subject to errors, omissions, change in price, rental or other conditions, withdrawal without notice, and to any special listing conditions imposed by the property owner(s). As applicable, we make no representation as to the condition of the property (or properties) in question.



PARAMARK

Real Estate Services

FOR LEASE

**MULTIPLE
SPACES
AVAILABLE**

1620 SOUTH BROADWAY, ROCHESTER, MN



 **PARAMARK**
Real Estate Services

© 2021 Paramark Real Estate Services. No warranty or representation, express or implied, is made to the accuracy or completeness of the information contained herein, and same is submitted subject to errors, omissions, change in price, rental or other conditions, withdrawal without notice, and to any special listing conditions imposed by the property owner(s). As applicable, we make no representation as to the condition of the property (or properties) in question.