

8528

DICE ROAD, SANTA FE SPRINGS

± 12,591 SF FREESTANDING INDUSTRIAL BUILDING



FOR SALE

OWNER/USER OR
INVESTOR OPPORTUNITY

Voit
REAL ESTATE SERVICES

BC
BOUMA CAPUTO

BUILDING ADDRESS	8528 Dice Road, Santa Fe Springs, CA
BUILDING SIZE	± 12,591 SF Freestanding Industrial Building
OFFICE SIZE	± 1,500 SF
LAND SIZE	± .60 Acres
WAREHOUSE CEILING CLEARANCE	± 16' Warehouse Clearance
POWER	Heavy Power (<i>Buyer to Verify</i>)
PARKING	2/1,000 Parking Ratio
YARD	Large Fenced Yard
GROUND LEVEL DOORS	Two (2) Ground Level Doors
YEAR BUILT	1965
ZONING	SSM2
PARCEL NUMBER	8168-023-030
OTHER	Freestanding Building, Corner Location, Fenced Yard
CURRENT LEASE	November 1, 2023 - October 31, 2024: \$10,654.00/mo. IG November 1, 2024 - October 31, 2025: \$10,974.00/mo. IG

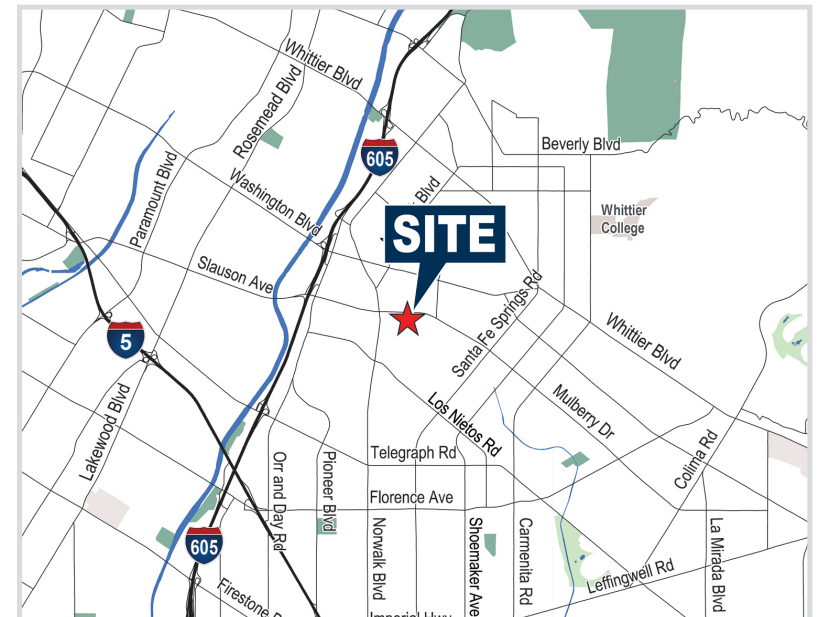

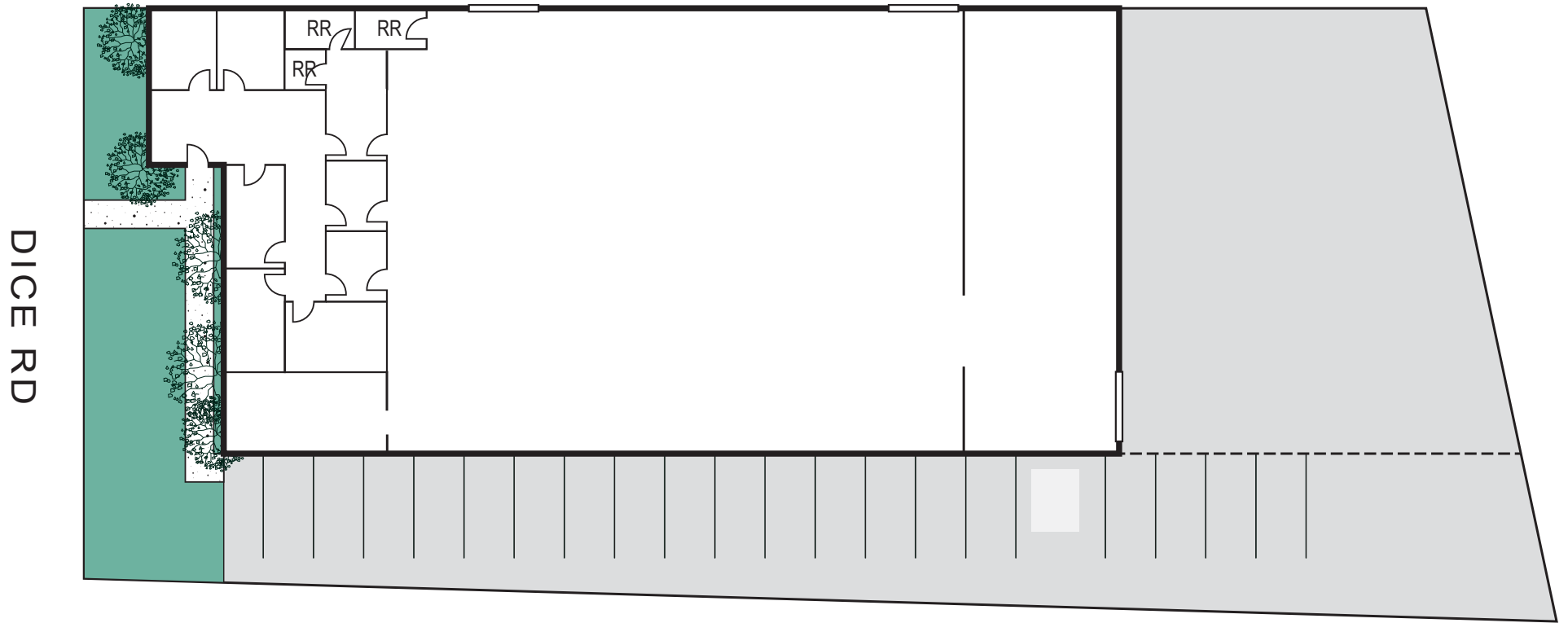

8528

DICE ROAD, SANTA FE SPRINGS

± 12,591 SF FREESTANDING INDUSTRIAL BUILDING



Exclusively
Offered by:

Voit
REAL ESTATE SERVICES

BC
BOUMA CAPUTO

Mike Bouma, SIOR
Senior Vice President | Partner
Lic #01070753
714-935-2340
mbouma@voitco.com

Paul Caputo, MBA
Senior Vice President
Lic #01196935
714-935-2332
pcaputo@voitco.com

2400 E. Katella Ave., Suite 750, Anaheim, CA 92806 • 714.978.7880 • 714.978.9431 Fax | www.BoumaCaputo.com