



Maitland
Summit

Orlando's Premier Office Park

Your Gateway to Inspired Work
in the Heart of Vibrant Orlando





Welcome to Maitland Summit

This highly sought-after business destination boasts a prime location and is thoughtfully designed to accommodate the unique needs of today's firms. With customizable spaces perfectly suited for all sizes and professions, Maitland Summit offers the ultimate environment for productivity and success.



Maitland Summit I

1950 Summit Park Dr, Maitland, FL 32751



Maitland Summit II

1958 Summit Park Dr, Maitland, FL 32751



Maitland Summit IV

1901 Summit Tower Blvd, Maitland, FL 32751



Maitland Summit III

2001 Summit Park Dr, Maitland, FL 32751

Tenant-Only
Parking Garages



Park Overview



Maitland Summit I

Building size: 128,240 SF

Typical floor: 21,373 SF



Maitland Summit III

Building size: 211,236 SF

Typical floor: 30,176 SF



Maitland Summit II

Building size: 128,934 SF

Typical floor: 21,489 SF



Maitland Summit IV

Building size: 120,268 SF

Typical floor: 30,067 SF



Experience Exclusive Amenities

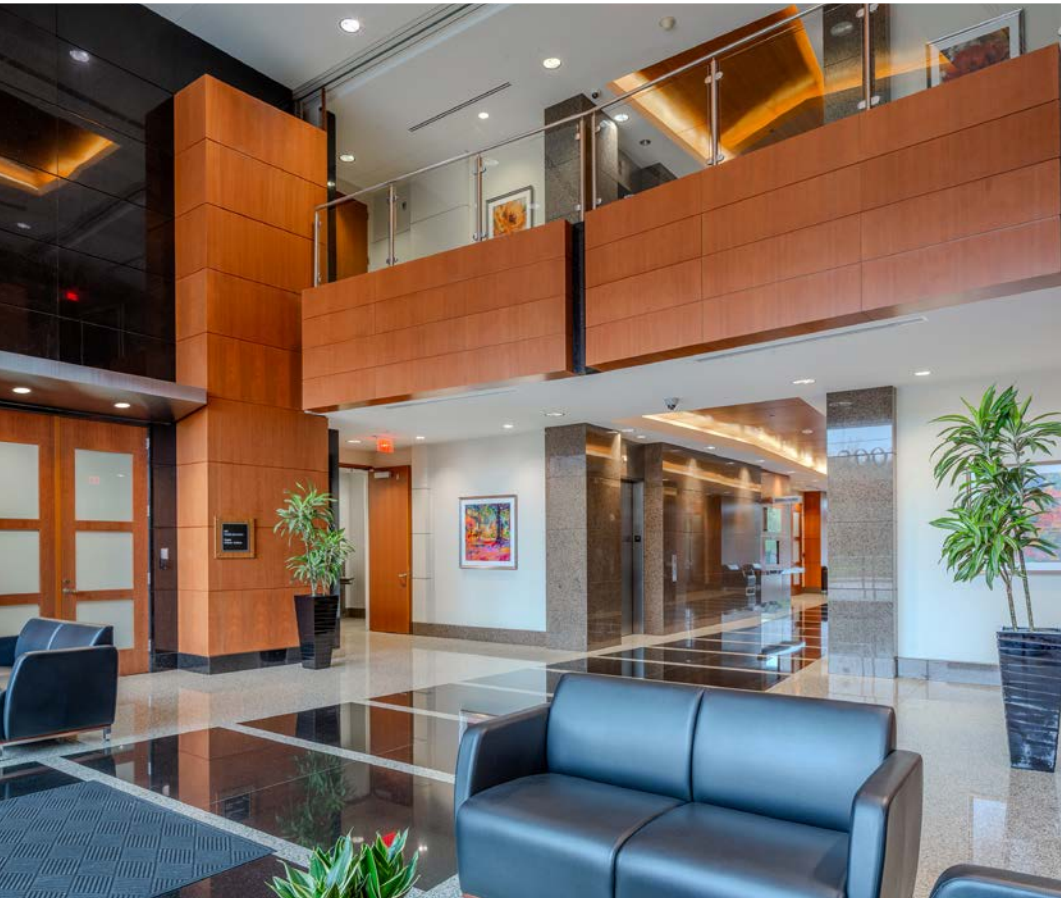

Conferencing
facility



Café and
restaurant



Fitness center and
locker rooms with showers



Manicured walking
trail around
a beautiful
water feature



Two tenant-only
parking garages,
in addition to
surface parking



Illuminated
monument
signage



Directly adjacent
to the
RDV sportsplex

Convenience When and Where You Need It

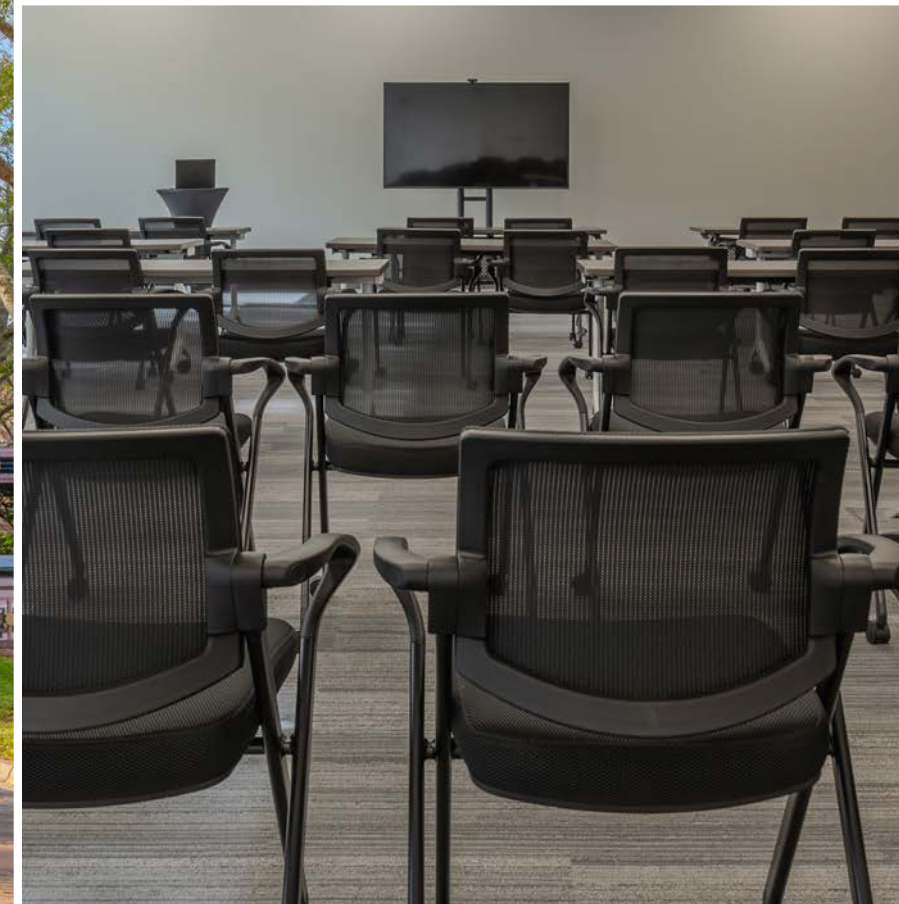

View from The Summit

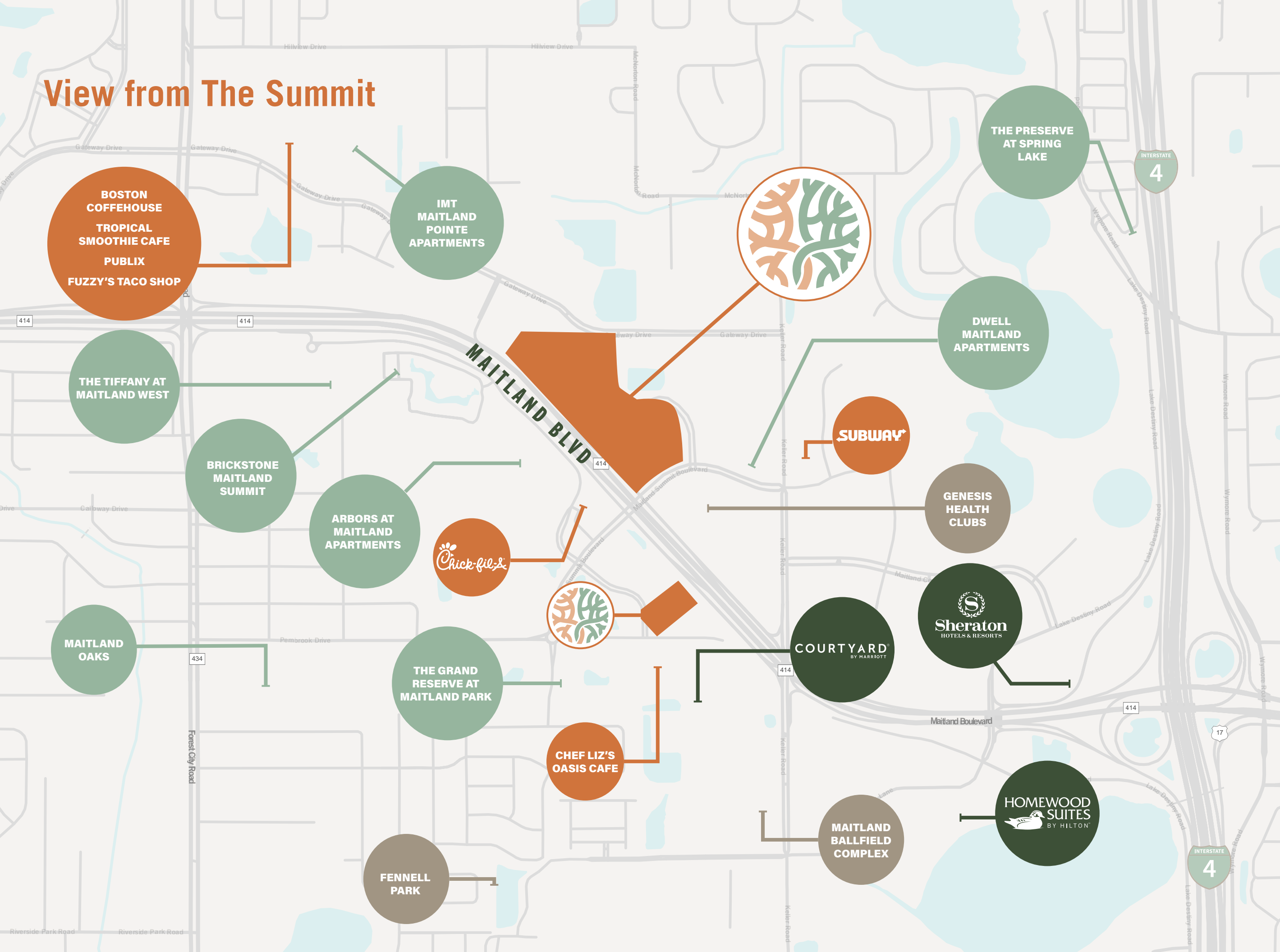

Dining



Hospitality



Health & Wellness



Multifamily

Orlando Market Overview

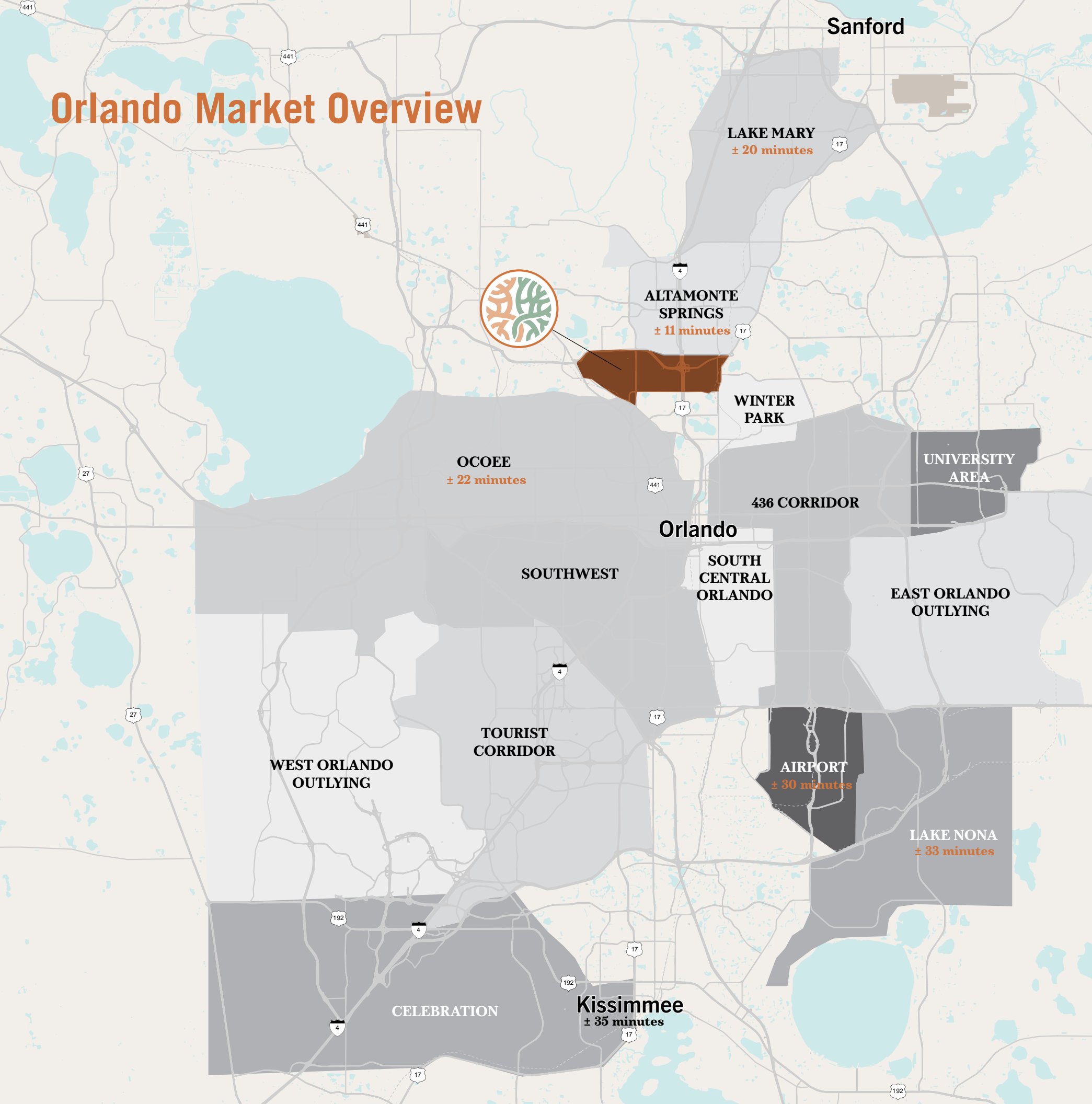

Office leasing by industry 2019-2023

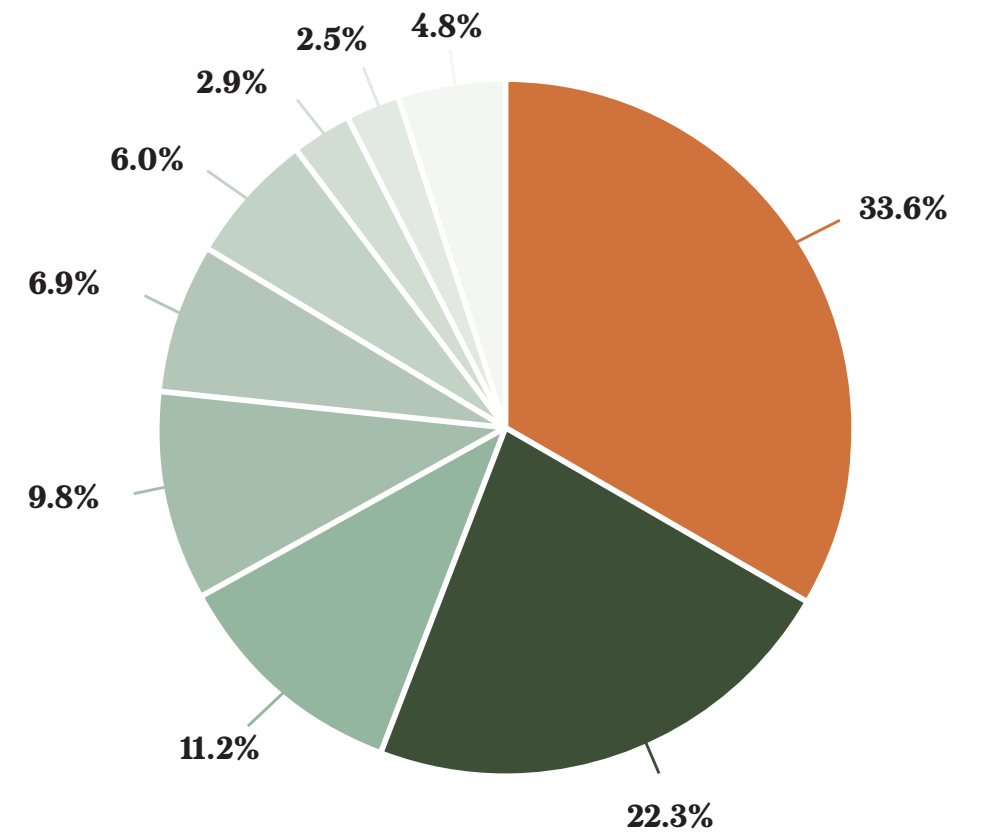

- Finance
- Professional & Business Services
- Health
- Logistics & Distribution
- Technology
- Media
- Energy & Utilities
- Government
- Other

Top Industries: Finance, Professional & Business Services, Healthcare, and Technology.

Residential base consists of high-end executive housing, with higher median household income and higher median home values in Maitland compared to the Orlando market as a whole.

Per capita income in Maitland exceeds the overall Orlando market, with significantly less people living in poverty.



Your Landlord Matters

At CP Group, we place a premium on customer service and pride ourselves on transforming spaces into activated environments that drive productivity, build community, and help you attract and retain quality talent.

1st

**LARGEST LANDLORD
IN FLORIDA**

25th

**LARGEST OFFICE LANDLORD
IN THE U.S.**

56MM+

**SQUARE FEET OWNED &
MANAGED TO-DATE**

\$8B+

**ASSETS MANAGED/
ACQUIRED/DEVELOPED**

170+

ACQUISITIONS

36+

YEARS OF CRE EXPERIENCE

ENVIRONMENTAL HEALTH & WELLNESS PROGRAM

Prioritizing safety and sustainability under the trusted advisory of our Director of Environmental, Social & Governance

NATIONWIDE PRESENCE

Jacksonville, Orlando, Central Florida, Fort Lauderdale, Miami, Denver, Houston, Atlanta and more

TENANT EXPERIENCE

Committing to best-in-class service through a Tenant Services Program designed to enhance interaction and ensure continuous improvement





Maitland
Summit



Learn More

Micah Strader

Managing Director
407.982.8688
micah.strader@jll.com

Madison Kimbell

Senior Associate
407.982.8580
madison.kimbell@jll.com

Jones Lang LaSalle Brokerage, Inc.
250 S. Orange Avenue, Suite 700P
Orlando, FL 32801
T +1 407 982 8688

<https://www.maitlandsummit.com>