

5345 Old Dixie Highway

Forest Park, GA 30297

64,162 - 373,843 SF FOR LEASE

MULTIPLE DIVISIBILITY OPTIONS



BUILDING INFORMATION

Total Building Size: 64,162 - 373,843 SF
Office: Up to 16,258 SF
Loading: 61 dock doors, 3 Drive-ins
Clear Height: 25'-30'
Lighting: LED
Sprinkler: ESFR
Auto Parking Spots: 158
Trailer Parking Spots: 61
Power: 5200 amps
Large outside storage/trailer lot
Fully Fenced Premises



Joseph Kriss
678.362.4641
josephk@seefriedproperties.com

Tripp Ausband
770.825.3391
tausband@seefriedproperties.com

Seefried Industrial Properties
3333 Riverwood Parkway, Suite 300 | Atlanta, GA 30339
404.233.0204 | www.seefriedproperties.com

OWNED BY:
STAG
INDUSTRIAL

LEASED BY:
SEEFRIED
INDUSTRIAL PROPERTIES

No guarantee, warranty or representation, express or implied, is made as to the accuracy of the information contained herein, and same is submitted subject to errors, omissions, change of price, rental or other conditions, or withdrawal without notice.

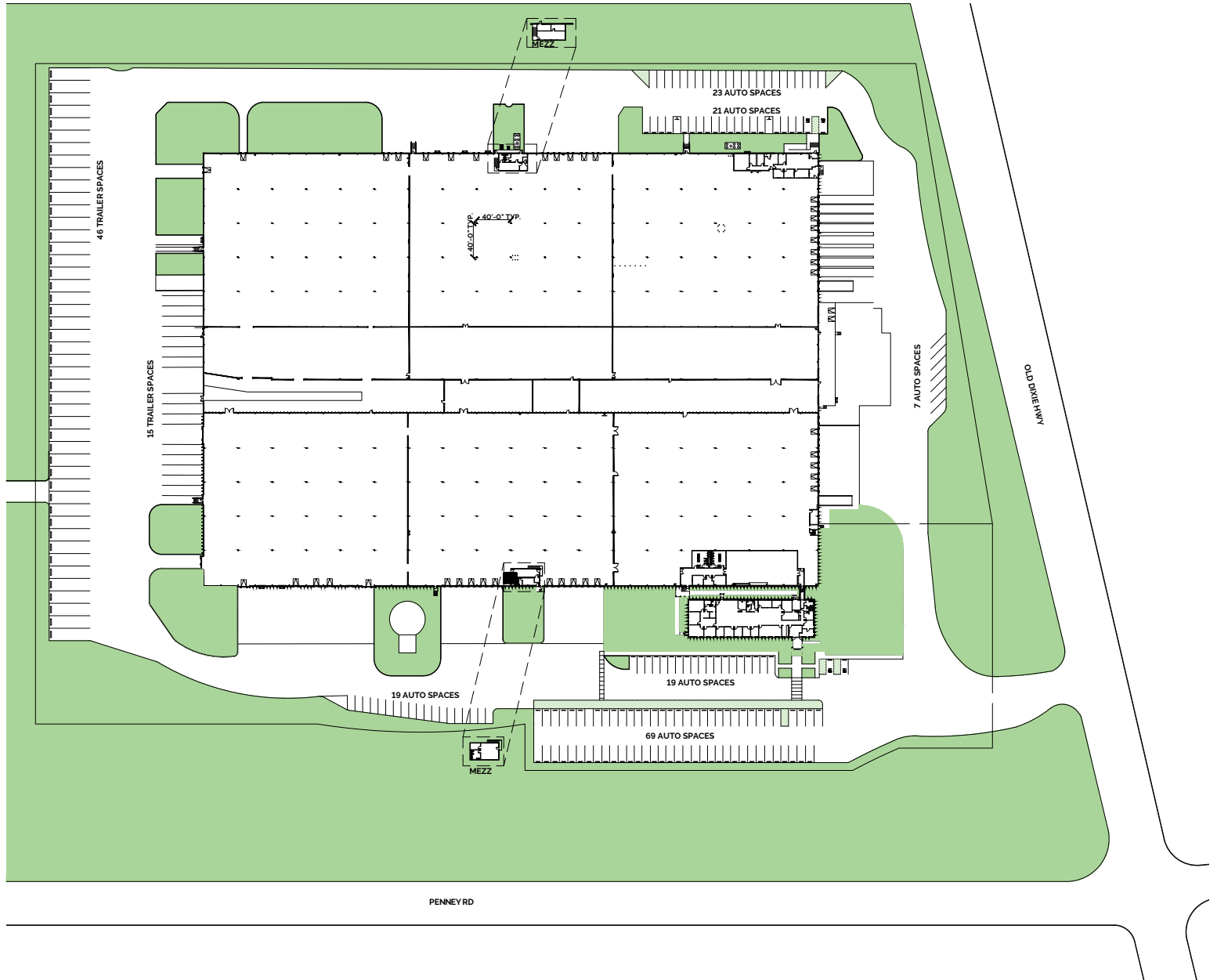

Joseph Kriss
678.362.4641
josephk@seefriedproperties.com

Tripp Ausband
770.825.3391
tausband@seefriedproperties.com

Seefried Industrial Properties
3333 Riverwood Parkway, Suite 300 | Atlanta, GA 30339
404.233.0204 | www.seefriedproperties.com

OWNED BY:
STAG
INDUSTRIAL

LEASED BY:
SEEFRIED
INDUSTRIAL PROPERTIES