

## 0.89-ACRE PARCEL AVAILABLE

NEC of SR 52 & Deerbrook Blvd | Land O' Lakes, FL 34638

### PROPERTY HIGHLIGHTS

- ▶ 0.89-acre parcel available for ground lease
- ▶ 360' of frontage along SR 52 (29,000 AADT)
- ▶ First intersection off the Suncoast Parkway (SR 589) on east side along SR 52
- ▶ FDOT is under construction with a \$49.7 million dollar project to widen this SR 52 from 2-lane road to a 6-lane divided road; estimated completion date is 2024
- ▶ Local retailers include Circle K, Dunkin', Publix Super Market, RaceTrac, Dairy Queen, Heartland Dental and Waffle House
- ▶ Lennar acquired 5,100 acres directly west of the subject parcel for future Angeline residential development to allow up to 11,495 homes, 5.4 million SF of commercial and office uses
- ▶ Moffitt Cancer Center and Research Institute acquired 775 acres from Lennar for a 1.4 million SF \$191 million dollar research facility which will create 14,500 jobs
- ▶ Demographics include a population of over 40,000 with an average income of more than \$87,000 within a 5-mile radius

### DEMOGRAPHICS

#### Population

	3 Mile	10,997
	5 Mile	40,542
	7 Mile	84,019

#### Households

	3 Mile	4,141
	5 Mile	15,354
	7 Mile	32,509

#### Household Income

	3 Mile	\$109,835
	5 Mile	\$87,040
	7 Mile	\$86,507

#### Traffic Counts

	SR 52 (E/W)	29,000 AADT
	Suncoast Pkwy (SR 589)	74,000 AADT

CALL FOR DETAILS

**813-712-3068**

**Brandon Eggleston**  
813 712 3068  
brandon@rmcpg.com

8902 N Dale Mabry Hwy  
Tampa, FL 33614  
800 728 5379  
www.RMCPG.com

# 0.89-ACRE PARCEL AVAILABLE

NEC of SR 52 & Deerbrook Blvd | Land O' Lakes, FL 34638

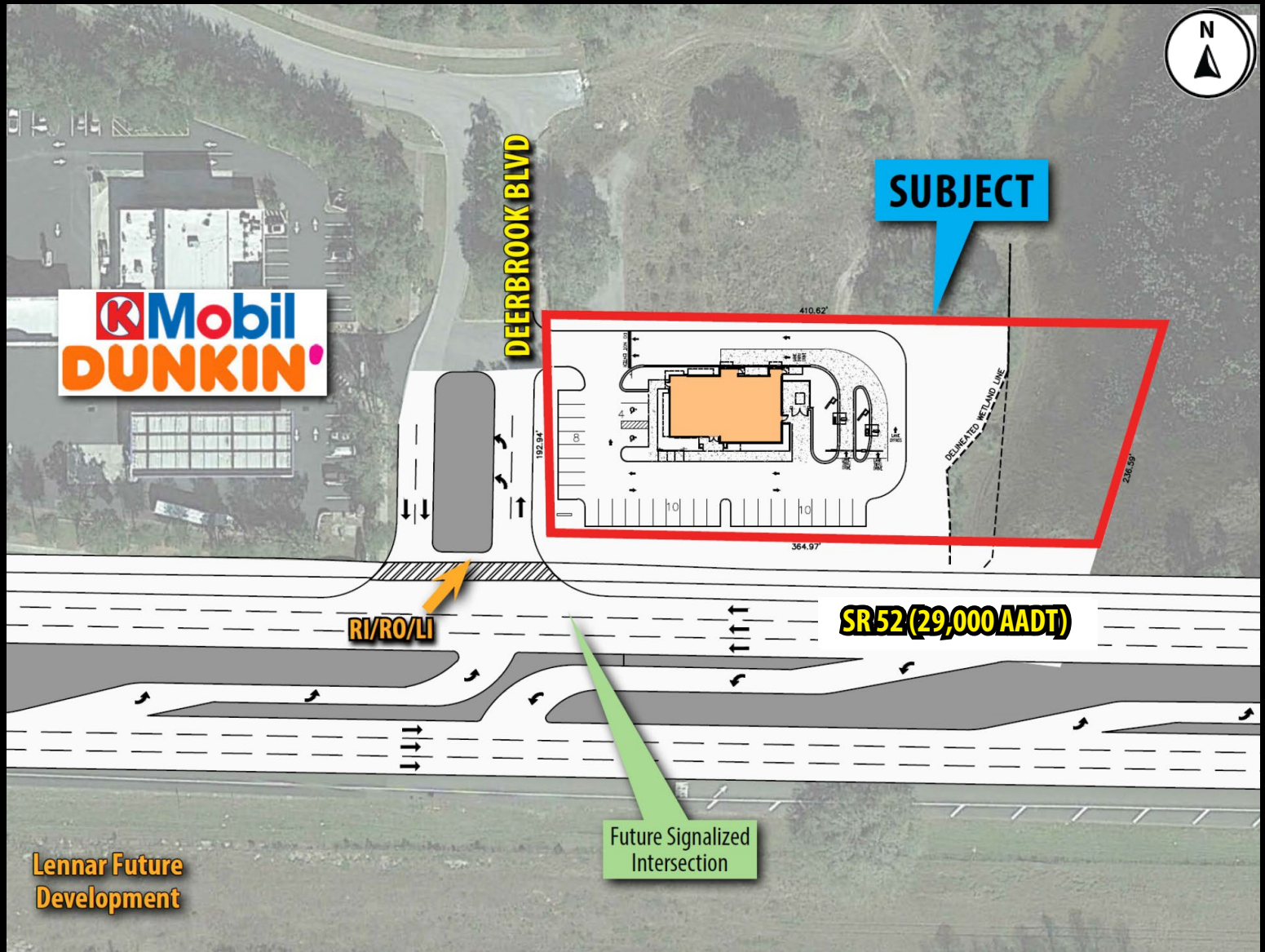

All information given herein is obtained from sources considered reliable. However, we are not responsible for misstatement of facts, errors, omissions, prior sale, withdrawal from market, modification of mortgage commitment, terms and considerations, or change in price without notice. The information supplied herein is for informational purposes only and shall not contain a warranty or assurance that said information is correct. Any person intending to rely upon the information supplied herein should verify said information independently. **UPDATED: 072224**

**Brandon Eggleston**  
813 712 3068  
brandon@rmcpg.com

8902 N Dale Mabry Hwy  
Tampa, FL 33614  
800 728 5379  
www.RMCPG.com