



**RETAIL/MEDICAL/FITNESS/
2nd GENERATION RESTAURANT SPACE**

BELLMORE, NY

BELLMORE SHOPPES

2760 & 2784 SUNRISE HIGHWAY

SIZE

2784 - ±13,899 SF (Former Rite Aid)
2760 - ±1,500 SF (Former Restaurant)

ASKING RENT

Upon Request

CO-TENANTS

King Kullen, Jersey Mike's, Island Federal Credit Union, Piccolo, Vision People, Tutoring Club of Bellmore

NEIGHBORS

Arby's, 7-Eleven, New York Community Bank, CVS, Advanced Dermatology, Applebee's, P.C. Richard & Son, Auto Zone

COMMENTS

Former Rite Aid Space Available

Second Generation Restaurant Available

Located on Sunrise Highway with traffic light access at Bellmore Avenue

Prime center with a strong mix of both local and national Tenants

Over 56,000 vehicles pass this site daily on Sunrise Highway

Across from the Bellmore Long Island Rail Road Train Station

CONTACT EXCLUSIVE AGENTS

GREG BATISTA

gbatista@ripcony.com

D: 516.342.8277

C: 516.351.5604

MICHELLE ABRAMOV

mabramov@ripcony.com

D: 718.663.2652

C: 718.607.1920

RIPCO
REAL ESTATE

1000 Woodbury Road
Suite 100
Woodbury, NY 11797
516.933.8880

Please visit us at ripcony.com for more information

This information has been secured from sources we believe to be reliable, but we make no representations as to the accuracy of the information. References to square footage are approximate. Buyer must verify the information and bears all risk for any inaccuracies.

EXTERIOR PHOTO



MARKET AERIAL



AERIAL

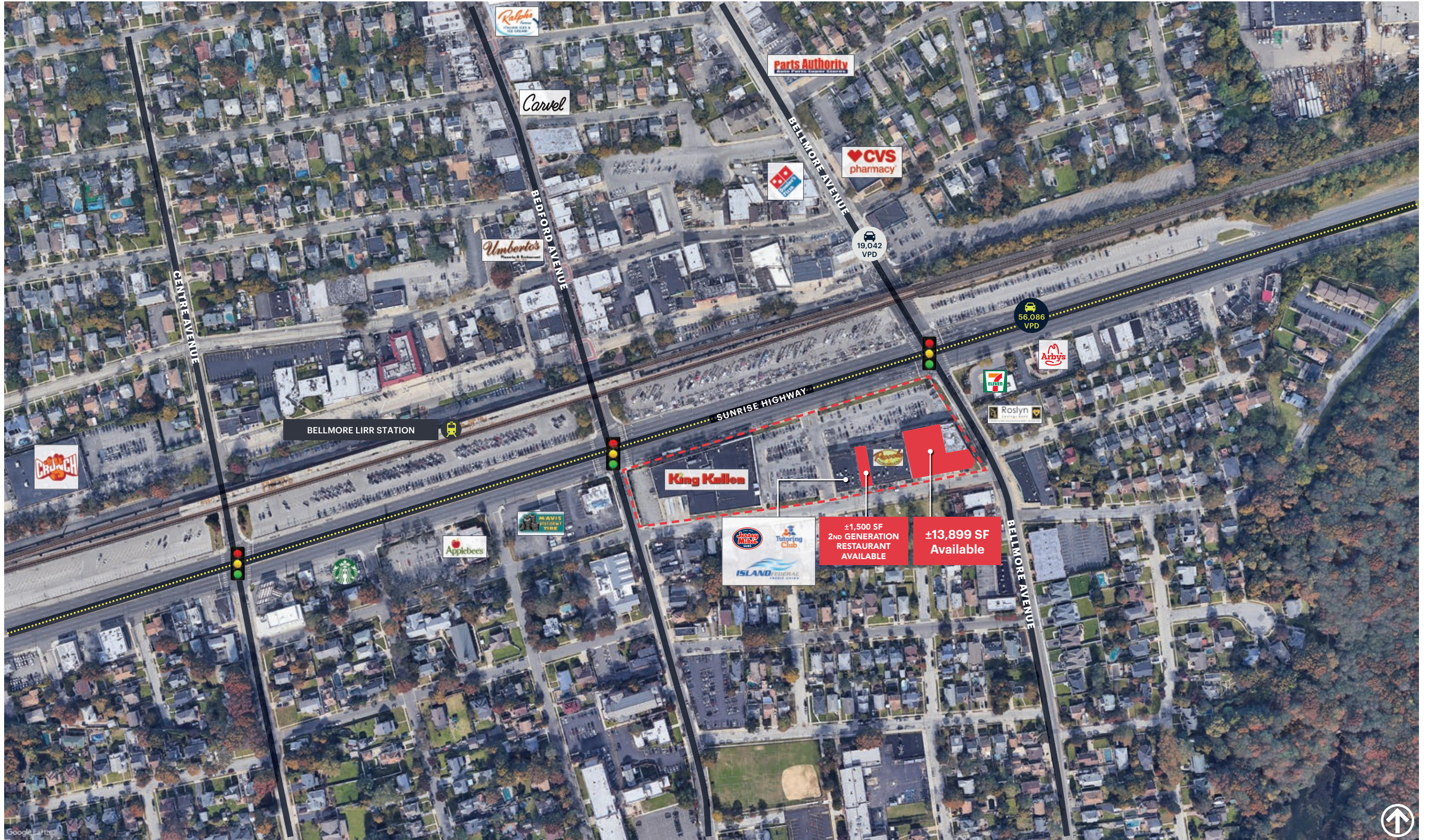

BELLMORE LIRR STATION

King Kullen

±1,500 SF
2ND GENERATION
RESTAURANT
AVAILABLE

±13,899 SF
Available

FORMER RITE AID - FLOOR PLAN

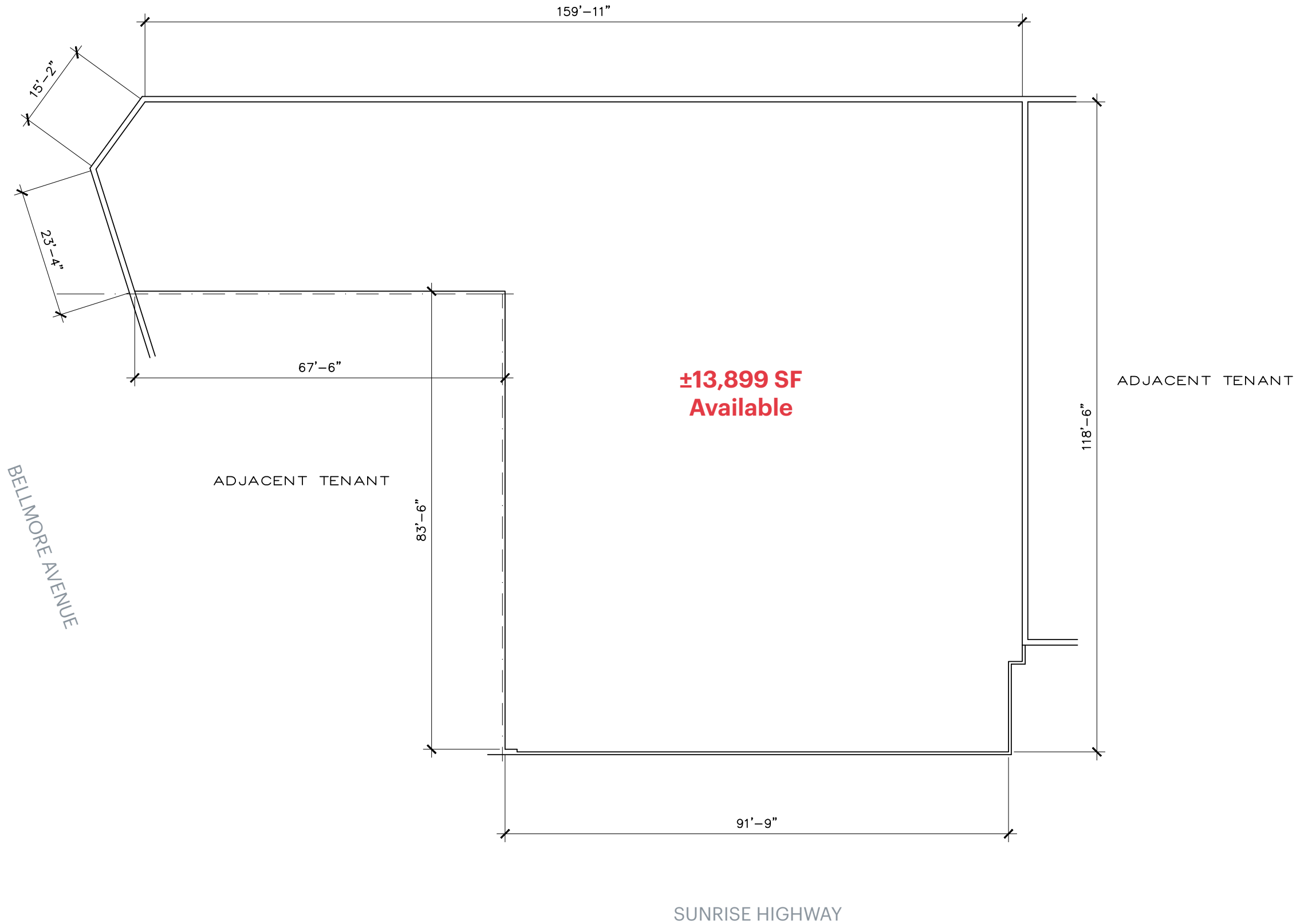

FORMER RITE AID - INTERIOR PHOTOS



FORMER RESTAURANT - FLOOR PLAN

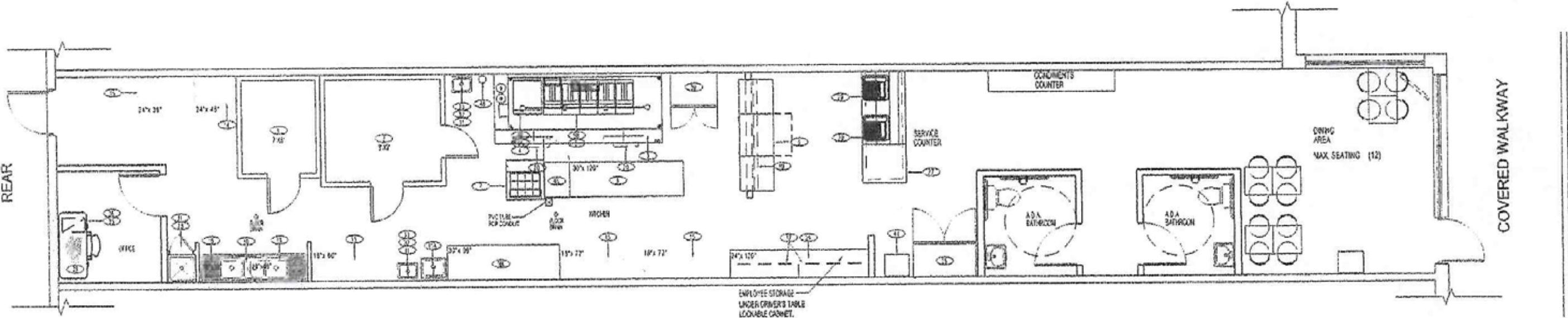

AREA DEMOGRAPHICS

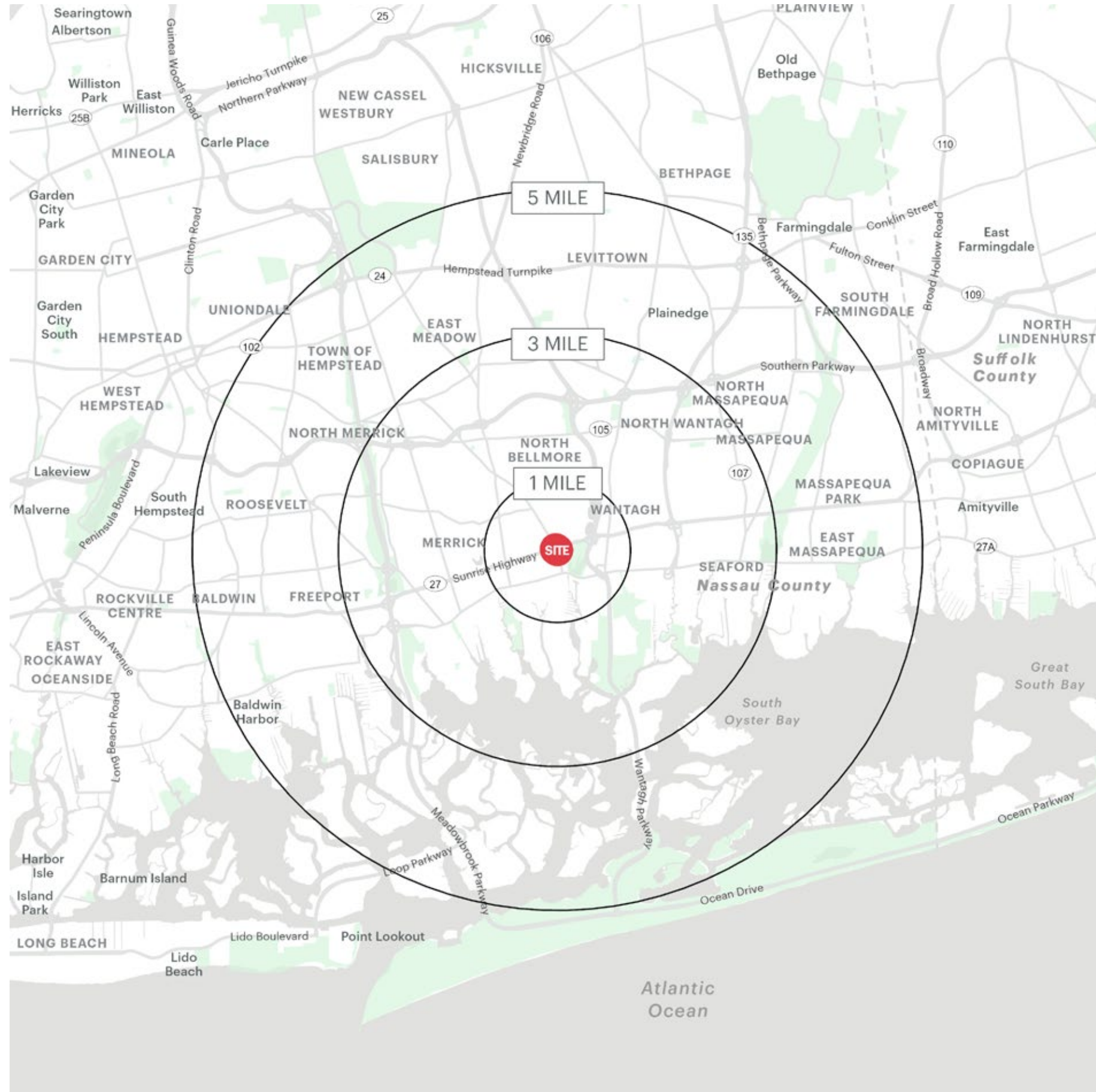

2760 & 2784 SUNRISE HIGHWAY BELLMORE, NEW YORK

1 MILE RADIUS

POPULATION
20,346

HOUSEHOLDS
7,070

AVERAGE HOUSEHOLD INCOME
\$185,580

MEDIAN HOUSEHOLD INCOME
\$153,151

COLLEGE GRADUATES (BACHELOR'S +)
7,553 - 52.0%

TOTAL BUSINESSES
1,266

TOTAL EMPLOYEES
8,152

DAYTIME POPULATION (W/ 16 YR +)
17,452

3 MILE RADIUS

POPULATION
148,661

HOUSEHOLDS
49,227

AVERAGE HOUSEHOLD INCOME
\$188,163

MEDIAN HOUSEHOLD INCOME
\$151,367

COLLEGE GRADUATES (BACHELOR'S +)
54,681 - 52.0%

TOTAL BUSINESSES
4,880

TOTAL EMPLOYEES
472,714

DAYTIME POPULATION (W/ 16 YR +)
113,753

5 MILE RADIUS

POPULATION
406,229

HOUSEHOLDS
128,553

AVERAGE HOUSEHOLD INCOME
\$168,249

MEDIAN HOUSEHOLD INCOME
\$130,200

COLLEGE GRADUATES (BACHELOR'S +)
127,871 - 44.0%

TOTAL BUSINESSES
11,968

TOTAL EMPLOYEES
107,693

DAYTIME POPULATION (W/ 16 YR +)
304,266

AREA DEMOGRAPHICS

