



ARES
INDUSTRIAL
MANAGEMENT

LITTLE ORCHARD BUSINESS PARK

170 BARNARD & 196-198 BARNARD AVENUE, SAN JOSE, CA 95125

±24,415 Square Feet to ±48,833 Square Feet

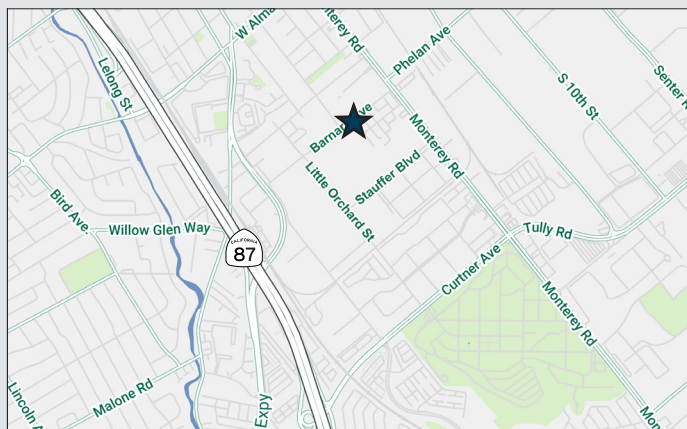

BUILDING HIGHLIGHTS

- ±24,415 to ±48,833 Square Feet
- 1/1,000 Parking Ratio
- Easy Access to Hwy 87
- Walking Distance to Plant Shopping Center
- Call to Tour

CHIP SUTHERLAND

Vice Chairman

+1 408 453 7410

chip.sutherland@cbre.com

Lic. 01014633

FRANK FRIEDRICH

Senior Vice President

+1 408 453 7495

frank.friedrich@cbre.com

Lic. 01159876

CBRE



ARES
INDUSTRIAL
MANAGEMENT

LITTLE ORCHARD BUSINESS PARK

170 BARNARD & 196-198 BARNARD AVENUE, SAN JOSE, CA 95125

170 Barnard Avenue

- ±24,788 Square Feet
- ±2,693 SF Office
- Five (5) Dock High Doors
- One (1) Grade Level Door
- ±22' Clear Height
- Sprinklered
- 225 Amp @ 480V Panel
- End Unit
- Zoned "HI - Heavy Industrial"
- Available March 1, 2025 (or sooner)

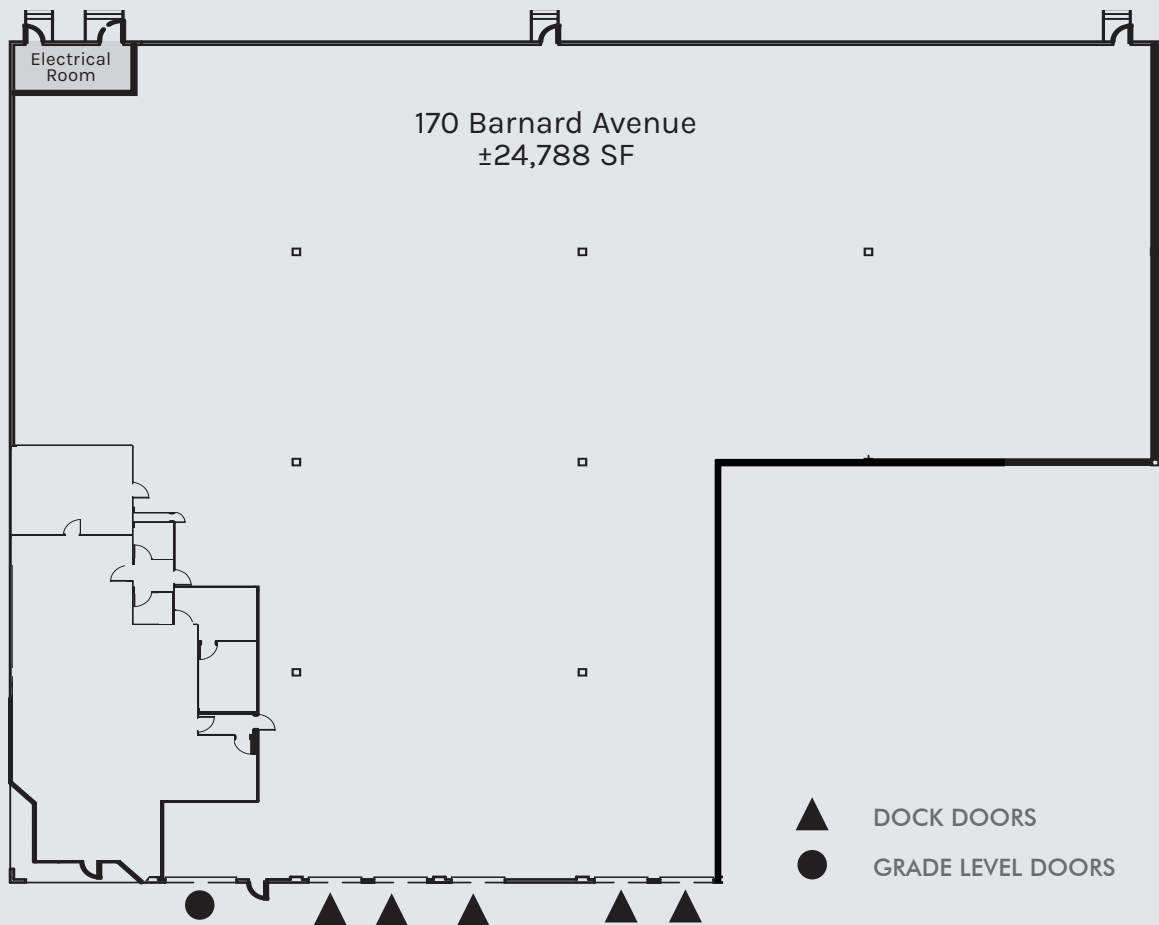



ARES
INDUSTRIAL
MANAGEMENT

LITTLE ORCHARD BUSINESS PARK

170 BARNARD & 196-198 BARNARD AVENUE, SAN JOSE, CA 95125

196 Barnard Avenue

- ±24,415 SF
- ±3,288 SF Office
- ±22' Clear Height
- Sprinklered
- Four (4) Dock High Doors
- One (1) Grade Level Door
- Available October 1, 2024

198 Barnard Avenue

- ±24,418 SF
- ±2,000 SF Office
- ±22' Clear Height
- Sprinklered
- Three (3) Dock High Doors
- One (1) Grade Level Door
- 2 Oversized Grade Level Doors at 16' Wide
- 225 Amp @ 480V Panel
- End Unit
- Available October 1, 2024

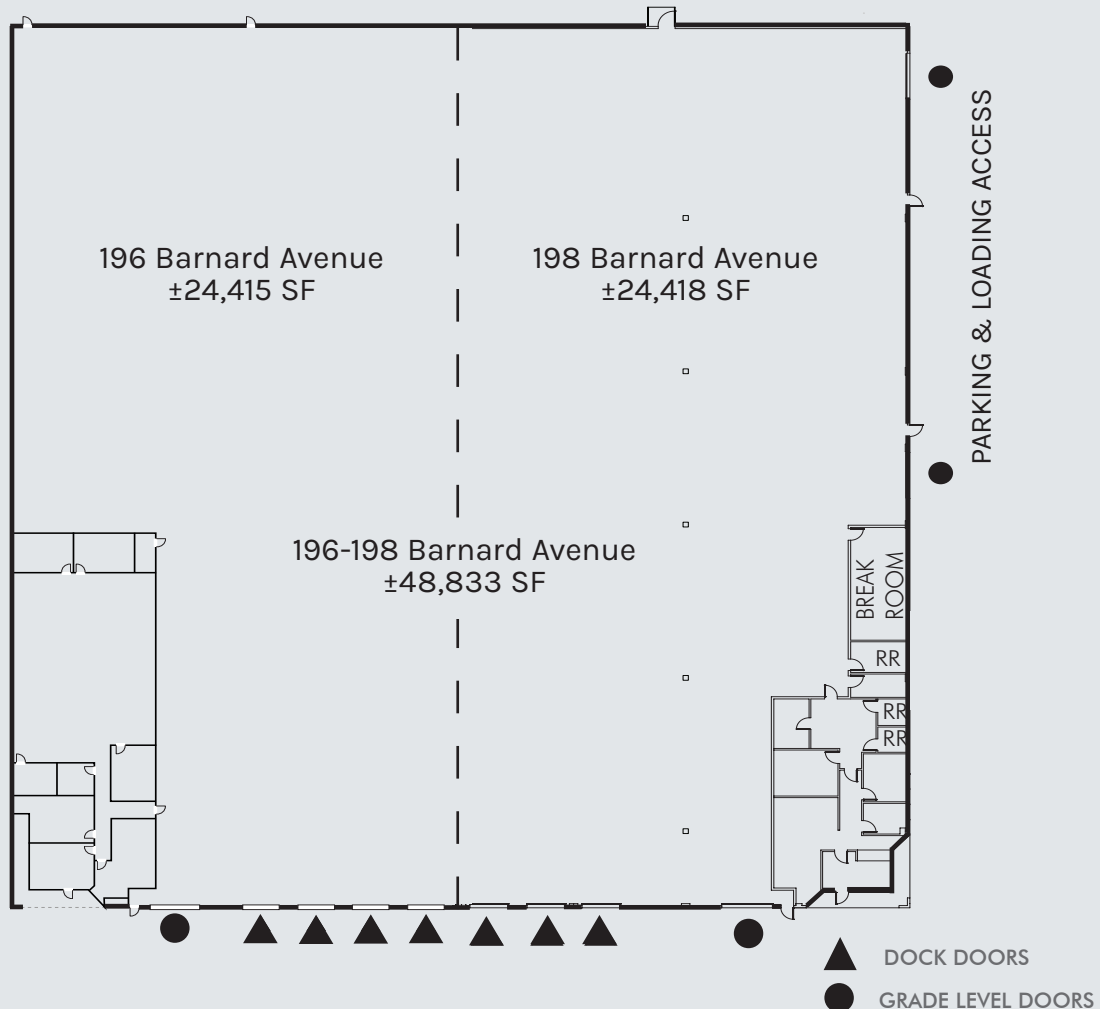



ARES
INDUSTRIAL
MANAGEMENT

LITTLE ORCHARD BUSINESS PARK

170 BARNARD & 196-198 BARNARD AVENUE, SAN JOSE, CA 95125

Site Plan



© 2024 CBRE, Inc. All rights reserved. This information has been obtained from sources believed reliable, but has not been verified for accuracy or completeness. You should conduct a careful, independent investigation of the property and verify all information. Any reliance on this information is solely at your own risk. CBRE and the CBRE logo are service marks of CBRE, Inc. All other marks displayed on this document are the property of their respective owners, and the use of such logos does not imply any affiliation with or endorsement of CBRE. Photos herein are the property of their respective owners. Use of these images without the express written consent of the owner is prohibited.



ARES
INDUSTRIAL
MANAGEMENT

LITTLE ORCHARD BUSINESS PARK

170 BARNARD & 196-198 BARNARD AVENUE, SAN JOSE, CA 95125

±24,415 Square Feet to ±48,833 Square Feet

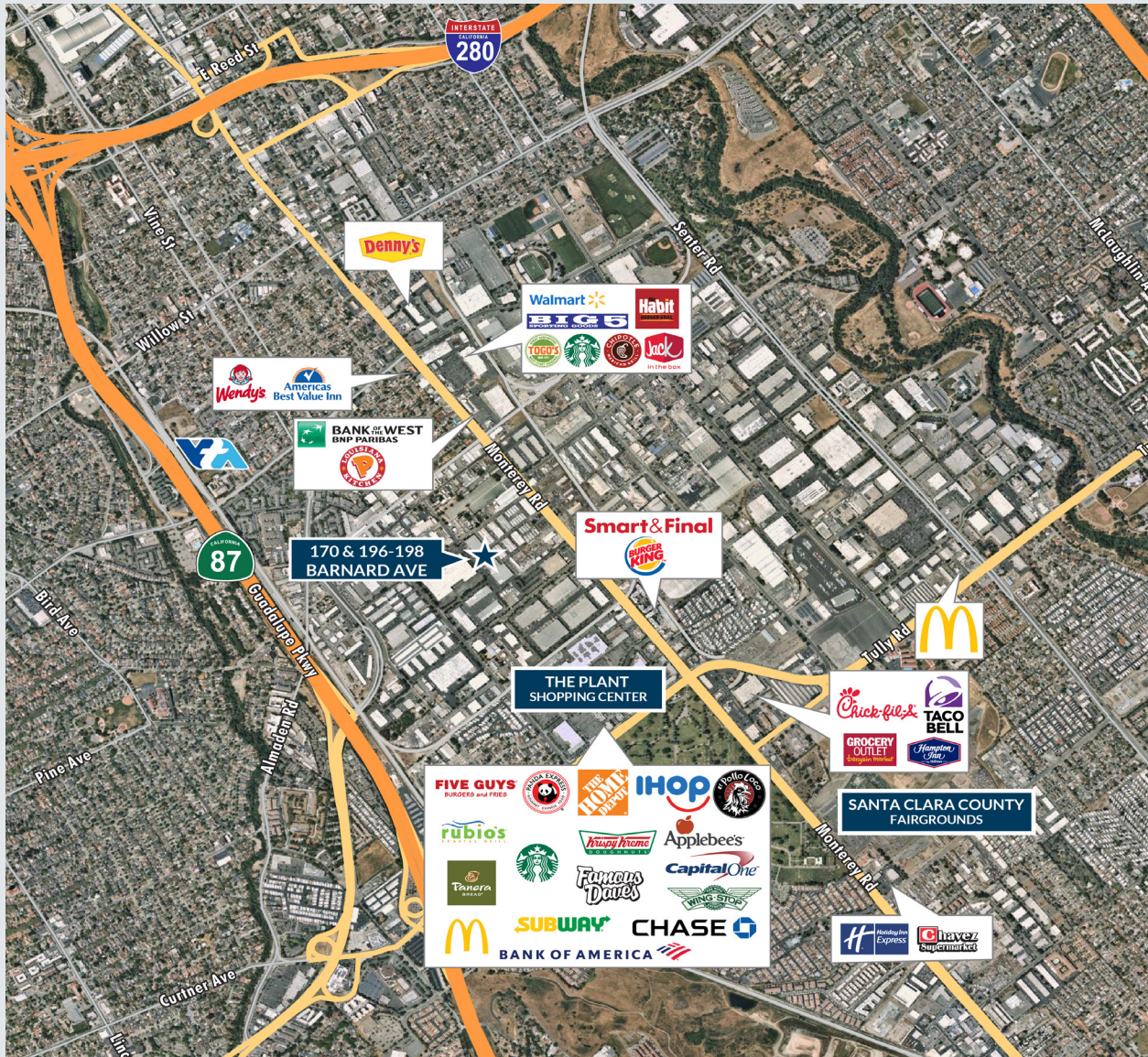

CHIP SUTHERLAND
Vice Chairman
+1 408 453 7410
chip.sutherland@cbre.com
Lic. 01014633

FRANK FRIEDRICH
Senior Vice President
+1 408 453 7495
frank.friedrich@cbre.com
Lic. 01159876

