

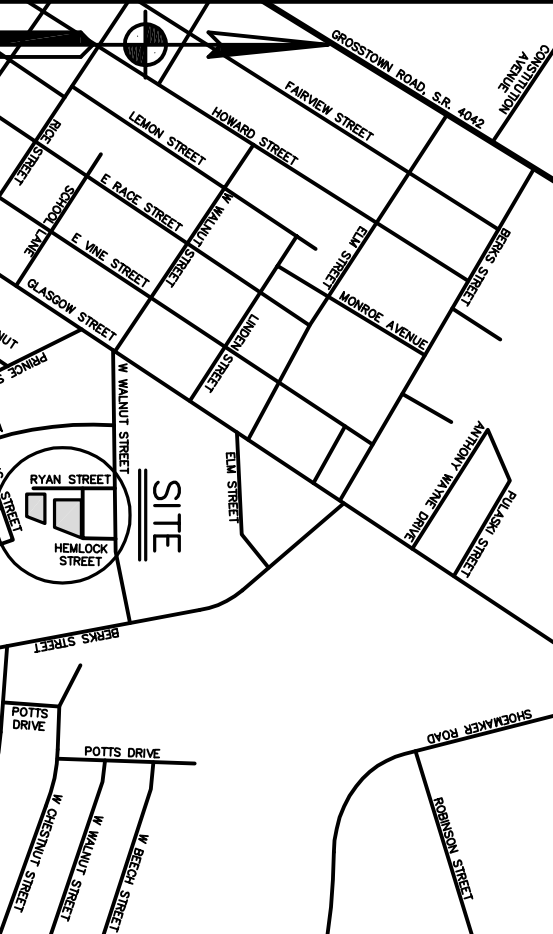

Land now or formerly of Stephen G. & Thomas R. Berless T.M.P. #16-00-31140-00-2 Tax Map ID: 16051 028
Land now or formerly of Michelle Lightbourn T.M.P. #16-00-31136-00-6 Tax Map ID: 16051 023
Land now or formerly of Renee D. Freeman T.M.P. #16-00-31132-00-1 Tax Map ID: 16051 016
Land now or formerly of Tracey Wright T.M.P. #16-00-31128-00-5 Tax Map ID: 16051 026
Land now or formerly of Lori A. Sitt T.M.P. #16-00-31124-00-9 Tax Map ID: 16051 029
Land now or formerly of James L. Caples T.M.P. #16-00-31120-00-4 Tax Map ID: 16051 027
Land now or formerly of Ronald Lee & Yvonne A. White T.M.P. #16-00-31116-00-8 Tax Map ID: 16051 018
Land now or former Deborah Phegans T.M.P. #16-00-31112 Tax Map ID: 16051
Land now or formerly of Howard Charles/Kearney Charlotte T.M.P. #16-00-31108-00-7 Tax Map ID: 16051 020
Land now or formerly of Tracey L. Wright T.M.P. #16-00-31104-00-2 Tax Map ID: 16051 021
Land now or formerly of Harold W. & Terri L. Harbison T.M.P. #16-00-31100-00-6 Tax Map ID: 16051 022
Land now or formerly of Craig S. & Kristian M. Rimmel T.M.P. #16-00-31096-00-1 Tax Map ID: 16051 023

Land now or formerly of Marsalis S. & Erna Green S T.M.P. #16-00-31092-00-5 Tax Map ID: 16051 031
--

Land now or formerly of L. L. Day T.M.P. #16-00-05568-00-4 Tax Map ID: 16051 009



SITE LOCATION MAP 1"=1000'

SITE STATISTICS

1. SUBJECT TRACT MAY BE RECORDED BY MONTGOMERY COUNTY TAX ASSESSMENT INFORMATION AS FOLLOWS:

POTTSWOM BOROUGH
PARCEL NO. 16-00-06572-00-3

2. RECORDED DEED DATA IS AS FOLLOWS:
AS RECORDED IN THE OFFICE FOR THE RECORPING OF DEEDS, ETC., IN AND FOR THE COUNTY OF MONTGOMERY, PENNSYLVANIA IN DEED BOOK 5650, PAGE 0648.

3. NAME AND ADDRESS OF THE OWNER OF THE SUBJECT TRACT:
POTTSWOM PROPERTY INVESTMENTS, LLC
208 WISSAHICKON AVENUE
NORTH WALKER, PA 19054

4. AREA STATISTICS:
TOTAL TRACT AREA (LOT 1) = 23,986 S.F. (TO DEED TITLE LINES)
TOTAL TRACT AREA (LOT 2) = 12,968 S.F. (TO DEED TITLE LINES)

- ### NOTES
1. TITLE LINE INFORMATION TAKEN FROM EXISTING DEEDS, PLANS OR RECORDS, AND VERIFIED BY ACTUAL FIELD MEASUREMENTS TAKEN BY THIS OFFICE IN MAY 2016.
 2. ANY SCALED DIMENSIONS FROM THE PLAN SHALL NOT BE USED FOR CONSTRUCTION WITHOUT CONFIRMATION BY ST/A ENGINEERING, INC.

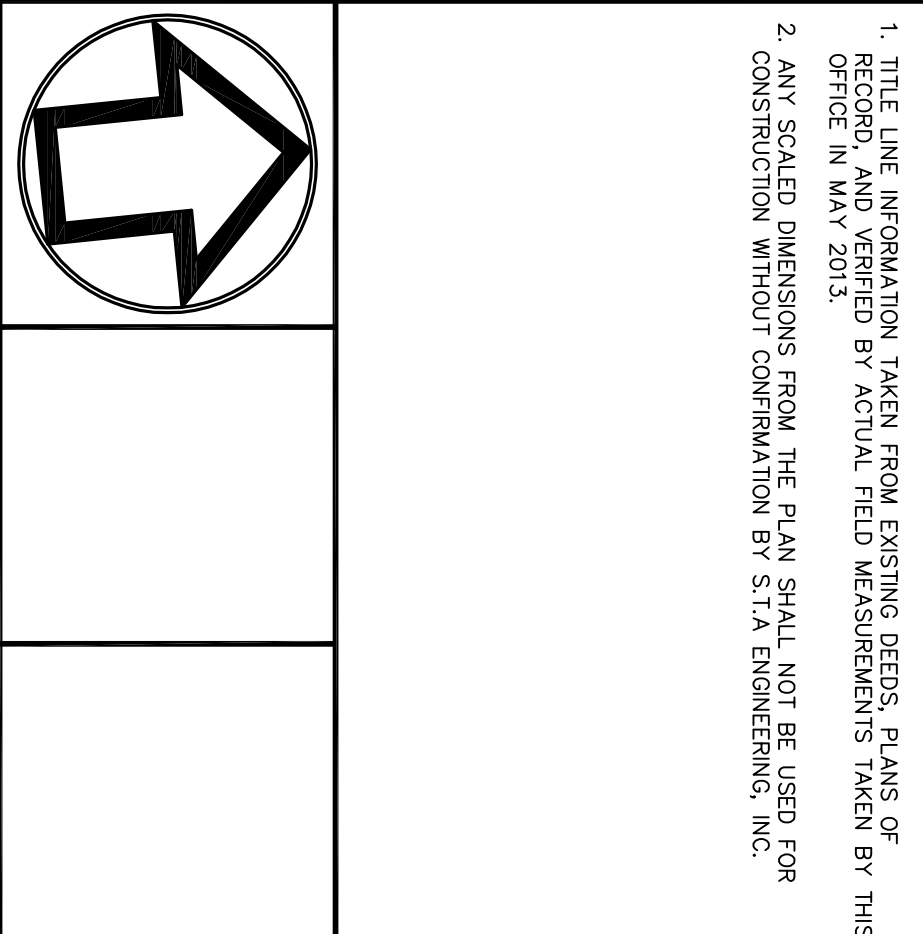

PLAN ORIGINATOR DATE: MAY 26, 2016

SKETCH B - MIMICKING
BRIGHT HOPE COMMUNITY DEVELOPMENT
(SMALL UNITS)

PREPARED FOR:
POTTSWOM PROPERTY INVESTMENTS, LLC

SITE SITUATE IN:
POTTSWOM BOROUGH
MONTGOMERY COUNTY, PENNSYLVANIA

Civil Engineers • Land Surveyors
2499 KNIGHT ROAD, PENNSBURG, PA 18073
MADING, P.O. BOX 87, RED HILL, PA 18076
PH: (215) 679-0200, www.staocc.com

PROJECT NUMBER	4726	DRAWING FILE NUMBER	4726SK2	PLAN SHEET NUMBER	1 OF 1
----------------	------	---------------------	---------	-------------------	--------