

FOR SALE OR LEASE

800 10TH ST. E,
HASTINGS, MN



Property Information



ADDRESS

800 10th St.E, Hastings, MN

SIZE

Office 1,707 SF
Whse/Prod 96,862 SF
 Total 98,569 SF*

*Includes Approx. 3,373 SF Mezzanine Space.

SPACE AVAILABLE

12,000 SF - 62,000 SF

OUTDOOR STORAGE

Fenced Outdoor Storage Available

LOADING:

5 Dock Doors | 1 Drive-In (Ability to Add More)

CLEAR HEIGHT

11'-20'

YEAR BUILT

1960

SPRINKLER

Yes

POWER

Heavy

PARKING

134 Spaces

ZONING

I-1 Industrial Park

LEASE RATE

\$5.50 PSF NNN

2025 EST. TAX & CAM

\$3.40 PSF

Floor Plan

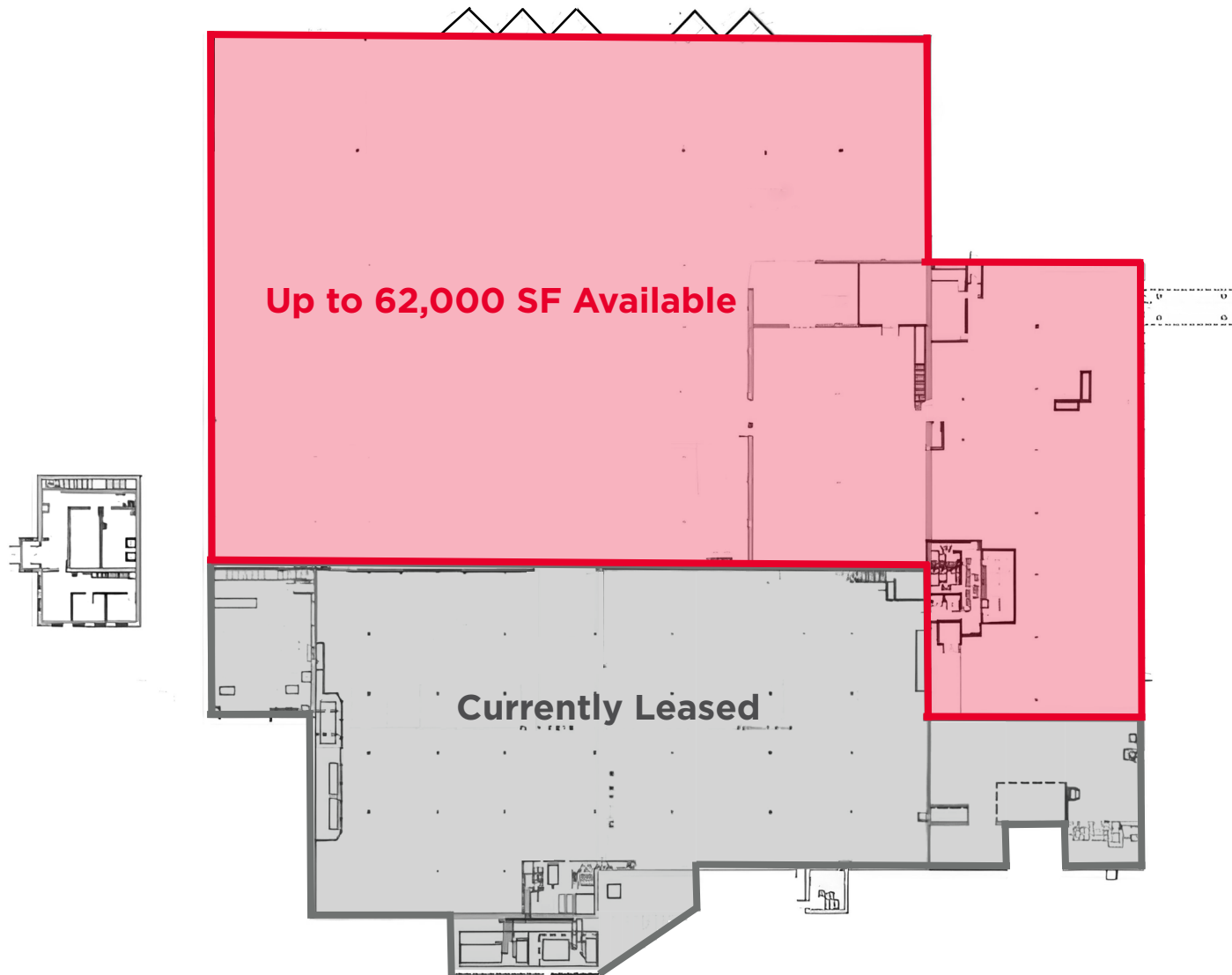

Area Amenities



**Access to High Quality
South Metro Labor Pool**



**Heavy Power Available
for Manufacturing Use**



**Fenced & Gated Outdoor
Storage Available**



**25-Min Drive Time to St.
Paul CBD**

Drive Times

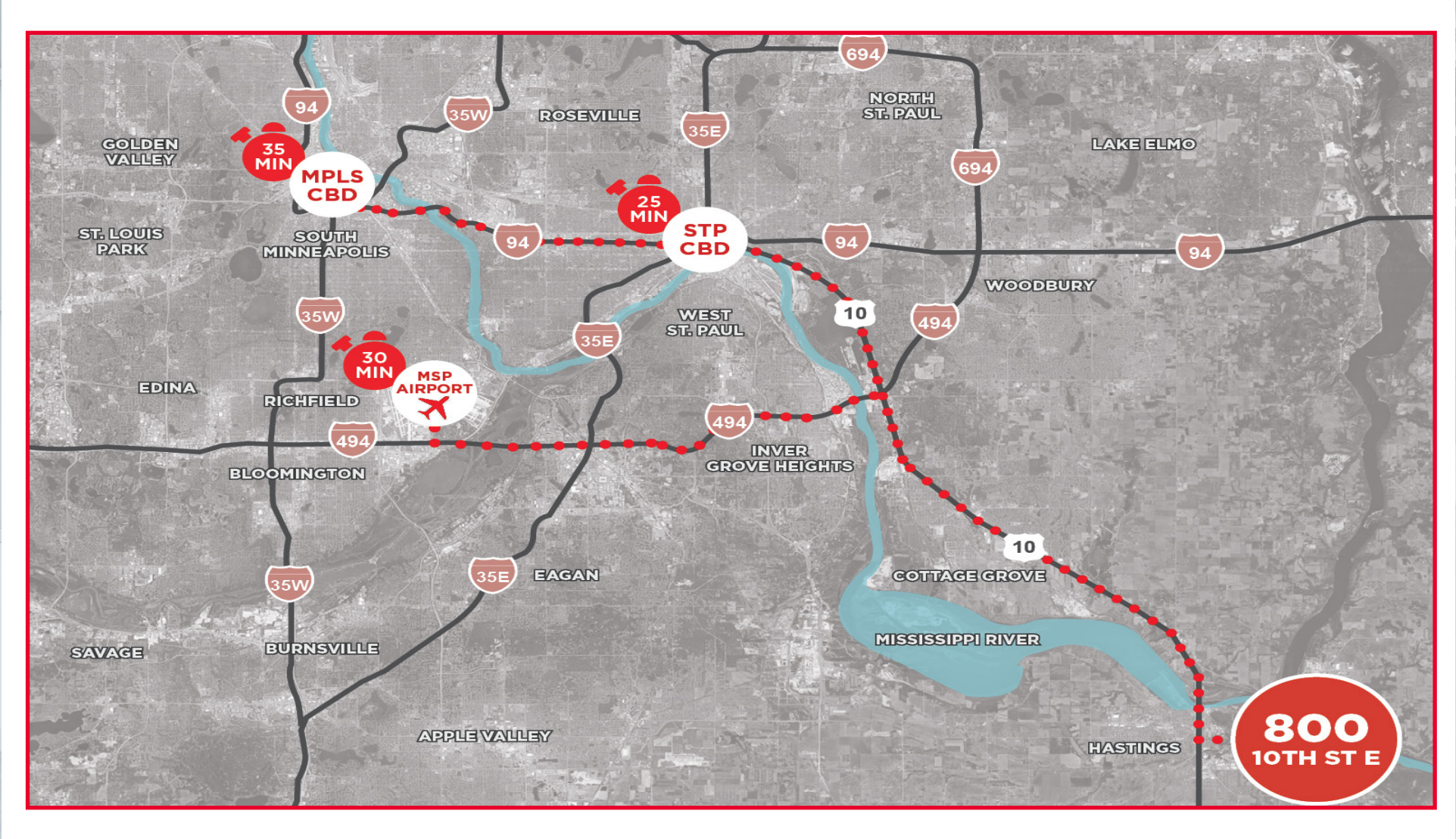

Property Aerial



Property Aerial







Contact

Jake Kelly
Senior Associate
+1 952 465 3303
jake.kelly@cushwake.com

Jordan Dick
Director
+1 952 204 7631
jordan.dick@cushwake.com

Todd Hanson
Senior Director
+1 952 820 8737
todd.hanson@cushwake.com



**CUSHMAN &
WAKEFIELD**