

OLIVE STREET

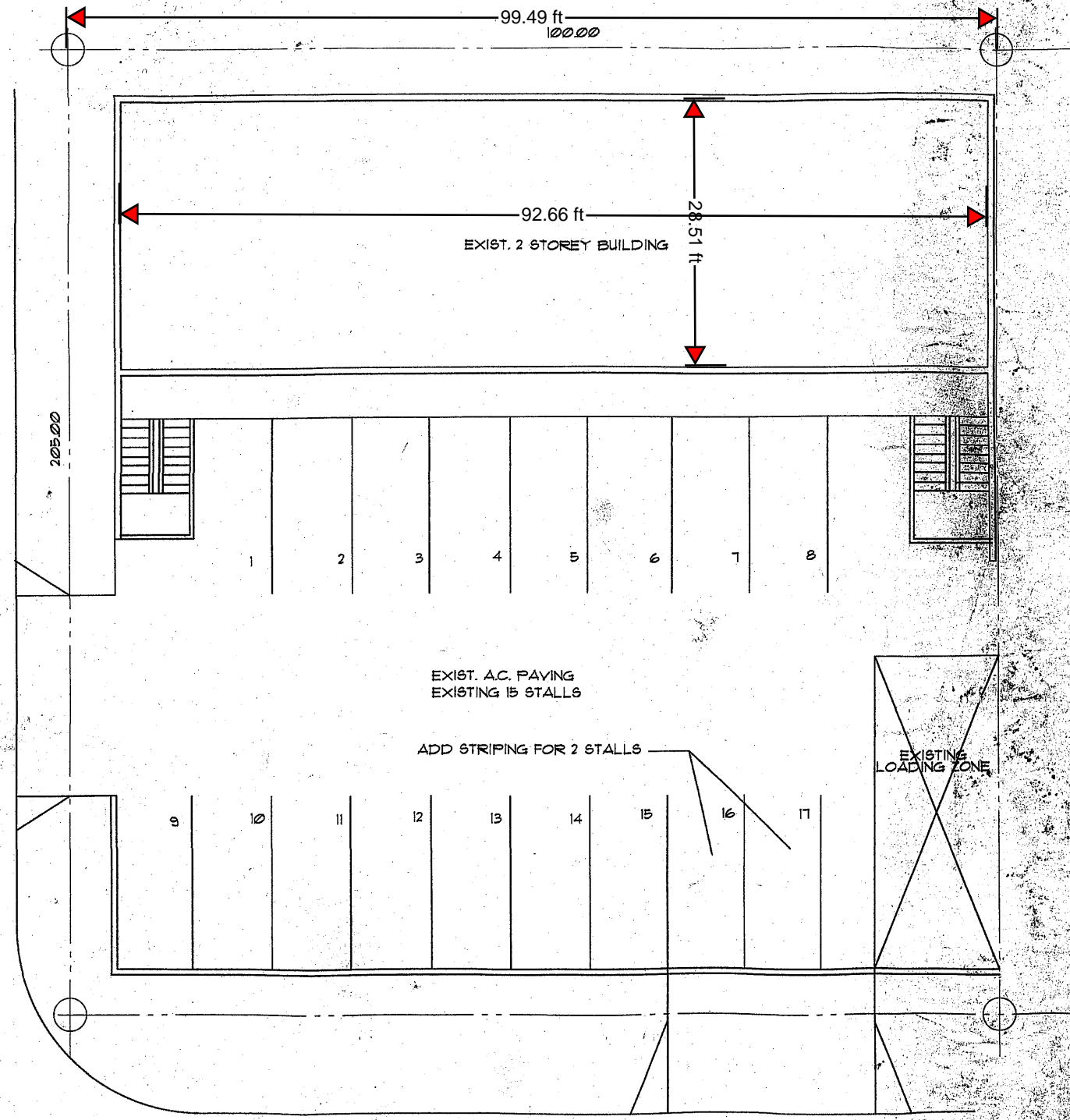

KAMEHAMEHA HIGHWAY

SITE PLAN
SCALE: 1/8" = 1'-0"

Project
Design
inc.

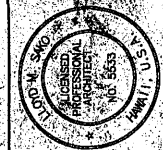

JOB NO. _____
 DRAWN BY: LS
 CHECKED BY: LS
 SCALE: AS NOTED
 DATE: MAY 2015

SIGNATURE: *M. M. M.* LICENSE EXPIRATION: 4-30-2016

THIS WORK WAS PREPARED BY ME OR UNDER MY SUPERVISION AND I AM A LICENSED PROFESSIONAL ENGINEER IN THE STATE OF HAWAII. I AM NOT PROVIDING CONTRACT ADMINISTRATION SERVICES. THE BOARD OF PROFESSIONAL ENGINEERS, ARCHITECTS, AND LANDSCAPE ARCHITECTS HAS REVIEWED THIS DOCUMENT AND IT IS IN COMPLIANCE WITH THE HAWAIIAN ENGINEERING ACT.

NAKAMURA PROPERTY
 KAMEHAMEHA HIGHWAY WAIHANA HAWAII
 TRK: T-3-007.034
 SITE PLAN

REVISIONS	DATE	BY	DESCRIPTION

NUMBER: 1
 SHEETS: 1