

FOR LEASE | OFFICE/SHOWROOM

WARD EAGLE OFFICE VILLAGE



29645-29655 W 14 MILE RD
FARMINGTON HILLS, MI 48334

PROPERTY HIGHLIGHTS:

- 1,150 SF office space for lease - available April 1, 2025
- Move in ready suite with high end finishes
- Ideal for showroom, medical, or general office uses
- Located in the historic Ward Eagle house
- Abundant on site parking
- Lease Rate: \$16.00 PSF Gross + Utilities + Janitorial

The information provided herein along with any attachment(s) was obtained from sources believed to be reliable, however, Friedman Real Estate makes no guarantees, warranties, or representations as to the completeness or accuracy of such information and legal counsel is advised. All information provided is subject to verification and no liability for reliance on such information or errors or omissions is assumed. The presentation of this property is submitted subject to errors, omissions, change of price or conditions, prior sale or lease, or withdrawal without notice. Copyright © 2024 Friedman Real Estate. All rights reserved.

FOR MORE INFORMATION PLEASE CONTACT:



ANDREW BOWER
andrew.bower@freg.com



STEVE EISENSHTADT
steve.eisenshtadt@freg.com

248.324.2000

eCODE 429



WARD EAGLE OFFICE VILLAGE | OFFICE/SHOWROOM
PROPERTY FLOOR PLAN

EXHIBIT B
PREMISES FLOOR PLAN

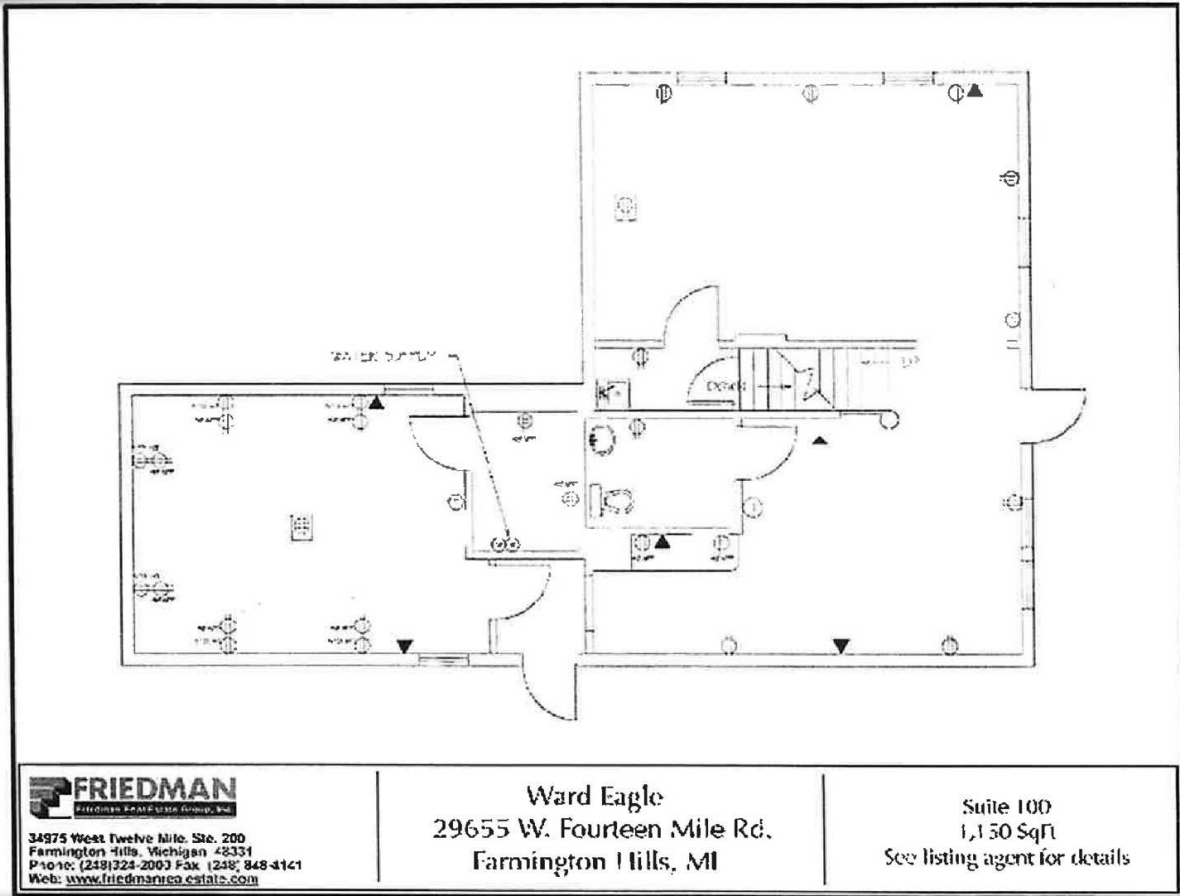

34
C:\Users\jaseik\AppData\Local\Microsoft\Windows\INetCache\Content.Outlook\TDD3P1R\Ward Eagle - Lease CLEAN (11.19.19).docx

FOR MORE INFORMATION **PLEASE CONTACT:**



ANDREW BOWER
andrew.bower@freg.com



STEVE EISENSHTADT
steve.eisenshtadt@freg.com

WARD EAGLE OFFICE VILLAGE | OFFICE/SHOWROOM PROPERTY PHOTOS



WARD EAGLE OFFICE VILLAGE | OFFICE/SHOWROOM
PROPERTY PHOTOS

