

WHITEHALL STATION

950 WHITEHALL RD, ATHENS, GA 30605



PROPERTY HIGHLIGHTS

- Dates from 1898 with many unique historic details
- Convenient to Athens as well as suburban Oconee county markets
- Flexible floor plan options
- Ideal for event facilities, creative workspaces, restaurants, music venue, and/or sports complex
- Light industrial/distribution



Contact
for
Pricing

Contact

Jacob Jordan

770-861-0675

jacob@stratuspg.com



675 Seminole Ave NE
Ste B1, Atlanta, GA 30307



www.stratuspg.com



404-618-0878

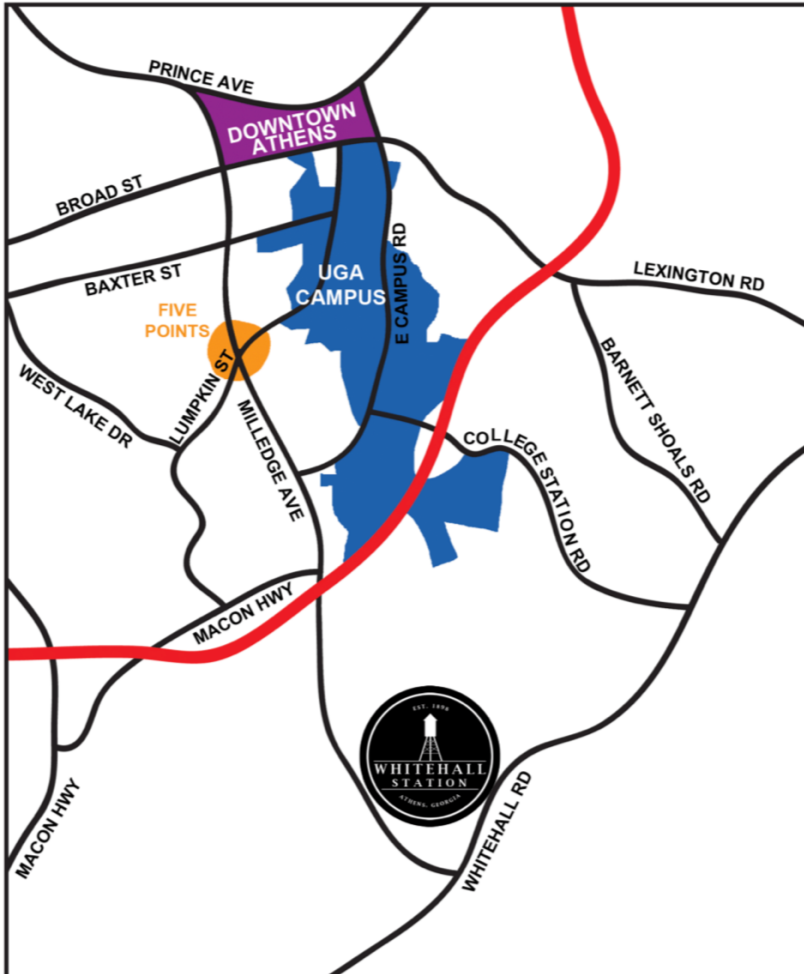
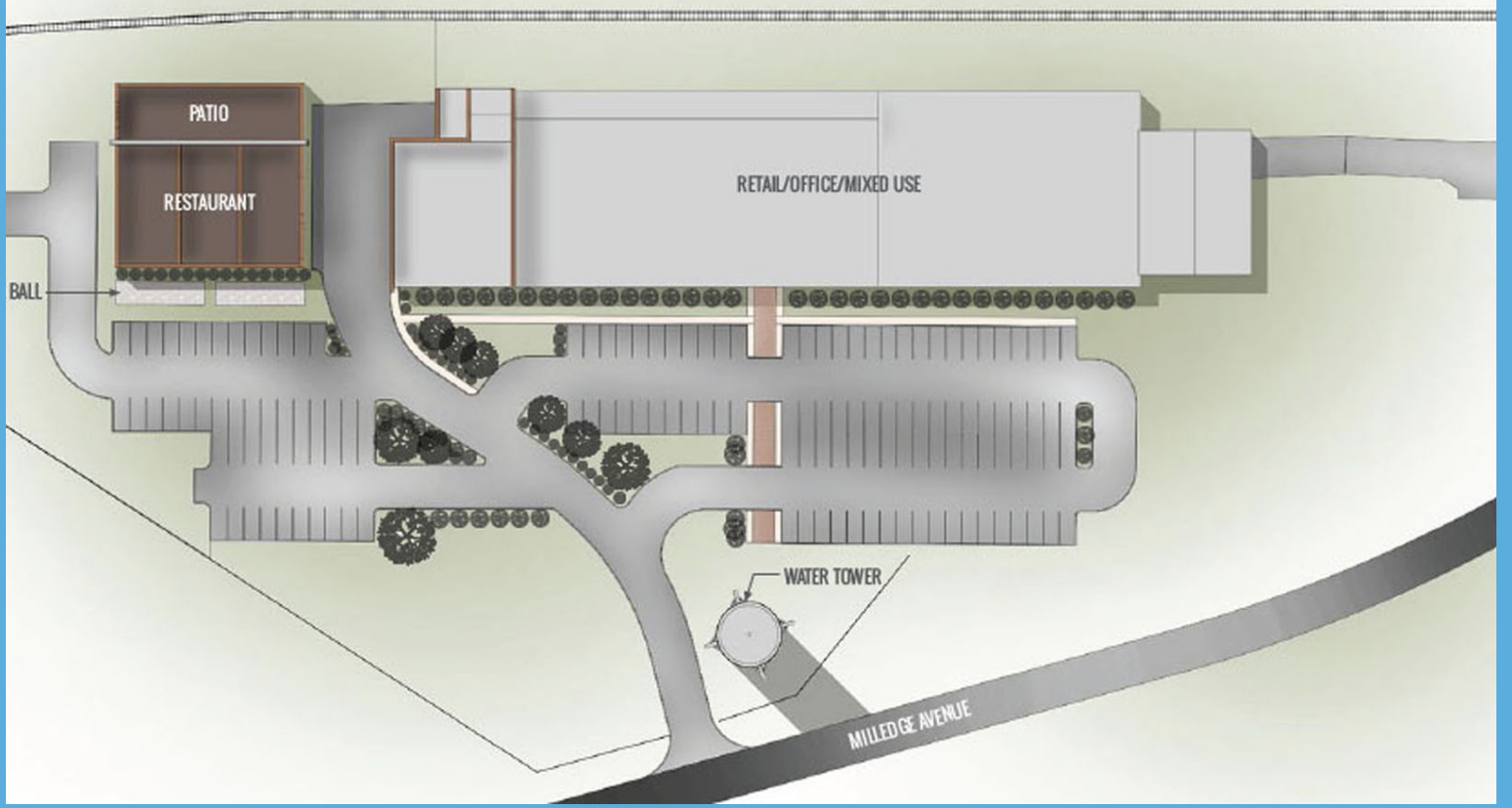

**UP TO 60,000 SF
BUILD TO SUIT IN
HISTORIC ATHENS
YARN MILL**

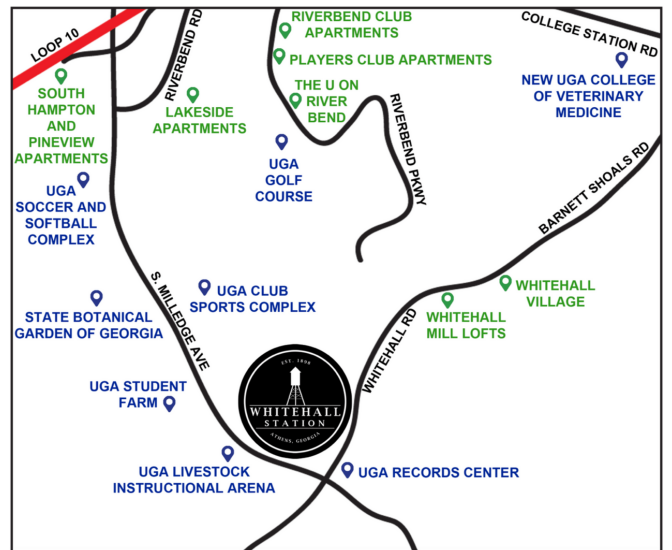

950 WHITEHALL RD, ATHENS, GA 30605

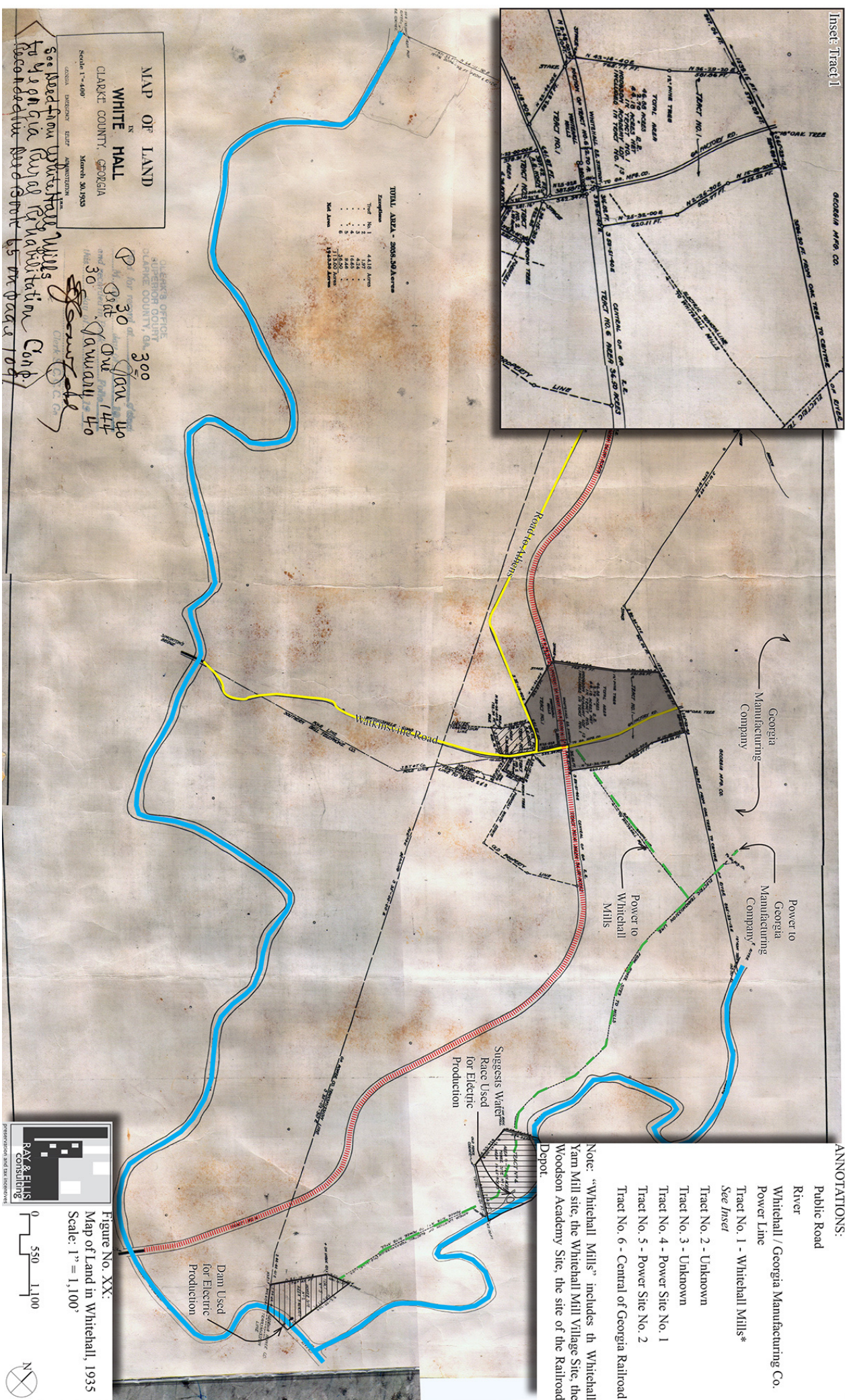

ANNOTATIONS:
 Public Road
 River
 Whitehall / Georgia Manufacturing Co. Power Line
 Tract No. 1 - Whitehall Mills*
 See Inset
 Tract No. 2 - Unknown
 Tract No. 3 - Unknown
 Tract No. 4 - Power Site No. 1
 Tract No. 5 - Power Site No. 2
 Tract No. 6 - Central of Georgia Railroad

Note: "Whitehall Mills" includes the Whitehall Yarn Mill site, the Whitehall Mill Village Site, the Woodson Academy Site, the site of the Railroad Depot.

RAY & FILLS CONSULTING

See location of Whitehall Mills to Georgia Rural Rehabilitation Camp. Recordative and other by map area top.

300
 300
 300
 40
 40
 40