

# 8634 Elder Creek Road

POWER INN SUBMARKET

SACRAMENTO, CA

±4,900 SF Industrial Building  
Available February 2025



## Contact Us

**Zac Sweet** SIOR

Senior Vice President  
+1 916 717 4768  
zac.sweet@cbre.com  
Lic. 01352800

**Tyler Howell**

Senior Associate  
+1 916 781 4835  
tyler.howell1@cbre.com  
Lic. 02100245

**Courtney Lee**

Associate  
+1 916 906 5544  
courtney.lee@cbre.com  
Lic. 02031694

**Stacy Ladd**

Senior Asset Manager, Buzz Oates  
T: 916 379 3847  
stacyladd@buzzoates.com  
Lic. 01214064

# PROPERTY INFORMATION

**8634 ELDER CREEK ROAD  
SACRAMENTO, CA 95828**

- + BUILDING AREA: ±4,900 SF
- + OFFICE AREA: ±500 SF
- + AVAILABLE: FEBRUARY 2025
- + CLEAR HEIGHT: 16'-18'
- + GRADE LEVEL DOORS: 6 - 10' X 12'
- + ZONING: M-2S HEAVY INDUSTRIAL
- + POWER: 400 AMPS, 120/208V\*

\*TENANT TO INDEPENDENTLY VERIFY PRIOR TO ENTERING BINDING AGREEMENT

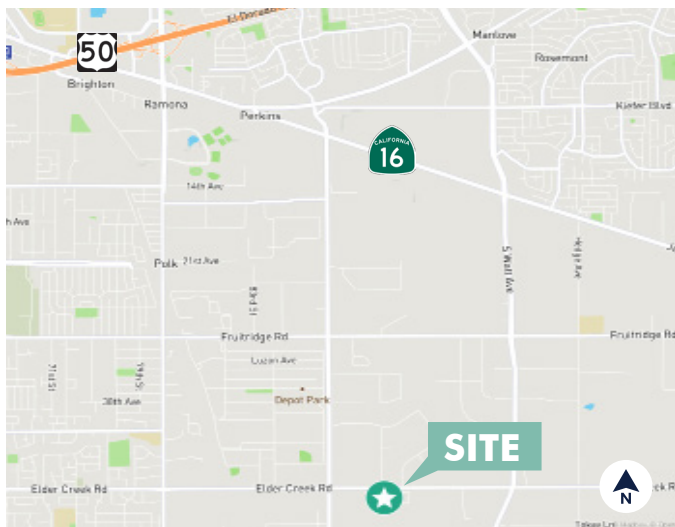

# FLOOR PLAN

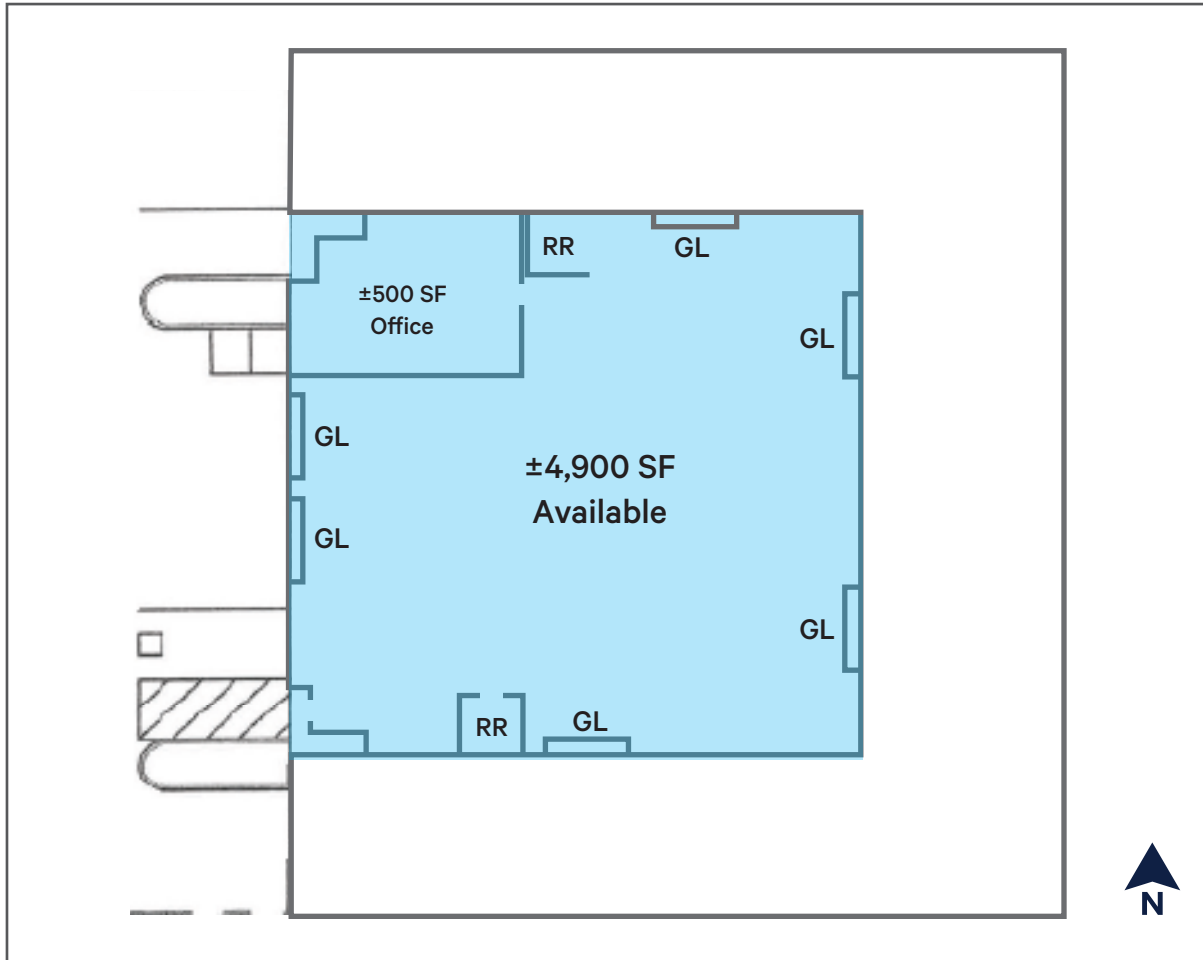

\*FLOOR PLAN NOT TO SCALE

GL - Grade Level Door

RR - Restroom

## Contact Us

### Zac Sweet SIOR

Senior Vice President

+1 916 717 4768

zac.sweet@cbre.com

Lic. 01352800

### Tyler Howell

Senior Associate

+1 916 781 4835

tyler.howell1@cbre.com

Lic. 02100245

### Courtney Lee

Associate

+1 916 906 5544

courtney.lee@cbre.com

Lic. 02031694

### Stacy Ladd

Senior Asset Manager, Buzz Oates

T: 916 379 3847

stacyladd@buzzoates.com

Lic. 01214064