

EAST BANK

S 6th Street & Conner Street, Noblesville, IN



McCREA
PROPERTY GROUP

MIXED-USE DEVELOPMENT - RETAIL / MULTI-FAMILY



**Developed &
Owned By:**



FOR LEASE

- 5,565 sf restaurant space available
- Outdoor Dining Opportunity
- **34 dedicated public garage parking spaces available and 32 public street parking spaces immediately adjacent to the property with abundant additional parking one block away**
- Located in the heart of historic Downtown Noblesville
- Part of EAST BANK a New 219-unit Multi-Family / Commercial Mixed-Use Development

CONTACT

Keith Fried

kfried@mccreapg.com

Jason Fried

jfried@mccreapg.com

MARKET DEMOGRAPHICS

Radius	Population	Income	Households	Daytime Pop
1 Mile	8,187	\$91,701	3,626	6,070
3 Mile	39,584	\$137,192	15,299	17,512
5 Mile	120,553	\$150,481	45,476	30,696

301 Pennsylvania Pkwy | Suite 225 | Indianapolis | IN | 46280

Information deemed reliable, but not guaranteed. Subject to change without notice.

EAST BANK

S 6th Street & Conner Street, Noblesville, IN



McCREA
PROPERTY GROUP

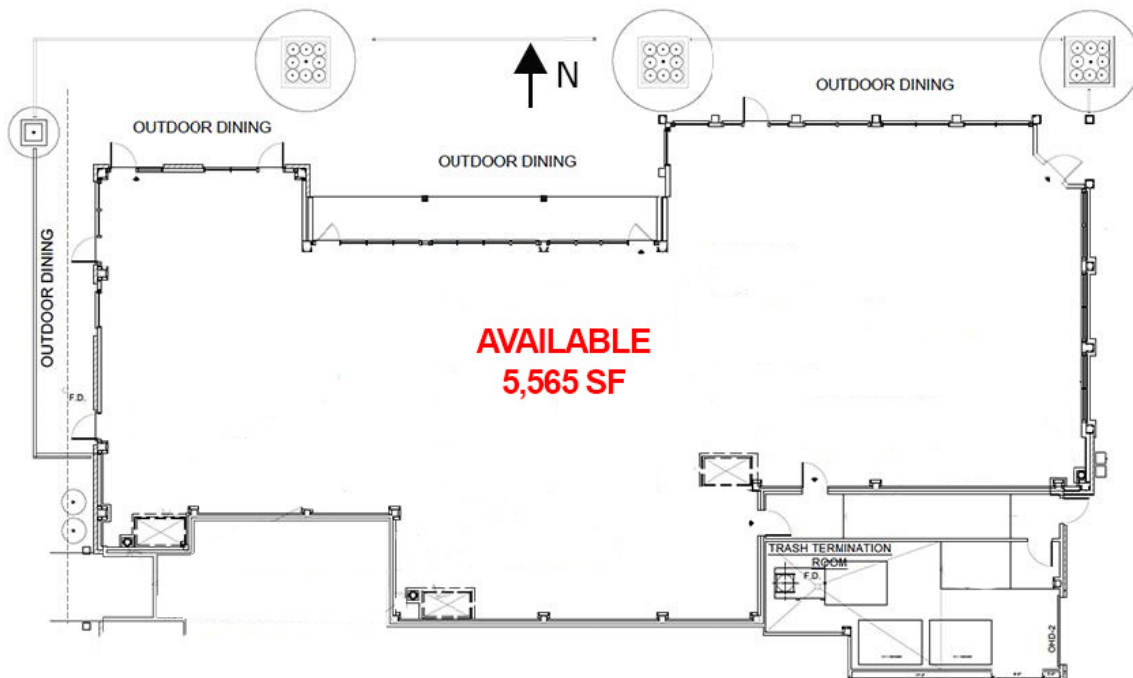

301 Pennsylvania Pkwy | Suite 225 | Indianapolis | IN | 46280

Information deemed reliable, but not guaranteed. Subject to change without notice.

NOBLESVILLE DOWNTOWN PARKING MAP



ON-STREET PARKING

FREE PARKING

2 Consecutive Hours Only: Weekdays (9A-5P)
Unlimited hours: Weekend

PERMIT PARKING

Permits Required: Monday - Friday (8A-5P)
Open: Weeknights/Weekends

NO PARKING

ALWAYS FREE



20 Minute Parking Spots are available around the Downtown Square and identified with signage



LOT PARKING

Public Parking Lot

ORANGE LOT

GOLD LOT

Hourly Parking: Monday - Friday (9A-5P)
Cost: \$2/Hour FREE Parking: Weekends

Public Parking Garage

THE LEVINSON

Permit & Public Parking Available
Cost: First 4 hours are free
\$2 per hour after, including overnight

Permit Required Parking Lots

PURPLE LOT

Permit Parking: 8A-5P

CITY EMPLOYEE LOT

Permit Parking: 8A-5P

HAMILTON COUNTY PARKING GARAGE

Permit Parking: 7A-5P

Free Parking: Weeknights/Weekends

Always FREE Parking Lots

GREEN

CITY HALL

BROWN

EAST