

RETAIL SPACE

RIVERDALE CROSSING

193 West 237th Street

RIVERDALE
BRONX | NY

896 SF

For Lease



SPACE DETAILS

GROUND FLOOR

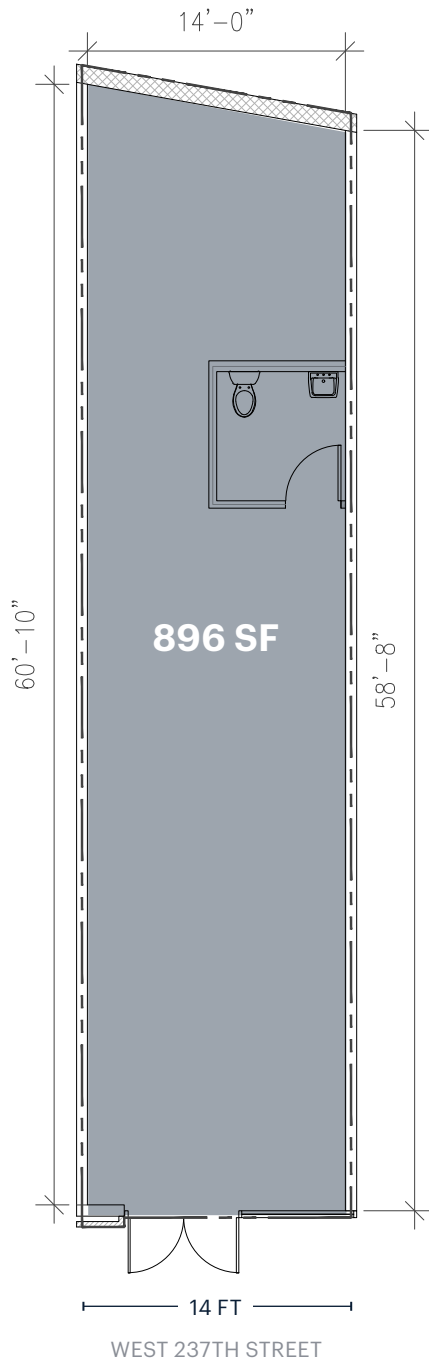

LOCATION

193 West 237th Street

SIZE

Ground Floor 896 SF

FRONTAGE

14 FT

STATUS

Currently Subway Sandwiches

RENT

Upon request

CO-TENANTS

Chipotle, BJ's, Buffalo Wild Wings, Bank of America, and Teriyaki One

COMMENTS

New premiere neighborhood shopping center

Strong co-tenancy with BJ's wholesale club as anchor

496 parking spaces

TRANSPORTATION

2023 Ridership Report

238th Street

| | |
|---------|---------|
| Annual | 959,752 |
| Weekday | 3,104 |
| Weekend | 3,141 |

Bx9

| | |
|---------|-----------|
| Annual | 3,451,515 |
| Weekday | 10,746 |
| Weekend | 13,129 |

Bx3

| | |
|---------|-----------|
| Annual | 1,967,640 |
| Weekday | 5,978 |
| Weekend | 8,184 |

SITE PLAN

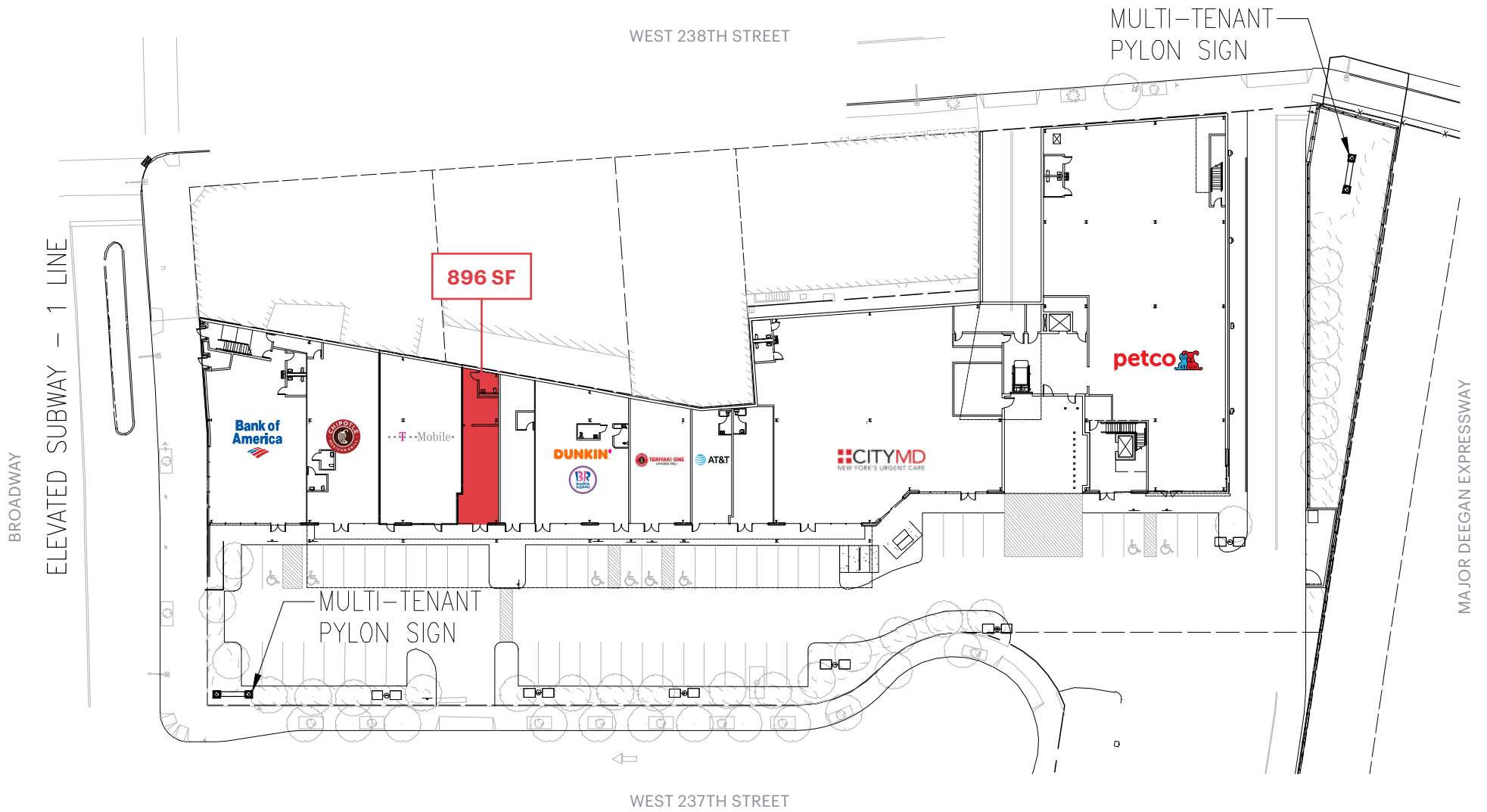

AREA RETAIL



RIVERDALE CROSSING

RIVERDALE CROSSING

- Smash Burger
- Bank of America
- AT&T
- petco
- WILD WINGS
- CITYMD URGENT CARE
- SUBWAY
- Mobile
- TERIYAKI ONE
- batikn
- DUNKIN'

THE SHOPS AT MARBLE HILL

- Chick-fil-A
- Marshall's
- Applebees
- target
- Starbucks
- Planet Fitness

CONTACT EXCLUSIVE AGENTS

PETER YOON
 pyoon@ripcony.com
 718.233.6565

ERIC FISHER
 efisher@ripcony.com
 718.233.6565