



Lauderdale County Parcel Viewer

512 E Mobile St, Florence, AL, X



Navigation Tools



Zoom In



Zoom Out



Pan

Layers

☒ Lauderdale County Data☐ Lauderdale County Imagery

Legend

Find Address

Search

By Attribute

By Shape

Select A Layer:

Parcels

Owner Name: (at least 3 chars)

Enter the name Smith, John

Parcel Number: (at least 3 chars)

2401013003007000

PIN (Parcel Identification Number):
(at least 1 chars)

12345

Search

Street View

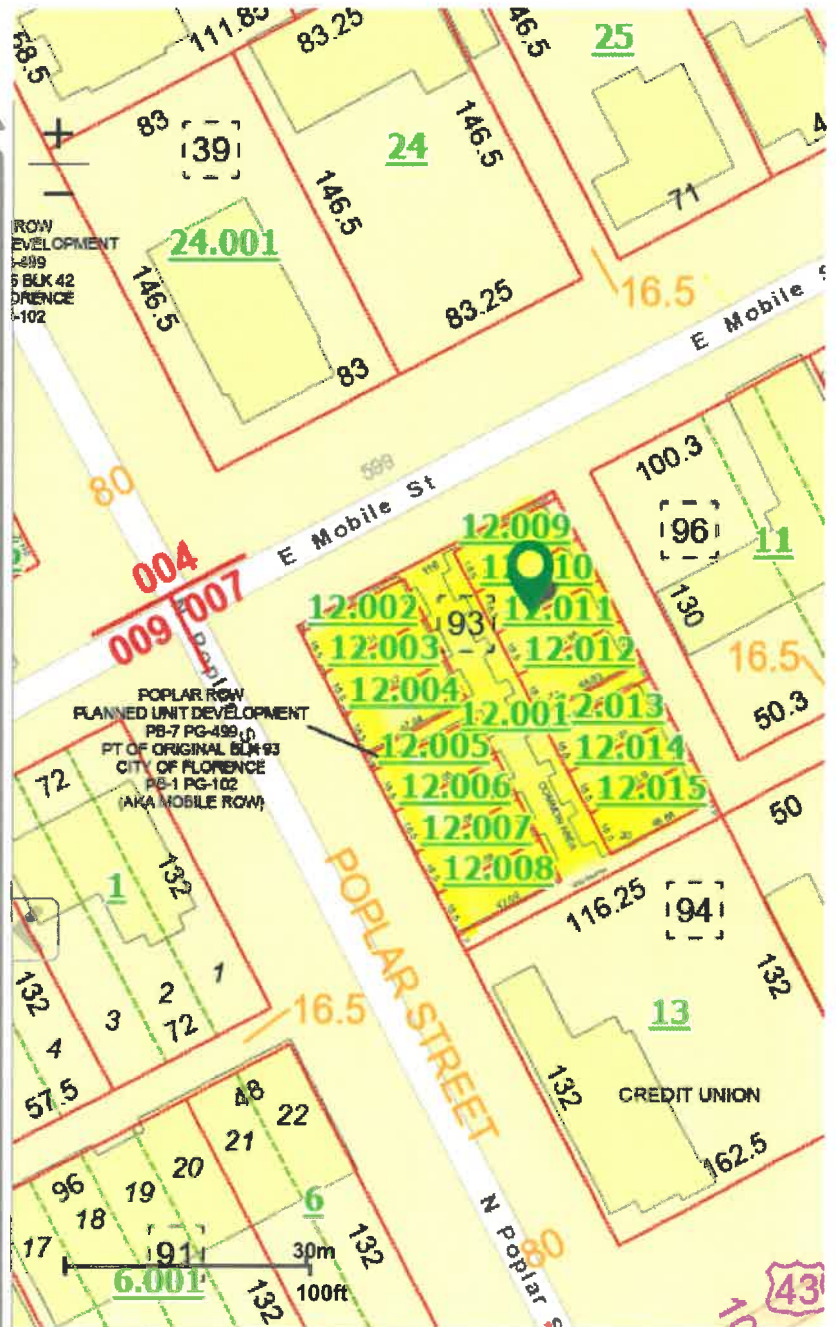
View the center of the map OR
use the button to click on the map.

MOBILE ROW

COMPLEX HAS 14 UNITS
EACH UNIT IS APPROX 1950 SQ FT
3 BEDROOMS, 3.5 BATHS, SINGLE CAR GARAGE, \$2,500 MONTHLY RENT PER UNIT
INCLUDED ARE THE FOLLOWING

512 E. MOBILE STREET

PARCEL # 24-01-11-3-007-012.001

LEGAL DESCRIPTION: 116.5' X 6.89' IRR COMMON AREA OF POPLAR ROW PLANNED UNIT DEVELOPMENT
PB 7 PG 499 (AKA MOBILE ROW) PT OF ORIGINAL BLK 93 CITY OF FLORENCE SEC 11 T3S R11W
2025 TAXES \$217.56

0 MOBILE STREET

PARCEL # 24-01-11-3-007-012.002

LEGAL DESCRIPTION: 18.5' X 47' LOT 7 OF POPLAR ROW PLANNED UNIT DEVELOPMENT PB 7 PG 499 (AKA
MOBILE ROW) PT OF ORIGINAL BLOCK 93 CITY OF FLORENCE
SEC 11 T3S R11W
2025 TAXES \$436.10

0 MOBILE STREET

PARCEL # 24-01-11-3-007-012.003

LEGAL DESCRIPTION: 18.5' X 47.02' LOT 8 OF POPLAR ROW PLANNED UNIT DEVELOPMENT PB 7 PG 499
(AKA MOBILE ROW) PT OF ORIGINAL BLOCK 93 CITY OF FLORENCE SEC 11 T3S R11W
2025 TAXES \$436.10

0 MOBILE STREET

PARCEL # 24-01-11-3-007-012.004

LEGAL DESCRIPTION: 18.5' X 47.04' LOT 9 POPLAR ROW PLANNED UNIT DEVELOPMENT PB 7 PG 499 (AKA
MOBILE ROW) PT OF ORIGINAL BLOCK 93 CITY OF FLORENCE
SEC 11 T3S R11W
2025 TAXES \$ 436.10

0 MOBILE STREET

PARCEL # 24-01-11-3-007-012.006

LEGAL DESCRIPTION: 18.5' X 47.06' LOT 11 OF POPLAR ROW PLANNED UNIT DEVELOPMENT PB 7 PG 499
(AKA MOBILE ROW) PT OF ORIGINAL BLOCK 93 CITY OF FLORENCE SEC11 T3S R11W
2025 TAXES \$436.10

0 MOBILE STREET

PARCEL # 24-01-11-3-007-012.007

LEGAL DESCRIPTION: 18.5' X 47.08' LOT 12 POPLAR ROW PLANNED UNIT DEVELOPMENT PB 7 PG 499
(AKA MOBILE ROW) PT OF ORIGINAL BLOCK 93CITY OF FLORENCE SEC 11 T3S R11W
2025 TAXES \$436.10

0 MOBILE STREET

PARCEL # 24-01-11-3-007-012.008

LEGAL DESCRIPTION: 18.5' X 47.09' LOT 13 OF POPLAR ROW PLANNED UNIT DEVELOPMENT PB 7 PG 499
(AKA MOBILE ROW) PT OF ORIGINAL BLK 93 CITY OF FLORENCE SEC 22 R3W R11W
2025 TAXES \$436.10

CONTINUED

0 MOBILE STEET

PARCEL # 24-01-11-3-007-012.009

LEGAL DESCRIPTION: 18.5' X 47' LOT 14 OF POPLAR ROW PLANNED UNIT DEVELOPMENT PB 7 PG 499 (AKA MOBILE ROW) PT OF ORIGINAL BLK 93 CITY OF FLORENCE SEC 22 R3W R11W

2025 TAXES \$436.10

0 MOBILE STREET

PARCEL # 24-01-11-3-007-012.010

LEGAL DESCRIPTION: 18.5 X 46.97' LOT 15 OF POPLAR ROW PLANNED UNIT DEVELOPMENT PB 7 PG 499 (AKA MOBILE ROW) PT OF ORIGINAL BLK 93 CITY OF FLORENCE SEC 22 R3W R11W

2025 TAXES \$436.10

0 MOBILE STREET

PARCEL # 24-01-11-3-007-012.011

LEGAL DESCRIPTION: 18.5' X 46.95' LOT 16 OF POPLAR ROW PLANNED UNIT DEVELOPMENT PB 7 PG 499 (AKA MOBILE ROW) PT OF ORIGINAL BLK 93 CITY OF FLORENCE SEC 22 R3W R11W

2025 TAXES \$436.10

0 MOBILE STRET

PARCEL # 24-01-11-3-007-012.012

LEGAL DESCRIPTION: 18.5' X 46.97' LOT 17 OF POPLAR ROW PLANNED UNIT DEVELOPMENT PB 7 PG 499 (AKA MOBILE ROW) PT OF ORIGINAL BLK 93 CITY OF FLORENCE SEC 22 R3W R11W

2025 TAXES \$436.10

0 MOBILE STREET

PARCEL # 24-01-11-3-007-012.013

LEGAL DESCRIPTION: 18.5' X 46.91' LOT 18 OF POPLAR ROW PLANNED UNIT DEVELOPMENT PB 7 PG 499 (AKA MOBILE ROW) PT OF ORIGINAL BLK 93 CITY OF FLORENCE SEC 22 R3W R11W

2025 TAXES \$436.10

0 MOBILE STREET

PARCEL #24-01-11-3-007-012.014

LEGAL DESCRIPTION: 18.5' X 46.9' LOT 19 OF POPLAR ROW PLANNED UNIT DEVELOPMENT PB 7 PG 499 (AKA MOBILE ROW) PT OF ORIGINAL BLK 93 CITY OF FLORENCE SEC 22 R3W R11W

2025 TAXES \$436.10

0 MOBILE STREET

PARCEL # 24-01-11-3-007-012.015

LEGAL DESCRIPTION: 18.5' X 46.88' LOT 20 OF POPLAR ROW PLANNED UNIT DEVELOPMENT PB 7 PG 499 (AKA MOBILE ROW) PT OF ORIGINAL BLK 93 CITY OF FLORENCE SEC 22 R3W R11W

2025 TAXES \$436.10