



Address: 1910 E Dominguez St, Carson, CA 90810
Cross Streets: S Wilmington Ave/E Dominguez St

3 Dock Positions Plus 2 Ground Level Doors
 Private Yard Area Suitable for Product/Trailer Storage
 Outstanding Carson Location One Mile From 405 Freeway

Lease Rate/Mo: \$35,403
Lease Rate/SF: \$1.15
Lease Type: Net / Op. Ex: \$0.58
Available SF: 30,785 SF
Minimum SF: 30,785 SF
Prop Lot Size: 1.38 Ac / 60,249 SF
Term: 3 Years
Sale Price: NFS
Sale Price/SF: NFS
Taxes: \$176,706 / 2025
Yard: Fenced / Paved
Zoning: MH

Sprinklered: Yes
Clear Height: 21'-23'
GL Doors/Dim: 2 / 12'x12'
DH Doors/Dim: 3 / 10'x10'
A: 400 V: 120/240 0: 3 W: 4
Construction Type: TILT UP
Const Status/Year Blt: Existing / 1982
Whse HVAC: No
Parking Spaces: 46 / **Ratio:** 1.5:1
Rail Service: No
Specific Use: Warehouse/Distribution

Office SF / #: 3,200 SF / 8
Restrooms: 3
Office HVAC: Heat & AC
Finished Ofc Mezz: 700 SF
Include In Available: Yes
Unfinished Mezz: 0 SF
Include In Available: No
Possession: 30 Days
Vacant: No
To Show: Call broker
Market/Submarket: Carson/Compton
APN#: 7316-028-007

Listing Company: The Klabin Company

Agents: [Michael Quellette 310-329-9000](mailto:Michael.Quellette@klabin.com), [Nicholas Buss 310-329-9000](mailto:Nicholas.Buss@klabin.com), [Frank Schulz 310-329-9000](mailto:Frank.Schulz@klabin.com)

Listing #: 44195417

Listing Date: 01/21/2026

FTCF: CB300N000S000/OAA

Notes: Sprinkler calculation .21/2040. 21'-23' clearance. Lessee to verify all information contained herein.



This information supplied herein is from sources we deem reliable. It is provided without any representation, warranty or guarantee, expressed or implied as to its accuracy. Prospective Buyer or Tenant should conduct an independent investigation and verification of all matters deemed to be material, including, but not limited to, statements of income and expenses. Consult your attorney, accountant, or other prof. advisor.



KLABIN
 A member of the CORFAC International network

KLABIN.COM

19700 S. VERMONT AVENUE, SUITE 100
 TORRANCE, CA 90502

DRE 00824993

310.329.9000





SITE PLAN

INDUSTRIAL PROPERTY FOR LEASE

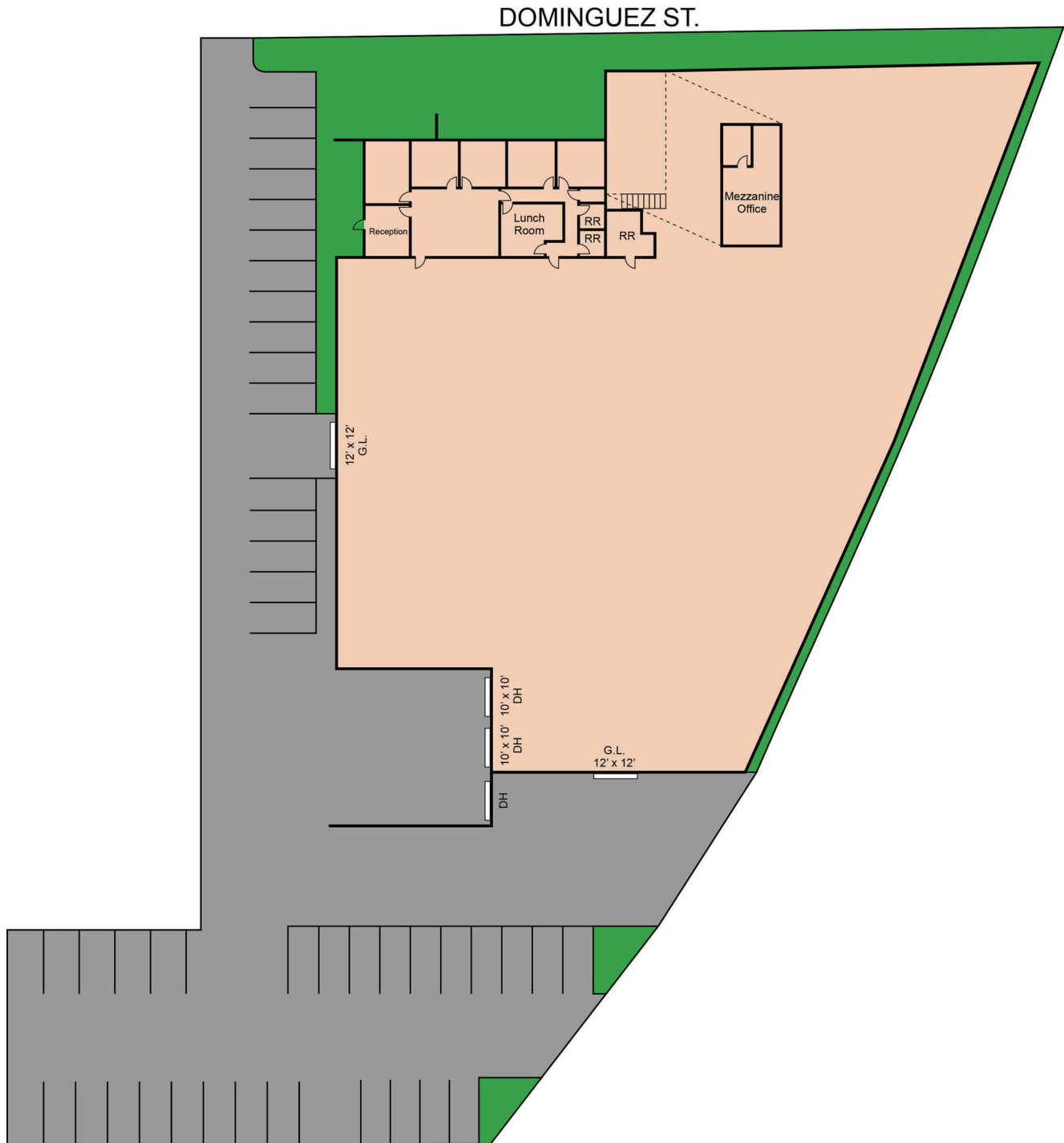

OWNED BY:



MIKE OUELLETTE
Vice President
310.329.9000 X1170
mikeo@klabin.com
Lic. 01989268

NICK BUSS, SIOR
Principal
310.329.9000 X-1160
nickb@klabin.com
Lic. 02086889

FRANK SCHULZ, SIOR
Managing Principal
310.329.9000 X-1100
franks@klabin.com
Lic. 01455172

KLABIN
A member of the CORFAC International network