

460

N. CANON
DRIVE



JAY LUCHS

VICE CHAIRMAN

T 310.407.6585

JAY.LUCHS@NMRK.COM

CA RE LIC. #01260345

NEWMARK

WWW.JAYLUCHS.COM

AVAILABILITY

N. CANON DRIVE

S. SANTA MONICA BOULEVARD

460 N. Canon Drive
±1,929 SF

il
Tramezzino
Italian Cafe

drybar

JENNIFER FISHER

JAY LUCHS

VICE CHAIRMAN

T 310.407.6585

JAY.LUCHS@NMRK.COM

CA RE LIC. #01260345

WWW.JAYLUCHS.COM

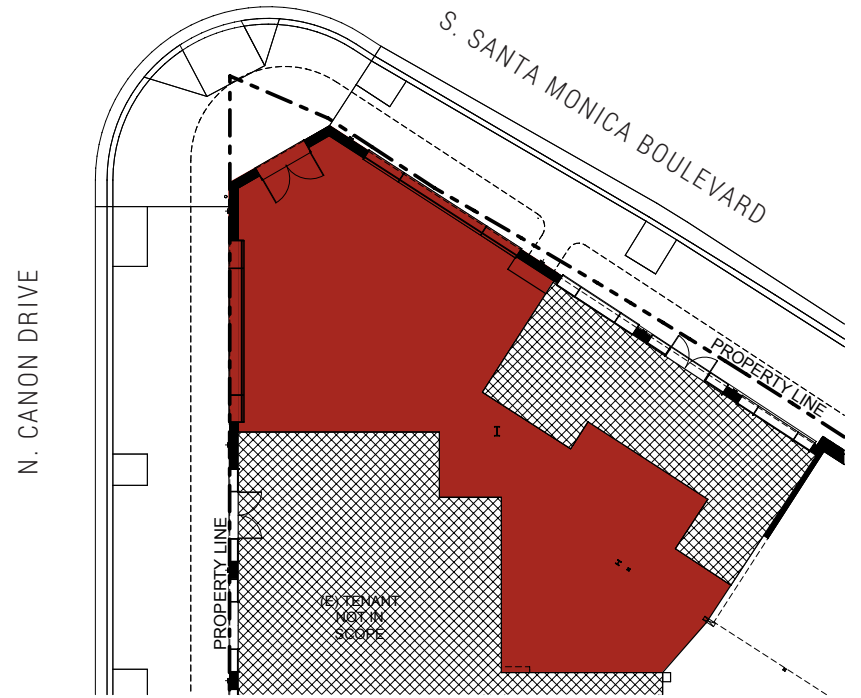

460

N. CANON
DRIVE



SIZE

±1,929 SF



USE

Retail



RENT

\$12.00 PSF per month NNN
\$144.00 PSF per annum NNN



NNN

Approximately \$2.50 PSF per month
Approximately \$30.00 PSF per annum

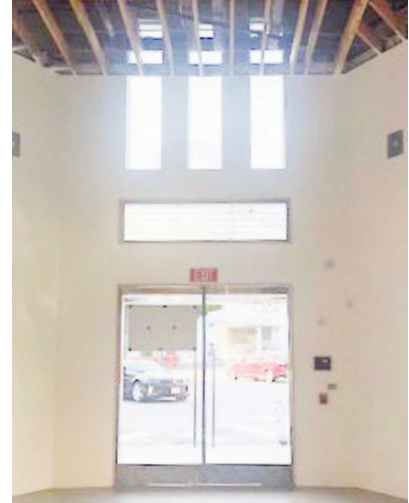

JAY LUCHS

VICE CHAIRMAN

T 310.407.6585

JAY.LUCHS@NMRK.COM

CA RE LIC. #01260345

WWW.JAYLUCHS.COM

NEARBY TENANTS



drybar



il Tramezzino
Pizzeria & Deli



CAFÉ GRATITUDE



HERITAGE



EDELWEISS CHOCOLATES



ALCHEMY 43



LA SCALA



OLIVE & JUNE



PortaVia
Beverly Hills



il Pastaio
Restaurante - Bar



**THE WALLIS ANNENBERG CENTER
FOR THE PERFORMING ARTS**

N. SANTA MONICA BOULEVARD
Medical Building
For Lease

S. SANTA MONICA BOULEVARD

HERITAGE
Vacant
Clorja
MAKEUP STUDIO
TATEL
Offices
For Lease

PARKING STRUCTURE
Wallis
For Lease (former WOLFGANG'S)
Keller Williams
The Courtyard
For Lease - Jay Luchs

MIRAME
BEVERLY HILLS, CA

YOSEMITE
JAMES PERSE

BRIGHTON WAY
Garfield Pharmacy
e. baldi
JAMES PERSE
Nelson Shelton Real Estate
For Lease - Jay Luchs

ALIBABA PIZZERIA
STREET

R/Wall Paint Lounge
Redevelopment Project
Wendy Harrison
JACKMOND
LE MERVETTY
Bally Pop-Up

Village on Canon

VIA ALORO
PHYSIQUE

DAYTON WAY
Blown
Nest Seekers

Palm
RESTAURANT

Hilton & Hyland
Vacant
For Lease

Sweet
BY THE BAKERY

Georgie
MAYBOURNE
HOTEL GROUP

BANK OF THE WEST
BNP PARIBAS

WILSHIRE BOULEVARD

N. SANTA MONICA BOULEVARD
The Wallis
Wallis Annenberg Center for the Performing Arts

S. SANTA MONICA BOULEVARD

460
N. CANON
DRIVE

drybar

JENNIFER FISHER
Edelweiss Chocolates
Selfish
ANNESISTERON

LEONARDO
Vacant
PortaVia
Umberto Salon
WABATSUMI
RESTAURANTE - BAR

il Pastaio
RESTAURANTE - BAR

BRIGHTON WAY

alo
BELLA + CANVAS

Vacant

Nazareth's
Florie Couture
Versai
GIUSEPPE FRANCO SALON
Mishka
Beverly Hills Watch Co.
Vacant

ESTRATORIO
Louka

Filmon.tv/Salon 90210

RITE AID

DAYTON WAY
Obagi
Core Real Estate Group

MASTRO'S
STEAKHOUSE

For Lease
Sands & Associates
MiniLuxe
LUXURIATOR
Barnes International Realty
WH

Super Care Drugs
For Lease (Office)
For Lease
CANALÉ

SUGARFISH
BY SUSHI NOZAWA

Westside Estate Agency
Rodeo Realty

CLIFTON WAY
Pacific Premier Bank
Fred Hayman Building

MUST BE

Spago
PRIVE

Coldwell Banker
New Pacific

WILSHIRE BOULEVARD

CANON DRIVE

JAY LUCHS

VICE CHAIRMAN

T 310.407.6585

JAY.LUCHS@NMRK.COM

CA RE LIC. #01260345

WWW.JAYLUCHS.COM



The information contained herein has been obtained from sources deemed reliable but has not been verified and no guarantee, warranty or representation, either express or implied, is made with respect to such information. Terms of sale or lease and availability are subject to change or withdrawal without notice.

JAY LUCHS

VICE CHAIRMAN

T 310.407.6585

JAY.LUCHS@NMRK.COM

CA RE LIC. #01260345

NEWMARK

WWW.JAYLUCHS.COM