

TOUCHMARK OFFICE PADS

31-91 S. TOUCHMARK WAY MERIDIAN, IDAHO 83642

0.436 TO 2.716 AC OF PRIME OFFICE DEVELOPMENT LAND
FOR SALE

JOHN STEVENS 208.947.0814 john@tokcommercial.com

MICHAEL BALLANTYNE 208.947.0831 mjb@tokcommercial.com





DETAILS

SALE PRICE: \$9.75/SF

AVAILABLE LOT SIZES: 0.436 AC to 2.716 AC

NO. OF LOTS: 7

ZONING: L-O | Limited Office

SUBMARKET: North Meridian

RESTRICTED USES: Inpatient Acute Care Service, Commercial Lab or Imaging, Surgery, Endoscopic Procedures, Arthroscopic Procedures, Radiation Therapy, Cardiac Imaging or Catheterization, Obstetrical Services



HIGHLIGHTS

Great location, just off of Eagle and Franklin Roads.

Excellent proximity to I-84, next to St. Luke's largest campus in the state.

Located off major corridor among St. Luke's, Blue Cross of Idaho, Meridian Crossroads, Scentsy, The Village at Meridian and more.



AVAILABLE LOTS

LOT DESCRIPTION:	LOT SIZE:
LOT 07 BLK 01 TOUCHMARK CENTER SUB #1	0.526 AC
LOT 08 BLK 01 TOUCHMARK CENTER SUB #1	0.518 AC
LOT 11 BLK 01 TOUCHMARK CENTER SUB #1	0.612 AC
LOT 12 BLK 01 TOUCHMARK CENTER SUB #1	0.624 AC
LOT 13 BLK 01 TOUCHMARK CENTER SUB #1	0.436 AC

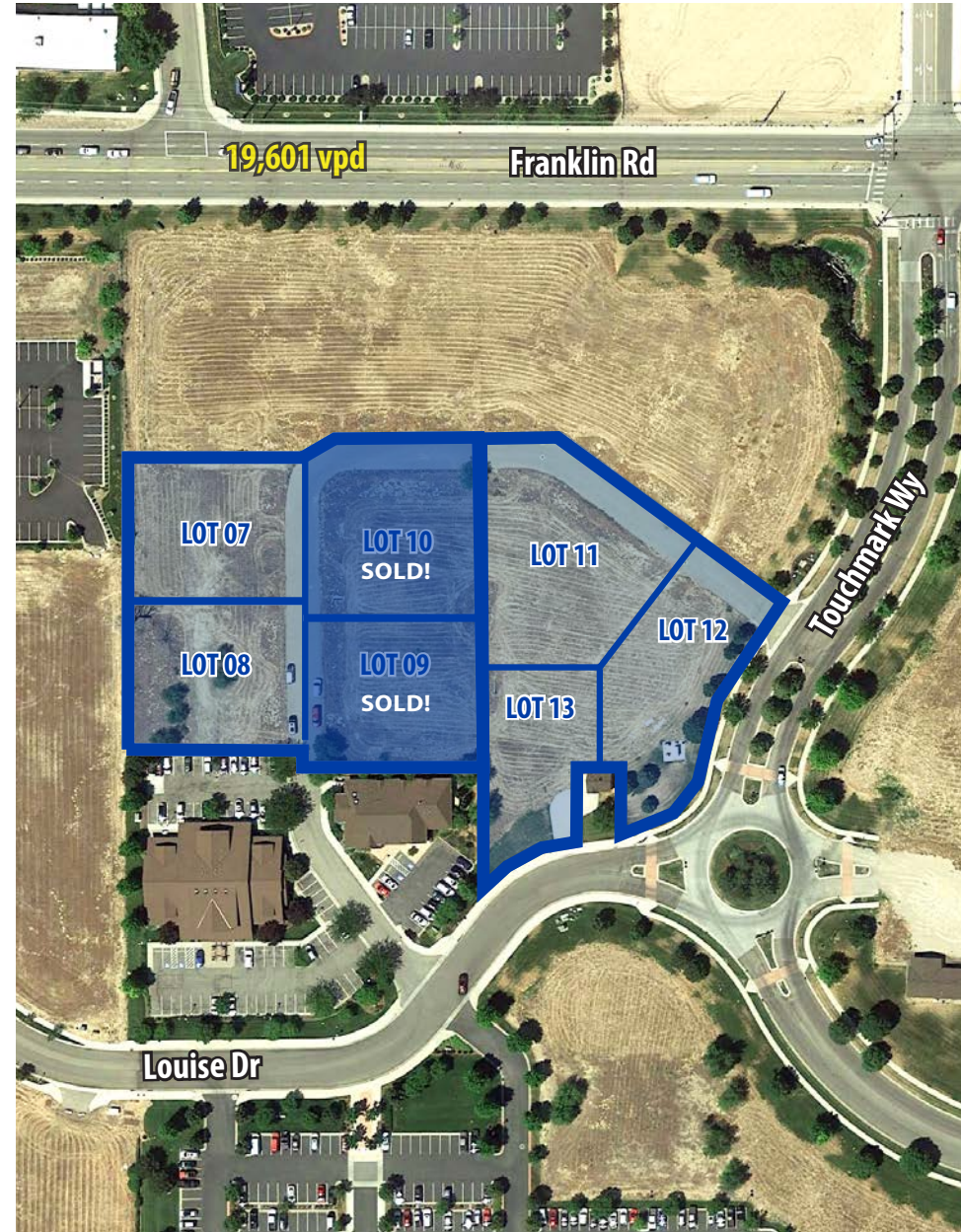

JUST OFF I-84 & MERIDIAN'S MAIN ARTERIAL

