

BEALLS PLAZA

10060 Pines Blvd • Pembroke, FL 33024

RESTAURANT SPACE FOR LEASE



116,162 SF Shopping Center in the Heart of Pembroke Pines

Features

- 2nd Generation Restaurant Space Available (7,400 SF + 2,800 SF Outdoor Patio)
- Come join other tenants like Bealls Outlet, Dollar General, Doris Market, Lens Crafters and Bank of America in this highly visible shopping center.
- Traffic counts in front of the site are 48,000 VPD & 25,000 VPD
- Excellent location in what is considered to be the center of one of the nations most exciting growth areas, Pembroke Pines.
- City Hall and a 285,000 SF Power Center are located across the street and the 2M+ SF Pembroke Lakes Regional Mall is just one mile away along with Target, Sports Authority, Best Buy and numerous national retailers.



Brad Ackerman

954.963.7500 • brad@silverbuilders.com



SILVER BUILDERS
REAL ESTATE CORPORATION

BEALLS PLAZA

10060 Pines Blvd • Pembroke, FL 33024

RESTAURANT SPACE FOR LEASE

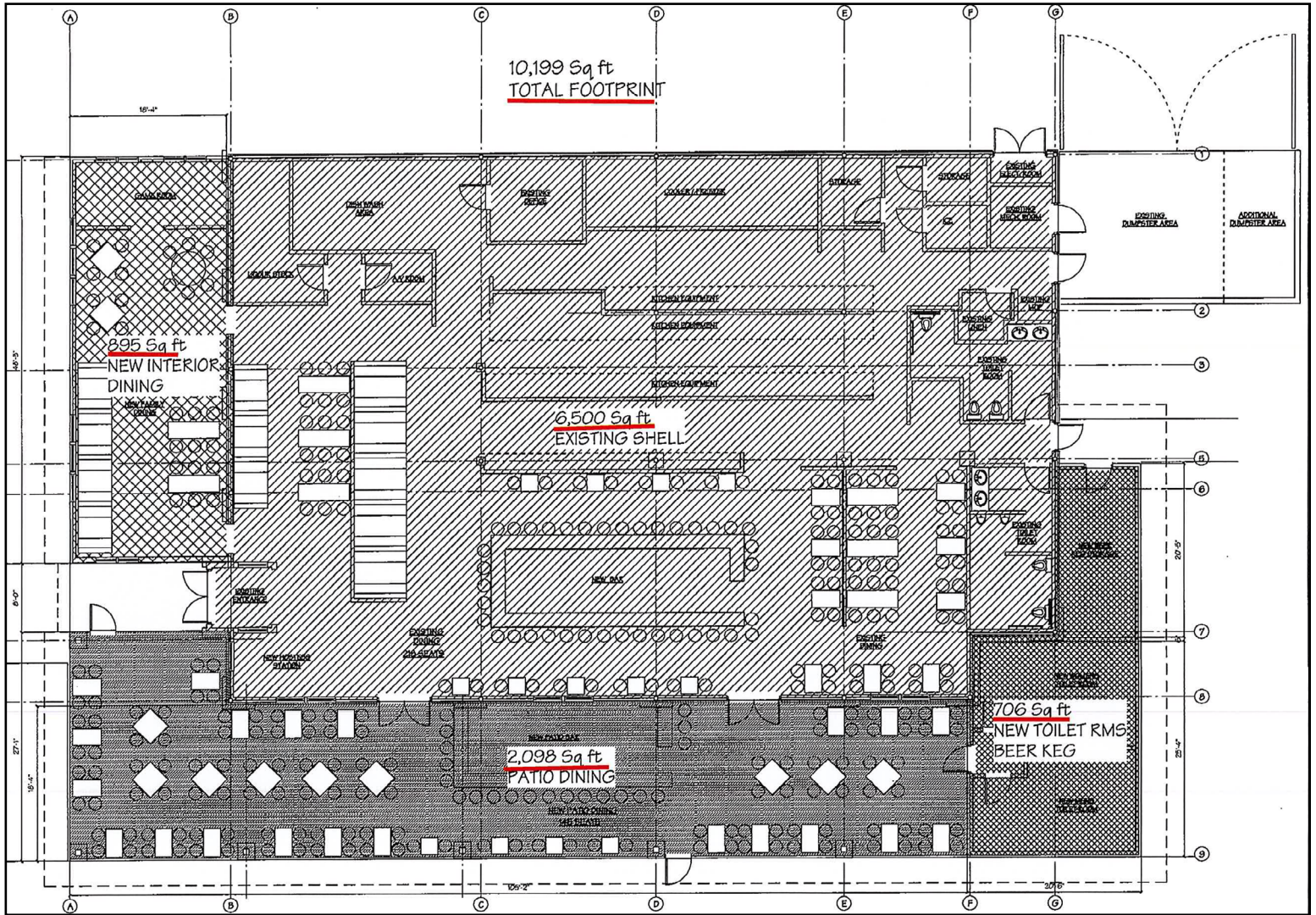

Floor Plan

Brad Ackerman

954.963.7500 • brad@silverbuilders.com



SILVER BUILDERS
REAL ESTATE CORPORATION

BEALLS PLAZA

10060 Pines Blvd • Pembroke, FL 33024

RESTAURANT SPACE FOR LEASE

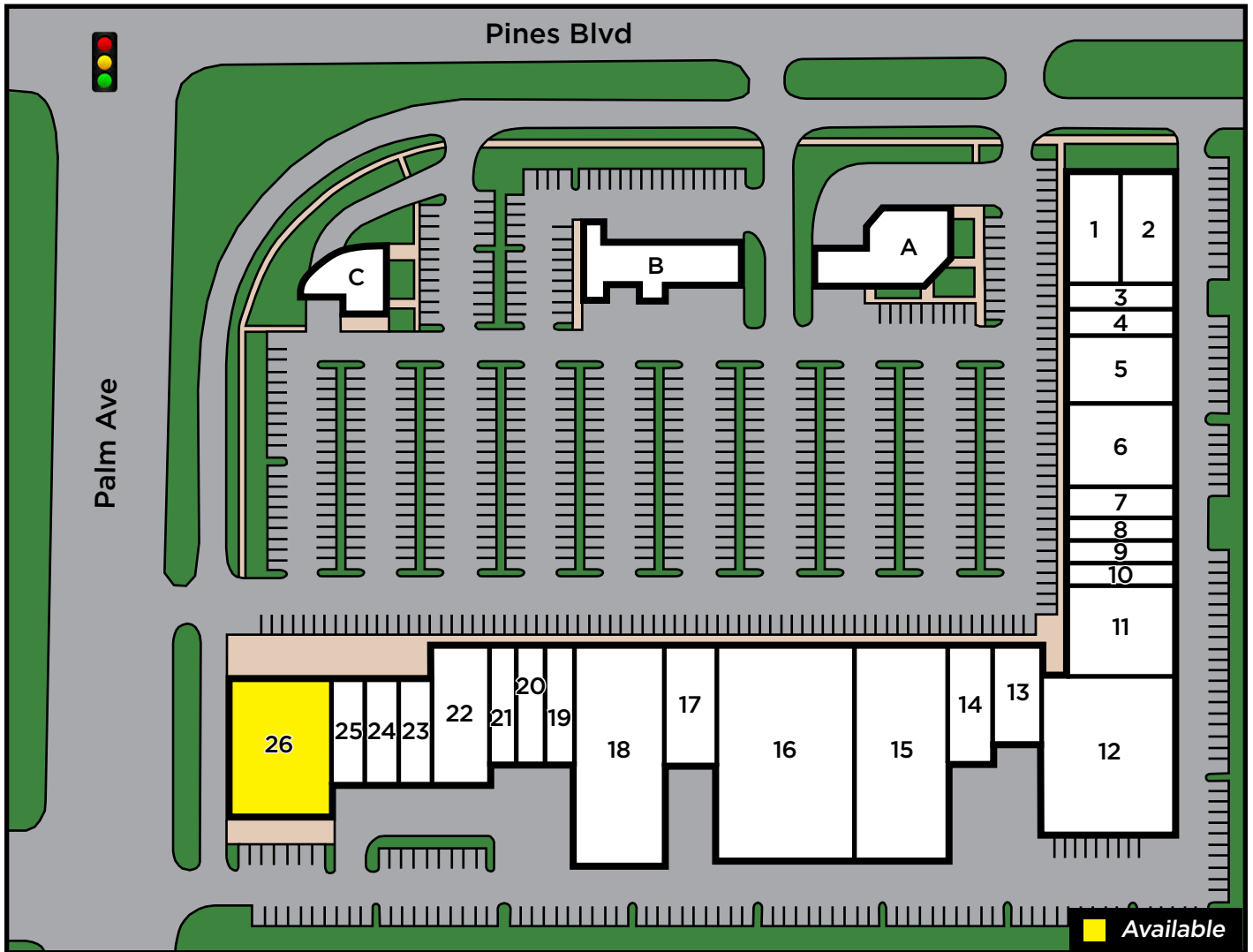

#	Address	Size
1	9900	4,100 SF
2	9916	4,700 SF
3	9920	1,600 SF
4	9924	1,600 SF
5	9930	4,725 SF
6	9940	5,200 SF
7	9948	2,700 SF
8	9956	1,200 SF
9	9960	1,200 SF
10	9964	1,200 SF

#	Address	Size
11	9968-76	3,600 SF
12	9980	13,200 SF
13	9984	3,130 SF
14	9996	2,550 SF
15	10000	9,800 SF
16	10004	20,000 SF
17	10008-16	3,768 SF
18	10020	10,800 SF
19	10028	1,700 SF
20	10032	2,380 SF

#	Address	Size
21	10036	1,955 SF
22	10040	3,600 SF
23	10044-48	3,365 SF
24	10052	1,825 SF
25	10056	1,900 SF
26	10060	7,400 SF
A	10050	Out Parcel
B	10070	Out Parcel
C	10090	Out Parcel

Brad Ackerman

954.963.7500 • brad@silverbuilders.com



SILVER BUILDERS
REAL ESTATE CORPORATION

BEALLS PLAZA

10060 Pines Blvd • Pembroke, FL 33024

RESTAURANT SPACE FOR LEASE

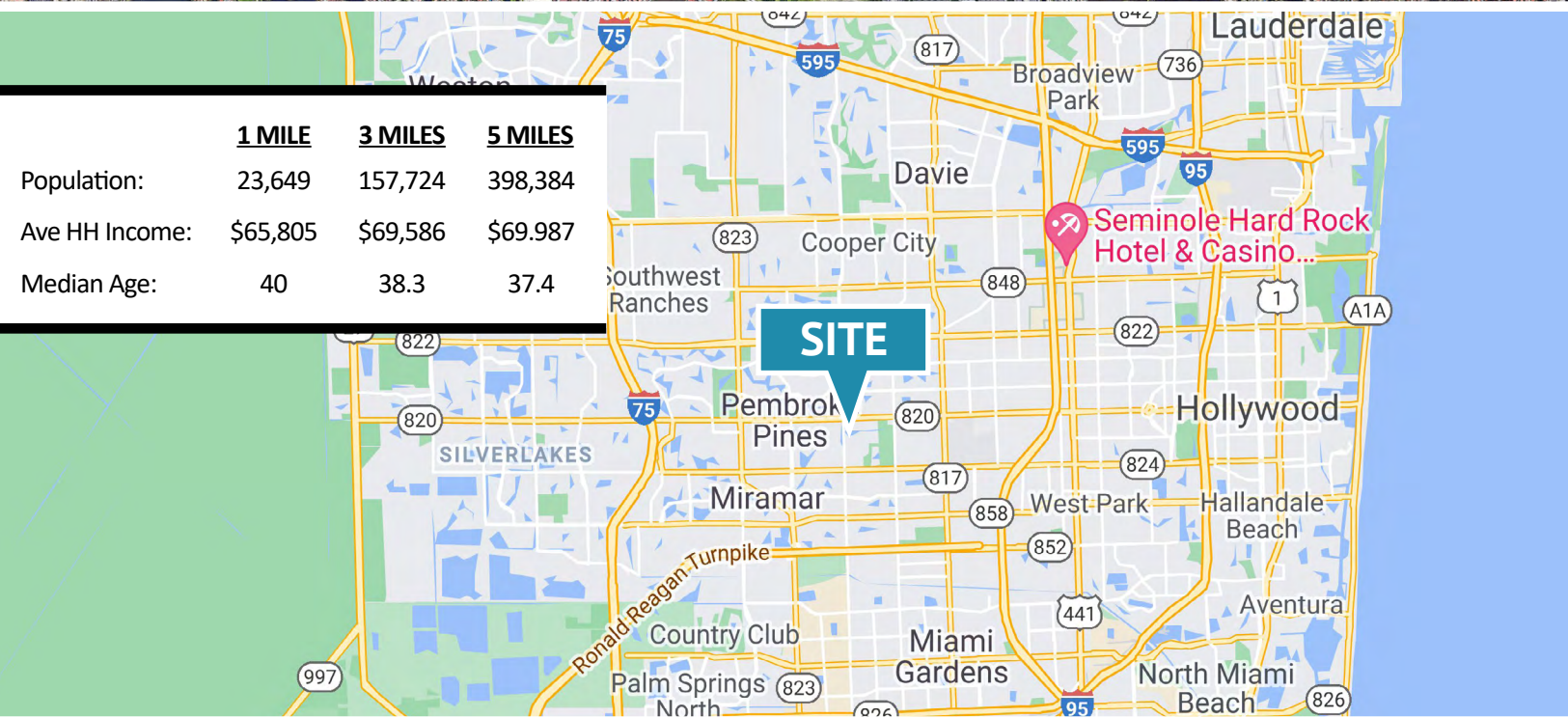

Brad Ackerman

954.963.7500 • brad@silverbuilders.com



SILVER BUILDERS
REAL ESTATE CORPORATION