

DONELSON PLAZA

Small Shop Retail Space Available



a development by



HOLLADAY
PROPERTIES

leasing by



SOUTHEAST VENTURE

OVERVIEW | Recently revitalized multi-tenant complex

2710-2720 Old Lebanon Road
Nashville, TN 37214

5:1000 Parking

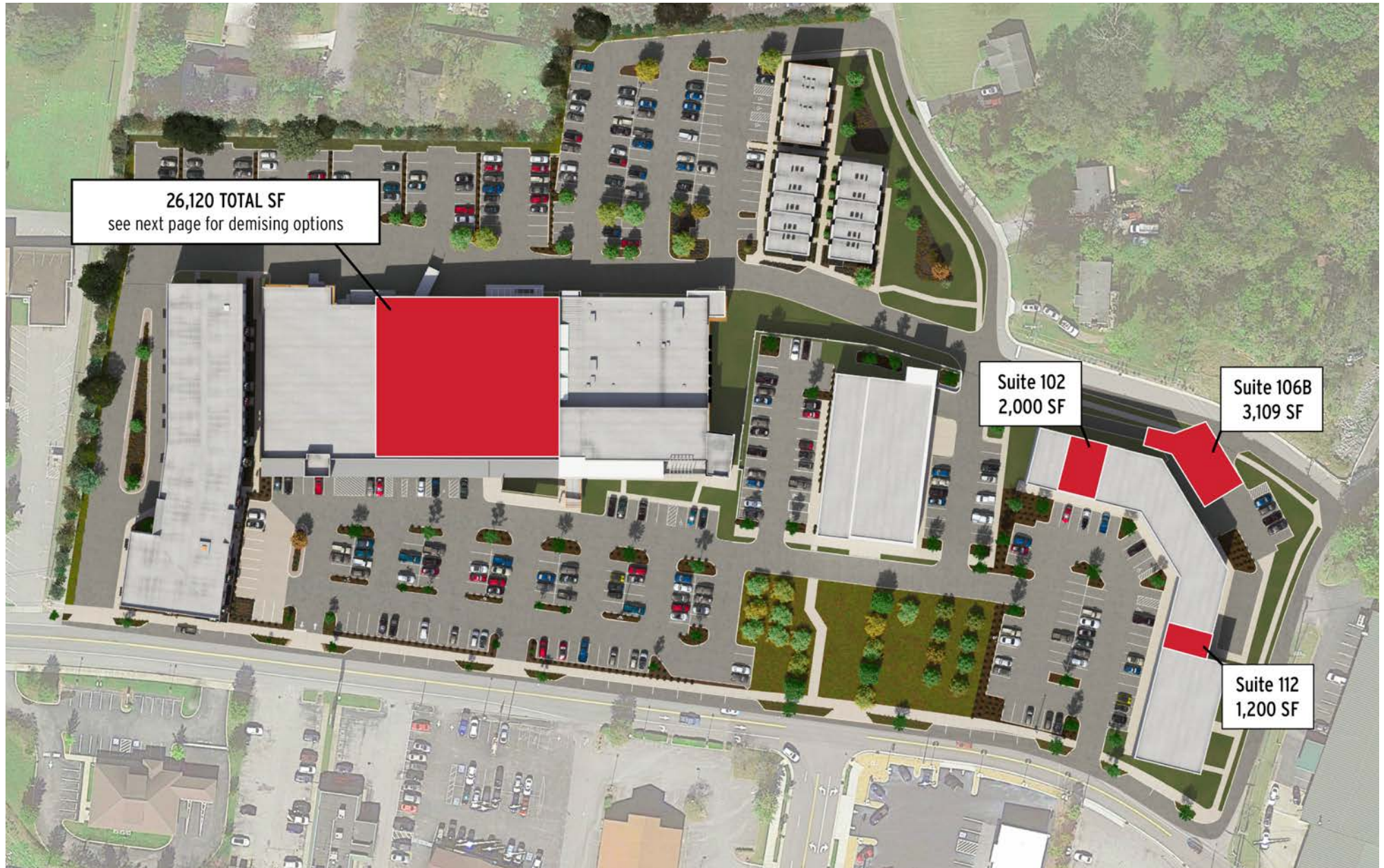

DEMISING OPTIONS | Retail Suites 9, 10, 11, 12, 13

26,120 Total SF | [View Additional Demising Options](#)

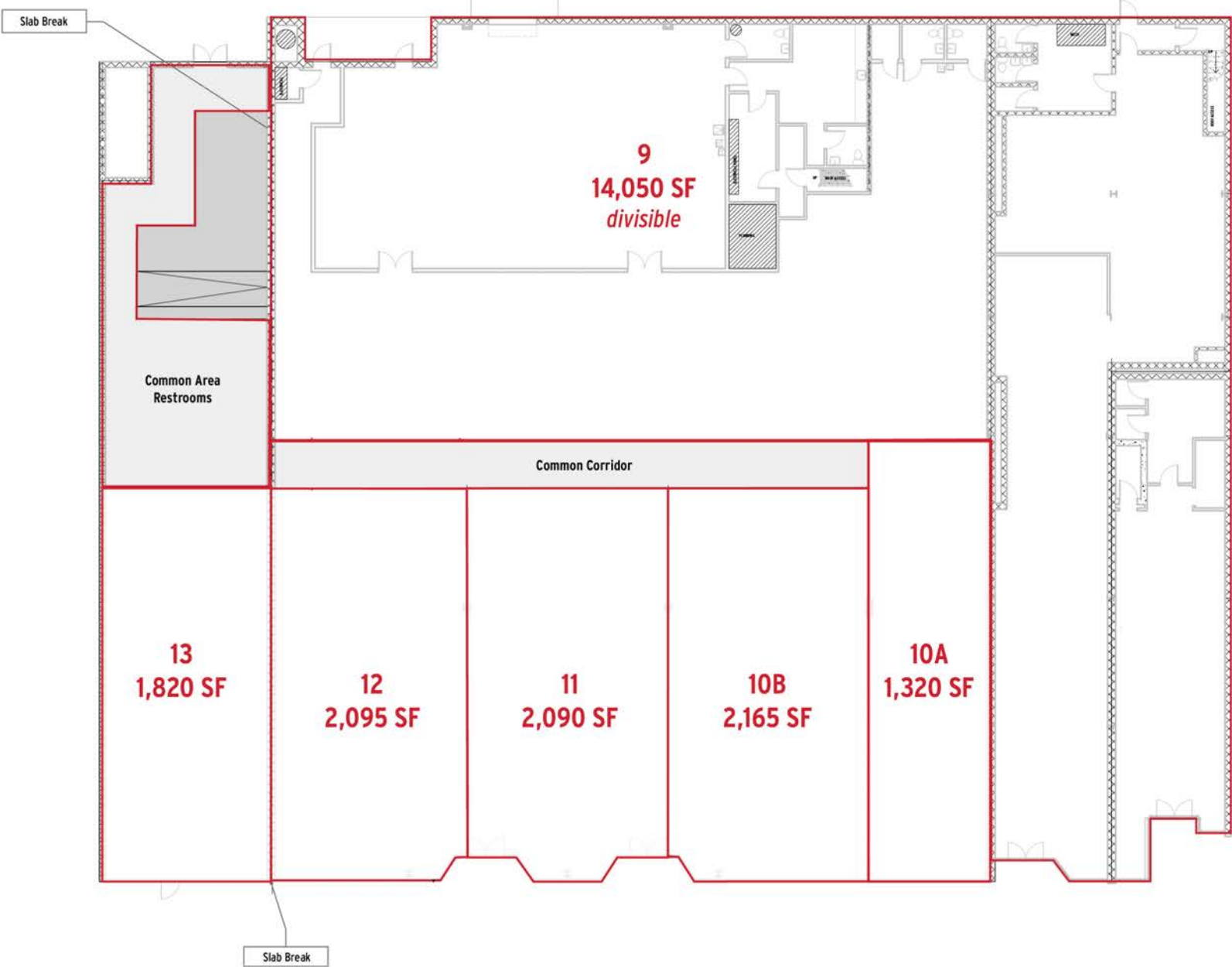

CURRENT TENANTS + FUTURE DEVELOPMENT



TENANTS
INCLUDE

- Bagelshop
- HiFi Cookies
- Fryce Cream
- Epiphany Chiropractic
- West Coast Taco Shop
- The Salon Professional Academy
- Homegrown Taproom & Kitchen
- Movement Lounge by Yoga Muttz
- Doneslon Strike & Spare
- Dollar Tree
- ABS Kids

Aerial Map of Donelson Area:

- Businesses and Landmarks:** PUBLIX, KROGER, TENNFOLD BREWING, SHIPLEY DONUTS, ROCKNROLL SUSHI, SUNFLOWER BAKEHOUSE, CALIBER COFFEE CO., NATIVE PILATES, RADIUS AT DONELSON, NECTAR: URBAN CANTINA, CROSSFIT DONELSON, PARTY FOWL, FLETCHER'S PIZZA, EDLEY'S BBQ, M'NAMARA'S PUB, BEXLEY DONELSON.
- Infrastructure:** BRILEY PARKWAY, OLD LEBANON PIKE, LEBANON PIKE, DONELSON PIKE, music city star computer train.
- Donelson Station:** Planned Transit-Oriented Mixed Use Development.
- Donelson Plaza:** Highlighted in red.

Inset Map:

- Location:** Donelson is located east of Nashville, Tennessee.
- Neighboring Areas:** East Nashville, North Nashville, Lockeland Springs, The Gulch, Berry Hill, Green Hills, Belle Meade.
- Highways:** I-40, I-24, I-75, I-41, I-41A, I-155, I-12, I-431, I-70S.
- Landmarks:** Nashville International Airport.

Key Statistics:

- Avg. HH Income: \$81,458
- Avg. Home Value: \$365,665
- Lebanon Pike at Old Lebanon Road: 32,757 Cars Per Day

| | |
|----------------------------------|------------------|
| Total Population | Median Age |
| 127,000 | 37.9 |
| Avg. HH Income | Avg. Home Value |
| \$81,458 | \$365,665 |
| Lebanon Pike at Old Lebanon Road | |
| 32,757 Cars Per Day | |

ADDITIONAL PHOTOS

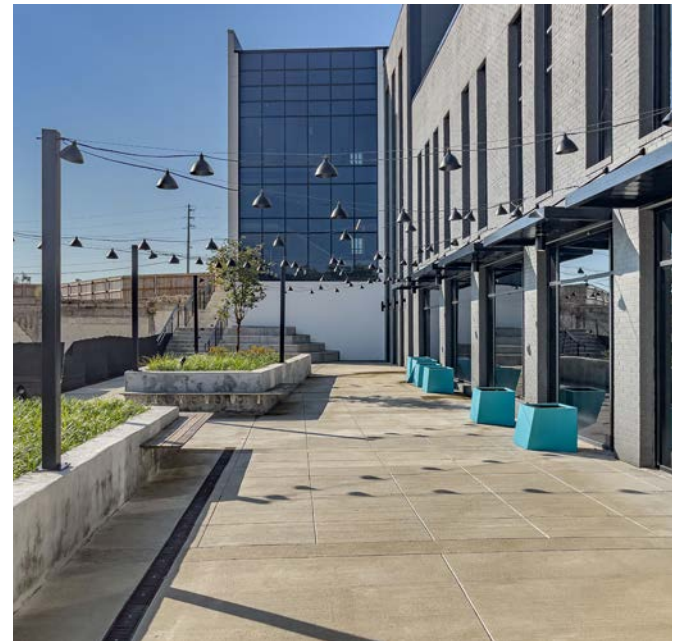

NEW DEVELOPMENT

102 Multi-Family Units Anchored by Bagelshop
Now Open



Future Nashville Public Library Donelson Branch
Now Open



FOR MORE INFORMATION, CONTACT

Jon Petty

615.743.9387

jpetty@southeastventure.com

Jeremy Coward

615.545.8368

jcoward@southeastventure.com

Shane Bowen

615.804.9540

sbowen@southeastventure.com

a development by



HOLLADAY
PROPERTIES

leasing by



SOUTHEAST VENTURE