

OVIEDO MEDICAL / DENTAL or TRADITIONAL OFFICE

FOR LEASE 1,500 SF 3,580 SF or 5,080 SF
820 W. Broadway, Oviedo, FL 32765

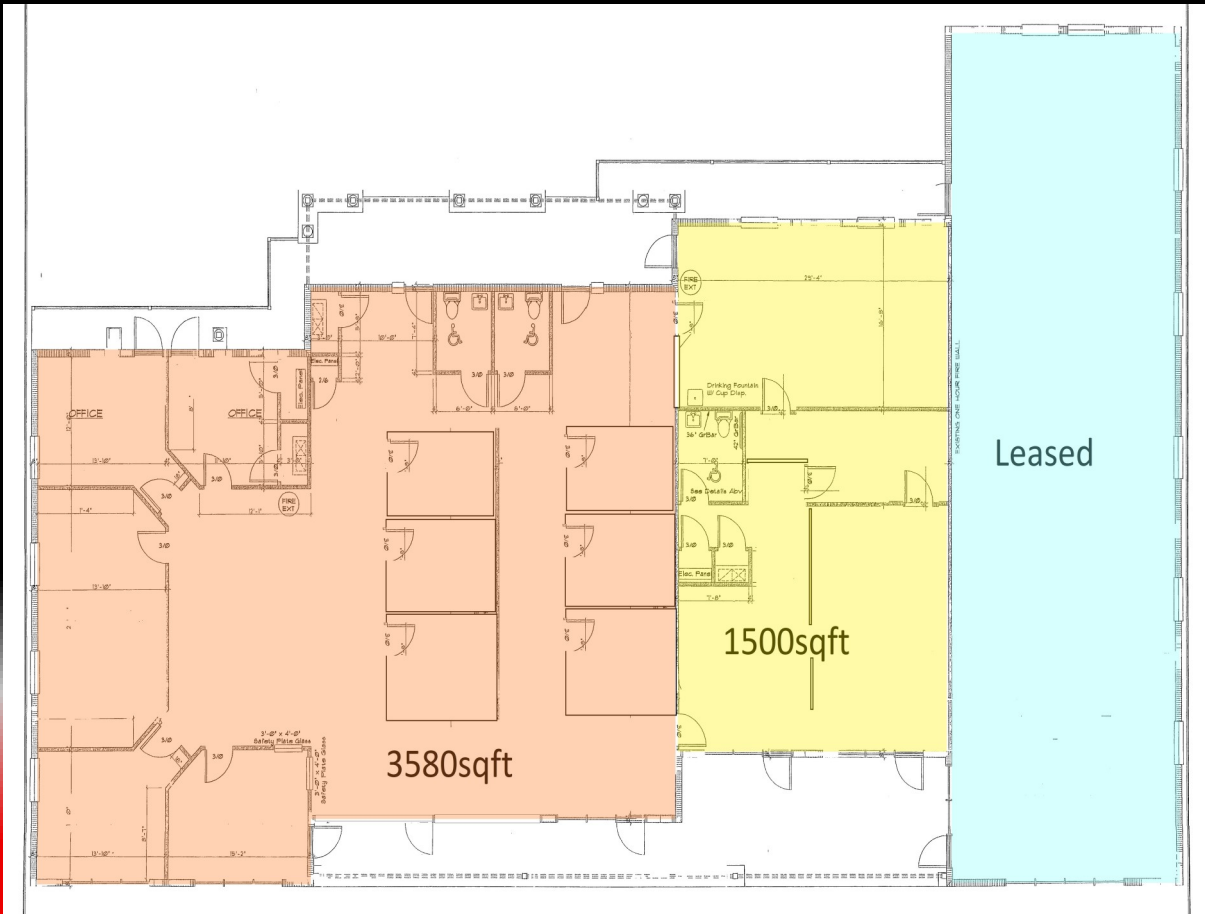





FOR LEASE
1,500 sf.
3,580 sf.
5,080 sf.



Greg Kainz
 (407) 580-4024
gkainz@cep advisors.com



David Lundberg
 (407) 701-4400
dlundberg@cep advisors.com



LEGAL DISCLAIMER:

INFORMATION GIVEN HEREWITH IS OBTAINED FROM SOURCES CONSIDERED RELIABLE; HOWEVER, WE ARE NOT RESPONSIBLE FOR MISSTATEMENT OF FACTS, ERRORS, OMISSIONS, PRIOR SALE, AND WITHDRAWAL FROM MARKET, CHANGE IN PRICE OR AVAILABILITY WITHOUT NOTICE. THE INFORMATION SUPPLIED HEREIN IS FOR INFORMATION PURPOSES ONLY AND SHALL NOT CONSTITUTE A WARRANTY OR ASSURANCE THAT SAID INFORMATION IS CORRECT. ANY PERSON INTENDING TO RELY UPON THE INFORMATION SUPPLIED HEREIN SHOULD VERIFY SAID INFORMATION INDEPENDENTLY.