

**FOR LEASE**

# 4090 Nelson Avenue, Suites A-G

Available: December 1, 2024 | Concord, CA |



±3,949 - ±18,295 SF



## PROPERTY HIGHLIGHTS

- SF: ±3,949 – ±18,295
- Standalone Building With Street Frontage
- Speculative Make-Ready to be Delivered Q4 2024
- Office Layout Per Floorplan
- Seven (7) Grade Level Doors
- Eight (8) Restrooms
- Clear Height: ±16'
- Power: 1200A @ 120/208 Volt
- Sprinklered
- Close Proximity to HWY 4 & 680
- Lease Rate: Call Brokers



## CONTACT US

Tony Binswanger, SIOR | Exec Vice President  
+1 925 296 7728 | [tony.binswanger@cbre.com](mailto:tony.binswanger@cbre.com)

Bo Harkins | First Vice President  
+1 925 296 7727 | [bo.harkins@cbre.com](mailto:bo.harkins@cbre.com)



**SPECULATIVE FLOORPLAN**

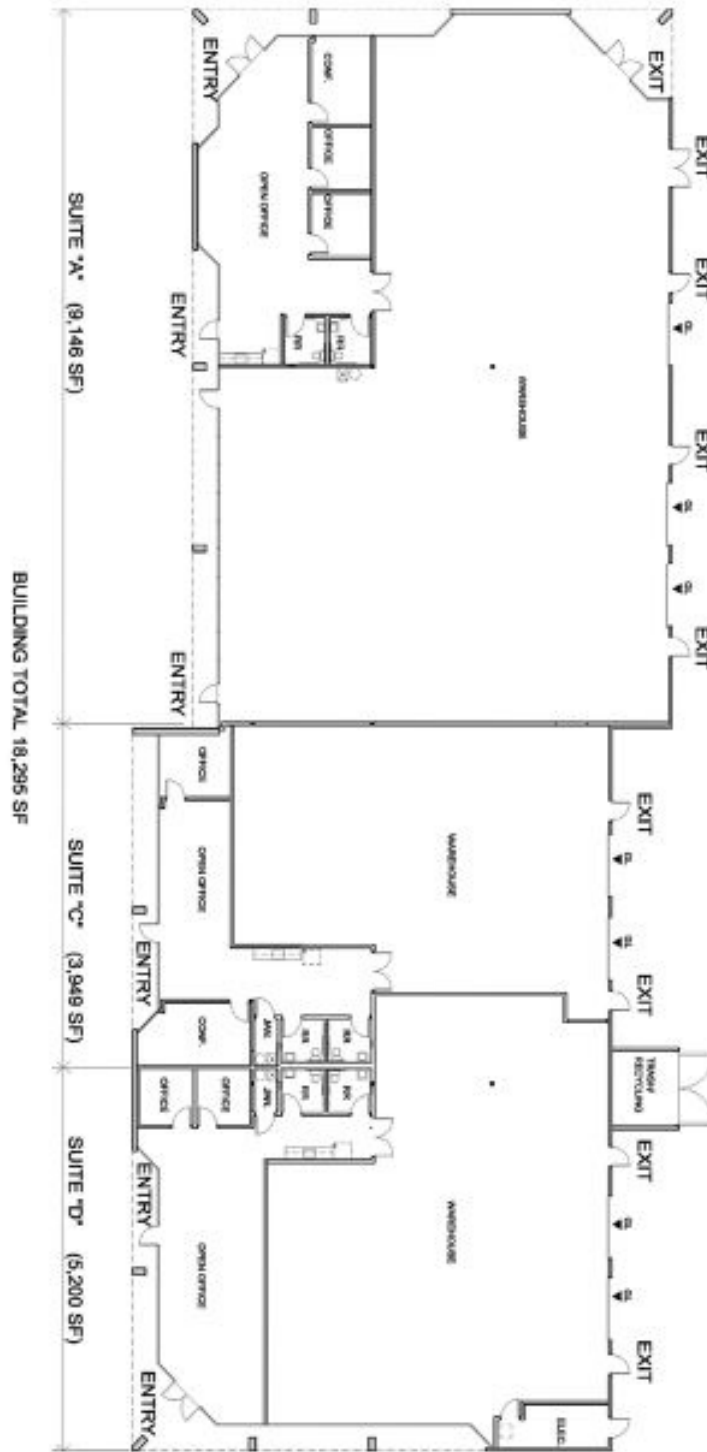

# SITE PLAN

