

FINAL MILE PARK

WESTCHESTER

1-6 Warehouse Lane | Elmsford, NY

FOR LEASE | 5 WAREHOUSE LANE



This last-mile location is located within two hours' drive of **23 million people** and **8.5 million households**, which includes the entire New York City metro area.



REALTERM
LOGISTICS



For more information, please contact: **Frank Rao** • 914.287.6410 • frao@nycrgroup.com | **Michael Rao** • 914.287.6410 • mr Rao@nycrgroup.com

FOR LEASE

5 WAREHOUSE LANE

8,004 SF • 8 Wide Large Drive-In Doors

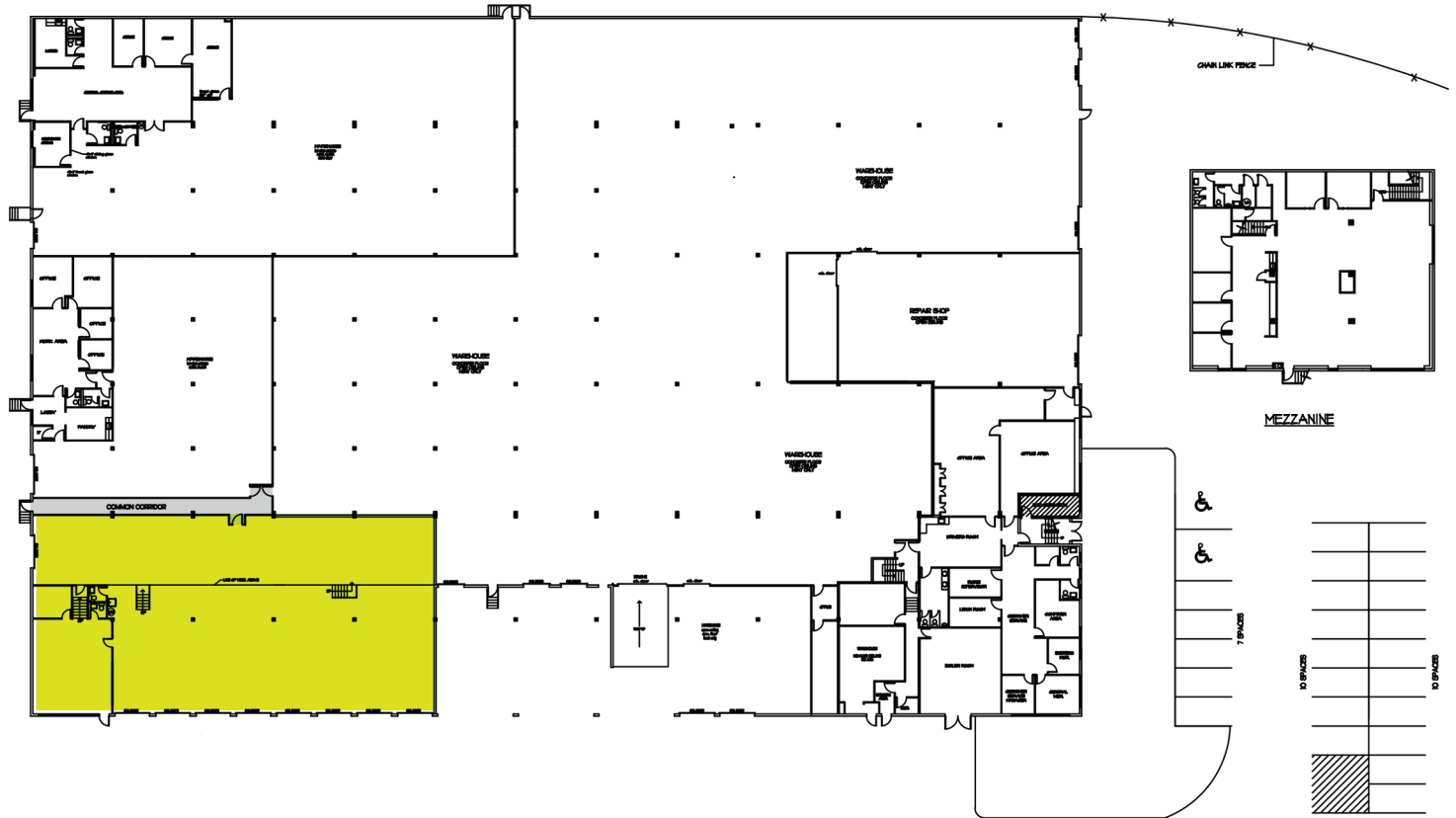

Site Description

| | |
|-----------------------------|--|
| Buildings | 1 |
| Total SF | 8,004 |
| Wide Large Drive-In Doors | 8 |
| Docks | 1 |
| Zoning Type | Industrial/Flex |
| Location Class | A |
| Approximate Ceiling Heights | 14' - 20' |
| Slab | Concrete |
| Parking on Site | Yes |
| Location | Convenient high way access via Route 9A to the Cross Westchester Expressway and the Sprain Brook and Saw Mill River Parkways |
| Asking Lease Price | \$18 psf Gross |



REALTERM
LOGISTICS

