



# PILOT

PROPERTY GROUP

**GREAT OFFICE SPACE!**  
**37308 SCHOENHERR, STERLING HEIGHTS, MI 48312**

**PROPERTY OVERVIEW:**

Nicely appointed office space in the heart of Macomb County.  
 Easy access to 16 Mile Road.  
 Monument signage available.  
 Contact the Brokers for more details.

*Property Type:* ..... General Office  
*Cross Streets:* ..... East side of Schoenherr, North of 16 Mile Rd.  
*Total Square Footage:* ..... 7,000  
*Minimum Square Footage:* ..... 2,500  
*Maximum Square Footage:* ..... 2,500  
*Parcel Size:* ..... 1.45 Acres  
*Year Built:* ..... 2001  
*Zoning:* ..... Office  
*Parking Spaces:* ..... 65+  
*Lease Rate:* ..... \$16.95/SF  
*Lease Type:* ..... Gross

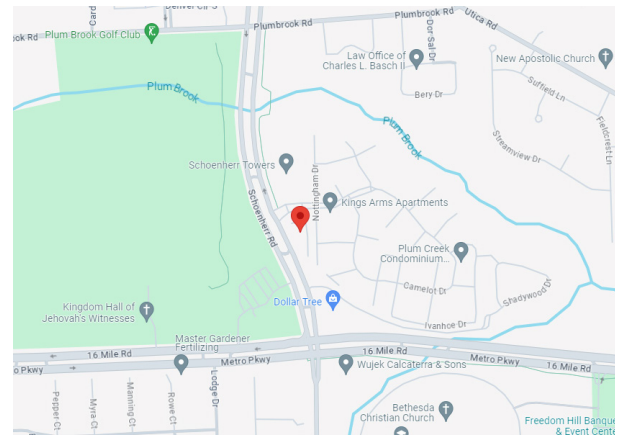

**AGENT CONTACT INFO**

**ANTHONY RUBINO** O: 586.254.0900 x101 • C: 586.873.5419 • anthony@pilotpg.com  
**ALEX TERMINI** O: 586.254.0900 x104 • C: 586.291.0499 • alex@pilotpg.com

*Matching the right people to the right place.*

44400 Van Dyke, Suite 101, Sterling Heights, MI 48314 • 1530 Pine Grove, Suite 4, Port Huron, MI 48060  
 586.254.0900 • www.pilotpg.com

## FLOORPLAN

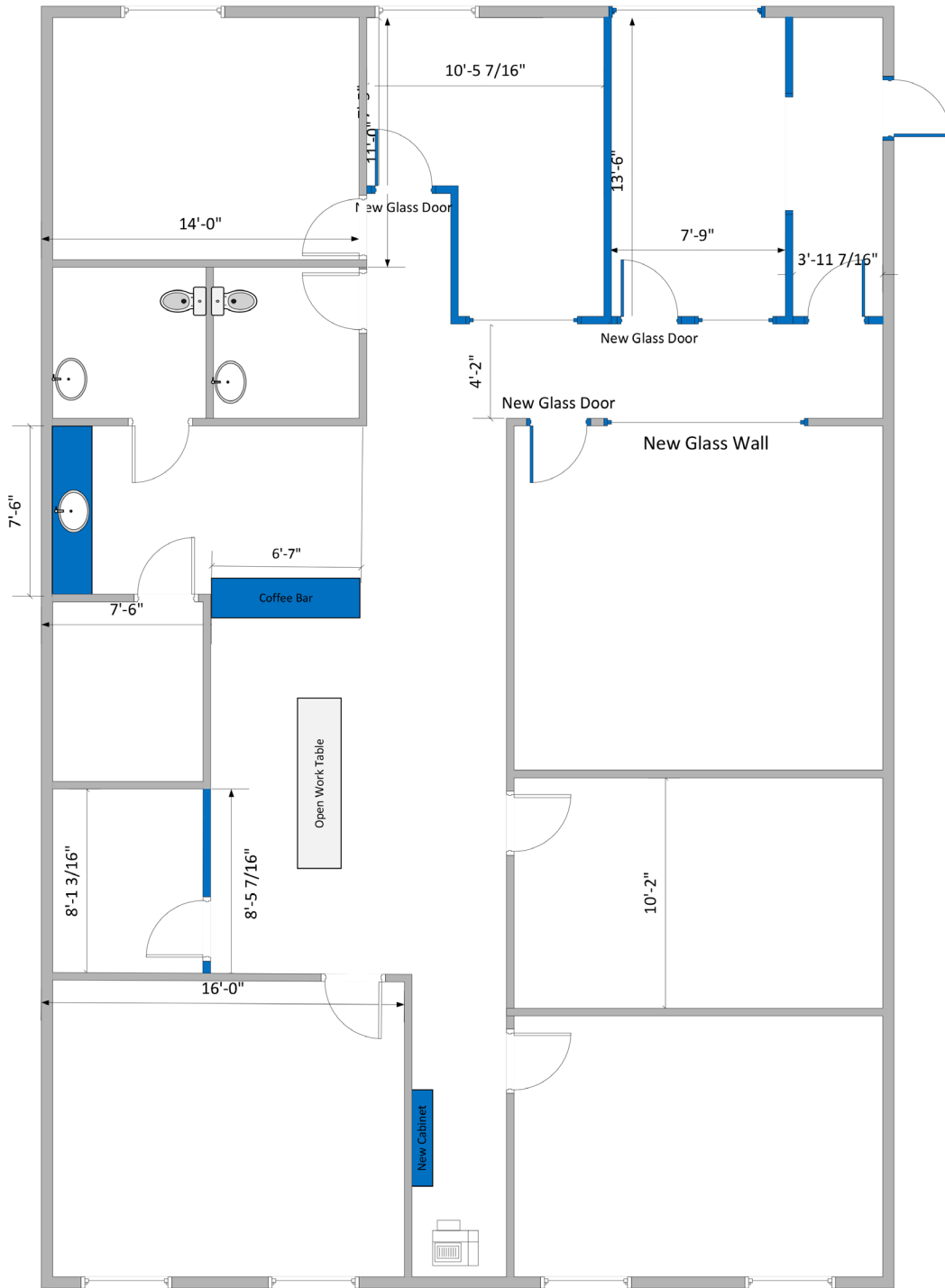

*Matching the right people to the right place.*

## ADDITIONAL PHOTOS



*Matching the right people to the right place.*

44400 Van Dyke, Suite 101, Sterling Heights, MI 48314 • 1530 Pine Grove, Suite 4, Port Huron, MI 48060  
586.254.0900 • [www.pilotpg.com](http://www.pilotpg.com)