

FOR SALE

362 MULBERRY DRIVE

SAN MARCOS, CA 92069

*±9,022 SF Multi-tenant
Office/Flex Building for
Sale in San Marcos*



Building designed with the storefronts, plumbing and electrical meters to divide into up to 4 individual suites



PROPERTY OVERVIEW

BUILDING TYPE	Single story, multi-tenant office building
SQUARE FEET	±9,022 SF
LAND AREA	0.72 acres / 31,363 SF
APN	220-210-33
ZONING	LI / NC for Light industrial transitioning to neighborhood commercial
BUILT	1980
OFFICE	±6,002 SF
SOLAR	Owned solar (PV) system with a rating of 23.6kW (installed in 2024)
UNIMPROVED OFFICE / WAREHOUSE	±3,020 SF
CLEAR HEIGHT	12' - 14'
PARKING	42 spaces (4.67/1,000 SF)
CONSTRUCTION	Decorative concrete block

\$3,599,000
ASKING SALE PRICE

±9,022
SQUARE FEET

KIDDER.COM

This information supplied herein is from sources we deem reliable. It is provided without any representation, warranty, or guarantee, expressed or implied as to its accuracy. Prospective Buyer or Tenant should conduct an independent investigation and verification of all matters deemed to be material, including, but not limited to, statements of income and expenses. Consult your attorney, accountant, or other professional advisor. All Kidder Mathews designs are the sole property of Kidder Mathews. Branded materials and layouts are not authorized for use by any other firm or person.



FOR SALE



KIDDER.COM

This information supplied herein is from sources we deem reliable. It is provided without any representation, warranty, or guarantee, expressed or implied as to its accuracy. Prospective Buyer or Tenant should conduct an independent investigation and verification of all matters deemed to be material, including, but not limited to, statements of income and expenses. Consult your attorney, accountant, or other professional advisor. All Kidder Mathews designs are the sole property of Kidder Mathews. Branded materials and layouts are not authorized for use by any other firm or person.



FLOOR PLAN

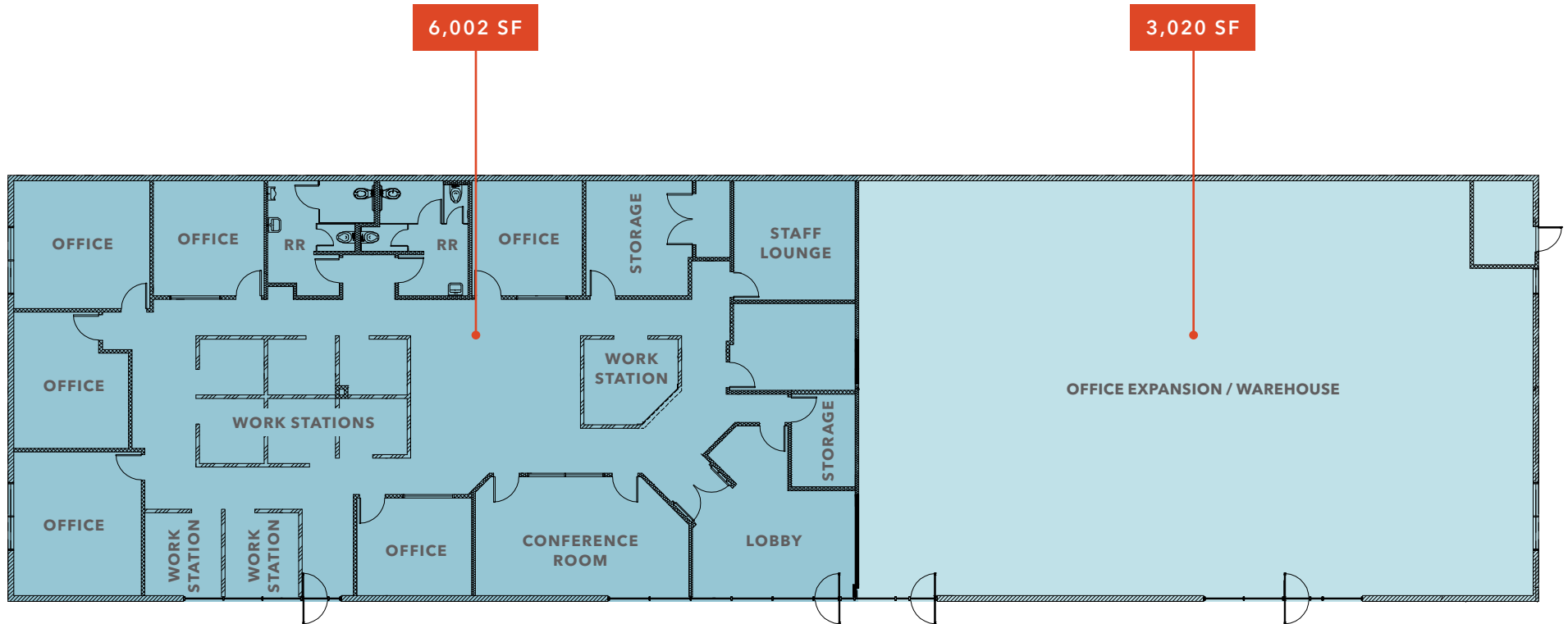

SITE PLAN

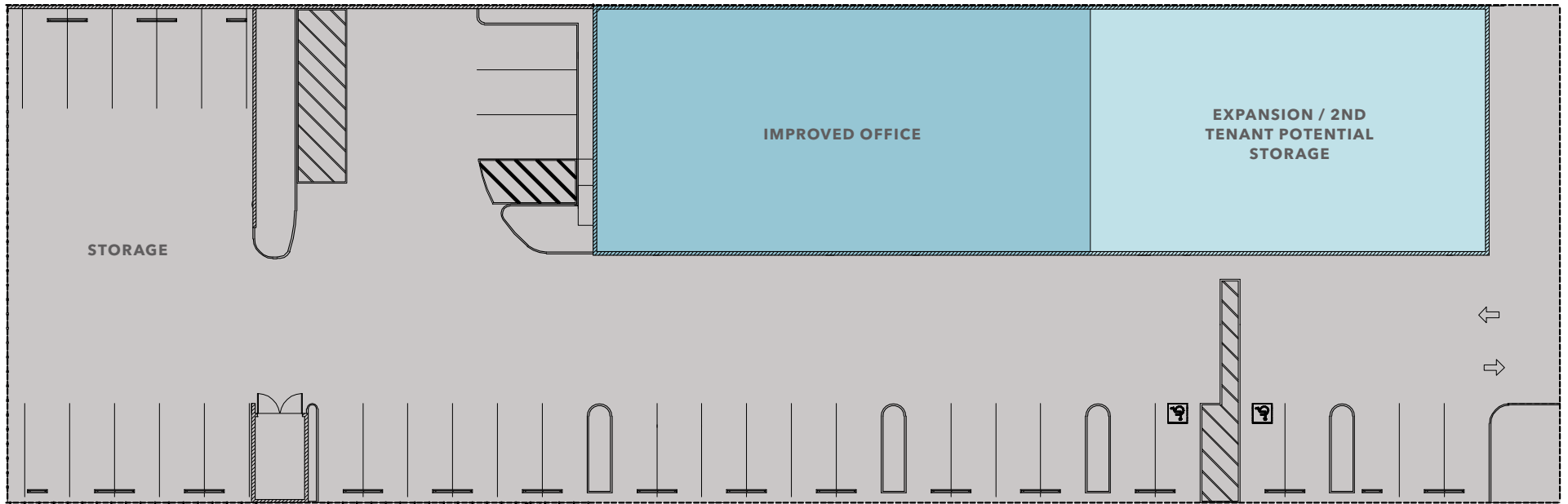

KIDDER.COM

This information supplied herein is from sources we deem reliable. It is provided without any representation, warranty, or guarantee, expressed or implied as to its accuracy. Prospective Buyer or Tenant should conduct an independent investigation and verification of all matters deemed to be material, including, but not limited to, statements of income and expenses. Consult your attorney, accountant, or other professional advisor. All Kidder Mathews designs are the sole property of Kidder Mathews. Branded materials and layouts are not authorized for use by any other firm or person.

DEMOGRAPHICS

POPULATION

	1 Mile	3 Miles	5 Miles
2025 ESTIMATED	14,334	83,827	214,569
MEDIAN AGE	36.1	36.7	37.7
TOTAL BUSINESSES	799	4,161	10,548
TOTAL EMPLOYEES	6,264	34,049	94,652
AVERAGE HOUSEHOLD INCOME	\$142,904	\$144,713	\$138,053
WHITE COLLAR WORKERS	65%	65%	62%
BLUE COLLAR WORKERS	35%	35%	38%

HOUSEHOLDS

	1 Mile	3 Miles	5 Miles
2025 ESTIMATED	4,652	27,780	71,525
AVERAGE HOUSEHOLD SIZE	3.0	2.9	2.9
OWNER-OCCUPIED	63%	60%	57%
RENTER-OCCUPIED	37%	40%	43%

Data Source: ©2026, Sites USA

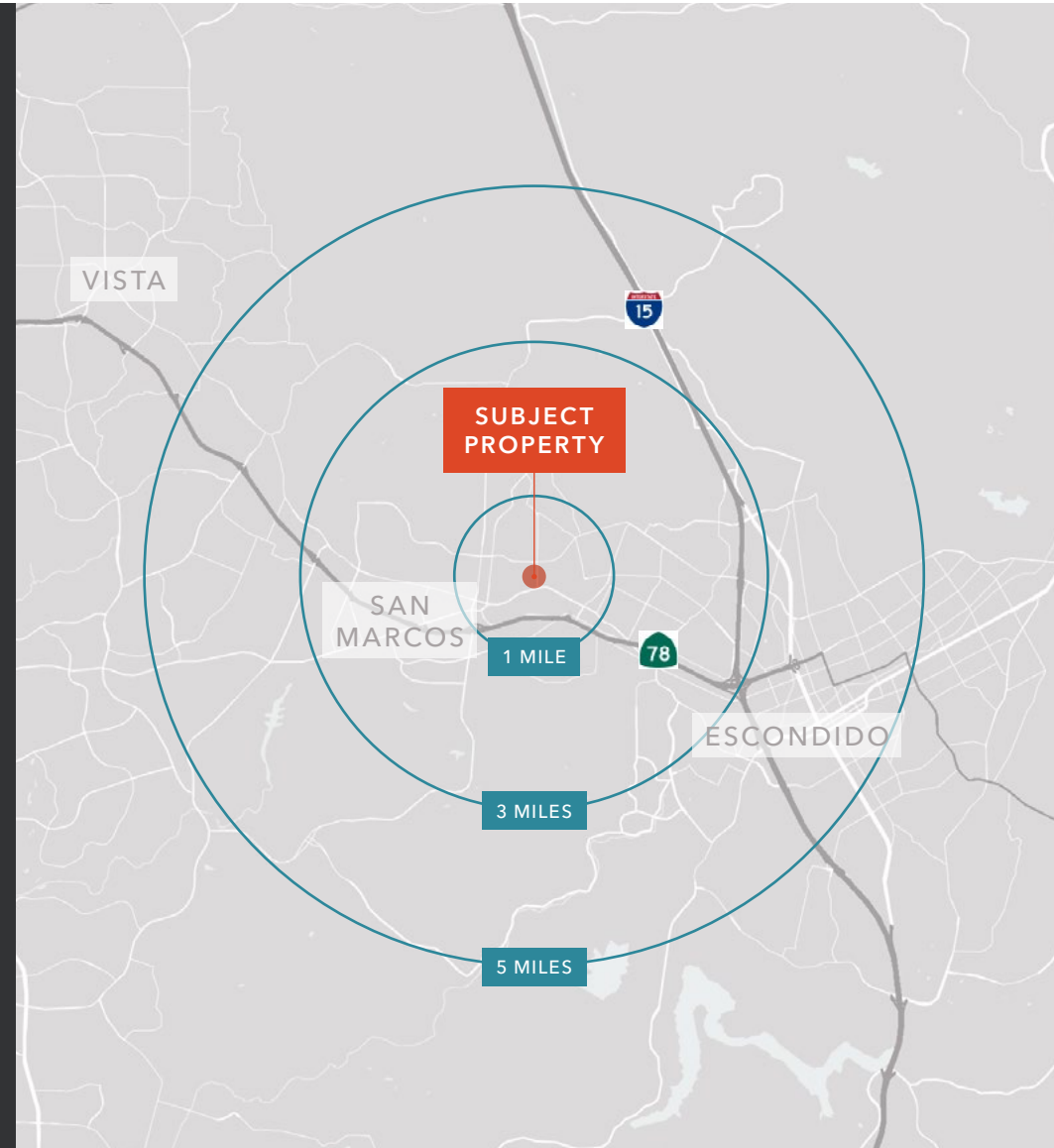

KIDDER.COM

This information supplied herein is from sources we deem reliable. It is provided without any representation, warranty, or guarantee, expressed or implied as to its accuracy. Prospective Buyer or Tenant should conduct an independent investigation and verification of all matters deemed to be material, including, but not limited to, statements of income and expenses. Consult your attorney, accountant, or other professional advisor. All Kidder Mathews designs are the sole property of Kidder Mathews. Branded materials and layouts are not authorized for use by any other firm or person.

FOR SALE



KIDDER.COM

This information supplied herein is from sources we deem reliable. It is provided without any representation, warranty, or guarantee, expressed or implied as to its accuracy. Prospective Buyer or Tenant should conduct an independent investigation and verification of all matters deemed to be material, including, but not limited to, statements of income and expenses. Consult your attorney, accountant, or other professional advisor. All Kidder Mathews designs are the sole property of Kidder Mathews. Branded materials and layouts are not authorized for use by any other firm or person.



Exclusively listed by

BOB WILLINGHAM, SIOR
Executive Vice President
858.369.3013
bob.willingham@kidder.com
LIC N° 01469841

RON KING, SIOR
Executive Vice President
858.369.3011
ron.king@kidder.com
LIC N° 00868661

KIDDER.COM

