

# 2110 Lawrence Street - Suite 300

Atlanta, GA 30334

124,432 SF – FOR LEASE

CREEKSIDE DISTRIBUTION CENTER | END-CAP WITH ADDITIONAL OFFSITE PARKING



## SUITE INFORMATION

Total Square Feet:	124,432 SF
Warehouse:	122,832 SF
Office:	1,600 SF
Loading Doors:	22 dock-high; 1 drive-in
Dock Equipment:	Four (4) pit levelers and six (6) EoD levelers
Column Spacing:	50'x50'
Truckcourt:	Approx. 185'
Ceiling Height:	32' clear
Sprinklers:	ESFR
Lighting:	LED
Auto Parking:	24 (expandable to 214)
Trailer Parking:	23 (expandable)



**Joseph Kriss**  
678.362.4641  
josephk@seefriedproperties.com

**Tripp Ausband**  
770.825.3391 Direct  
tausband@seefriedproperties.com

**Seefried Industrial Properties**  
3333 Riverwood Parkway, Suite 200 | Atlanta, GA 30339  
404.233.0204 | www.seefriedproperties.com



No guarantee, warranty or representation, express or implied, is made as to the accuracy of the information contained herein, and same is submitted subject to errors, omissions, change of price, rental or other conditions, or withdrawal without notice.

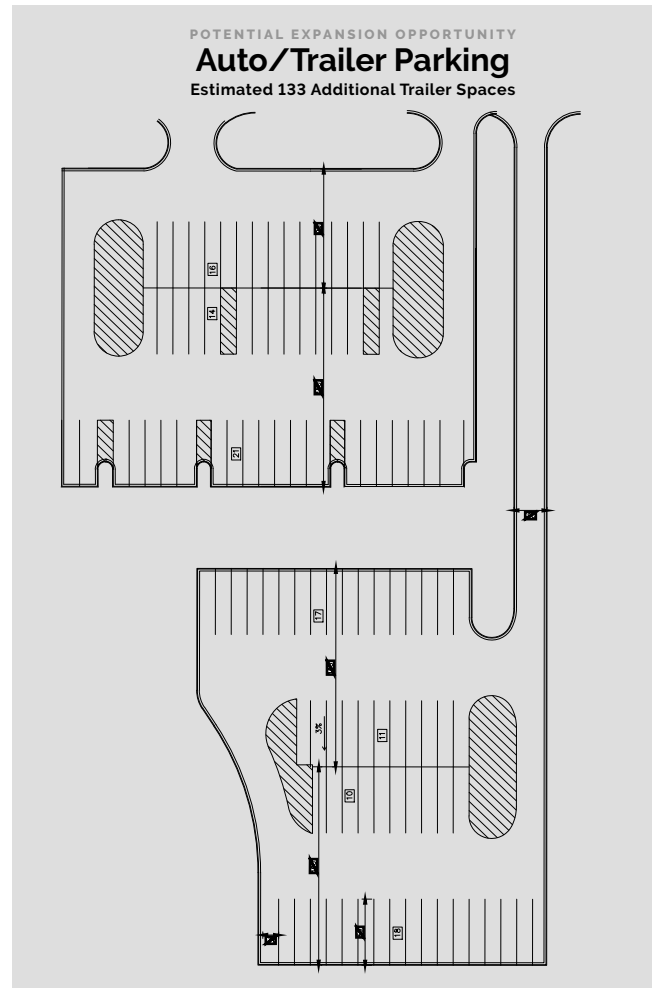
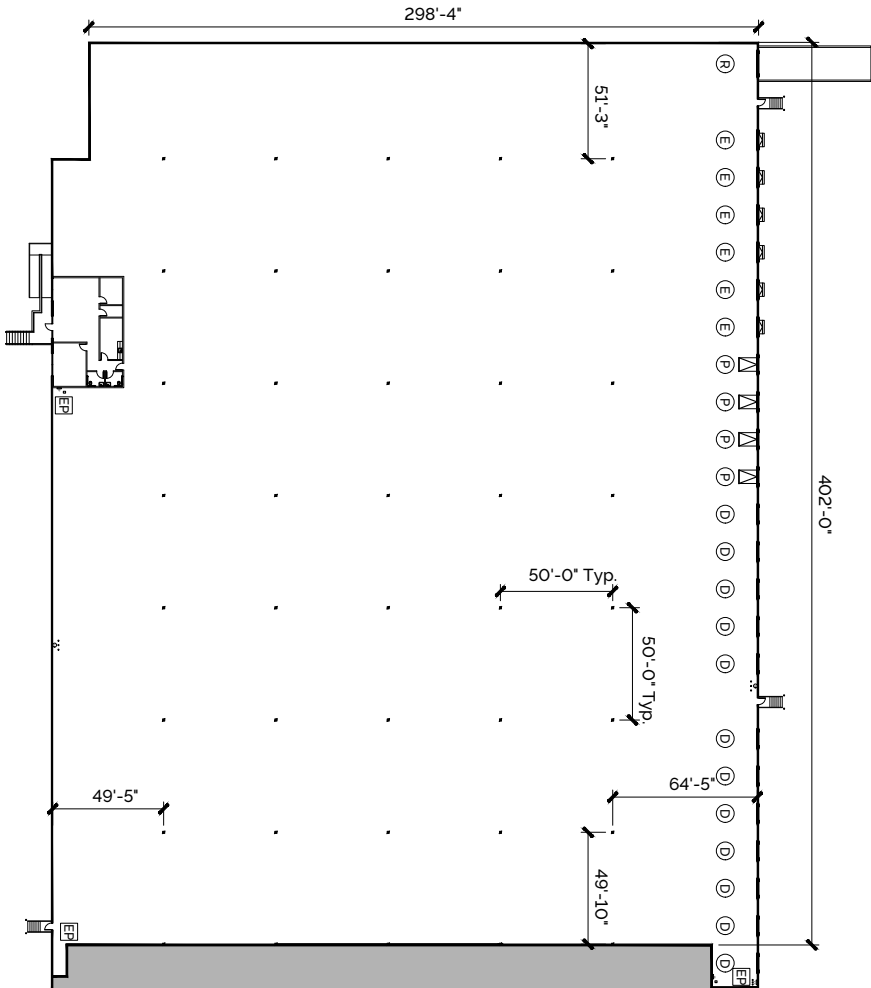

**Joseph Kriss**  
678.362.4641  
josephk@seefriedproperties.com

**Tripp Ausband**  
770.825.3391 Direct  
tausband@seefriedproperties.com

**Seefried Industrial Properties**  
3333 Riverwood Parkway, Suite 200 | Atlanta, GA 30339  
404.233.0204 | www.seefriedproperties.com

