

H I L A N D
C O M M E R C I A L

2258 & 2280 Schuetz Rd
St. Louis, MO 63146

MAPLE POND OFFICE PARK

Westport
Office Space
For Sale or Lease

2258



PROPERTY HIGHLIGHTS

- Premiere two-building office portfolio located in the Westport submarket
- Excellent location and easy access to I-270 and Lindbergh Blvd
- Building & Monument Signage available
- Recently renovated common areas
- Over 5/1,000 sf parking ratio on-site
- Restaurants and other retail amenities nearby at WESTPORT PLAZA including Starbucks, Westport Social, Trainwreck Saloon, Fuzzy's Taco Shop & 360 Westport



MAPLE POND PARK I (2258 Schuetz Rd)

Two-story, 25,022 square foot office building
Suites available from 339 square feet up to 3,268 square feet

MAPLE POND PARK II (2280 Schuetz Rd)

Two-story, 26,360 square foot office building
Entire 13,180 square foot 1st floor available
Excellent owner/user opportunity
Furniture available and backup generator on-site

For Lease: \$17.95/RSF Full-Service
For Sale: Contact Broker



BUILDING
SIGNAGE
OPPORTUNITY

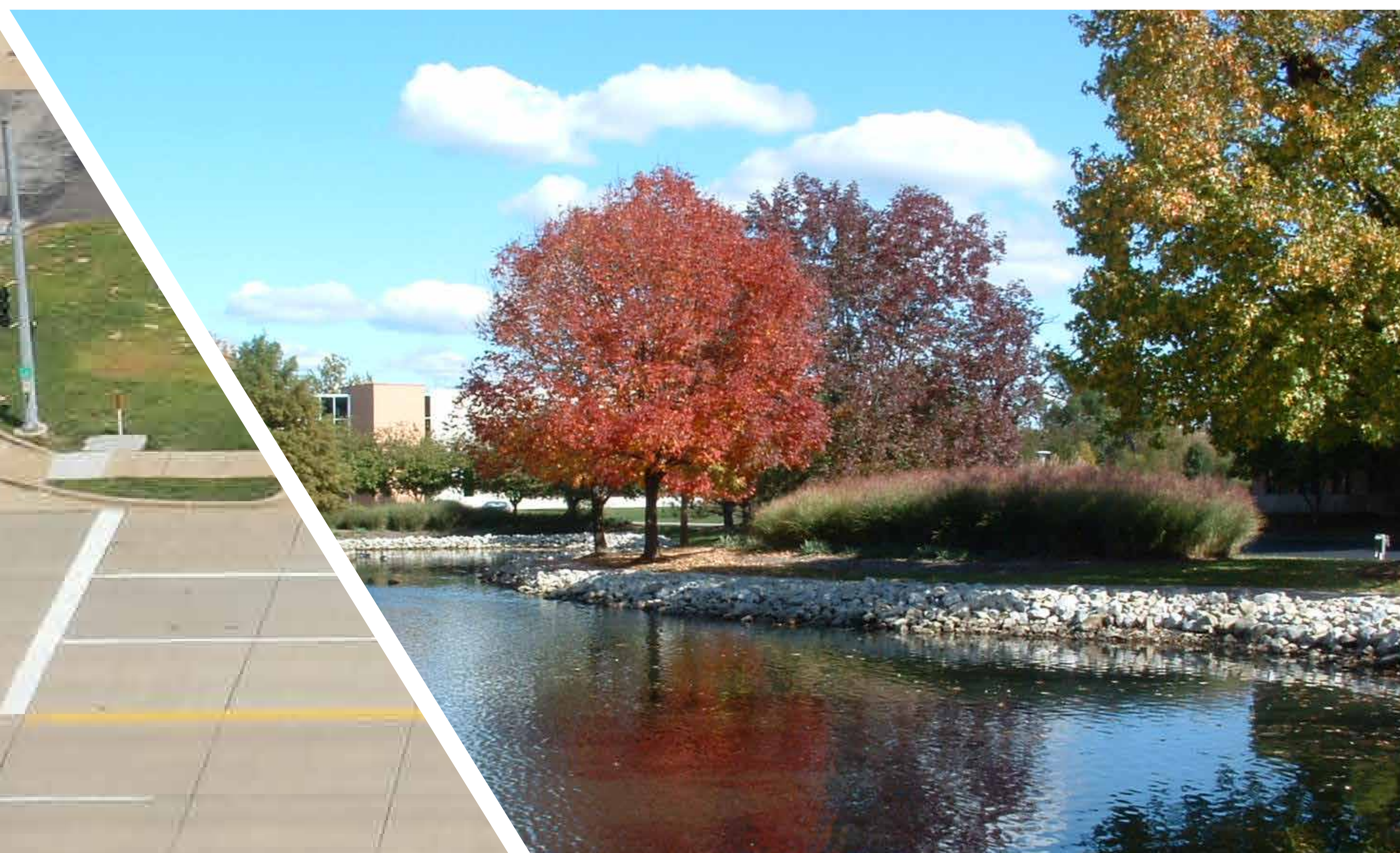



339 RSF up to 13,180 RSF

AVAILABLE

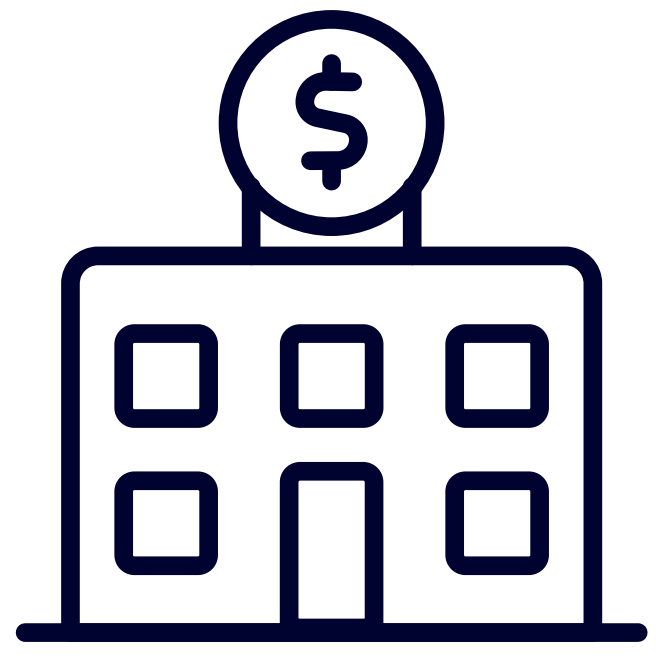

\$17.95

PSF FULL-SERVICE

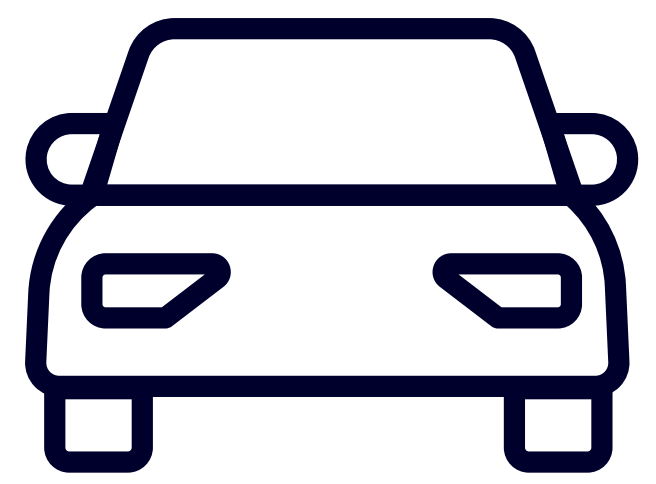

5/1,000

PARKING RATIO

2

BUILDINGS

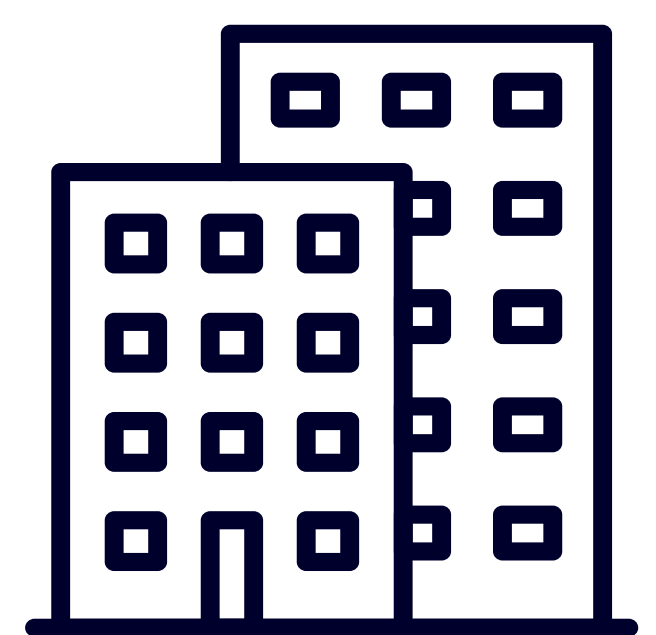

B+

CLASS BUILDING

2022

RENOVATION

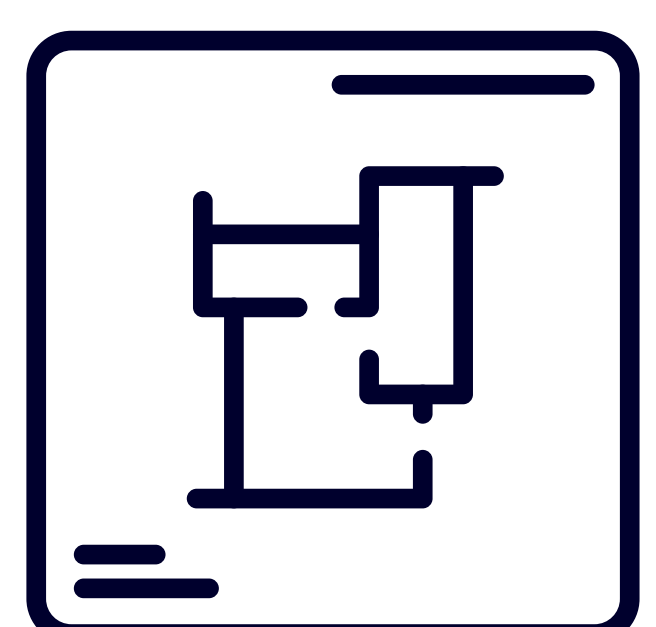

339

SF MIN AVAILABLE

13,180

SF MAX CONTIG





2258

NO SOLICITING

NO SOLICITING



LOCATION



MAPLE POND PARK II
2280 Schuetz Rd

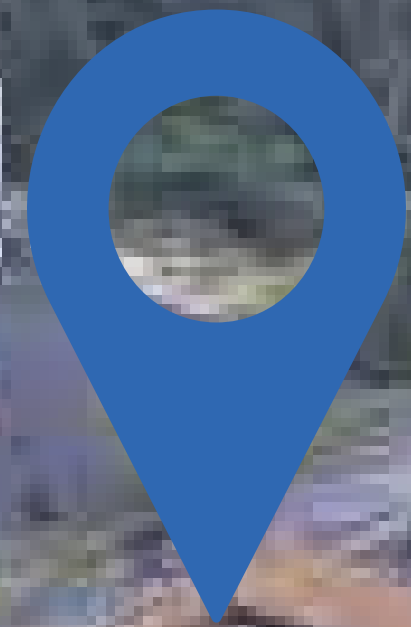

MAPLE POND PARK I
2258 Schuetz Rd

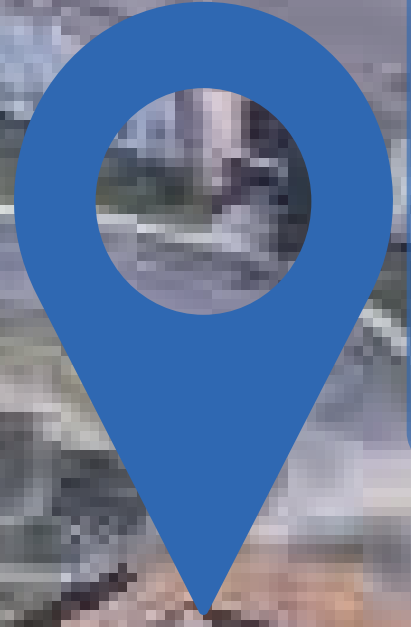

Schuetz Rd

Page Ave



A E R I A L



2258 & 2280 Schuetz Rd
St. Louis, MO 63146

For Additional Information, Please Contact

PAM HINDS

phinds@hilandcommercial.com

314.802.6226 x2

TIM LAWLOR, SIOR, CCIM

tlawlor@hilandcommercial.com

314.802.6226 x1

12412 POWERSCOURT DR
ST. LOUIS, MO 63131
WWW.HILANDCOMMERCIAL.COM

**MAPLE POND
OFFICE PARK**



©2024 HILAND COMMERCIAL. ALL RIGHTS RESERVED. THIS INFORMATION HAS BEEN OBTAINED FROM SOURCES BELIEVED TO BE RELIABLE BUT HAS NOT BEEN VERIFIED. NO WARRANTY OR REPRESENTATION, EXPRESS OR IMPLIED, IS MADE AS TO THE CONDITION OF THE PROPERTY (OR PROPERTIES) REFERENCED HEREIN OR AS TO THE ACCURACY OR COMPLETENESS OF THE INFORMATION CONTAINED HEREIN, AND SAME IS SUBMITTED SUBJECT TO ERRORS, OMISSIONS, CHANGE OF PRICE, RENTAL OR OTHER CONDITIONS, WITHDRAWAL WITHOUT NOTICE, AND TO ANY SPECIAL LISTING CONDITIONS IMPOSED BY THE PROPERTY OWNER(S). ANY PROJECTIONS, OPINIONS OR ESTIMATES ARE SUBJECT TO UNCERTAINTY AND DO NOT SIGNIFY CURRENT OR FUTURE PROPERTY PERFORMANCE.